

three eighths inch = one foot
one eighth inch = one foot
one quarter inch = one foot
one half inch = one foot
one inch = one foot
one and one half inch = one foot
two inches = one foot
three inches = one foot
four inches = one foot
five inches = one foot
six inches = one foot
seven inches = one foot
eight inches = one foot
nine inches = one foot
ten inches = one foot
eleven inches = one foot
twelve inches = one foot
thirteen inches = one foot
fourteen inches = one foot
fifteen inches = one foot
sixteen inches = one foot
seventeen inches = one foot
eighteen inches = one foot
nineteen inches = one foot
twenty inches = one foot
twenty one inches = one foot
twenty two inches = one foot
twenty three inches = one foot
twenty four inches = one foot
twenty five inches = one foot
twenty six inches = one foot
twenty seven inches = one foot
twenty eight inches = one foot
twenty nine inches = one foot
thirty inches = one foot
thirty one inches = one foot
thirty two inches = one foot
thirty three inches = one foot
thirty four inches = one foot
thirty five inches = one foot
thirty six inches = one foot
thirty seven inches = one foot
thirty eight inches = one foot
thirty nine inches = one foot
forty inches = one foot
forty one inches = one foot
forty two inches = one foot
forty three inches = one foot
forty four inches = one foot
forty five inches = one foot
forty six inches = one foot
forty seven inches = one foot
forty eight inches = one foot
forty nine inches = one foot
fifty inches = one foot
fifty one inches = one foot
fifty two inches = one foot
fifty three inches = one foot
fifty four inches = one foot
fifty five inches = one foot
fifty six inches = one foot
fifty seven inches = one foot
fifty eight inches = one foot
fifty nine inches = one foot
sixty inches = one foot
sixty one inches = one foot
sixty two inches = one foot
sixty three inches = one foot
sixty four inches = one foot
sixty five inches = one foot
sixty six inches = one foot
sixty seven inches = one foot
sixty eight inches = one foot
sixty nine inches = one foot
seventy inches = one foot
seventy one inches = one foot
seventy two inches = one foot
seventy three inches = one foot
seventy four inches = one foot
seventy five inches = one foot
seventy six inches = one foot
seventy seven inches = one foot
seventy eight inches = one foot
seventy nine inches = one foot
eighty inches = one foot
eighty one inches = one foot
eighty two inches = one foot
eighty three inches = one foot
eighty four inches = one foot
eighty five inches = one foot
eighty six inches = one foot
eighty seven inches = one foot
eighty eight inches = one foot
eighty nine inches = one foot
ninety inches = one foot
ninety one inches = one foot
ninety two inches = one foot
ninety three inches = one foot
ninety four inches = one foot
ninety five inches = one foot
ninety six inches = one foot
ninety seven inches = one foot
ninety eight inches = one foot
ninety nine inches = one foot
one hundred inches = one foot

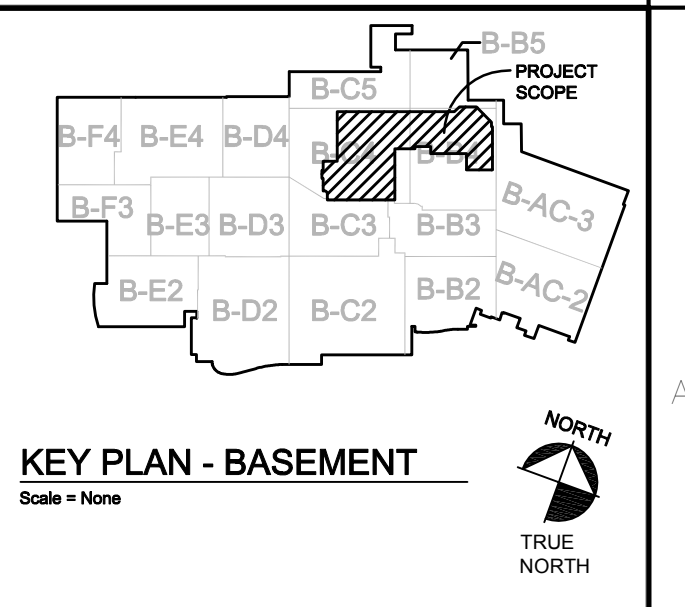
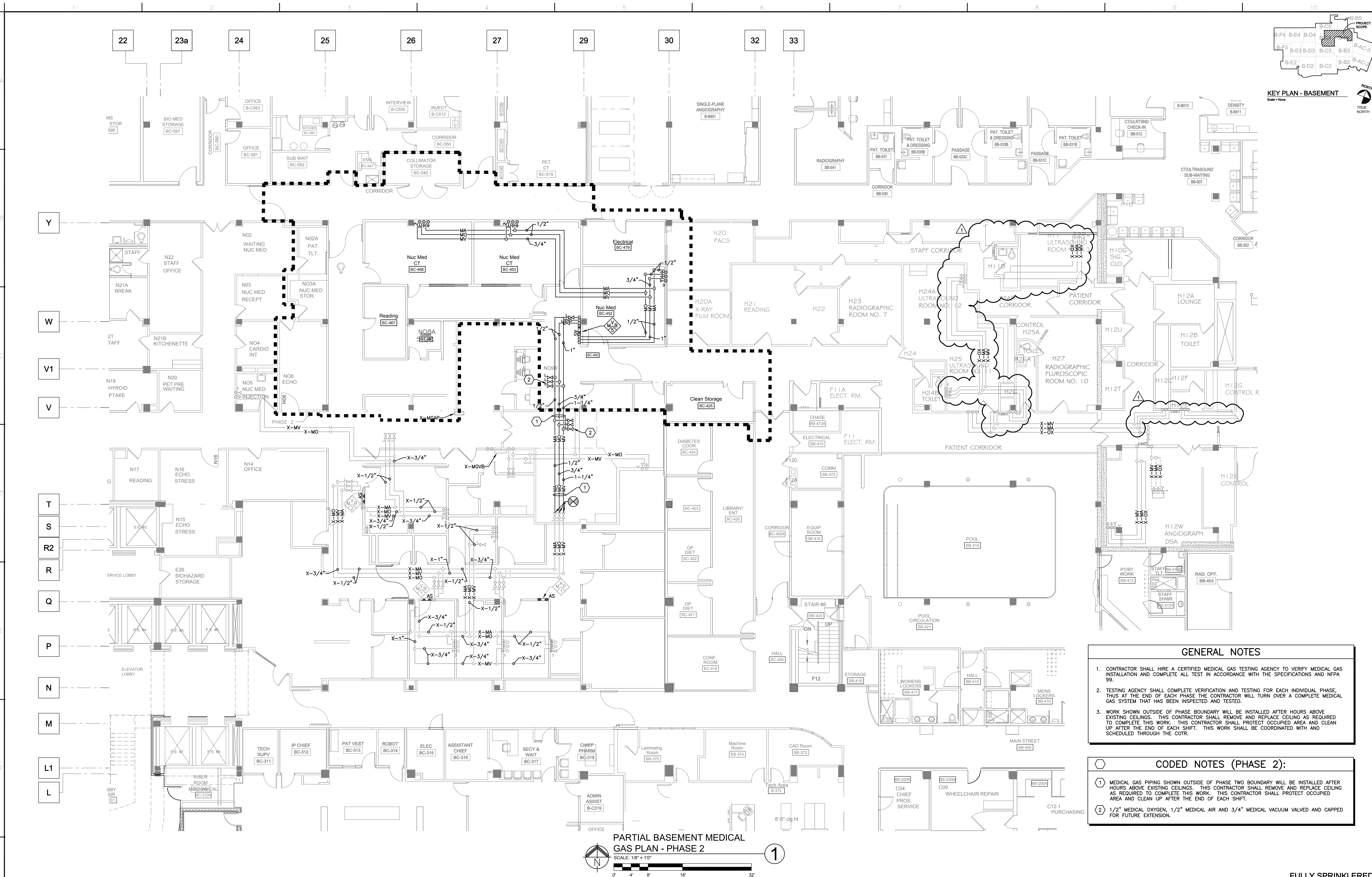

- GENERAL NOTES**
 - CONTRACTOR SHALL HIRE A CERTIFIED MEDICAL GAS TESTING AGENCY TO VERIFY MEDICAL GAS INSTALLATION AND COMPLETE ALL TEST IN ACCORDANCE WITH THE SPECIFICATIONS AND NFPA 99.
 - TESTING AGENCY SHALL COMPLETE VERIFICATION AND TESTING FOR EACH INDIVIDUAL PHASE, THUS AT THE END OF EACH PHASE THE CONTRACTOR WILL TURN OVER A COMPLETE MEDICAL GAS SYSTEM THAT HAS BEEN INSPECTED AND TESTED.
 - WORK SHOWN OUTSIDE OF PHASE BOUNDARY WILL BE INSTALLED AFTER HOURS ABOVE EXISTING CEILING. THIS CONTRACTOR SHALL REMOVE AND REPLACE CEILING AS REQUIRED TO COMPLETE THIS WORK. THIS CONTRACTOR SHALL PROTECT OCCUPIED AREA AND CLEAN UP AFTER THE END OF EACH SHIFT. THIS WORK SHALL BE COORDINATED WITH AND SCHEDULED THROUGH THE COTR.
- CODED NOTES (PHASE 2):**
 - MEDICAL GAS PIPING SHOWN OUTSIDE OF PHASE TWO BOUNDARY WILL BE INSTALLED AFTER HOURS ABOVE EXISTING CEILING. THIS CONTRACTOR SHALL REMOVE AND REPLACE CEILING AS REQUIRED TO COMPLETE THIS WORK. THIS CONTRACTOR SHALL PROTECT OCCUPIED AREA AND CLEAN UP AFTER THE END OF EACH SHIFT.
 - 1/2" MEDICAL OXYGEN, 1/2" MEDICAL AIR AND 3/4" MEDICAL VACUUM VALVED AND CAPPED FOR FUTURE EXTENSION.

CONSULTANTS:		ARCHITECT:		Drawing Title		Project Title		Project Number		Office of Facilities Management	
 FREDRICK, FREDRICK & HELLER ENGINEERS, INC. 672 EAST ROYALTON ROAD BROADVIEW HTS., OHIO 44147 TEL: (440) 546-8888 FAX: (440) 546-8889		 Perspectus architecture 13212 Shaker Square Suite 204 Cleveland, Ohio 44120 P. 216.752.1800 F. 216.752.3833		PARTIAL BASEMENT MEDICAL GAS PLAN - PHASE 2		EXPAND AND RENOVATE NUCLEAR MEDICINE AND RADIOLOGY		541-14-101		Office of Facilities Management	
Amendment 02 Bid Issue Revisions:		2217 East 9th Street, Suite 350 Cleveland OH 44115-1257 216-875-0100/ (F) 216-875-0111 barberhoffman.com BARBER & HOFFMAN, INC. Consulting Engineers		Approved: Project Director		VAMC - WADE PARK		Building Number 1		Department of Veterans Affairs	
09/12/14 01/17/14 Date		FFH #13027				Location		Drawing Number 1-P6.2			
						Date 1-17-2014		Checked BMW		Dwg. of	
								Drawn DAD			