

① LEVEL 1 - AREA D
3/16" = 1'-0"

[illegible]

ARCHITECTS/ENGINEERS:

**Burns &
McDonnell**
SINCE 1898

9400 Ward Parkway
Kansas City, MO 64114
Phone: (816) 333-9400
Fax: (816) 822-3321
<http://burnsmcd.com>

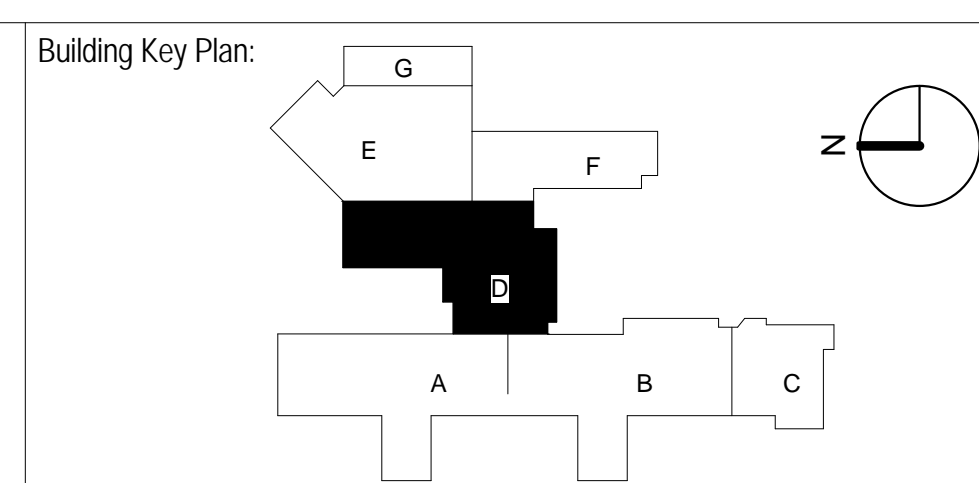

FACILITIES MANAGEMENT
FLOOR PLAN DRAWINGS

- FOR REFERENCE ONLY -
NOT FOR
CONSTRUCTION



**VA EASTERN KANSAS HEALTH
CARE SYSTEM**

Dwight D. Eisenhower VA Medical Center, Leavenworth
Colmery-O'Neil VA Medical Center, Topeka

Drawing Title: **LEVEL 1 - AREA D**

Scale: **3/16" = 1'-0"**

0 4' 8'

SCALE IN FEET

Approved: _____

Project Title:			Date:
VA RTLS HOSPITAL			01/21/2014
Building Number:			Project No.
1	Checked By:	Drawn By:	74344
	AS	TC	
Location:			Drawing No.
Colmery-O'Neil VA Medical Center, Topeka			AE213
			Dwn. Of

Department of
Veterans Affairs