

one eighth inch = one foot
0 4 8 16
one quarter inch = one foot
0 4 8
three eighths inch = one foot
0 4 8
one half inch = one foot
0 4 8
three quarters inch = one foot
0 4 8
one inch = one foot
0 6
one and one half inches = one foot
0 6
two inches = one foot
0 6
three inches = one foot
0 6

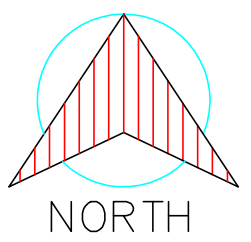
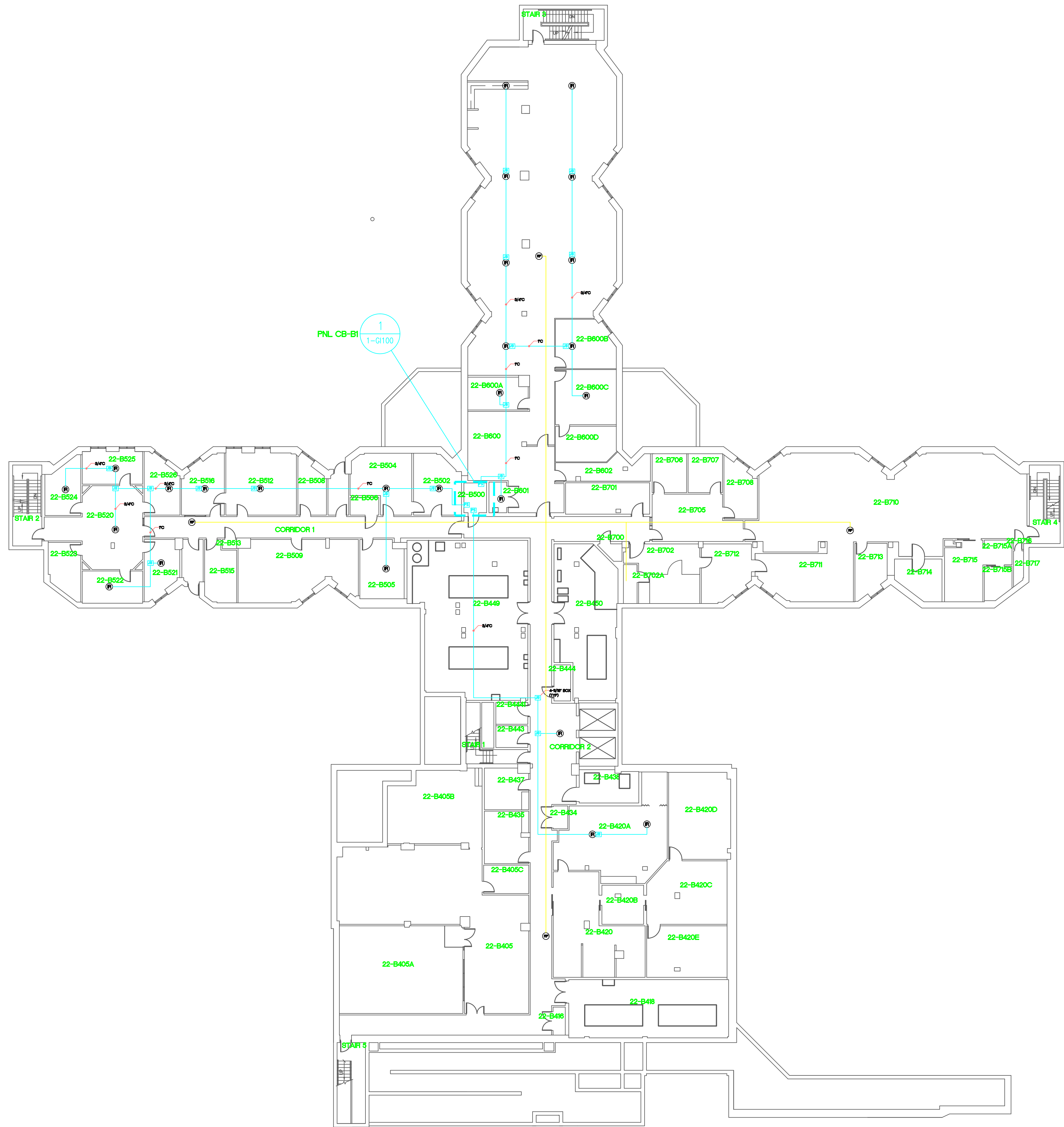

AS-BUILT	01/31/14
AS-BUILT	10/25/13
Revision 1	3-8-13

CONSULTANTS:

WAK Engineers-Architects-Co

William A. Kibbe & Associates
1475 S. Washington Avenue, Saginaw, MI
(989) 752-5000

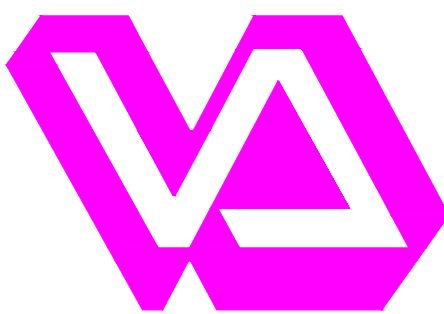

Department of Veterans Affairs
Aleda E. Lutz Medical Center
1500 Weiss Street
Saginaw, MI 48602

Property of the United States Government
For Official Use Only
Do not remove this notice.
Properly Destroy documents when no longer needed.

File Name
File Location

Drawing Title	BUILDING 22 FLOOR B RTLS LAYOUT
Approved Director Facilities Management Service	

Project Title	RTLS SITE PREP
Project No.	655-13-106
Date	3-8-13
Checked	
Drawn	

Scale	1/16" = 1'-0"
Building Number	BUILDING 22
Drawing Number	22-EP-100
	Dwg. 67 of 95

Office of
Facilities
Management

