

three inches = one foot
one and one half inches = one foot
one inch = one foot
three quarters inch = one foot
one half inch = one foot
three eighths inch = one foot
one quarter inch = one foot
one eighth inch = one foot

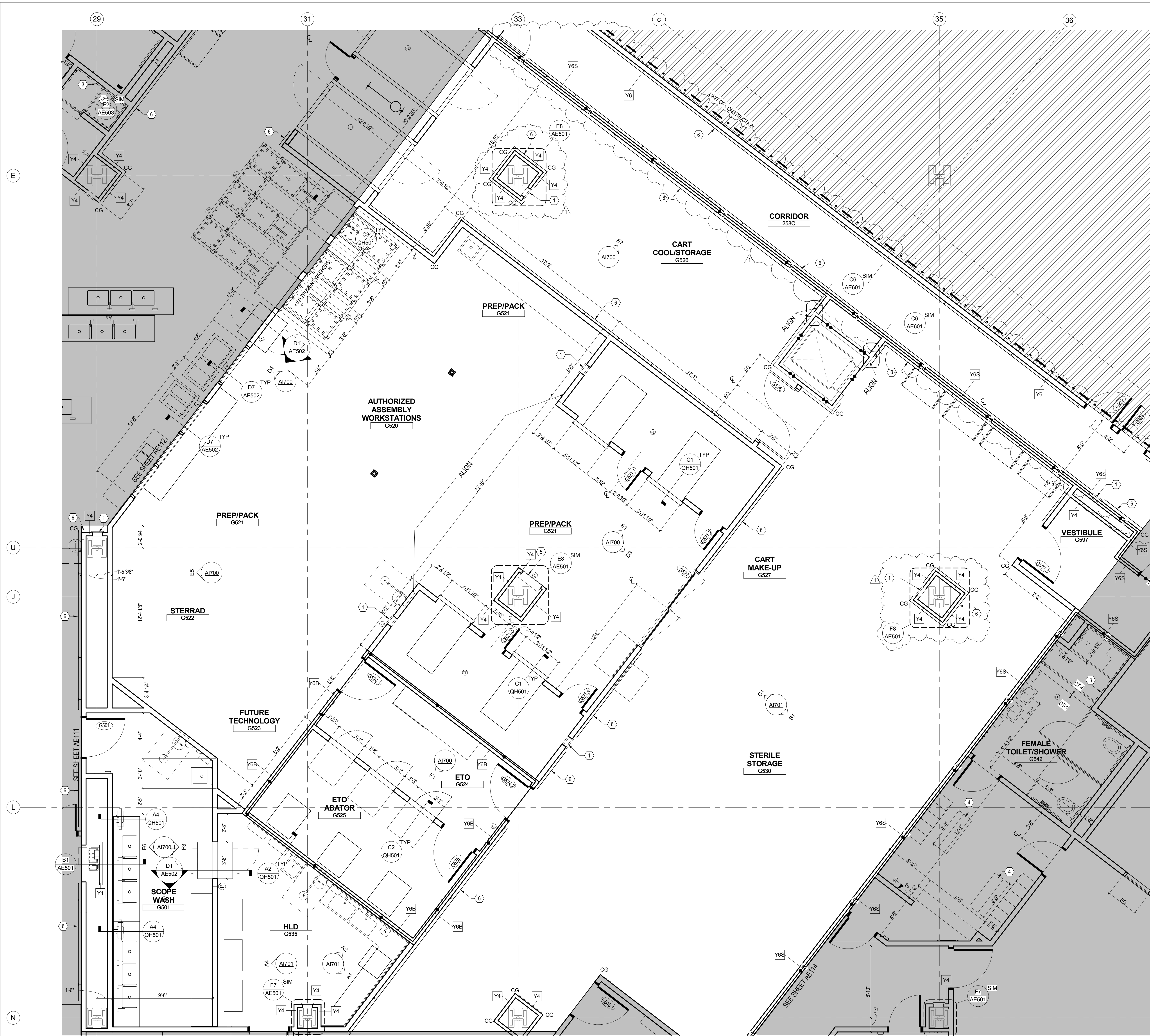

KEY PLAN:

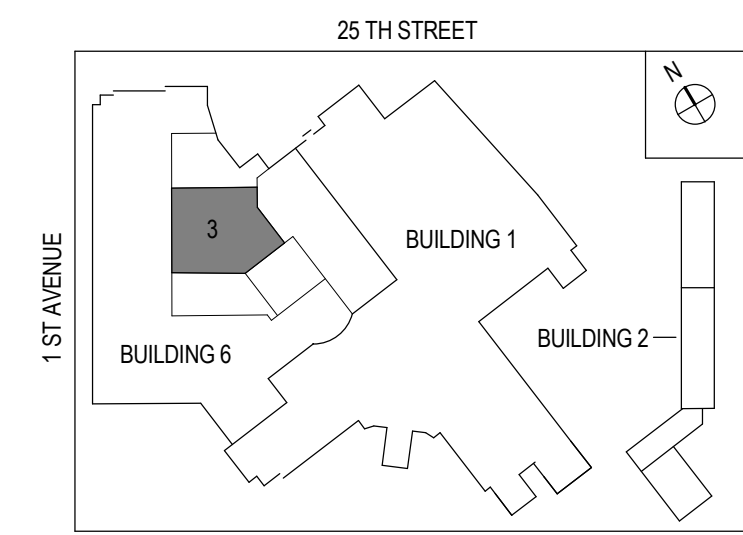

GENERAL NOTES:

- ALL DIMENSIONS ARE TO FINISH FACE OF WALLS.
- PATCH ALL EXISTING FIRE-RATED CONSTRUCTION AS REQUIRED. FIRESTOP ALL PENETRATIONS, NEW OR EXISTING, IN FIRE-RATED CONSTRUCTION AS REQUIRED TO MAINTAIN RATING. REFER TO DRAWING G1002 FOR EXISTING FIRE-RATED PARTITIONS.
- PATCH ANY PENETRATIONS IN EXISTING CONSTRUCTION TO REMAIN, FOUND OR CREATED DURING THE COURSE OF DEMOLITION SCOPE.
- CONTRACTOR TO CHALK OUT ALL PARTITION AND DOOR LOCATIONS FOR ARCHITECT'S REVIEW AND APPROVAL PRIOR TO INSTALLATION OF TRACKS.
- PROVIDE SEALANT AT ALL INTERIOR JOINTS, CREVICES, GAPS AND OPENINGS, IN ACCORDANCE WITH SCHEDULE IN SPECIFICATION.
- GENERAL CONTRACTOR TO PROVIDE REQUIRED BLOCKING IN THE WALLS FOR PROPER SUPPORT AND FASTENING OF THE OF THE MILLWORK AND CASEWORK.
- PATCH AND REPAIR ALL EXISTING CORRIDOR FLOORING, WALL, AND CEILING FINISHES IMPACTED BY CONSTRUCTION TO MATCH ADJACENT CORRIDOR SURFACES.
- DRAWINGS INCLUDE TYPICAL DETAILS THAT ARE NOT CROSS-REFERENCED WITHIN THE SET. DUE TO GENERIC AND WIDESPREAD NATURE, DETAILS APPLY TO ALL CONSTRUCTION AS PROJECT CONDITIONS PRESENT THEMSELVES.
- DRAWINGS OF BASE BUILDING CONDITIONS ARE BASED ON EXISTING BUILDING DRAWINGS AND LIMITED FIELD OBSERVATION. ACTUAL CONDITIONS MAY DIFFER FROM THOSE SHOWN.
- VERIFY EXISTING CONSTRUCTION, CONDITIONS AND DIMENSIONS PRIOR TO THE FABRICATION AND INSTALLATION OF MATERIALS AND PRODUCTS. CONTRACTOR SHALL REPORT ANY DISCREPANCIES TO THE AE PRIOR TO START OF WORK. COMMENCEMENT OF WORK IMPLIES ACCEPTANCE OF EXISTING CONDITIONS.
- IF DOCUMENTS ARE AT VARIANCE WITH ONE ANOTHER, THE CONTRACTOR SHALL BASE HIS PROPOSAL ON THE BETTER QUALITY OR MORE EXPENSIVE OF THE CONDITIONS. ITEMS OR EQUIPMENT SPECIFIED UNDER ONE TRADE SHALL BE BINDING AS IF SPECIFIED UNDER ALL APPLICABLE TRADES.
- VERIFY DRAWINGS ARE THE LATEST ISSUE PRIOR TO COMMENCING CONSTRUCTION.
- DIMENSIONS AND NOTES FOR A GIVEN CONDITION ARE TYPICAL FOR SIMILAR CONDITIONS, UNLESS OTHERWISE NOTED.
- DO NOT SCALE DRAWINGS. CLARIFICATION OF INFORMATION REQUIRED BY CONTRACTOR WILL BE FURNISHED BY THE AE, UPON WRITTEN REQUEST.
- PROTECT AND BE RESPONSIBLE FOR ADJACENT STRUCTURES AND SPACES WITHIN AREA OF OPERATION UNDER THIS CONTRACT. ANY DAMAGE OR DISTURBANCE RESULTING FROM WORK DONE UNDER THIS CONTRACT SHALL BE PROMPTLY RESTORED, REPLACED OR REPAIRED AT NO ADDITIONAL COST TO THE VA.
- LOCATE DOOR OPENINGS FOUR INCHES FROM ADJACENT WALL, UNLESS OTHERWISE NOTED. DOOR OPENINGS ADJACENT TO CASEWORK, MILLWORK, OR OTHER FIXED EQUIPMENT, SHALL BE FOUR INCHES FROM THE FACE OF EQUIPMENT, UNLESS OTHERWISE NOTED.
- PROVIDE CONTROL JOINTS AT 25'-0" O.C. MAXIMUM FOR CMJ AND GYPSUM BOARD PARTITIONS, UNLESS OTHERWISE NOTED.
- VERIFY EXISTING COLUMN CENTERLINES, SIZES AND LOCATIONS PRIOR TO THE START OF WORK BRING ANY DISCREPANCIES TO THE AE'S ATTENTION PRIOR TO THE START OF WORK IN THAT AREA.
- IN AREAS WHERE PREVIOUS DEMOLITION OR EXISTING CONDITIONS HAVE CAUSED UNEVENNESS OF THE FLOOR SLAB, CONTRACTOR SHALL PATCH AND LEVEL EXISTING SLAB TO MATCH ADJACENT SLAB CONSTRUCTION. COORDINATE WITH FINISH PLANS AND DETAILS.
- SUB-FLOOR SHALL BE CLEAN AND FREE OF DUST, SOLVENTS, SEALERS, ADHESIVE RESIDUE, AND OTHER FOREIGN MATERIALS PRIOR TO FINISH FLOOR INSTALLATION. VERIFY ALL WALL AND FLOOR SUBSTRATES ARE ACCEPTABLE FOR FLOORING AND BASE APPLICATION. PREPARE SURFACE ACCORDING TO MANUFACTURER'S RECOMMENDATIONS. SEE SPECIFICATIONS FOR FURTHER INFORMATION.
- ALL DOOR FRAMES ARE TO BE INSTALLED 4" AWAY FROM ADJACENT PERPENDICULAR WALLS UNLESS NOTED OTHERWISE.
- PROVIDE LINTEL AT ALL DOOR LOCATIONS WITHIN A MASONRY WALL. SEE SHEETS AE01 & AE11 FOR LINTEL SCHEDULE AND DOOR DIMENSIONS.
- ALL PARTITIONS TO BE TYPE Y6, UNLESS OTHERWISE NOTED.
- PROVIDE LINTEL AT ALL MASONRY DOOR LOCATIONS. REFER TO SHEET AE01 FOR ADDITIONAL INFORMATION.
- REFER TO MEP DWGS FOR ADDITIONAL SCOPE OF WORK.
- ALL FIRE EXTINGUISHERS WILL BE AT LEAST 2.5 GALLON IN SIZE.

KEYNOTES:

- FIRE EXTINGUISHER CABINET.
- RESINOUS FLOORING MANUFACTURER SHALL PROVIDE MOCK-UP OF FLOORING FINISH IN SHOWER. PROVIDE TEXTURED QUARTZ FINISH AND/OR GLASS BEAD SEALER AS NECESSARY TO MEET SLIP-RESISTANCE C.O.F. REQUIREMENTS. VA SHALL PROVIDE FINAL ACCEPTANCE OF FLOOR FINISH.
- CT-3 TO EXTEND 84" AFF IN SHOWER AND DRYING AREA. DASHED LINE INDICATED EXTENT OF CT-3 INSTALLED TO 84". INSTALL CT-3 TO 64" AFF ON ALL OTHER RESTROOM WALLS. ANY CT-3 TILE TERMINATING ON THE OUTSIDE EDGE OF A WALL, SHALL RECEIVE A METAL REGLET. SEE AE003 FOR DETAILS.
- BENCH. REFER TO LOCKER SPECIFICATION FOR INFORMATION.
- RECESSED HOSE CABINET.
- CONTINUOUS WALL PROTECTION, CRASH RAILS OR-1. REFER TO TYPICAL MOUNTING HEIGHT DETAIL ON SHEET A1700 & DETAILS ON AE003 FOR ADDITIONAL INFORMATION.

FULLY SPRINKLERED

CONSULTANTS:

WARNING: This warning is required to be included on this document under New York State Education Law, Article 145, Section 7209, Sub-Paragraph 2. It is a violation of the aforementioned law for any person, unless acting under the direction of a licensed professional engineer or land surveyor, to alter any portion of the design set forth on this document. If any item of the design set forth in this document is altered, the altering engineer or land surveyor shall affix to the item his/her seal and the notation "altered by" followed by her/his signature and the date of such alteration and a specific description of the alteration.

ARCHITECT/ENGINEERS:

HDR
Henningson, Durham & Richardson, Architecture and Engineering, P.C.
500 Seventh Ave, 11th Floor, New York, NY 10018. 212-904-1212

Drawing Title
GROUND FLOOR PARTIAL PLAN PART 03

Approved: Project Director

Project Title
**VA NY HARBOR HEALTHCARE SYSTEM
MANHATTAN CAMPUS GROUND FLOOR PHASE 1B
STERILE PROCESSING SUITE**

Location
423 E 23RD STREET, NEW YORK, NY 10010

Date	Checked	Drawn
02/18/2014	BC	PT

Project Number
219359
Building Number
6
Drawing Number
AE113

Office of
Construction
and Facilities
Management

VA U.S. Department
of Veterans Affairs