

three inches = one foot  
one and one half inches = one foot  
one inch = one foot  
three quarters inch = one foot  
one half inch = one foot  
three eighths inch = one foot  
one quarter inch = one foot  
one eighth inch = one foot

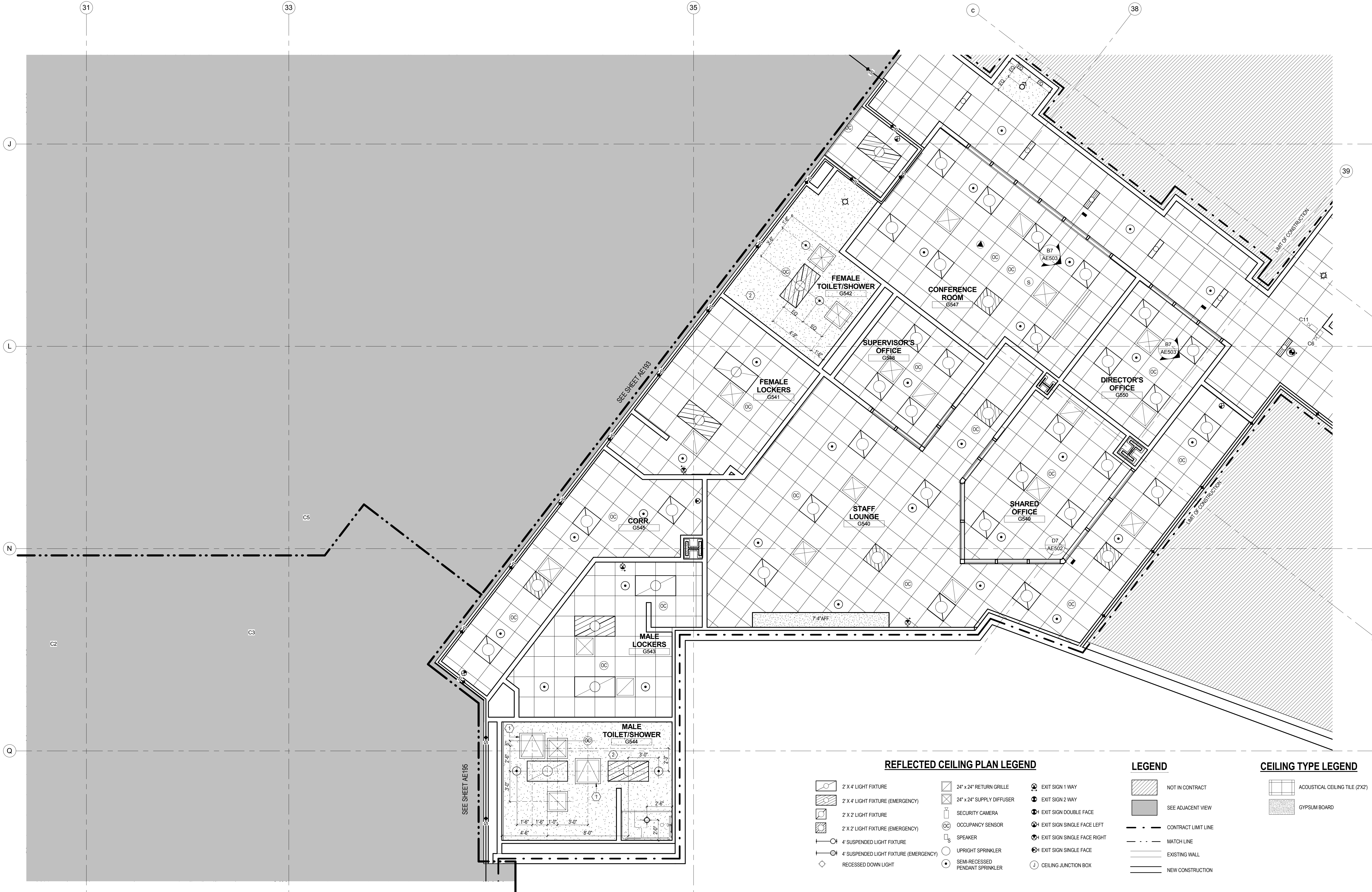

F1 GROUND FLOOR PARTIAL REFLECTED CEILING PLAN PART 04  
1/4" = 1'-0"

NO	REVISIONS	DATE
1	ADDENDUM 1 ISSUE FOR CONSTRUCTION	02/13/2015
		07/25/2014

CONSULTANTS:

WARNING: This warning is required to be included on this document under New York State Education Law, Article 145, Section 7209, Sub-Paragraph 2. It is a violation of the aforementioned law for any person, unless acting under the direction of a licensed professional engineer or land surveyor, to alter any portion of the design set forth on this document. If any item of the design set forth in this document is altered, the altering engineer or land surveyor shall affix to the item his/her seal and the notation "altered by" followed by her/his signature and the date of such alteration and a specific description of the alteration.

ARCHITECT/ENGINEERS:



Henningson, Durham & Richardson, Architecture and Engineering, P.C.  
500 Seventh Ave, 11th Floor, New York, NY 10018 · 212-904-1212

Drawing Title  
**GROUND FLOOR PARTIAL REFLECTED  
CEILING PLAN PART 04**

Approved: Project Director

Project Title  
**VA NY HARBOR HEALTHCARE SYSTEM  
MANHATTAN CAMPUS GROUND FLOOR PHASE 1B  
STERILE PROCESSING SUITE**

Location  
**423 E 23RD STREET, NEW YORK, NY 10010**

Date  
**02/18/2014**

Checked  
**BC**

Drawn  
**PT**

Project Number  
**219359**

Building Number  
**6**

Drawing Number  
**AE194**

Office of  
Construction  
and Facilities  
Management



U.S. Department  
of Veterans Affairs

KEY PLAN:

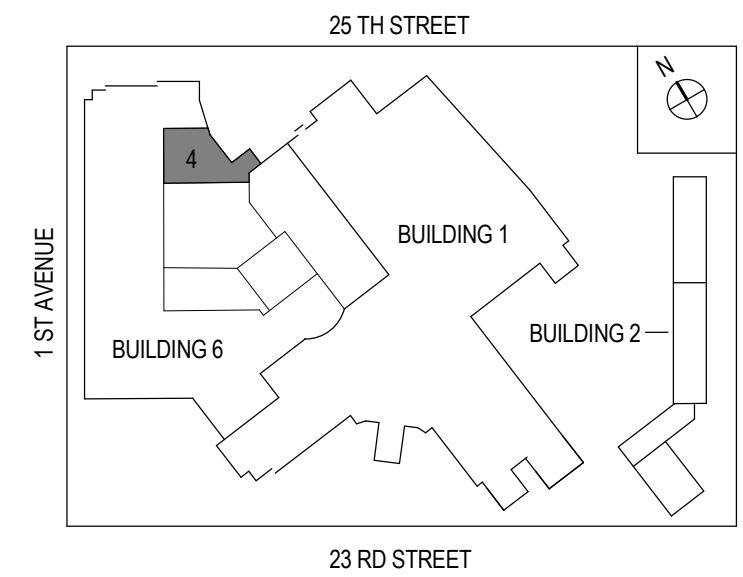

GENERAL NOTES:

1. CEILING HEIGHT IS TO BE MEASURED FROM AN ASSUMED BENCHMARK OF 0'-0" (ABOVE FINISHED FLOOR).
2. ALL RECESSED CIRCULAR LIGHTS, EXIT SIGNS, DIFFUSERS, GRILLES, AND SPRINKLER HEADS ARE TO BE CENTERED ON ACOUSTICAL CEILING TILES UNLESS OTHERWISE NOTED.
3. SEE "EL" DRAWING SERIES FOR LIGHTING FIXTURE TAGS AND TYPES.
4. THIS DRAWING IS TO BE READ IN CONJUNCTION WITH MEP DRAWINGS FOR CEILING COMPONENTS, SWITCH LOCATIONS AND SPECIFICATIONS. REFER TO ELECTRICAL DRAWINGS FOR LIGHTING FIXTURE SCHEDULE. REFER TO MECHANICAL DRAWINGS FOR DIFFUSER AND GRILLE SCHEDULE.
5. ALL CEILINGS TO BE 8'-0" A.F.F., UNLESS OTHERWISE NOTED.
6. REMOVE EXISTING BLACK IRON. PROVIDE NEW BLACK IRON FOR CEILINGS UNLESS OTHERWISE NOTED.

KEYNOTES:

1. 30"x30" ACCESS PANEL.
2. PROVIDE WATER RESISTANT GYPSUM BOARD CEILING.

FULLY SPRINKLERED