

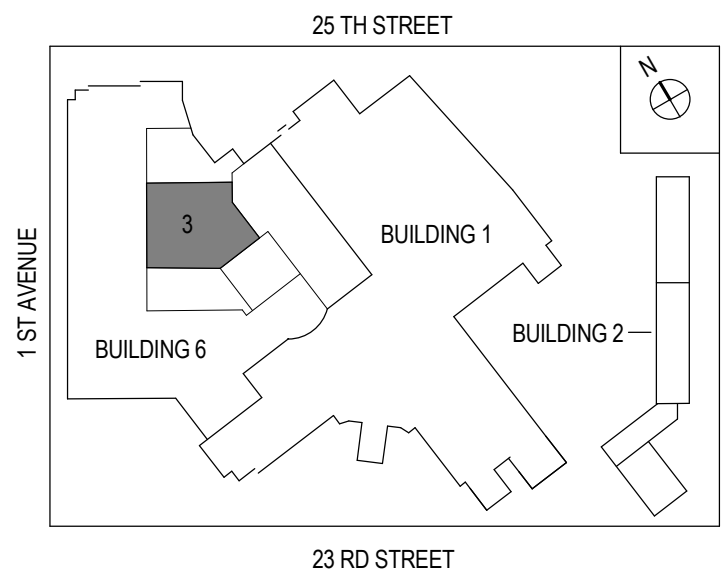

KEY PLAN:



GENERAL NOTES:

KEYNOTES:

- 1 CONTINUOUS WALL PROTECTION, CRASH RAILS CR-1, REFER TO TYPICAL MOUNTING HEIGHT DETAIL ON SHEET A700 & DETAILS ON A803 FOR ADDITIONAL INFORMATION.
- 2 FLOOR DRAIN, REFER TO PLUMBING DWGS FOR ADDITIONAL INFO.
- 3 PROVIDE FLEXIBLE HOSE CONNECTION FROM CEILING ABOVE TO TRIPLE SINKS.
- 4 PROVIDE FLEXIBLE HOSE CONNECTION FROM CEILING ABOVE TO WORKSTATIONS.

FULLY SPRINKLERED

NO	REVISIONS	DATE
1	ADDENDUM 1 ISSUE FOR CONSTRUCTION	02/13/2015
NO		07/25/2014

CONSULTANTS:

WARNING: This warning is required to be included on this document under New York State Education Law, Article 145, Section 7209, Sub-Paragraph 2. It is a violation of the aforementioned law for any person, unless acting under the direction of a licensed professional engineer or land surveyor, to alter any portion of the design set forth on this document. If any item of the design set forth in this document is altered, the altering engineer or land surveyor shall affix to the item his/her seal and the notation "altered by" followed by her/his signature and the date of such alteration and a specific description of the alteration.

ARCHITECT/ENGINEERS:

**HDR**  
Henningson, Durham & Richardson, Architecture and Engineering, P.C.  
500 Seventh Ave, 11th Floor, New York, NY 10018 · 212-904-1212

Drawing Title  
**GROUND FLOOR PARTIAL EQUIPMENT PLAN  
PART 03**

Approved: Project Director

Project Title  
**VA NY HARBOR HEALTHCARE SYSTEM  
MANHATTAN CAMPUS GROUND FLOOR PHASE 1B  
STERILE PROCESSING SUITE**

Location  
**423 E 23RD STREET, NEW YORK, NY 10010**

Date  
**02/18/2014**

Checked  
**BC**

Drawn  
**AB**

Project Number  
**219359**

Building Number  
**6**

Drawing Number  
**QH113**

Office of  
Construction  
and Facilities  
Management

**VA** U.S. Department  
of Veterans Affairs