

LEGEND

- NOT IN CONTRACT
- SEE ADJACENT VIEW
- CONTRACT LIMIT LINE
- MATCH LINE
- EXISTING WALL
- NEW CONSTRUCTION

GENERAL NOTES:

KEYNOTES:

- CONTINUOUS WALL PROTECTION, CRASH RAILS OR-1, REFER TO TYPICAL MOUNTING HEIGHT DETAIL ON SHEET A700 & DETAILS ON A653 FOR ADDITIONAL INFORMATION.

KEY PLAN:

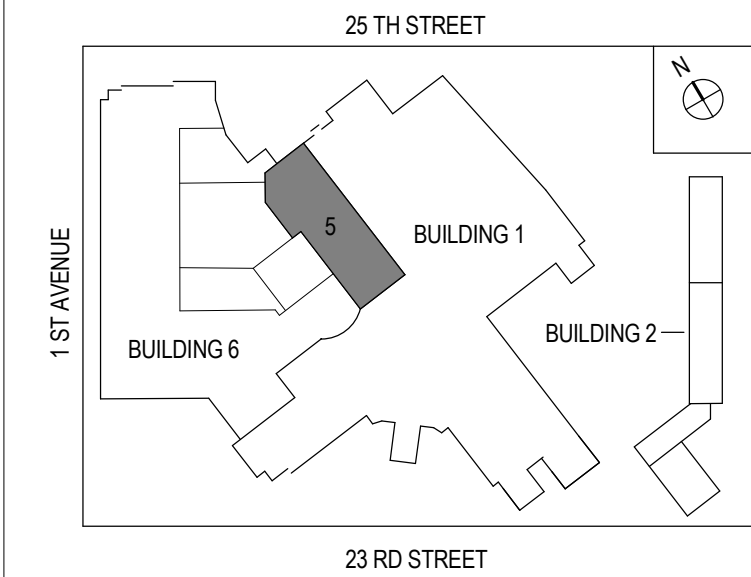

F1 GROUND FLOOR PARTIAL EQUIPMENT PLAN PART 05

CONSULTANTS:

WARNING: This warning is required to be included on this document under New York State Education Law, Article 145, Section 7209, Sub-Paragraph 2. It is a violation of the aforementioned law for any person, unless acting under the direction of a licensed professional engineer or land surveyor, to alter any portion of the design set forth on this document. If any item of the design set forth in this document is altered, the altering engineer or land surveyor shall affix to the item his/her seal and the notation "altered by" followed by her/his signature and the date of such alteration and a specific description of the alteration.

ARCHITECT/ENGINEERS:



Henningson, Durham & Richardson, Architecture and Engineering, P.C.
500 Seventh Ave, 11th Floor, New York, NY 10018 · 212-904-1212

Drawing Title

GROUND FLOOR PARTIAL EQUIPMENT PLAN
PART 05

Approved: Project Director

Project Title

VA NY HARBOR HEALTHCARE SYSTEM
MANHATTAN CAMPUS GROUND FLOOR PHASE 1B
STERILE PROCESSING SUITE

Location
423 E 23RD STREET, NEW YORK, NY 10010

Date
02/18/2014

Checked
BC

Drawn
AB

Project Number

219359

Building Number

6

Drawing Number

QH115

FULLY SPRINKLERED

Office of
Construction
and Facilities
Management



U.S. Department
of Veterans Affairs