

three inches = one foot
one and one half inches = one foot
one inch = one foot
three quarters inch = one foot
one half inch = one foot
three eighths inch = one foot
one quarter inch = one foot
one eighth inch = one foot

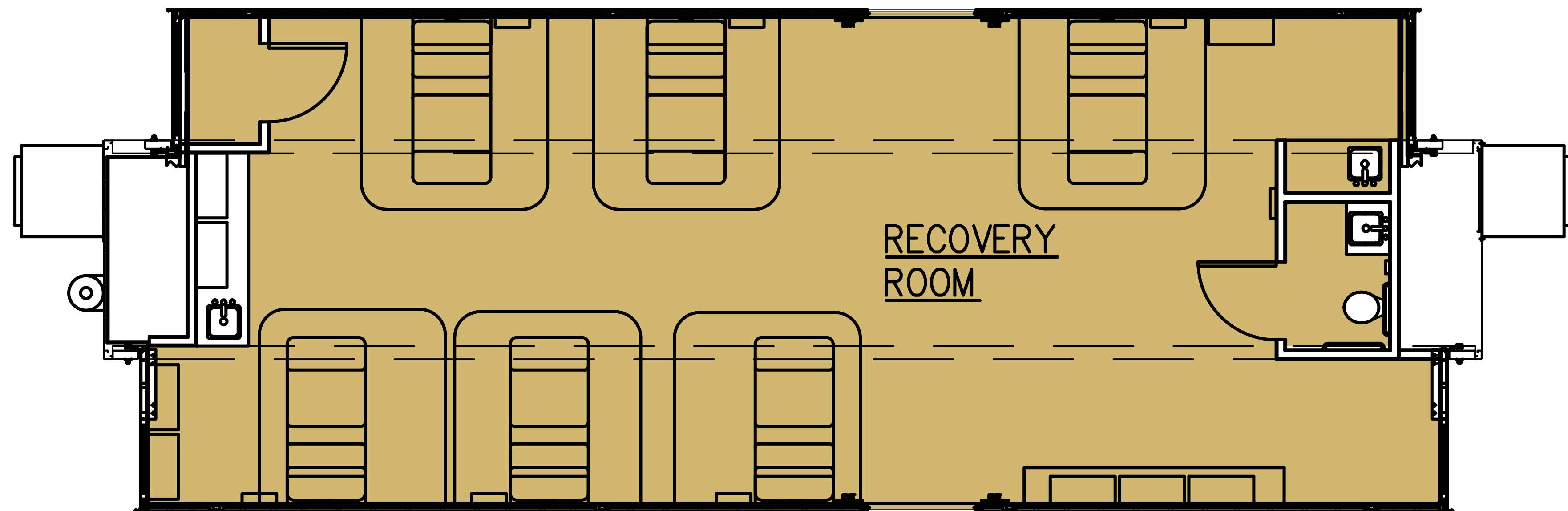
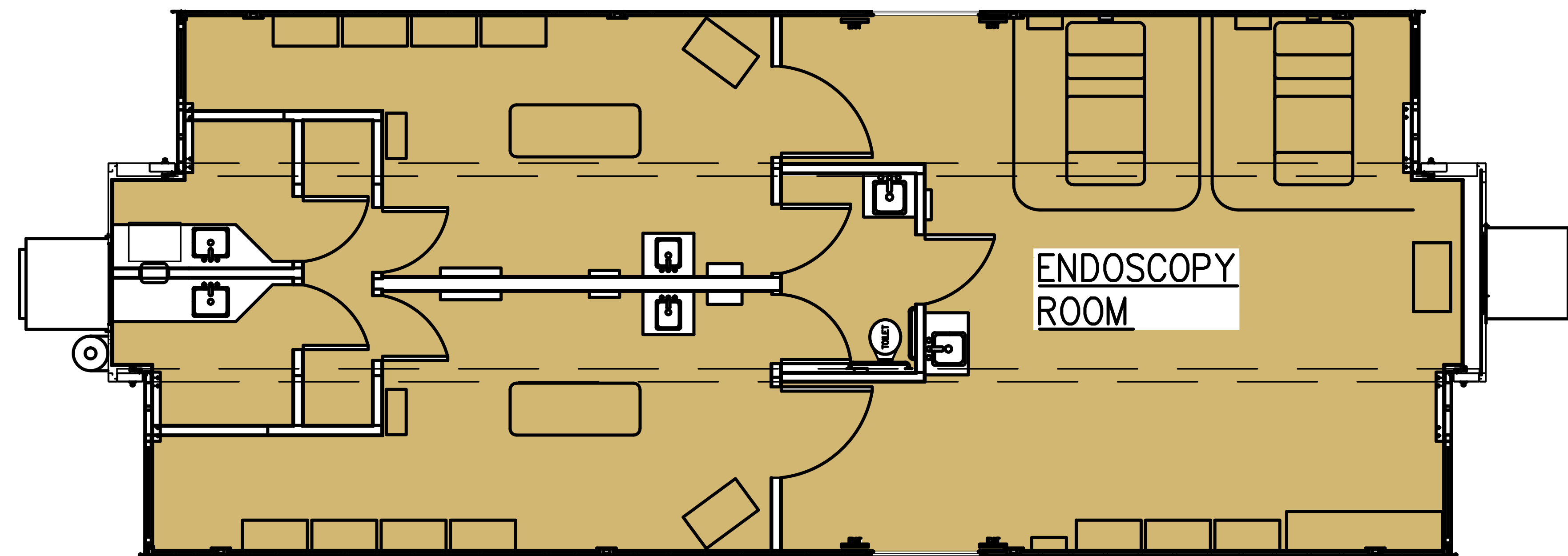
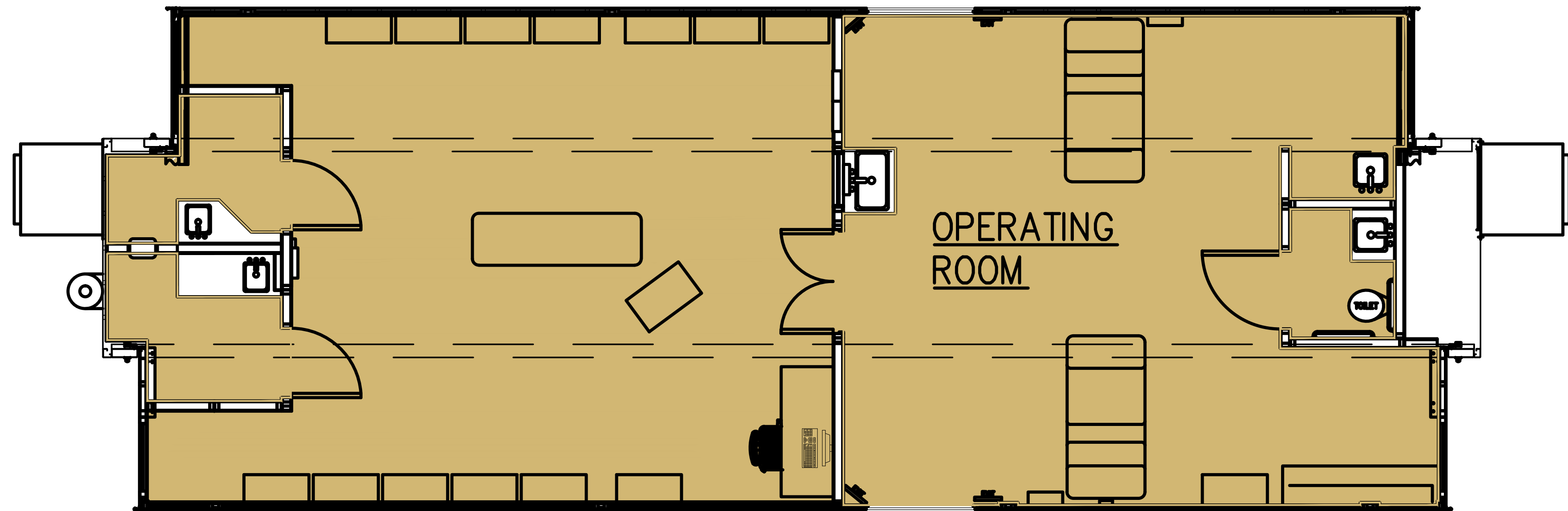

SCALE 1/8"=1'-0"

GENERAL NOTES

- Deliver materials to site in original sealed packages or containers; labeled for identification with manufacturer's name and brand.
- Deliver sheet flooring full width roll, completely enclosed in factory wrap, clearly marked with the manufacturer's number, type and color, production run number and manufacture date.
- Store materials in weathertight and dry storage facility. Protect from damage due to handling, weather, and construction operations before, during and after installation. Store sheet flooring on end with ambient temperatures maintained as recommended by manufacturer.
- Store sheet flooring on end.
- Move sheet vinyl floor coverings and installation accessories into spaces where they will be installed at least 48 hours in advance of installation.

INSTALLATION OF FLOORING

- Install work in strict compliance with manufacturer's instructions and approved layout drawings.
- Maintain uniformity of sheet vinyl floor covering direction and avoid cross seams.
- Arrange for a minimum number of seams and place them in inconspicuous and low traffic areas, but in no case less than 150 mm (6 inches) away from parallel joints in flooring substrates.
- Match edges of resilient floor coverings for color shading and pattern at seams.
- Where resilient sheet flooring abuts other flooring material floors shall finish level.
- Extend sheet vinyl floor coverings into toe spaces, door reveals
- Inform the Resident Engineer of conflicts between this section and the manufacturer's instructions or recommendations for auxiliary materials, or installation methods, before proceeding.
- Keep joints to a minimum; avoid small filler pieces or strips.
- Follow manufacturer's recommendations for seams at butt joints. Do not any open joints that would be readily visible from a standing position.
- Install sheet in full coverage adhesives.
- Follow manufacturer's recommendations regarding pattern match, if pipes and vertical projections; seal joints at pipe with waterproof cement or sealant. closets, and similar openings.
- Installation of Edge Strips:
 - Locate edge strips under center lines of doors unless otherwise indicated.
 - Set aluminum strips in adhesive, anchor with lead anchors and stainless steel Phillips screws. Seal around all edges of strips with VA approved sealant. Submit for approval.

M. Integral Cove Base Installation:

- Set preformed fillet strip to receive base.
- Install the base with adhesive, terminate expose edge with the cap strip.
- Form internal and external corners to the geometric shape generated by the cove at either straight or radius corners.
- Solvent weld joints as specified for the flooring. Seal cap strip to wall with an adhesive type sealant.
- Unless otherwise specified or shown where sheet flooring is scheduled, provide integral base at intersection of floor and vertical surfaces. Provide sheet flooring and base scheduled for room on floors and walls under and behind areas where casework, laboratory and pharmacy furniture and other equipment occurs, except where mounted in wall recesses.

GENERAL NOTES FOR EXISTING BASE, METAL PLATES AND METAL FRAMING:

Contractor may choose to incorporate existing steel base in trailers. Base is estimated not to exceed 76.2 mm (3 inches) in height. The existing base and metal plates are to be complete reinstalled. All seams, gaps and cracks are to be filled with an approved epoxy, filler or sealant. All sealants shall be submitted as a submittal by VA. All gaps created by existing metal framing within floor panels are to be completely sealed with an approved product. Number of panels per Trailer are estimated at 20.

Scale: 1/8"=1'-0"

CONSULTANTS:		ARCHITECT/ENGINEERS:		Drawing Title FLOORING INSTALLATION PLAN		Project Title REPLACE FLOORING AT APU		Project Number 629-15-101		Office of Construction and Facilities Management	
				Approved Project Director		Location 2237 Poydras, APU		Building Number			
						Date 19-Feb-2015		Drawing Number A1			
Revision								Checked		Drawn	
Date										Dep. of	