

② ARCHITECTURAL REFLECTED CEILING PLAN - LEVEL 1 ZONE B
1/8" = 1'-0"

1. THIS SHEET SHALL BE USED FOR LOCATING GRID AND GWB LAYOUT - REFER TO MECH DRAWINGS FOR ELEC. & MECH. DETAILS & SCHEDULES.
2. CONSIDER AND COORDINATE THE LOCATION OF ALL MECH., ELEC. & FIRE PROTECTION ITEMS. REFER TO MEP DESIGN.
3. THE GC IS TO FIELD VERIFY ALL DIMENSIONS AND REPORT ANY DISCREPANCIES TO THE ARCHITECT.
4. REFER TO ELEC. DRAWINGS FOR SPEAKERS, SMOKE DETECTORS, EXIT SIGNS, AND OTHER CEILING MOUNTED DEVICES.
5. ALIGN CEILING GRID WITH EXIST. WHERE NEW GRID IS NEAR OR ADJACENT TO EXIST. GRID SYSTEM.
6. CUT, PATCH, & REPAIR EXIST. CEILING AS REQUIRED TO INSTALL NEW WORK.
7. LOCATE VERTICAL FACE OF SPACE "T" FROM ADJACENT CABINET FACE OR WALL, TYP. U.N.O. SOFFITS SHALL ENCLOSE ENTIRE SPACE ABOVE UPPER CABINETS, AT 7'-0" U.N.O.
8. SEE SHEET 1-A25 FOR CEILING DETAILS.
9. ALL GWB CEILING SURFACES TO MATCH ADJACENT WALL FINISH U.N.O.
10. CEILING INSTALLER SHALL BE RESPONSIBLE FOR COORDINATING AND PROVIDING TILE PENETRATIONS WHERE REQUIRED.
11. GYPSUM CEILINGS IN SHOWER AREAS SHALL BE WATER RESISTANT.

1	EXTEND NEW DROP CEILING TO EXISTING COVE LIGHTING SOFFIT.	8	METAL PANEL SOFFIT - RE: 2/I-A19.
2	CEILING MOUNTED IV TRACK.	9	GLASS FIBER OR CEMENTIOUS HARD CEILING IN DECON STATION / STAFF TOILET
3	CEILING MOUNTED TV BRACKET BY GENERAL CONTRACTOR. RE: EQ. # 120	10	REMOVE, STORE, AND RE-INSTALL EXISTING CEILING TILE FOR INSTALLATION OF PIPING. REPLACE ANY DAMAGED TILES.
4	TIE INTO EXISTING CEILING GRID IN WAITING ROOM WHERE OCCURS.	11	CLEANROOM CEILING - REFER TO SPEC SECTION FOR DETAILS.
5	CEILING MOUNTED 600 LB PATIENT LIFT.	12	SOFFIT BY FURNISHING PROVIDER.
6	CEILING MOUNTED 1,000 LB PATIENT LIFT	13	ACCESS PANEL IN GYP. CEILING.
7	EXAM LIGHT - OWNER FURNISHED, CONTRACTOR INSTALLED	14	EXPANSION JOINT COVER

SUSPENDED 2X2 LAY IN CEILING - SEE IN SHEETS FOR CEILING TYPE
 SUSPENDED GYP BOARD CEILING
 ACCESS PANEL, COORDINATE W/ MEP DRAWINGS
 2' X 4' FLUORESCENT LIGHT FIXTURE - NORMAL
 2' X 4' FLUORESCENT LIGHT FIXTURE - EMERGENCY
 2' X 2' FLUORESCENT LIGHT FIXTURE - NORMAL
 2' X 2' FLUORESCENT LIGHT FIXTURE - EMERGENCY
 1' X 4' FLUORESCENT STRIP FIXTURE - NORMAL
 1' X 4' FLUORESCENT STRIP FIXTURE - EMERGENCY
 PENDANT FIXTURE/RECESSED FIXTURE
 OCCUPANCY SENSORS
 SPEAKER
 NURSE CALL DOME LIGHT
 FIRE DETECTOR
 SPRINKLER
 EXIT SIGN
 CEILING DIFFUSER
 LINEAR DIFFUSER, CENTER BETWEEN MULLIONS
 CU. TRACK
 PROJECTION MOUNT
 CLOSED CIRCUIT CAMERA

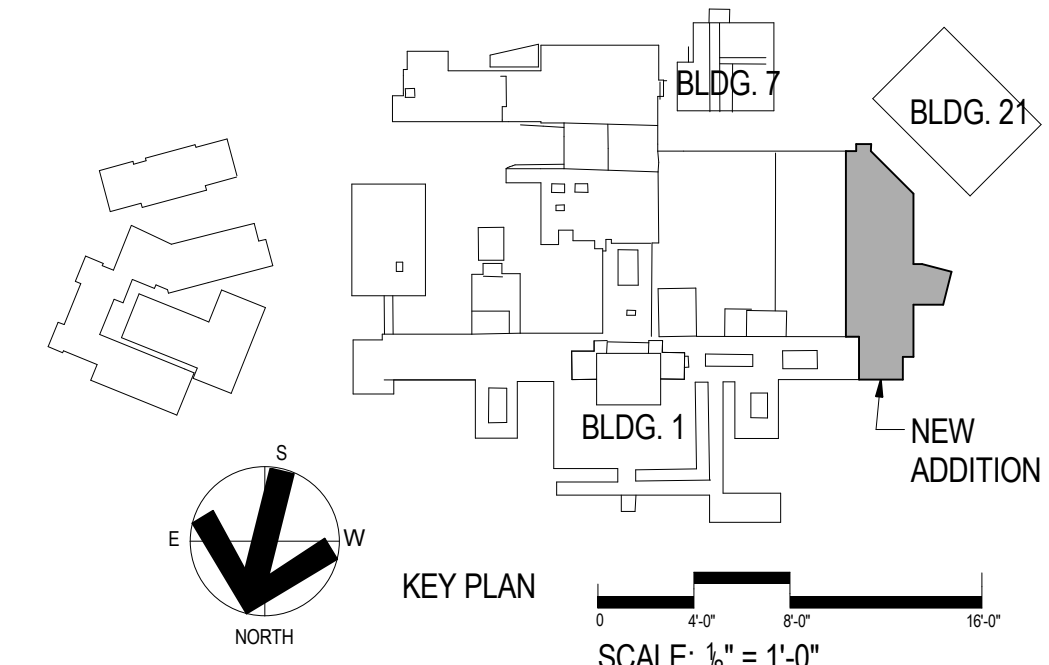

1 ARCHITECTURAL REFLECTED CEILING PLAN - LEVEL 1 ZONE A
1/8" = 1'-0"

---		---		---		
---		---		---		
---		---		---		
---		---		---		
---		---		---		
---		---		---		
---		---		---		
---		---		---		
Revisions	Date	Revisions	Date	Revisions	Date	

HEERY design
Heery International Inc.
125 South Dubuque Street,
Suite 500,
Iowa City, IA 52240-4003
319.354.4700

Drawing Title	<p>ARCHITECTURAL REFLECTED CEILING PLAN LEVEL 1</p>
<p>CONSTRUCTION DOCUMENTS</p>	

Building No. BLDG 1	Checked MM	Drawn RD
Location ICVA HEALTH CARE SYSTEM		

DRAWING NO.
1-A11

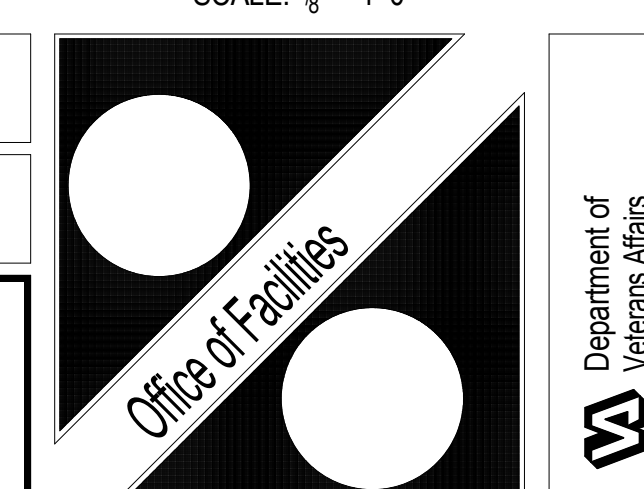

Department of
Veterans Affairs