

11

HALF HEIGHT WALL BASE PLATE

6" = 1'-0"

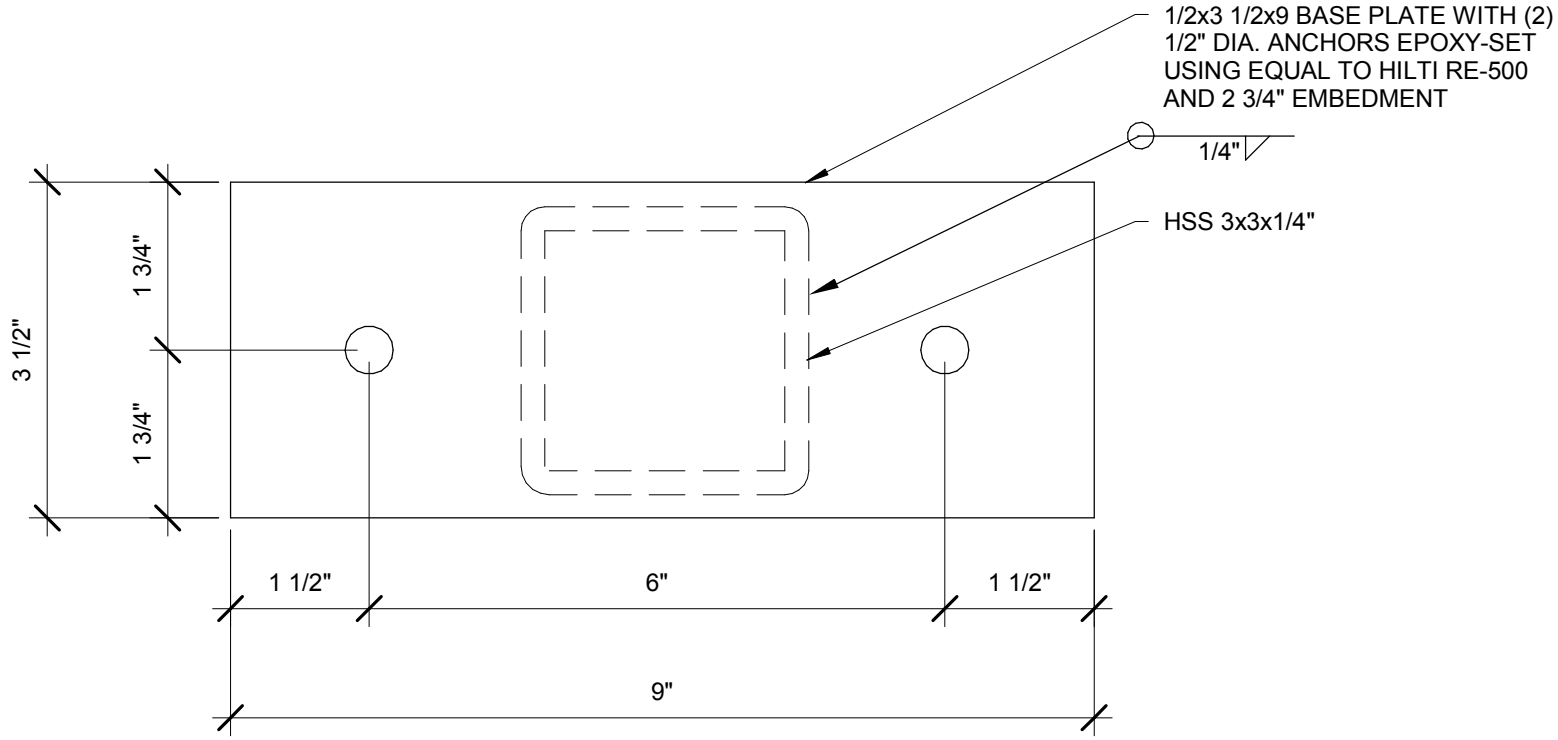

RENOVATE AND EXPAND SPACE FOR PATIENT SUPPORT AREAS

IOWA CITY VA HEALTH CARE SYSTEM
IOWA CITY, IOWA

DATE	03/06/2015	SCALE	As indicated	Book #	2-A27
DRAWN	EAS	FIELD BOOK			
APPROVED	Approver	REFERENCE DRAWING			

PROJECT NO.
110240-0

ISSUED FOR
ADD 2

SD-5

SHIVEHATTERY
ARCHITECTURE + ENGINEERING

Iowa | Illinois | Indiana | Missouri <http://www.shive-hattery.com>