

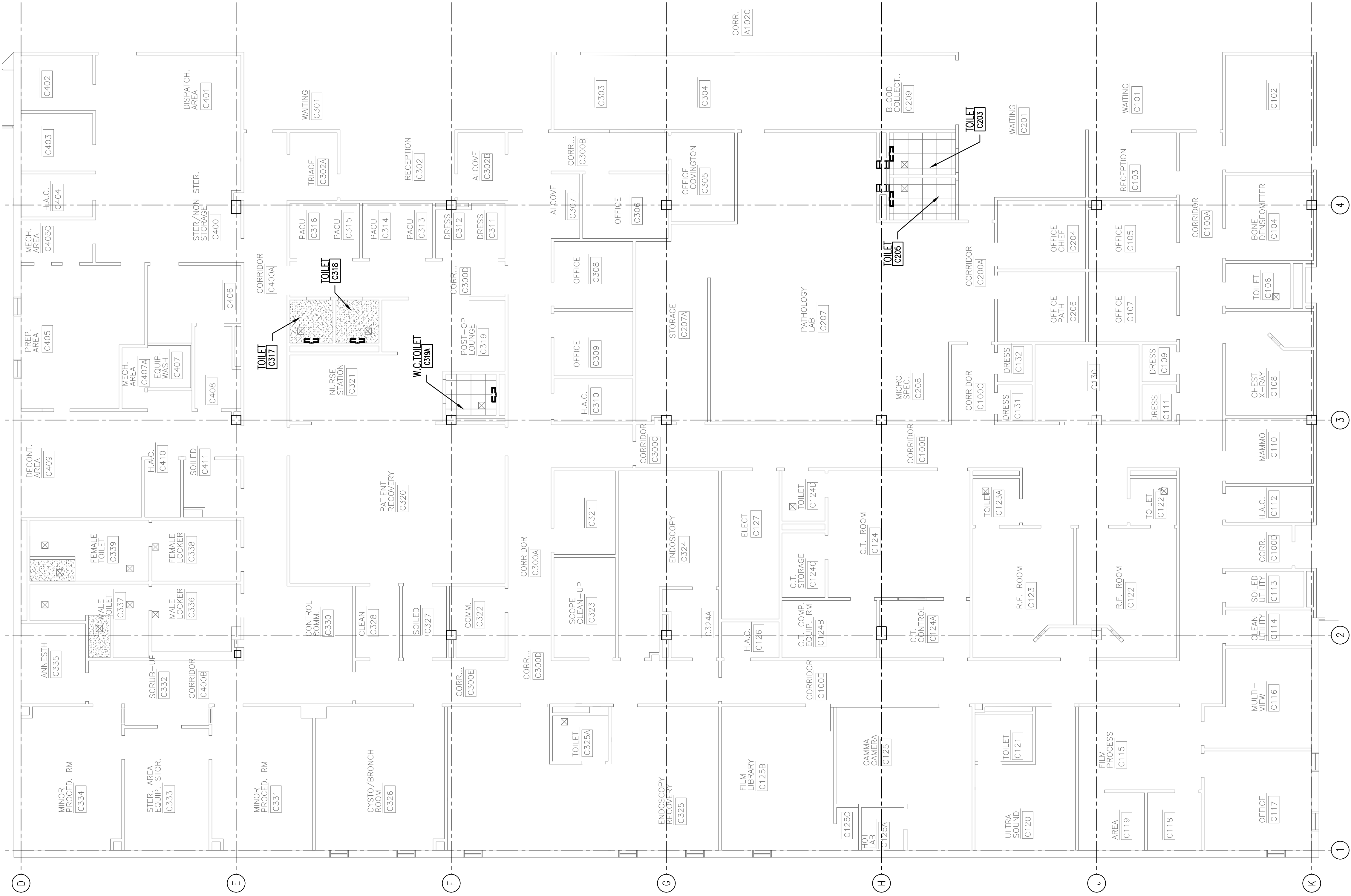

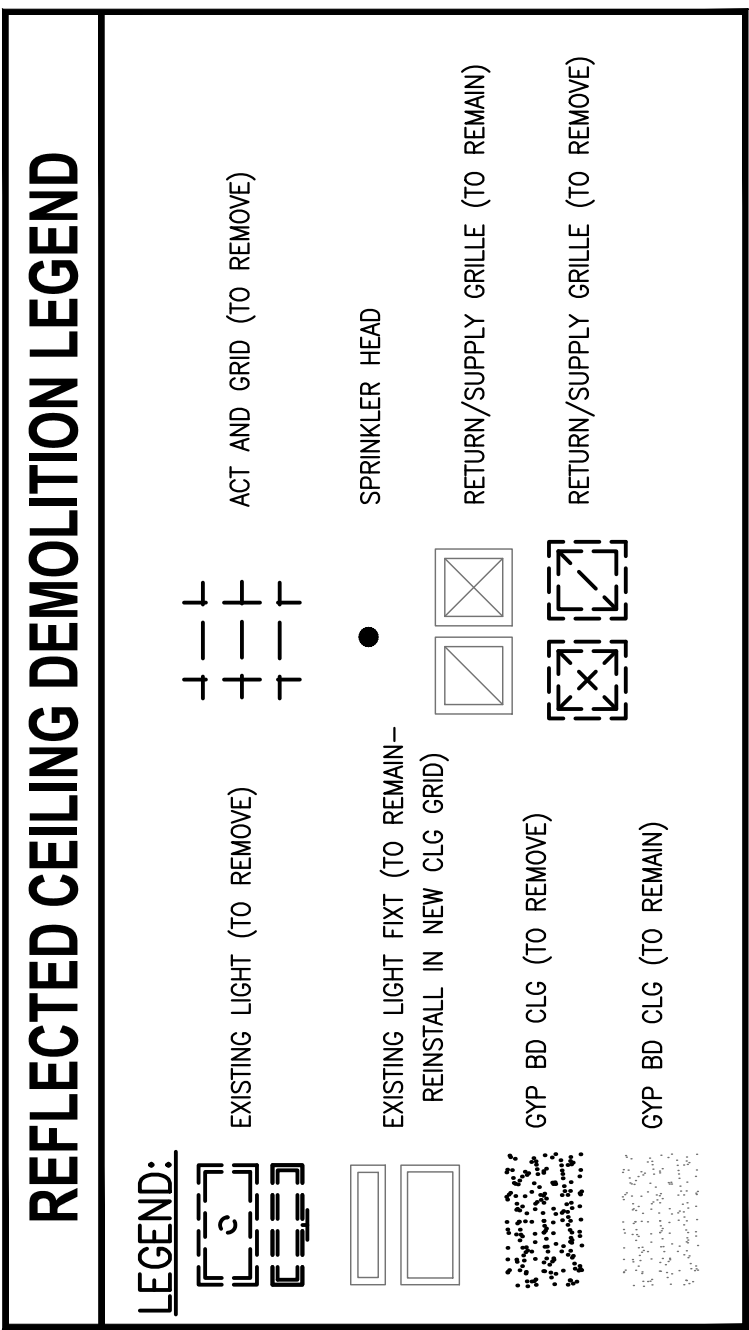

- ### DEMOLITION PLAN GENERAL NOTES - RESTROOMS, LOCKER ROOMS, AND SHOWER STALLS
1. REMOVE FLUORESCENT TRUFFERS. REFER TO ELECTRICAL DRAWINGS.
  2. REMOVE WALL-MOUNTED LIGHT FIXTURES. REFER TO ELECTRICAL DRAWINGS.
  3. REMOVE PLUMBING FIXTURES. REFER TO PLUMBING DRAWINGS.
  4. EXISTING SPRINKLER HEADS AND PIPING TO REMAIN. REFER TO FIRE PROTECTION DRAWINGS.
  5. SUSPENDED ACoustICAL TILE CEILING GRID TO REMAIN. REMOVE CEILING TILES. REMOVE, SALVAGE AND REPLACE GRID AS REQUIRED TO INSTALL LIGHT FIXTURES. GRID DAMAGED DURING CONSTRUCTION SHALL BE REPLACED BY THE CONTRACTOR AT NO ADDITIONAL EXPENSE TO THE GOVERNMENT.
  6. VENT GRILLS, SUPPLY DIFFUSERS AND RETURN REGISTERS SHALL REMAIN. WASH AND CLEAN ALL GRILLS, DIFFUSERS, AND REGISTERS IN THE CONSTRUCTION AREAS.
  7. REMOVE AND SALVAGE TOILET PARTITIONS, URINAL SODENS AND TOILET ACCESSORIES FOR REINSTALLATION. REPLACE MOUNTING AND DOOR HARDWARE. REFER TO EXISTING TOILET ACCESSORY SCHEDULE. REFER TO SHEET A601.
  8. REMOVE 18" X 24" MIRRORS. REFER TO EXISTING TOILET ACCESSORY SCHEDULE. REFER TO SHEET A601.
  9. REMOVE CERAMIC TILE WANSOT IN ALL ROOMS INCLUDING: A601, A602, A601A, A602A, A107, A108, A109, A110, B103, B117, B120, B215A, B220A, B313, B317, B319, B401, B402, B403, C106, C122A, C123A, C124OC203, C205, C317, C318, C337, C339, D110, D111, D224A104, E105, E120, E131, E314, AND E603. FIELD VERIFY EXISTING CONDITIONS.
  10. REMOVE THIN-SET CERAMIC TILE FLOORING AND CERAMIC TILE BASE IN LOCKER ROOMS A601 AND A602, REST ROOMS A302, C106, C122A, C123A, C124D, C317, C318, C319A, D208 AND D224A.
  11. REMOVE THICKSET CERAMIC FLOOR TILE, MUD BASE, AND CERAMIC WALL BASE TILE IN RESTROOMS A601A, A602A, B408, C337 AND C339.
  12. REMOVE VINYL COMPOSITION TILE AND CERAMIC TILE BASE IN RESTROOMS A107, A108, A109, A110, A302, B401, B408, B409, C203 AND C205. FIELD VERIFY EXISTING CONDITIONS.
  13. REMOVE VINYL COMPOSITION TILE AND RUBBER BASE IN LOCKER ROOMS 336 AND 339, RESTROOMS B102, B103, B117, B119, B129, B215A, B220A, B313, B317, B319, C121, C325A, D110, D111, D224A, E104, E105, E120, E314 AND E603. FIELD VERIFY EXISTING CONDITIONS.



1 DEMOLITION REFLECTED CEILING PLAN - AREA C  
1/8" = 1'-0"

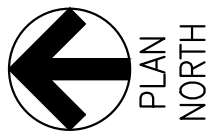

0' 4' 8' 16' 24'  
SCALE: 1/8"=1'-0"

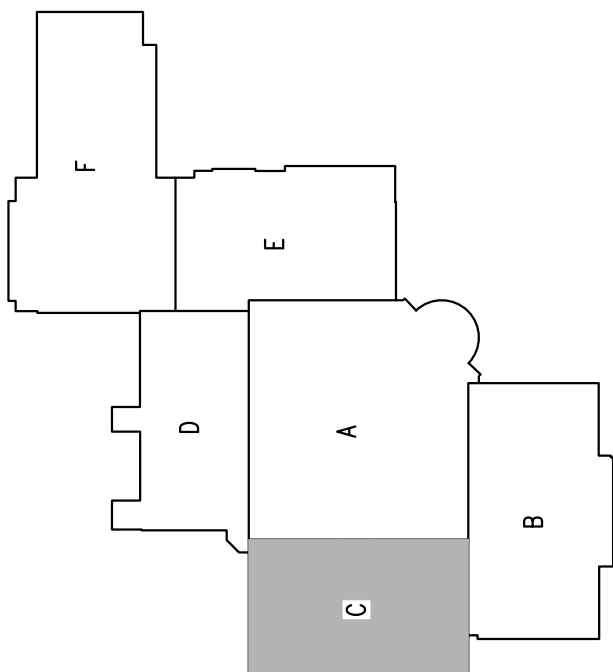

CORPORATE OFFICE 590 Means St., NW, Ste. 200 Atlanta, GA 30318 404.214.9774					
Drawing Title <b>DEMOLITION REFLECTED CEILING PLAN - AREA C</b>		Project Title <b>UPGRADE RESTROOMS AND INTERIOR FINISHES-VIERA OPC</b>		Date 11-14-2014	
Approved Project Engineer		Building Number Checked		Project No. 675-13-151	
		Drawn		DRAWING NO. AD113	
		Location VIERA, FL		Dwg. XX OF XX	
				Veterans Administration	











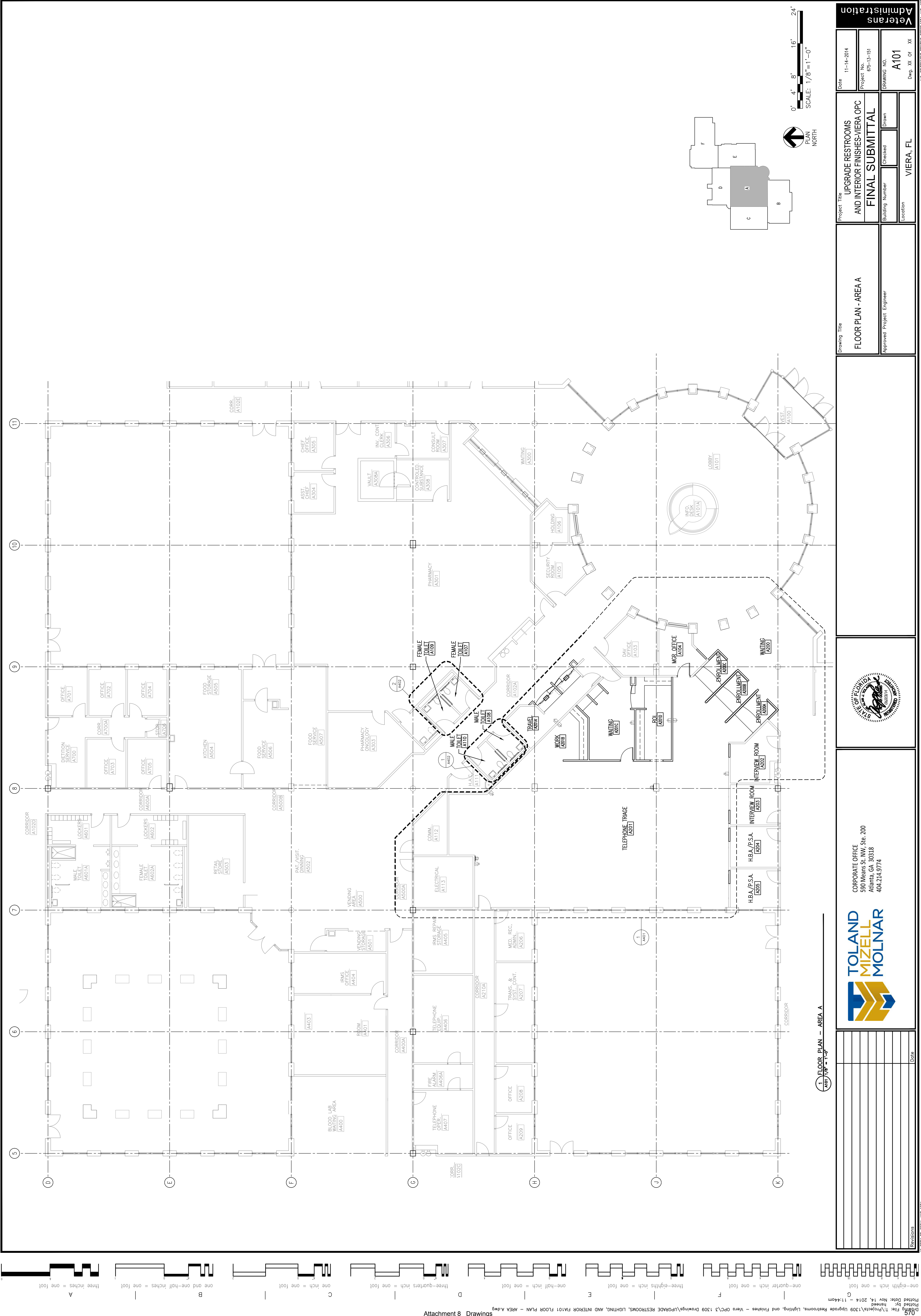

<b>Project Title</b> UPGRADE RESTROOMS AND INTERIOR FINISHES-VIERA OPC <b>FINAL SUBMITTAL</b>		<b>Drawing Title</b> FLOOR PLAN - AREA A		<b>Date</b> 11-14-2014	
<b>Building Number</b> VIERA, FL		<b>Checked</b> [Signature]		<b>Project No.</b> 675-13-151	
<b>Approved Project Engineer</b>		<b>Drawn</b> [Signature]		<b>DRAWING NO.</b> A101	
<b>Location</b> VIERA, FL		<b>Drawn</b> [Signature]		<b>U.S. GOVERNMENT PRINTING OFFICE:1984-440-467</b>	

**Corporate Office**  
590 Means St., NW, Ste. 200  
Atlanta, GA 30318  
404.214.9774

**TOLAND MIZELL MOLNAR**

**STATE OF FLORIDA**  
[Seal]

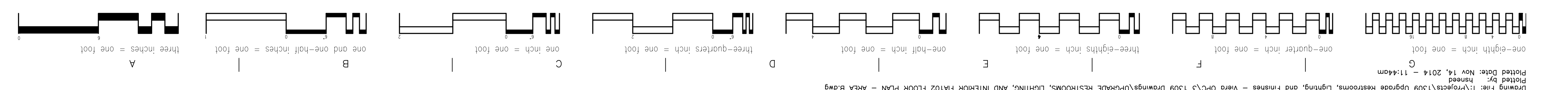

Attachment 8\_Drawings  
Combined Final\_ 675-13-151

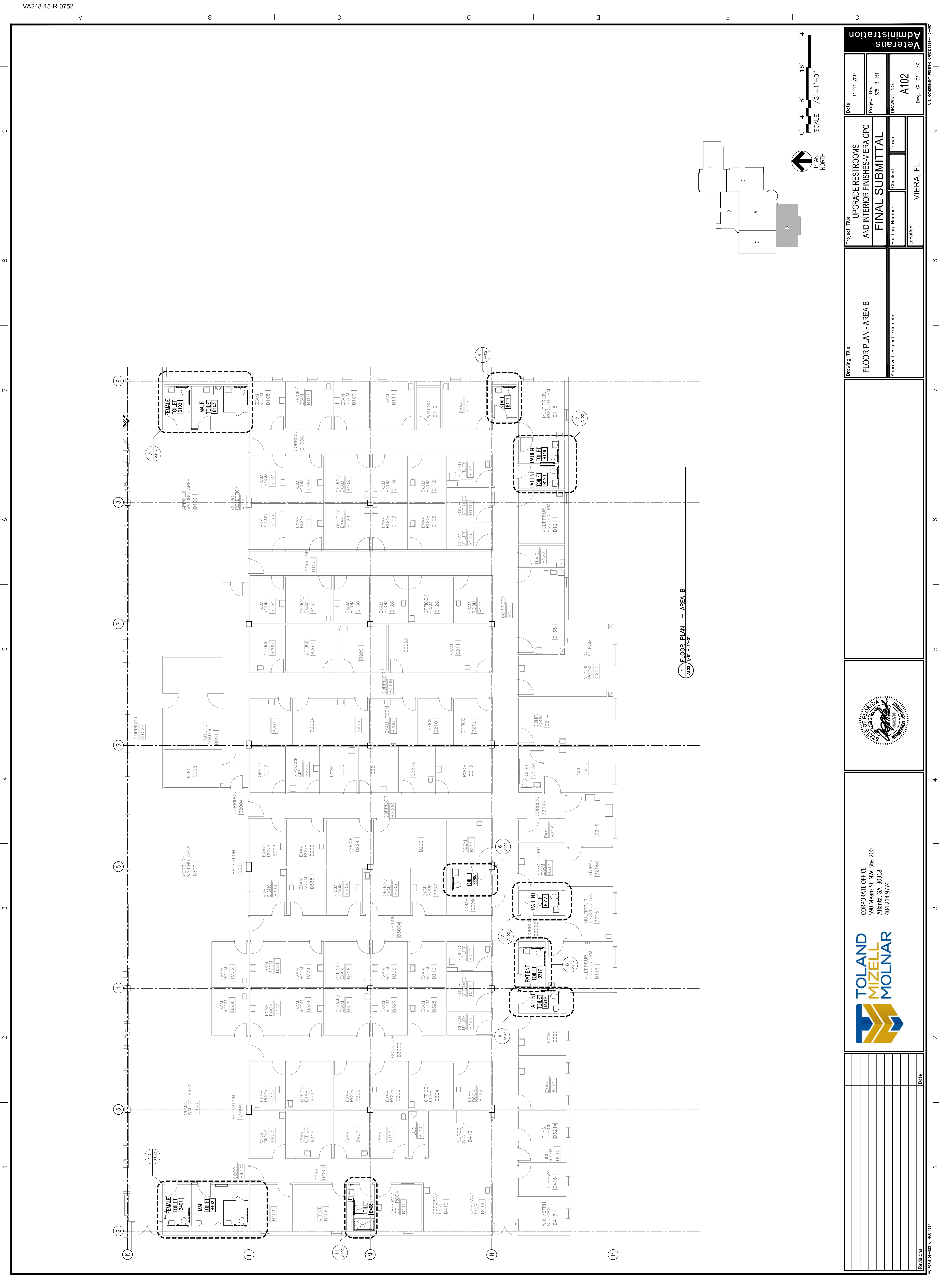

	<p><b>TOLAND MIZELL MOLNAR</b></p> <p>CORPORATE OFFICE 590 Means St. NW, Ste. 200 Atlanta, GA 30318 404.214.9774</p>	<p><b>Veterans Administration</b></p> <p>UPGRADE RESTROOMS AND INTERIOR FINISHES-VIERA OPC</p> <p><b>FINAL SUBMITTAL</b></p> <p>Building Number: _____ Checked: _____ Drawn: _____</p> <p>Location: <b>VIERA, FL</b></p>	<p>Date: 11-14-2014</p>
			<p>Project No: 675-13-151</p>
			<p>DRAWING NO. <b>A102</b></p>
			<p>Dwg. XX Of XX</p>

Revisions	Date



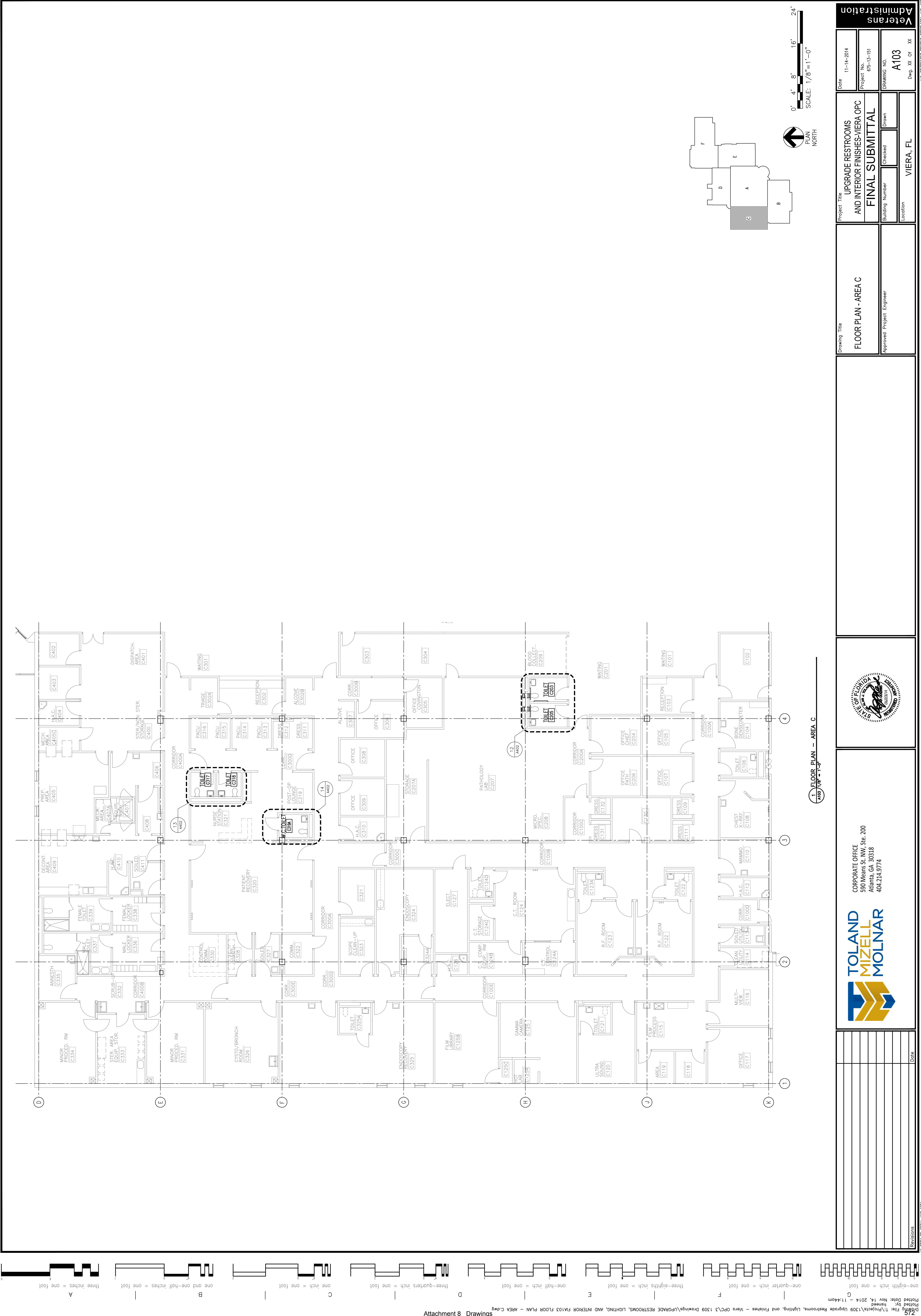

one-eighth inch = one foot		Plotting File: T:\Projects\1308 Upgrade\1308.dwg		Plot Date: Nov 14, 2014 - 11:44:06		Page 6	
						Revisions	
						Date	



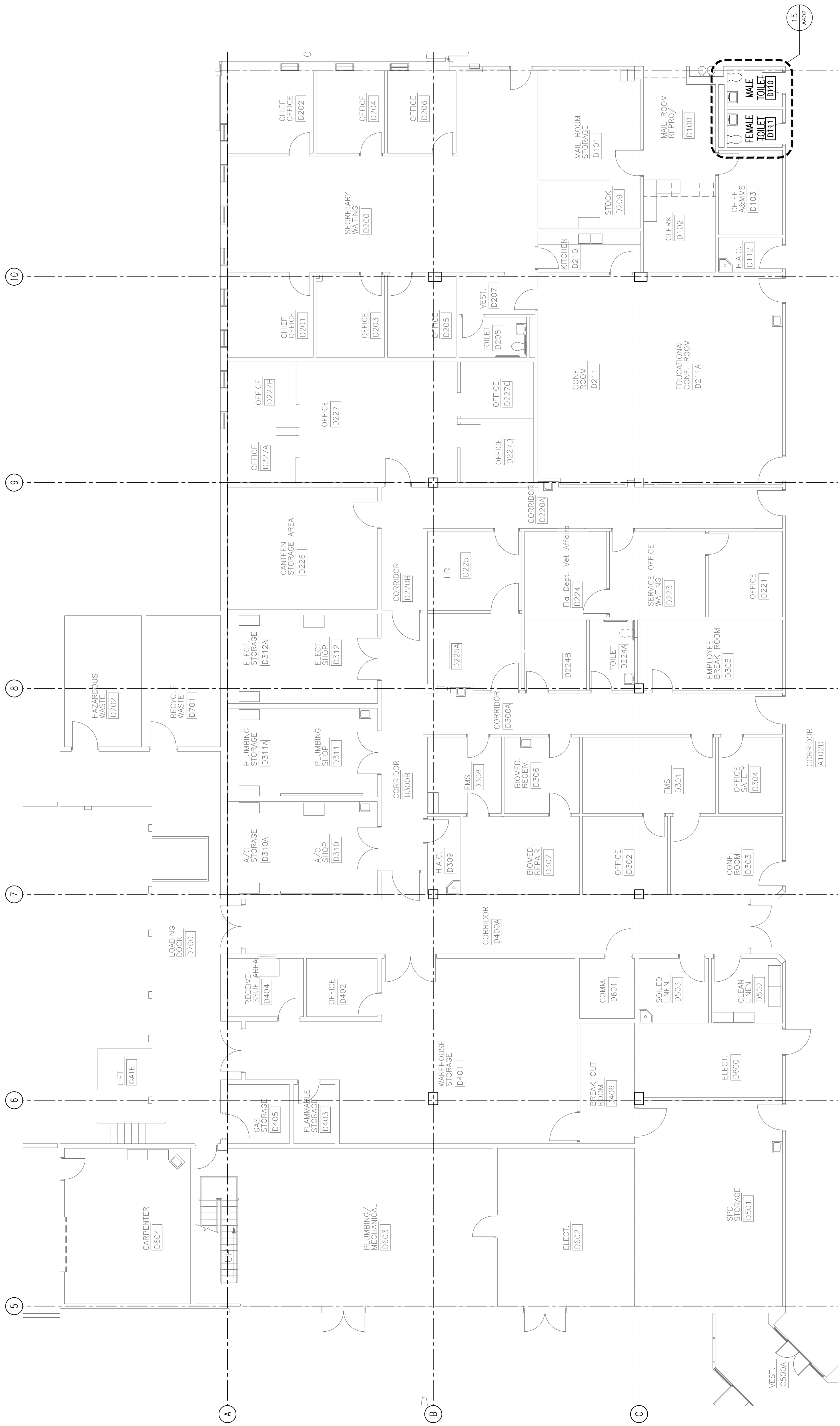

$$\frac{1}{A104} \text{ FLOOR PLAN - AREA D}$$

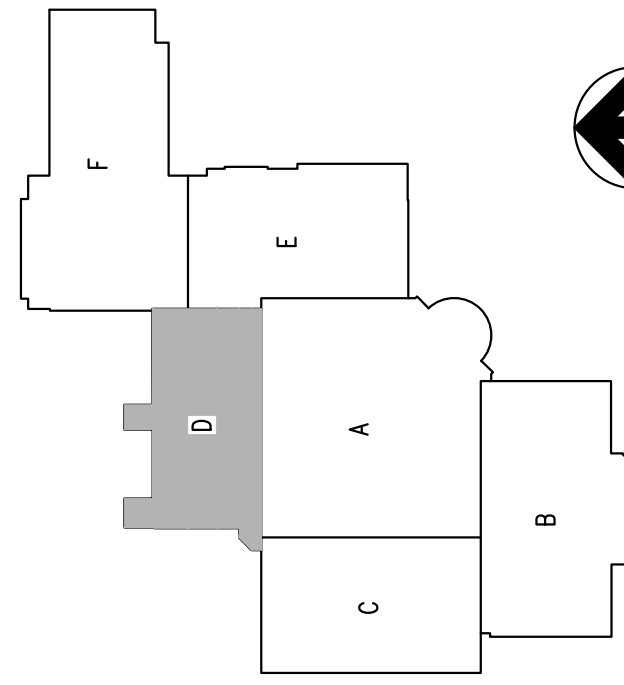

0' 4' 8' 16' 24'

SCALE: 1/8"=1'-0"

[illegible]



