

three inches = one foot
6"

one and one half inches = one foot
6"

one inch = one foot
6"

three quarters inch = one foot
6"

one half inch = one foot
6"

three eighths inch = one foot
6"

one quarter inch = one foot
6"

one eighth inch = one foot
6"

VA FORM 08-6231

CONSULTANTS:
H.F. LENZ COMPANY
1407 Scalp Avenue Johnstown, PA 15904
Phone: 814-269-9300 FAX: 814-269-9301
cadd@hflenz.com www.hflenz.com
Engineers • Planners • Surveyors • Energy Consultants

ARCHITECT/ENGINEERS:
**architecture
planning
interior design**
IKM Incorporated
One PPG Place
Pittsburgh, PA 15222
412-281-1337
www.ikminc.com

Drawing Title
**Partial Fourth Floor New
Work Plan**

Approved: Project Director

Project Title
**Clarksburg VAMC Fourth Floor B
Acute Inpatient Mental Health
Lock Down Conversion**

Location
VAMC Clarksburg West Virginia

Date
March 13, 2015

Checked

Drawn

VA Project Number
540-11-106
IKM Project Number
11-024.1
Building Number
Drawing Number
AS100
Dwg. of

Office of
Construction and
Facilities
Management

Department of
Veterans Affairs

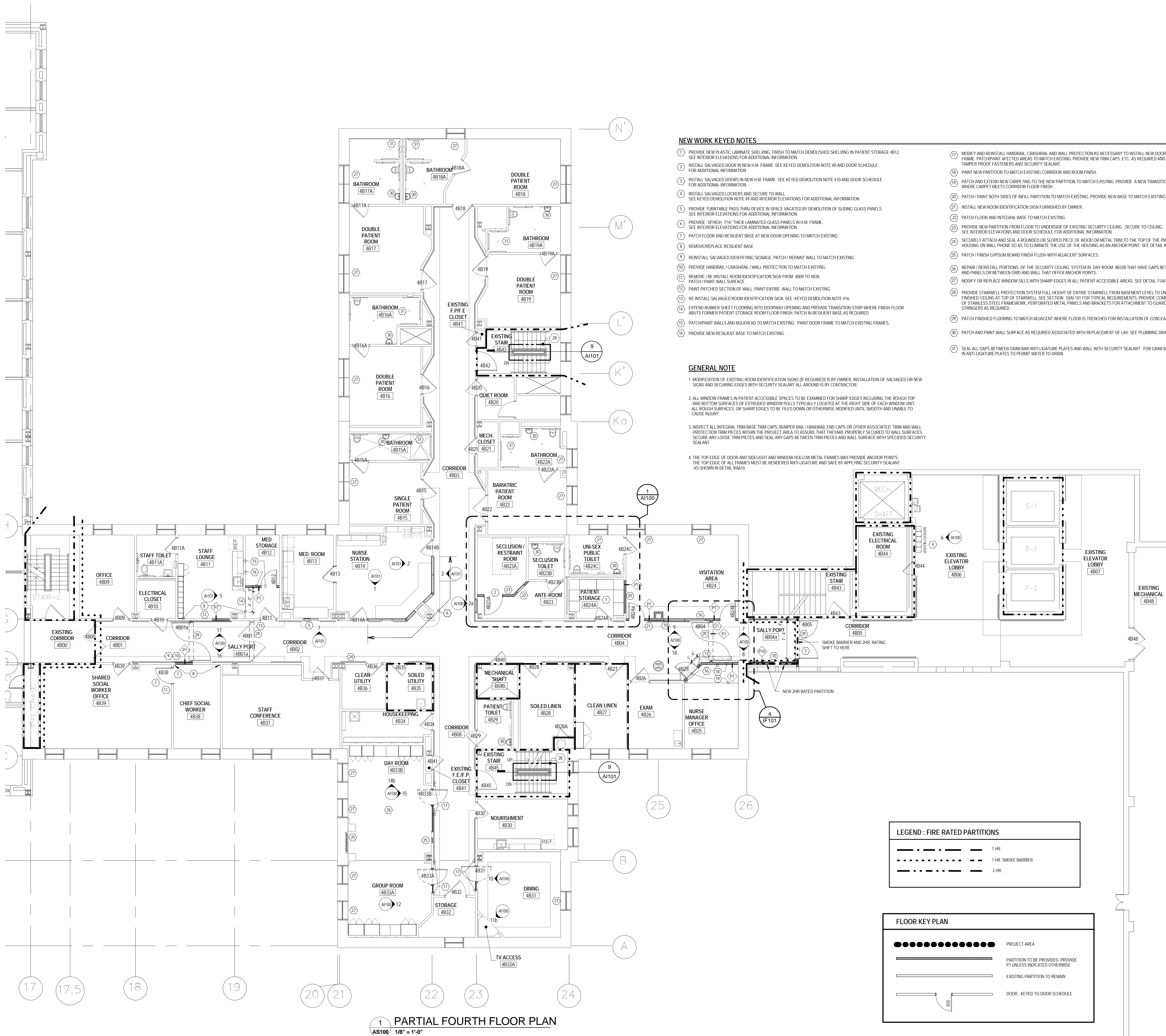

NEW WORK KEYED NOTES

1. PROVIDE NEW PLASTIC LAMINATE SHELVING TO MATCH DEMOLISHED SHELVING IN PATIENT STORAGE 4B12. SEE INTERIOR ELEVATIONS FOR ADDITIONAL INFORMATION.
2. INSTALL SALVAGED DOOR IN NEW H.M. FRAME. SEE KEYED DEMOLITION NOTE #8 AND DOOR SCHEDULE FOR ADDITIONAL INFORMATION.
3. INSTALL SALVAGED DOORS IN NEW H.M. FRAME. SEE KEYED DEMOLITION NOTE #10 AND DOOR SCHEDULE FOR ADDITIONAL INFORMATION.
4. INSTALL SALVAGED LOCKERS AND SECURE TO WALL. SEE KEYED DEMOLITION NOTE #9 AND INTERIOR ELEVATIONS FOR ADDITIONAL INFORMATION.
5. PROVIDE TURNABLE PASS-THRU DEVICE IN SPACE VACATED BY DEMOLITION OF SLIDING GLASS PANELS. SEE INTERIOR ELEVATIONS FOR ADDITIONAL INFORMATION.
6. PROVIDE 18" HIGH 7/16" THICK LAMINATED GLASS PANELS IN H.M. FRAME. SEE INTERIOR ELEVATIONS FOR ADDITIONAL INFORMATION.
7. PATCH FLOOR AND RESILIENT BASE AT NEW DOOR OPENING TO MATCH EXISTING.
8. REMOVE/REPLACE RESILIENT BASE.
9. REINSTALL SALVAGED IDENTIFYING SIGNAGE. PATCH / REPAINT WALL TO MATCH EXISTING.
10. PROVIDE HANDRAIL / CRASHRAIL / WALL PROTECTION TO MATCH EXISTING.
11. REMOVE / RE-INSTALL ROOM IDENTIFICATION SIGN FROM 4B09 TO 4B38. PATCH / PAINT WALL SURFACE.
12. PAINT PATCHED SECTION OF WALL. PAINT ENTIRE WALL TO MATCH EXISTING.
13. RE-INSTALL SALVAGED ROOM IDENTIFICATION SIGN. SEE KEYED DEMOLITION NOTE #16.
14. EXTEND RUBBER SHEET FLOORING INTO DOORWAY OPENING AND PROVIDE TRANSITION STRIP WHERE FINISH FLOOR ABUTS FORMER PATIENT STORAGE ROOM FLOOR FINISH. PATCH IN RESILIENT BASE AS REQUIRED.
15. PATCH PAINT WALLS AND BULKHEAD TO MATCH EXISTING. PAINT DOOR FRAME TO MATCH EXISTING FRAMES.
16. PROVIDE NEW RESILIENT BASE TO MATCH EXISTING.
17. MODIFY AND REINSTALL HANDRAIL, CRASHRAIL AND WALL PROTECTION AS NECESSARY TO INSTALL NEW DOOR, WINDOW AND FRAME. PATCH / PAINT PATCHED AREAS TO MATCH EXISTING. PROVIDE NEW TRIM CAPS, ETC. AS REQUIRED AND SECURE WITH TAMPER PROOF FASTENERS AND SECURITY SEALANT.
18. PAINT NEW PARTITION TO MATCH EXISTING CORRIDOR AND ROOM FINISH.
19. PATCH AND EXTEND NEW CARPETING TO THE NEW PARTITION TO MATCH EXISTING. PROVIDE A NEW TRANSITION STRIP WHERE CARPET MEETS CORRIDOR FLOOR FINISH.
20. PATCH / PAINT BOTH SIDES OF INFILL PARTITION TO MATCH EXISTING. PROVIDE NEW BASE TO MATCH EXISTING.
21. INSTALL NEW ROOM IDENTIFICATION SIGN FURNISHED BY OWNER.
22. PATCH FLOOR AND INTEGRAL BASE TO MATCH EXISTING.
23. PROVIDE NEW PARTITION FROM FLOOR TO UNDERSIDE OF EXISTING SECURITY CEILING. SECURE TO CEILING. SEE INTERIOR ELEVATIONS AND DOOR SCHEDULE FOR ADDITIONAL INFORMATION.
24. SECURELY ATTACH AND SEAL A ROUNDED OR SLOPED PIECE OF WOOD OR METAL TRIM TO THE TOP OF THE PROJECTING HOUSING ON WALL PHONE SO AS TO ELIMINATE THE USE OF THE HOUSING AS AN ANCHOR POINT. SEE DETAIL W4800.
25. PATCH / FINISH GYPSUM BOARD FINISH FLUSH WITH ADJACENT SURFACES.
26. REPAIR / REINSTALL PORTIONS OF THE SECURITY CEILING SYSTEM IN DAY ROOM 4B38B THAT HAVE GAPS BETWEEN THE GRID AND PANELS OR BETWEEN GRID AND WALL THAT OFFER ANCHOR POINTS.
27. MODIFY OR REPLACE WINDOW SILLS WITH SHARP EDGES IN ALL PATIENT ACCESSIBLE AREAS. SEE DETAIL 11A101 FOR NEW EDGE PROFILE.
28. PROVIDE STAIRWELL PROTECTION SYSTEM FULL HEIGHT OF ENTIRE STAIRWELL FROM BASEMENT LEVEL TO UNDERSIDE OF FINISHED CEILING AT TOP OF STAIRWELL. SEE SECTION 10A1101 FOR TYPICAL REQUIREMENTS. PROVIDE COMPLETE SYSTEM OF STAINLESS STEEL FRAMEWORK, PERFORATED METAL PANELS AND BRACKETS FOR ATTACHMENT TO GUARDRAILS AND STAIR STRINGERS AS REQUIRED.
29. PATCH / FINISH FLOORING TO MATCH ADJACENT WHERE FLOOR IS TRENCHED FOR INSTALLATION OF CONCEALED DOOR CLOSERS.
30. PATCH AND PAINT WALL SURFACE AS REQUIRED ASSOCIATED WITH REPLACEMENT OF LAV. SEE PLUMBING DRAWINGS FOR ADDITIONAL INFORMATION.
31. SEAL ALL GAPS BETWEEN GRAB BAR ANTI-LIGATURE PLATES AND WALL WITH SECURITY SEALANT. FOR GRAB BARS IN SHOWERS, DRILL HOLES IN ANTI-LIGATURE PLATES TO PERMIT WATER TO DRAIN.

GENERAL NOTE

1. MODIFICATION OF EXISTING ROOM IDENTIFICATION SIGNS (IF REQUIRED) IS BY OWNER. INSTALLATION OF SALVAGED OR NEW SIGNS AND SECURING EDGES WITH SECURITY SEALANT ALL AROUND IS BY CONTRACTOR.
2. ALL WINDOW FRAMES IN PATIENT ACCESSIBLE SPACES TO BE EXAMINED FOR SHARP EDGES INCLUDING THE ROUGH TOP AND BOTTOM SURFACES OF EXISTING WINDOW WALLS TYPICALLY LOCATED AT THE RIGHT SIDE OF EACH WINDOW UNIT. ALL ROUGH SURFACES OR SHARP EDGES TO BE FILED DOWN OR OTHERWISE MODIFIED UNTIL SMOOTH AND UNABLE TO CAUSE INJURY.
3. INSPECT ALL INTEGRAL TRIM BASE TRIM CAPS, BUMPER RAIL / HANDRAIL END CAPS OR OTHER ASSOCIATED TRIM AND WALL PROTECTION TRIM PIECES WITHIN THE PROJECT AREA TO ASSURE THAT THEY ARE PROPERLY SECURED TO WALL SURFACES. SECURE ANY LOOSE TRIM PIECES AND SEAL ANY GAPS BETWEEN TRIM PIECES AND WALL SURFACE WITH SPECIFIED SECURITY SEALANT.
4. THE TOP EDGE OF DOOR AND SIDEHILL AND WINDOW HOLLOW METAL FRAMES MAY PROVIDE ANCHOR POINTS. THE TOP EDGE OF ALL FRAMES MUST BE RENDERED ANTI-LIGATURE AND SAFE BY APPLYING SECURITY SEALANT AS SHOWN IN DETAIL W4610.

LEGEND : FIRE RATED PARTITIONS

- 1 HR.
- 1 HR. SMOKE BARRIER
- 2 HR.

FLOOR KEY PLAN

- PROJECT AREA
- PARTITION TO BE PROVIDED. PROVIDE P1 UNLESS INDICATED OTHERWISE.
- EXISTING PARTITION TO REMAIN
- DOOR - KEYED TO DOOR SCHEDULE

0' 4' 8' 16'

Project North True North