

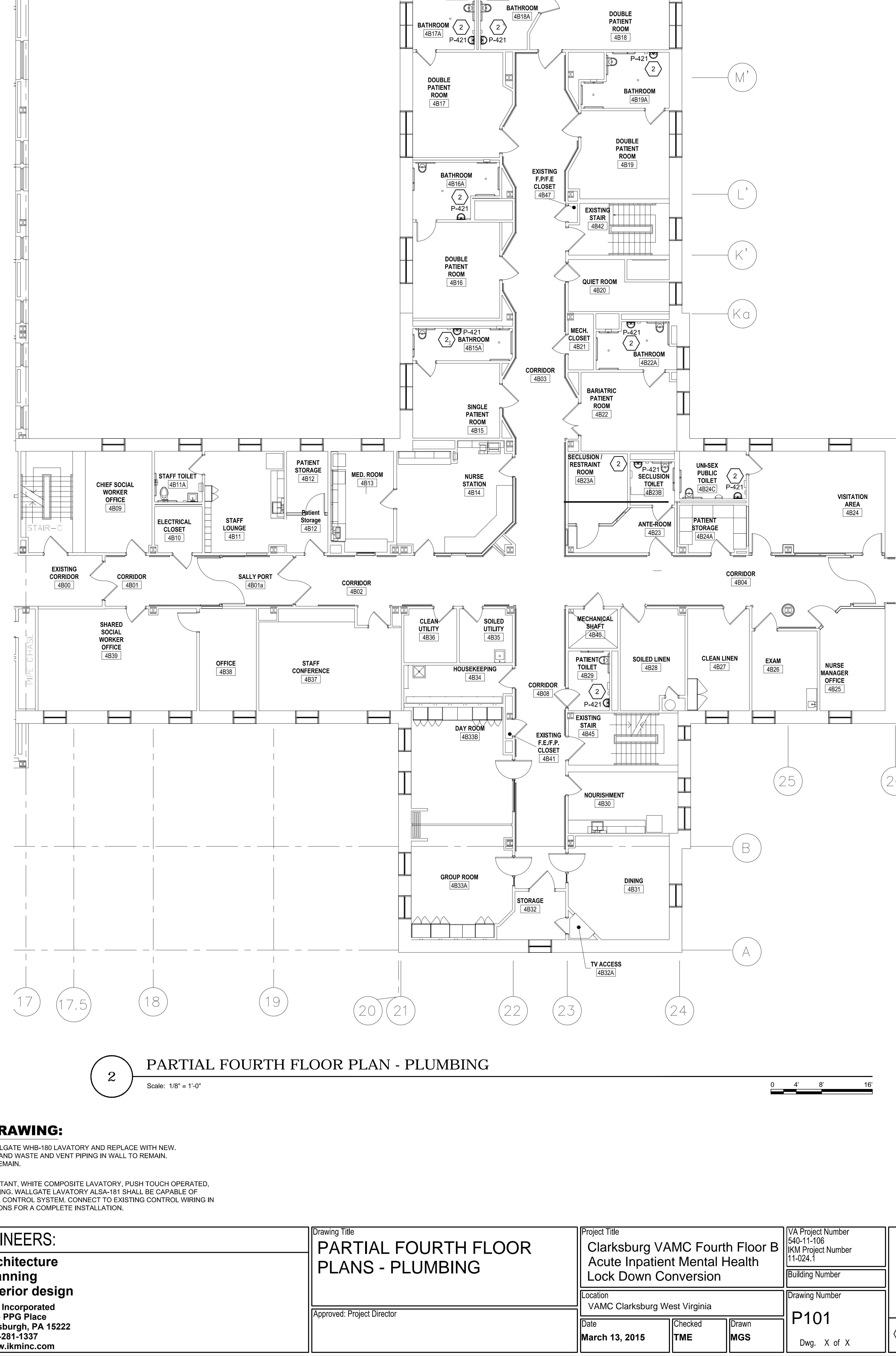

Scale: 1/8" = 1'-0"



Scale: 1/8" = 1'-0"

1. DISCONNECT AND REMOVE EXISTING WALLGATE WHB-180 LAVATORY AND REPLACE WITH NEW. EXISTING HOT AND COLD WATER SUPPLY AND WASTE AND VENT PIPING IN WALL TO REMAIN. EXISTING CONTROL WIRING IN WALL TO REMAIN.
2. NEW WALLGATE ALNSA-181, DAMAGE RESISTANT, WHITE COMPOSITE LAVATORY, PUSH TOUCH OPERATED, AS SPECIFIED, CONNECT TO EXISTING PIPING. WALLGATE LAVATORY ALNSA-181 SHALL BE CAPABLE OF BEING OPERATED BY EXISTING WALLGATE CONTROL SYSTEM. CONNECT TO EXISTING CONTROL WIRING IN WALL. MAKE ALL NECESSARY MODIFICATIONS FOR A COMPLETE INSTALLATION.

VA FORM 08-6231