

# OCCUPANT LOAD CALCULATIONS

ROOM NUMBER	ROOM NAME	AREA	RATIO	OCCUPANT LOAD	# OF EXIT REQUIRED
A3-101	CONFERENCE	220 SF	15	15	1
A3-109	OFFICE	98 SF	100	1	1
A3-110	EOC STORAGE	79 SF	300	1	1
A3-111	EOC MANAGER OFFICE	159 SF	100	2	1
A3-112	STORAGE	81 SF	300	1	1
A3-113	STORAGE	94 SF	300	1	1
A3-114	STORAGE	75 SF	300	1	1
A3-115	OFFICE	120 SF	100	2	1
A3-117	OFFICE	122 SF	100	2	1
A3-118	COPY	66 SF	100	1	1
A3-119	OFFICE	120 SF	100	2	1
A3-120	BREAK ROOM	66 SF	100	1	1
A3-121	OFFICE	120 SF	100	2	1
A3-123	OFFICE	122 SF	100	2	1
A3-125	OFFICE	120 SF	100	2	1
A3-127	OFFICE	120 SF	100	2	1
A3-129	OFFICE	122 SF	100	2	1
A3-131	OFFICE	120 SF	100	2	1
A3-140	OPEN OFFICE	899 SF	100	9	1
A3-141	CONFERENCE	215 SF	15	15	1
A3-200	CONFERENCE	410 SF	15	28	1
A3-214	OFFICE	118 SF	100	2	1
A3-216	OFFICE	118 SF	100	2	1
A3-218	OFFICE	118 SF	100	2	1
B3-101	UNAS	91 SF			
L1-1	STORAGE	17 SF	300	1	1
Grand total				97	

# EXITING CALCULATIONS

CORRIDOR A3-C10 EXIT WIDTH:  
24 PERSONS X 0.15'/PERSON = 3.6' REQUIRED

CORRIDOR A3-C12 EXIT WIDTH:  
23 PERSONS X 0.15'/PERSON = 3.45' REQUIRED

# GENERAL NOTES

ALL INFORMATION RELATING TO SMOKE SEPARATION AND FIRE RATED CONSTRUCTION WERE BASED ON EXISTING AS-BUILT DRAWINGS PROVIDED BY DEPARTMENT OF VETERAN AFFAIRS. THE ARCHITECT WILL NOT BE RESPONSIBLE FOR ACCURACY OR FOR INTERPRETATION OF INFORMATION ON PREVIOUS DRAWINGS.  
(REFERENCE: REPLACE CLINICAL BED TOWER FOR SEISMIC CORRECT - DRAWING FP2.3.0 THIRD FLOOR FIRE PROTECTION PLAN DATED MAY, 1994.)

# LEGEND

- EXISTING 1-HOUR FIRE RATED AND SMOKE PARTITION
- EXISTING 2-HOUR FIRE RATED PARTITION
- PATH OF EGRESS
- EXIT OCCUPANT LOAD
- EXIT
- (E) FIRE EXTINGUISHER CABINET AND FIRE EXTINGUISHER
- AREA OF WORK

## 4 THIRD FLOOR LIFE SAFETY AND EXIT DIAGRAM

Revisions:	Date

## CONSULTANTS:

## KEY PLAN

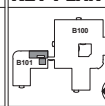

## ARCHITECT/ENGINEERS:



230 9TH STREET, SUITE 201  
SAN FRANCISCO, CA 94103  
P 415.398.7278 F 415.398.7278



## THIRD FLOOR LIFE SAFETY AND EXIT DIAGRAM

Approved: Project Director

## RENOVATE FOR B101 ON-CALL PROGRAM AND ANESTHESIA

Location: VAPAHCS - PALO ALTO

Date: SEPTEMBER 30, 2012

Checked: MMC

Drawn: TW

## GO-3

Page: 1 of 1

## FULLY SPRINKLERED CONSTRUCTION DOCUMENTS - BID SET

Office of Facilities Management

