

1 NOTES

1. ALL INFORMATION RELATING TO THE LOCATIONS OF THE WIFI ACCESS POINT AND SIGNAL STRENGTH WERE PROVIDED BY DEPARTMENT OF VETERAN AFFAIRS. THE ARCHITECT AND ENGINEER WILL NOT BE RESPONSIBLE FOR ACCURACY OR FOR INTERPRETATION OF INFORMATION.
2. ALL (E) WIFI ACCESS POINTS SHALL REMAIN IN OPERATION DURING CONSTRUCTION. CONTRACTOR TO COORDINATE WITH COR TO RELOCATE ACCESS POINT AS REQUIRED TO MEET NEW PLAN LAYOUT.

Floor View

Monitor > Site Maps > Palo Alto > Building 101 > Floor 2

Data may be delayed up to 15 minutes or more depending on background polling interval

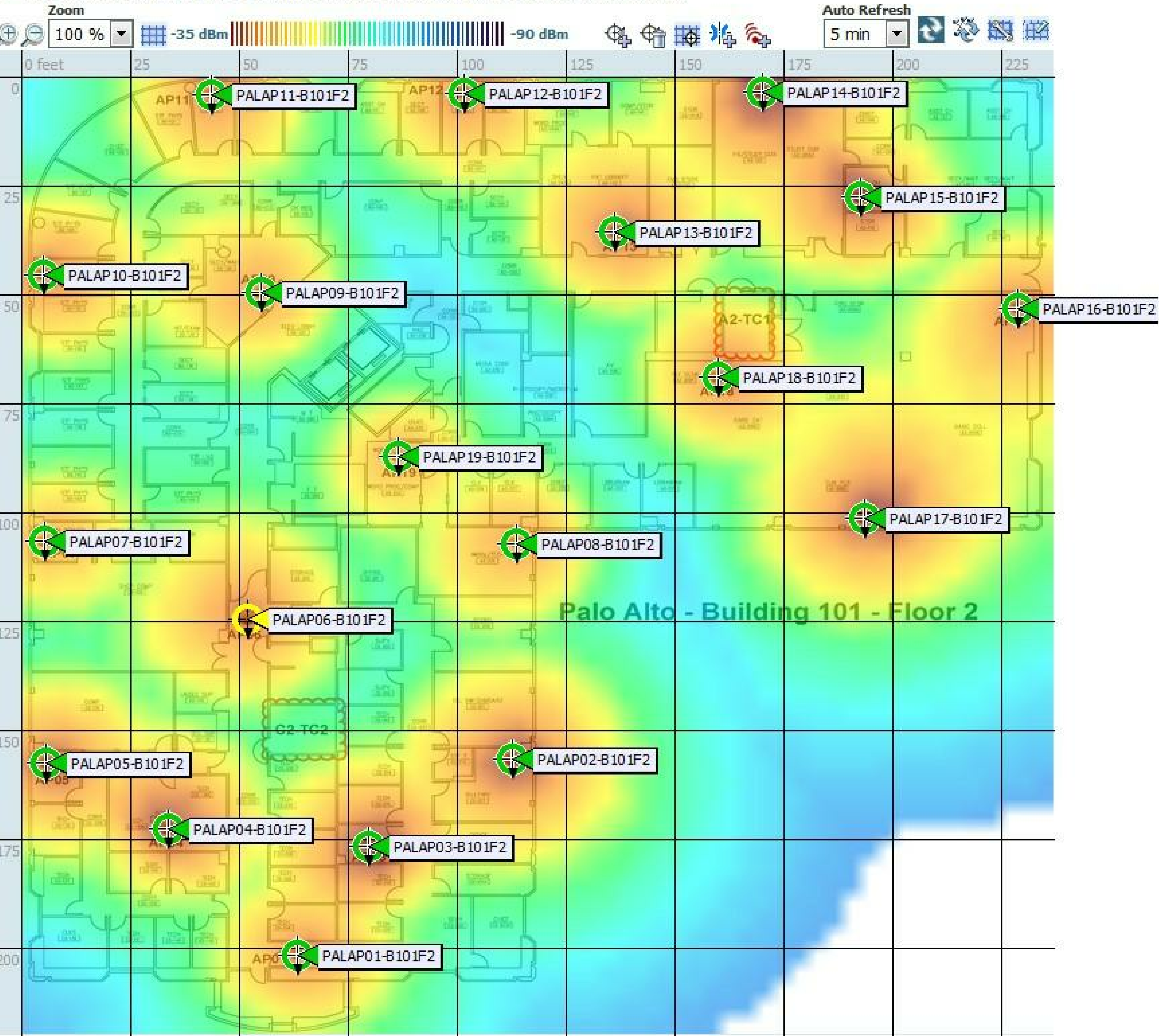

4 (E) SECOND FLOOR WIFI ACCESS POINT LOCATION MAP

12" = 1'-0"

1	AMENDMENT NO. 5	05-29-2015
Revisions:		Date

CONSULTANTS:

KEY PLAN

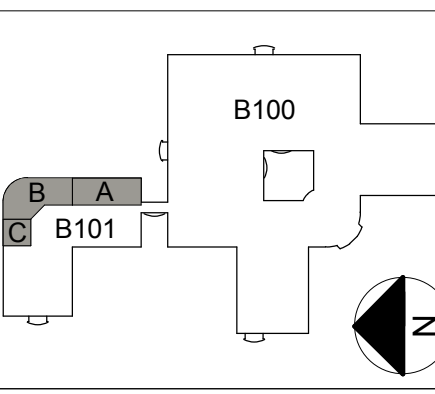

ARCHITECT/ENGINEERS:

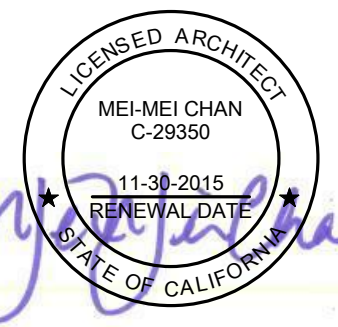

Drawing Title
EXISTING SECOND FLOOR WIFI ACCESS
POINT LOCATION MAP (FOR REFERENCE
ONLY)

Approved: Project Director

Project Title
Renovate for Medical Offices
Building 101 - 2nd Floor

Location
VA Palo Alto, CA

Date
March 6, 2015

Checked
MMC

Drawn
TW

Project Number
640-13-143P

Building Number
BLDG 101/2ND FLR

Drawing Number

ES2-3
Dwg-- of--

Office of
Facilities
Management

Department of
Veterans Affairs