

- WALL FINISHES LEGEND
- CG-1 3"x3"x3/8" OR 48" 90° CORNER GUARD (FIELD CUT TO FIT FROM FINISHED FLOOR TO HEIGHT AS INDICATED ON ELEVATIONS)
  - CG-2 1"x 1" TAPE-ON CORNER GUARD - TRIM IN FIELD
  - P PAINT - SEE SECTION 09 06 00 "SCHEDULE FOR FINISHES" FOR COLOR AND GLOSS LEVEL
  - HR ROUND STAINLESS STEEL HANDRAIL W/ ATTACHED CRASH RAIL - TOTAL HEIGHT 6"
  - WG-1 VINYL-COATED FABRIC WALL COVERING
  - WG-2A VINYL-COATED FABRIC WALL COVERING - COLOR A
  - WG-2B VINYL-COATED FABRIC WALL COVERING - COLOR B
  - WG-2C VINYL-COATED FABRIC WALL COVERING - COLOR C
  - WG-2D VINYL-COATED FABRIC WALL COVERING - COLOR D
  - WG-1 4" RIGID CRASH RAIL WITH CUSTOM HARDWOOD TRIM ABOVE
  - WG-2 4" RIGID CRASH RAIL WITH VINYL COVER ALIGN EDGE OF WINDOW SILL @ T.V. ROOMS
  - WG-3 1 1/2" IMPACT RESISTANT BUMPER RAIL
  - FRP FIBERGLASS REINFORCED PLASTIC PANELS TO 48" A.F.F. PROVIDE APPLICABLE MOLDINGS INCLUDING CAPS, ANGLES, CORNERS, DIVISIONS, END PANEL AT CASEWORK, INSIDE CORNERS AS INDICATED, RIGID SHEET WALL COVERING SYSTEM AS WAINSCOT
  - RSWS RIGID SHEET WALL COVERING SYSTEM AS WAINSCOT
  - WT-1 CROWN MOLDING WOOD TRIM

- NOTES
- [1] TYPICAL CONDITION - SEE ELEVATIONS 44-4
    - WG-1 @ 3'-6" AS A CHAIR RAIL
    - WG-1 BELOW CHAIR RAIL
    - P-1 ABOVE CHAIR RAIL
    - WT-1 @ TOP OF WALL
    - CG-2 @ EACH CORNER (FIELD CUT TO FIT FROM UNDERSIDE OF CHAIR RAIL TO WG-3
    - WG-3 ABOVE 4" RB
  - [2] WG-2 @ ALL RESIDENT ENTRIES. SEE SECTION 09 06 00 "SCHEDULE FOR FINISHES" FOR LIST OF COLORS
  - [3] SEE SECTION 09 06 00 "SCHEDULE FOR FINISHES" FOR PAINT COLORS IN THESE ROOMS
  - [4] TYPICAL CONDITION FOR CONNECTING CORRIDORS
    - HR @ 2'-10" A.F.F.
    - RSWS BELOW HANDRAIL
    - WG-3 @ TOP OF INTEGRAL COVE BASE
  - [5] TYPICAL CONDITION WHERE NO HANDRAIL OCCURS
    - RSWS WITH P-7 ABOVE
    - WG-2 ABOVE RSWS @ SAME HEIGHT AS INTEGRAL CRASH RAIL OF HR. (NO HAND RAIL)

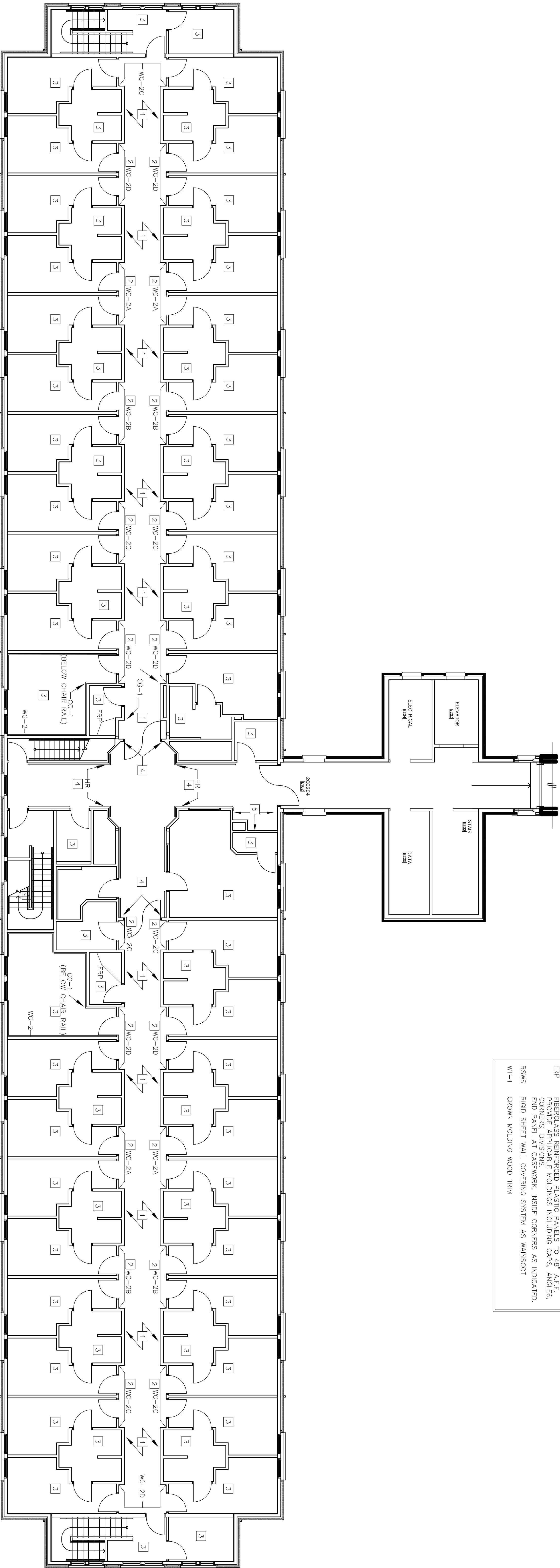

WALL FINISHES PLAN

1/8" = 1'-0"

0 4' 8' 16'

SCALE: 1/8" = 1'-0"

REVISIONS	DATE

REGISTERED ARCHITECT BRANDON J. KISTLER No. 1172 Kistler Small White Architects, Inc. State of Oregon	KISTLER SMALL WHITE ARCHITECTS 552 A STREET PORTLAND, OREGON 97201 P: 503.455.2812 F: 503.455.2812 www.kistlersmallwhite.com
---	---

	DEPARTMENT OF VETERANS AFFAIRS SOUTHERN OREGON REHABILITATION CENTER & CLINICS 8495 CRATER LAKE HIGHWAY WHITE CITY, OREGON
--	--

DRAWING TITLE: SECOND FLOOR PLAN WALL FINISHES	PROJECT TITLE REPLACE DOM BLDG. 203
CHECK BY: 692-339	DRAWN BY: 4 AUGUST 2014
DATE: 4 AUGUST 2014	DWG. 4 OF 4
US DEPARTMENT OF VETERANS AFFAIRS	bloom design INTERIORS