

three inches = one foot
6"

one and one-half inch = one foot
6"

one inch = one foot
6"

three-quarters inch = one foot
6"

one-half inch = one foot
6"

three-eighths inch = one foot
6"

one-quarter inch = one foot
6"

one-eighth inch = one foot
6"

C:\MYT\B5M6P-R\B5M6P-CENTRAL_akaomp.rvt
7/7/2015 3:14:34 PM

E3 MECHANICAL TOWER DEMOLITION PLAN-THIRD FLOOR
1/16" = 1'-0"

CONSULTANTS:
GAUTIER de TORRES ARQUITECTOS
Apartado 19357, San Juan, Puerto Rico 00910-1357
DEGENKOLB ENGINEERS
235 MONTGOMERY ST SUITE 500, SAN FRANCISCO, CA 94104
SAQ ENVIROMENTAL ENGINEERS, INC
PO.BOX 155, MANATI, PR 00674

LASALLE ENGINEERING, LLC
1000 YORK ROAD WILLOW GROVE, PA 19090
M.A + ASSOCIATES, LLC
8655 CHERRY LANE, LAUREL, MD 20707
CT + ASSOCIATES, LLC
86 THOMAS LEIGHTON BLVD, CUMBERLAND, RHODE ISLAND 02864

ARCHITECTS/ENGINEERS
HR
1101 King Street Suite 400,
Alexandria, VA 22314



Drawing Title
**MECHANICAL TOWER DEMOLITION PLAN -
THIRD FLOOR**

Approved : Project Director

Project Title
**PHASE 3 BUILDING ONE-SEISMIC
CORRECTIONS AND RENOVATIONS**

Location **VA Caribbean Healthcare System
10 Casia Street, San Juan, PR 00921-3201**

Date
06/12/2015

Checked by
WFZ

Drawn
OM

Project Number
672-085A
Building Number
1
Drawing number
MD1-103D
0

Office of
Construction
and Facilities
Management
Department of
Veterans Affairs

**MECHANICAL
DEMOLITION NOTES:**

1. REFER TO SHEET M-001 FOR ADDITIONAL NOTES.
2. UNLESS OTHERWISE NOTED, REMOVE ALL HVAC DUCTWORK, PIPING, CONTROLS AND EQUIPMENT.
3. CONTRACTOR SHALL COORDINATE DEMOLITION WORK WITH ALL OTHER TRADES.
4. REMOVE EXISTING EQUIPMENT SERVING TOWER INCLUDING AIR HANDLING UNITS, ASSOCIATED DUCTWORK, PIPING, CONDENSING UNITS, CONTROLS, POWER WIRING AND ROOF CURBS/SUPPORTS.
5. ALL EXISTING TO REMAIN EQUIPMENT (AHU'S, EF'S) LOCATED ON SECOND FLOOR ROOF WILL REMAIN OPERATIONAL AND MUST BE PROTECTED DURING DEMOLITION AND CONSTRUCTION ACTIVITIES.

**MECHANICAL
KEYNOTES:**

1. REMOVE EXISTING ROOF MOUNTED AIR HANDLING UNITS SERVING TOWER INCLUDING ASSOCIATED DUCTWORK, PIPING, CONDENSING UNITS, CONTROLS, POWER WIRING AND ROOF CURBS/SUPPORTS.
2. PROVIDE AND INSTALL THREE NEW CHILLED WATER DIFFERENTIAL PRESSURE (dP) SENSORS PRIOR TO DEMOLITION WORK. IN ADDITION TO THE SENSORS SHOWN HERE, A SENSOR SHALL BE PROVIDED ACROSS THE MORGUE CHILLED WATER CONNECTIONS AT ROOM C-32. CHILLED WATER PUMPS SHALL BE SWITCHED OVER TO THE NEW dP SENSORS AT THE COMMENCEMENT OF DEMOLITION WORK. PUMPS SHALL OPERATE BASED ON THE EXISTING SEQUENCE OF OPERATIONS AND THE dP SETPOINT SHALL REMAIN THE SAME UNLESS T&B DETERMINES AN INCREASE IN SETPOINT IS REQUIRED TO MEET THE DESIGN FLOW RATES OF THE NEW AIR HANDLING UNITS. SENSOR SHALL BE RATED FOR EXTERIOR USE. PUMPS TO OPERATE SUCH THAT THE SENSOR MEASURING THE LOWEST DIFFERENTIAL PRESSURE BE MAINTAINED AT SETPOINT.

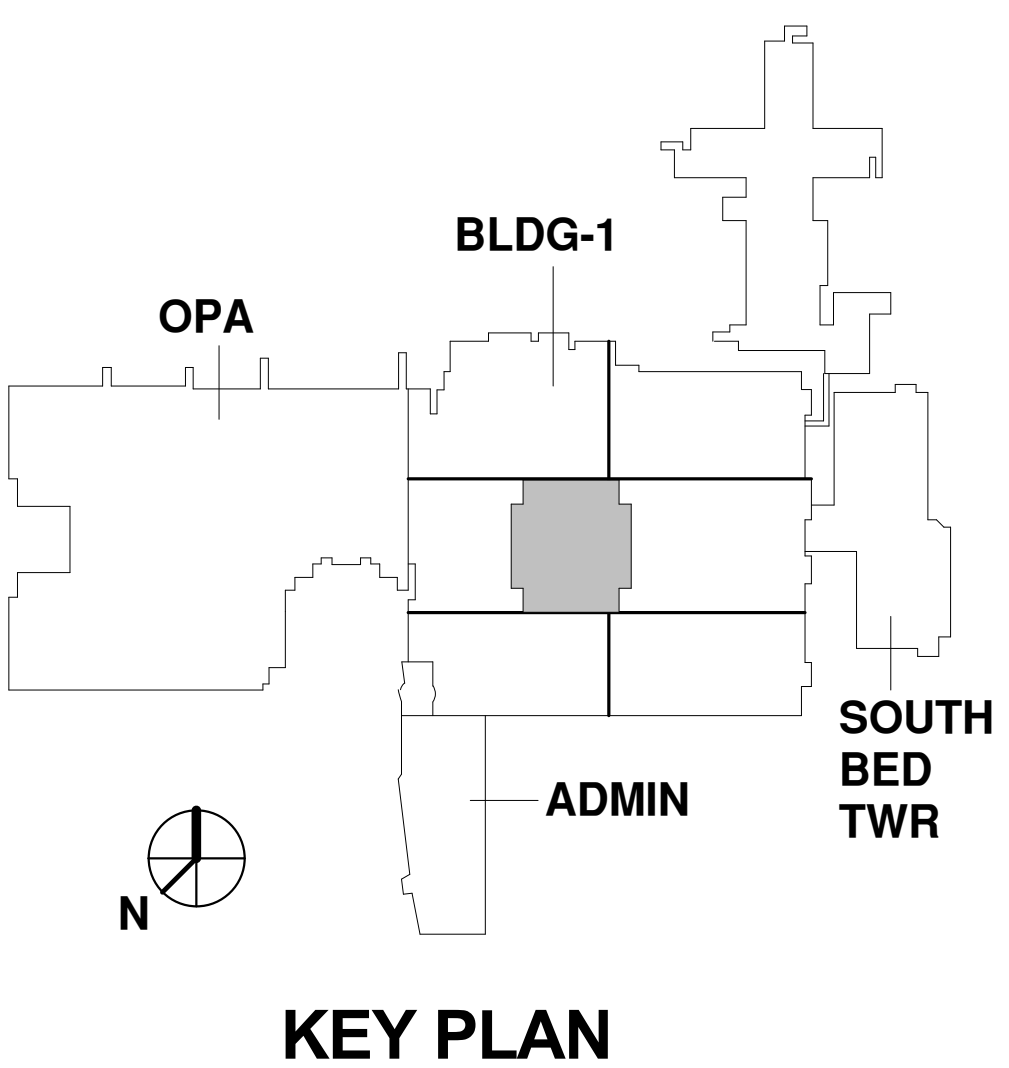

**BUILDING PARTIALLY SPRINKLERED (RENOVATED SPACES/
NEW PENTHOUSES IN THIS SCOPE OF WORK 100% SPRINKLERED)
BID SET 06/12/2015**