

- SHEET NOTES**
- ① PROVIDE 3-WAY VALVE AT THIS LOCATION
 - ② ALARM AT CONTROL PANEL SHOULD SPACE TEMPERATURE EXCEED 95°F (35°C)
 - ③ CHILLED WATER CHEMICAL TREATMENT
 - ④ HEATING HOT WATER CHEMICAL TREATMENT
 - ⑤ 36" CLEARANCE REQUIRED ON ALL SIDES OF BOILERS
 - ⑥ PROVIDE CHAIN OPERATION FOR VALVES HIGHER THAN 6'-0" (TYPICAL)
 - ⑦ CONDENSER HEADER ELEVATION AT 36" A.F.F.; BOTTOM TAP HEADER INTO PUMP
 - ⑧ COOLING TOWER BASIN HEIGHT MIN AT 6'-0" ABOVE GRADE. MAX ELEVATION OF TOWER AT OR BELOW HEIGHT OF C.E.P. YARD WALL. SHOULD TOWER ELEVATION EXCEED WALL HEIGHT, PROVIDE SAFETY ENCLOSURE EXTENSION ON TOP OF WALL
 - ⑨ CONDENSER WATER HEADER AT 3'-0" A.F.F.
 - ⑩ SIDE OR BOTTOM TAP CONDENSER WATER HEADER INTO PUMPS. DO NOT TOP TAP
 - ⑪ AUTO FLOW CONTROL VALVES
 - ⑫ 12" BOILER FLUE THRU ROOF

PARTIAL FLOOR PLAN LEVEL 1 AREA A - HVAC PIPING
1/8" = 1'-0"

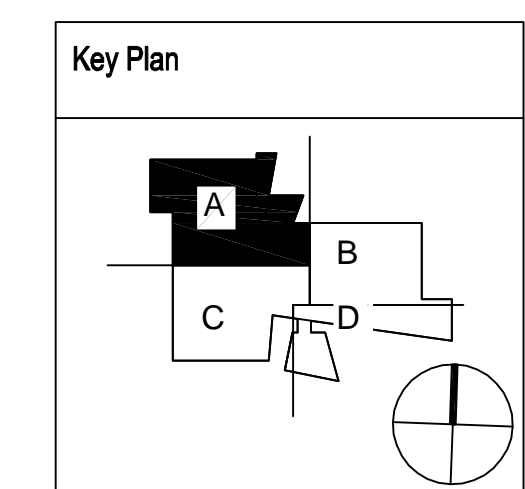

L:\2008-Jobs\108302-VA Ft. Myers Outpatient Clinic\CAD-MEP\Sheets HP101-A.dwg 4/18/2011 4:46:29 PM PLOT-17
one eighth inch = one foot
one quarter inch = one foot
one half inch = one foot
three quarters inch = one foot
one inch = one foot
one and one half inches = one foot
three inches = one foot