



SHADE TYPE A:
APPROXIMATE SIZE & QUANTITY
36" W X 116" H (2)
61" W X 116" H (52)
SHADE TYPE B:
APPROXIMATE SIZE & QUANTITY
42" W X 93" H (4)
67" W X 93" H (79)

*NOTE: ALL SIZES AND QUANTITIES ARE APPROXIMATE FOR BIDDING PURPOSES ONLY. FINAL SIZES AND QUANTITIES SHALL BE FIELD VERIFIED PRIOR TO ORDER PLACEMENT.

ATTACHMENT 4 - INPATIENT FLOORPLANS - PAGE 1 OF 4

FIRST FLOOR PLAN

Revised 06/25/2015

SHADE LOCATION

GENERAL NOTE:
ALL SHADES SHALL BE INSTALLED IN POCKETS WITH APPROPRIATE CLOSURE PLATE SIZE
UNLESS NOTED OTHERWISE.

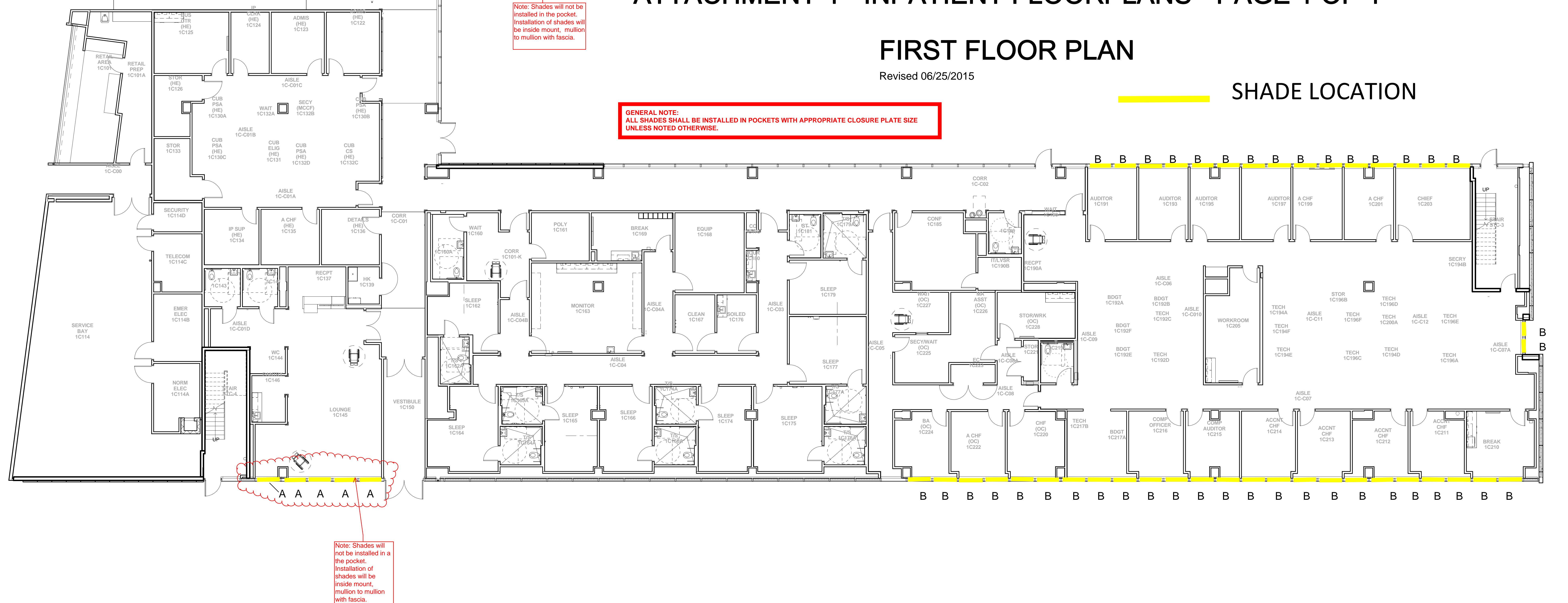

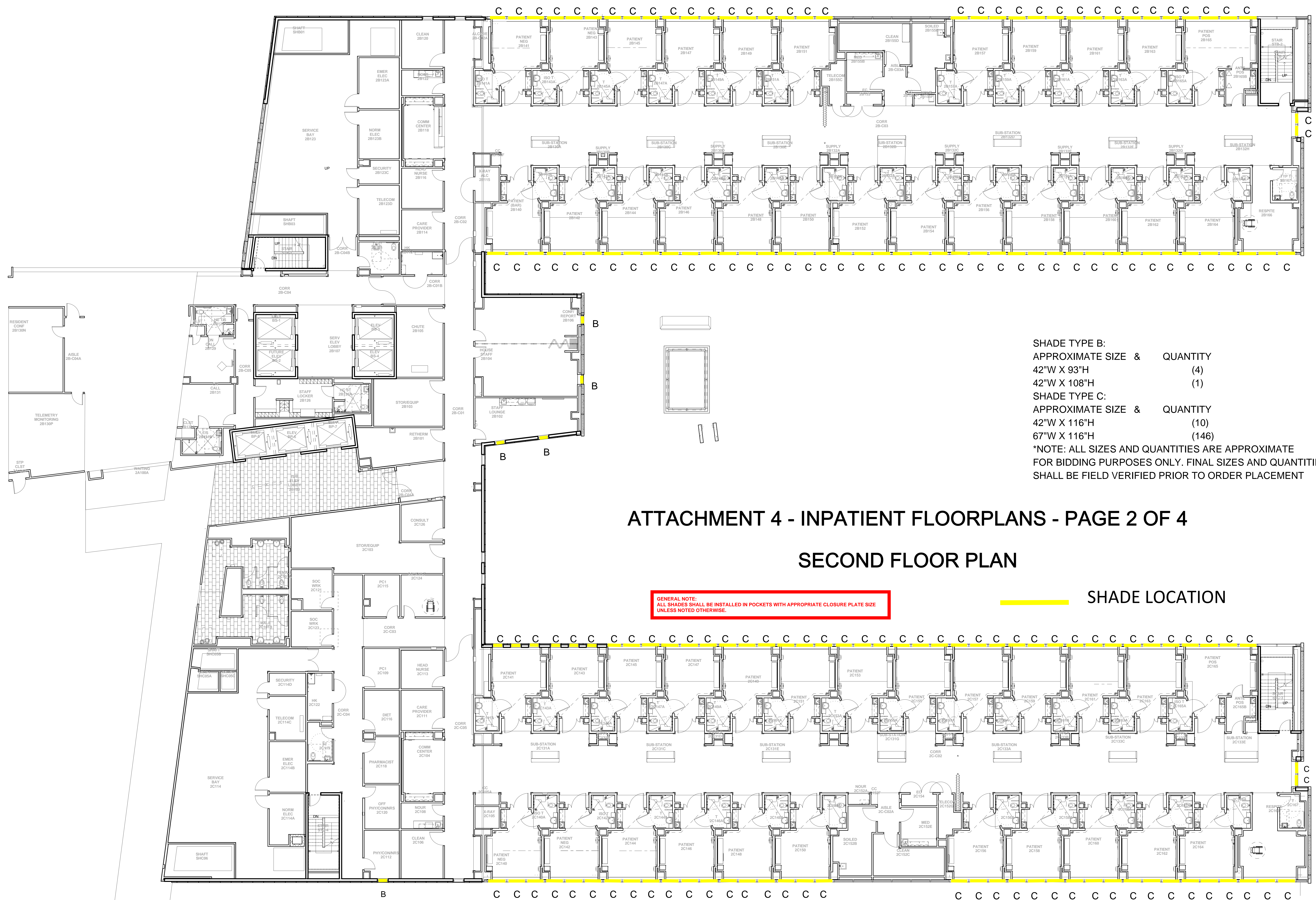

ATTACHMENT 4 - INPATIENT FLOORPLANS - PAGE 2 OF 4

SECOND FLOOR PLAN

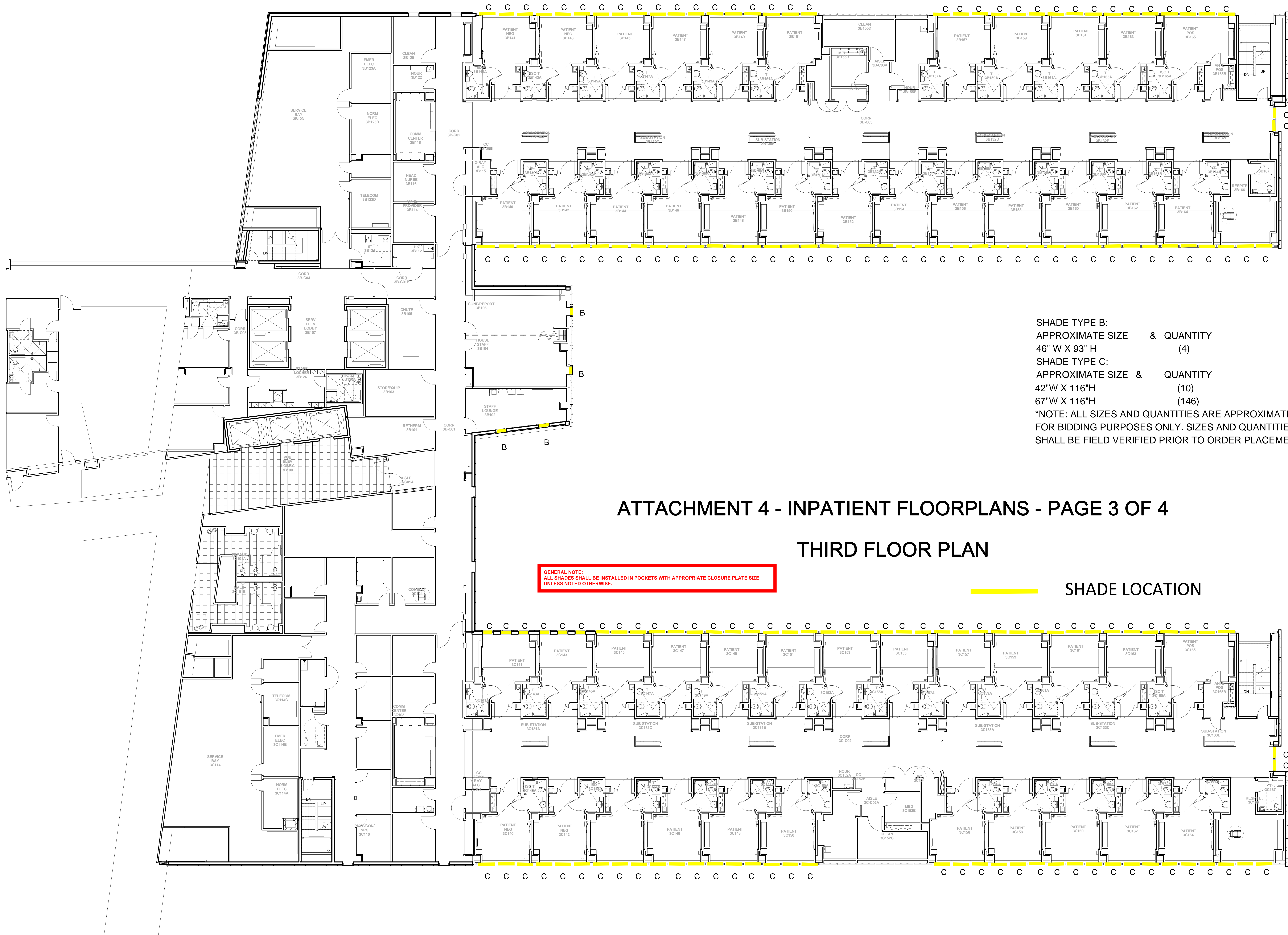

SHADE TYPE B:
APPROXIMATE SIZE & QUANTITY
46" W X 93" H (4)
SHADE TYPE C:
APPROXIMATE SIZE & QUANTITY
42"W X 116"H (10)
67"W X 116"H (146)
*NOTE: ALL SIZES AND QUANTITIES ARE APPROXIMATE
FOR BIDDING PURPOSES ONLY. SIZES AND QUANTITIES
SHALL BE FIELD VERIFIED PRIOR TO ORDER PLACEMENT.

ATTACHMENT 4 - INPATIENT FLOORPLANS - PAGE 3 OF 4

THIRD FLOOR PLAN

GENERAL NOTE:
ALL SHADES SHALL BE INSTALLED IN POCKETS WITH APPROPRIATE CLOSURE PLATE SIZE
UNLESS NOTED OTHERWISE.

SHADE LOCATION

61" W X 116" H (76)

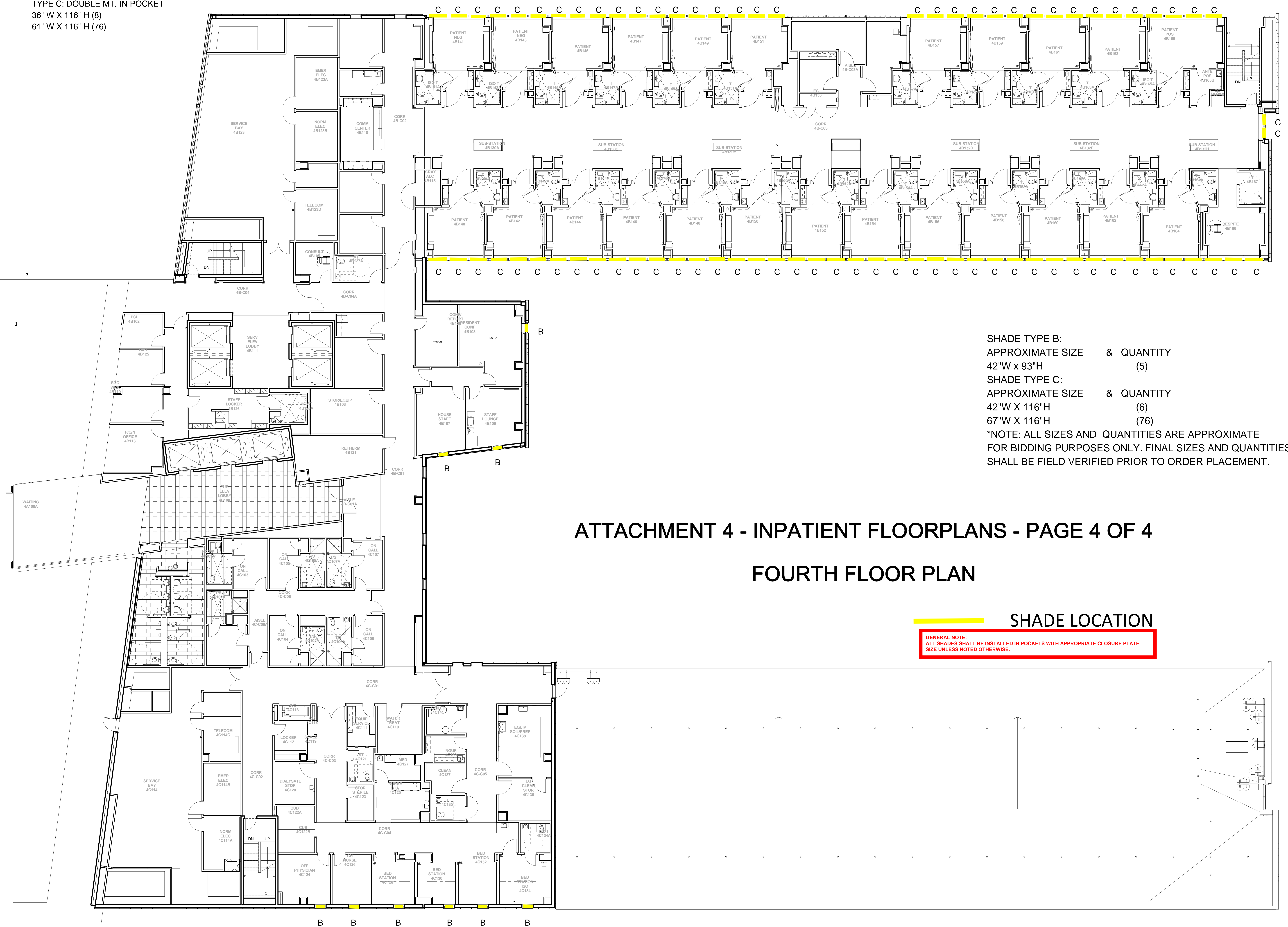

*NOTE: ALL SIZES AND QUANTITIES ARE APPROXIMATE
FOR BIDDING PURPOSES ONLY. FINAL SIZES AND QUANTITIES
SHALL BE FIELD VERIFIED PRIOR TO ORDER PLACEMENT.

FOURTH FLOOR PLAN

SHADE LOCATION

GENERAL NOTE:
ALL SHADES SHALL BE INSTALLED IN POCKETS WITH APPROPRIATE CLOSURE PLATE SIZE UNLESS NOTED OTHERWISE.