



DANVILLE, ILLINOIS

DRAWING INDEX

A detailed map of Danville, Illinois. The map shows the intersection of major roads: I-55 (Shirley F. Ryan Expressway) running north-south, I-74 (Danville Bypass) running east-west, and I-57 (Danville Bypass) running north-south. Other roads include S Kansas Ave, S Main St, and Tilton St. Landmarks include Danville National Cemetery and the Danville Public Library. The Danville River is shown flowing through the area. A compass rose indicates North. An inset map shows the location of Danville within the state of Illinois, marked with a star.

VICINITY MAP DANVILLE, ILLINOIS

I HEREBY CERTIFY THAT THIS PLAN  
SPECIFICATION OR REPORT WAS  
PREPARED BY ME OR UNDER MY  
DIRECT SUPERVISION, AND THAT I AM  
DULY LICENSED PROFESSIONAL  
ENGINEER UNDER THE LAWS OF THE  
STATE OF MINNESOTA

PRINT NAME: DAVID A. JASTER

SIGNATURE: 

DATE: 02-06-15 LICENSE # 496315

**ARCHITECT/ENGINEERS:**  
**ANDERSON ENGINEERING**  
ENGINEERING • ARCHITECTURE • LAND SURVEYING  
ENVIRONMENTAL SERVICES • LANDSCAPE ARCHITECTURE

Anderson Engineering of Minnesota, LLC  
13605 1st Avenue North  
Suite 100  
Plymouth, MN 55441  
763-412-4000 (o) 763-412-4090 (f)  
[www.ae-mn.com](http://www.ae-mn.com)

Drawing Title <b>COVER SHEET</b>	Approved Project Director
-------------------------------------	---------------------------

Project Title	Access Road for Section 20 Drainage Improvements to Section 20 Storage Material Bins	Checked MBS
Location	DANVILLE, ILLINOIS	Date FEBRUARY 4, 2015

**100% CONSTRUCTION DOCUMENTS FOR BID**

National  
Cemetery  
Administration

DANVILLE NATIONAL CEMETERY	DESIGN TEAM	<p>TIME CONTACT</p> <p>ARCHITECT: ONL. ENGINEERING &amp; MINISTRY 1800 37 4TH ST P.O. BOX 1000 P. 03845-0000</p> <p>CONTACT: DAME JARBER</p> <p>CONSULTING FIRM</p> <p>STRUCTURAL ENGINEER ADVANCED STRUCTURAL TECHNOLOGIES 728 METRO BLVD EDNA, MN 55609</p> <p>CONTACT: JOHN LEVARI</p> <p>GEOTECHNICAL SERVICES PROFESSIONAL SERVICE INDUSTRIES (PSI) 480 NORTH ST SPRINGFIELD, IL 62704</p> <p>CONTACT: JAMES GAIL GELBOFF</p> <p>STATE (BENJAMIN BARBER) (ONLY) PIONEER CEMETERY OF ILLINOIS 608 BENJAMIN ST LINCOLN, IL 62659</p> <p>CONTACT: DANIEL FORST</p>
----------------------------	-------------	--



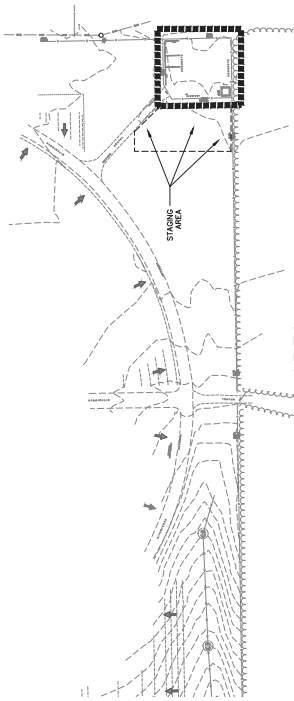

## AREA 1

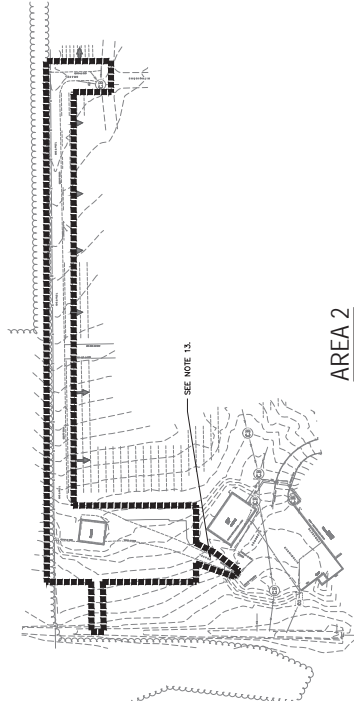

## AREA 2

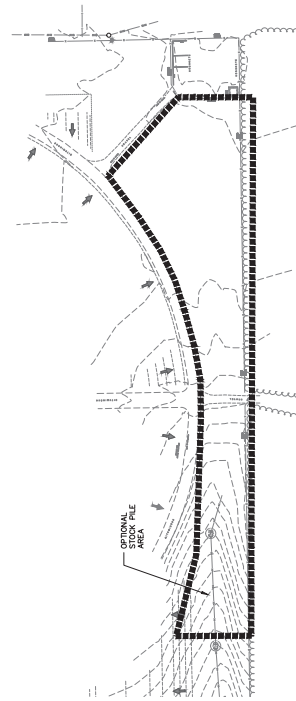

AREA 3

**CALL 48 HOURS BEFORE DIGGING**  
**UTILITIES Underground Location Center**  
**800 481 8811**

**Know what's below**  
**Call before you dig.**

## GENERAL NOTES

1. PROJECT IS CONSIDERED AS A SINGLE TRANSACTION PROJECT.
2. WORK MAY BE COMPLETED IN CONFORMANCE WITH LOCAL ALL OTHERS AREA (1, 2 & 3).
3. CONTRACTOR SHALL UNLITE IDENTIFIED AREAS FOR STAGING OF MATERIALS AND EQUIPMENT. NO STAGING IS ALLOWED WITHIN THE EXISTING RIGHT-OF-WAY OR EXISTING TRAVEL LANE. STAGING SHALL BE LOCATED WITHIN CORN AND GRASS FIELD OR OTHER ADJACENT AREAS TO BE PROTECTED WITH TEMPORARY HIGH CHAIN LINK FENCE.
4. FUTURE PROJECT IS LIMITED TO 70 DAY MAXIMUM OCCUPATION. CONTRACTOR SHALL COORDINATE PARKING SCHEDULE ACCORDINGLY.
5. CONTRACTOR TO POST SIGN TEMPORARY DIRECTION, SIGNAGE, THROUGH CEMETERY AS REQUESTED, MAINTAIN ACCESS TO ALL AREAS EXCEPT THOSE UNDER CONSTRUCTION.
6. MAINTAIN ALL ROUNDS IN CLASS C OR BETTER CONDITION. ORGANIZE STREET SWEEPING OF CEMENT AND PUBLIC STREETS SHALL BE COMPLETED DAILY.
7. DUE TO LIMITED STAGING ZONES AND TIGHT SITE CONSTRAINTS, MATERIAL MAY NEED TO BE EXPORTED OFF SITE AND MATERIAL MAY BE RE-IMPORTED. CONTRACTOR SHOULD SCHEDULE DELIVERY OF MATERIALS IN A WAY TO MINIMIZE THE NEED TO STORE ON-SITE.
8. SCHEDULE EQUIPMENT OF PROPER HEIGHT AND WIDTH TO ACCOMMODATE ACCESS THROUGH EXISTING CEMETERY GATES.
9. ADHERE TO ALL LOCAL MIGHTY LIMIT RESTRICTIONS.
10. ENTRANCE TO SITE ONLY THROUGH CEMETERY ENTRANCE ON MAIN STREET. NO ACCESS FROM KANSAS AVE.
11. CONTRACTOR STAGING AREA, PROVIDED NEAR NEW STREET, SHOULD SHED
12. NO ACCESS THROUGH EXISTING MAINTENANCE YARD AREA FROM KANSAS AVENUE.
13. TRUCK ROUTE LIMITED TO THOSE SHOWN.



## AREA 1: MATERIAL STORAGE SHED

1. INSTALL EROSION CONTROL MEASURES.
2. TEMPORARY STOCKPILE MATERIALS IN STORAGE BINS TO STORAGE SHED IN NORTHWEST CORNER SITE TO AVOID MATERIAL SITE CONCENTRATION.
3. REMOVE & DISPOSE EXISTING SHED (APPROX. 12'x42') AND ALL BELOW GROUND FOUNDATIONS, EQUIPMENT AND FENCE AS SHOWN.
4. CONTRACT NEW MATERIAL STORAGE SHED PER PLANS, INSTALL TEMPORARY CHAIN LINK CONSTRUCTION PERMITS FENCE FOR STAGING AREAS, WHERE FENCE WAS REMOVED FOR CONSTRUCTION OF BUILDING.
5. RELOCATE MATERIALS BACK TO NEW MATERIAL STORAGE SHED, COORDINATE WITH C.O.R. FOR EXACT BIN STORAGE LOCATIONS.
6. REMOVE EROSION CONTROL MEASURES.

## AREA 2: CONSTRUCT ROADWAY

1. INSTALL EROSION CONTROL MEASURES.
2. REMOVE EXISTING MEAL STORAGE BUILDING (APPROX. 300x80) IN ITS ENTIRETY INCLUDING FOUNDATIONS AND RELOCATE CHETTERLY SOIL, SAND, ROCK AND LANDSAFE MATERIALS TO LOCATION AS DETERMINED BY COR.
3. PREPARE ROADWAY SURFACE.
4. CONSTRUCT ROADWAY PER PLANS.
5. ESTABLISH GRASS/COVER PER PLANS.
6. REINFORCE EROSION CONTROL MEASURES UPON PLANTING AND SOIL STABILIZATION.

AREA 3: SECTION 23 DRAINAGE

1. INSTALL EROSION CONTROL MEASURES.
2. REMOVE AND SALVAGE TOPSOIL. STOCKPILE IN PHASE 3 ZONE OF CDMTORY.
3. INSTALL DRAINAGE PER PLANS.
4. ESTABLISH GROUND COVER PER PLANS.
5. REMOVE EROSION CONTROL MEASURES UPON PLANTING AND SOIL STABILIZATION.

## ACCESS TO CEMETERY MAP

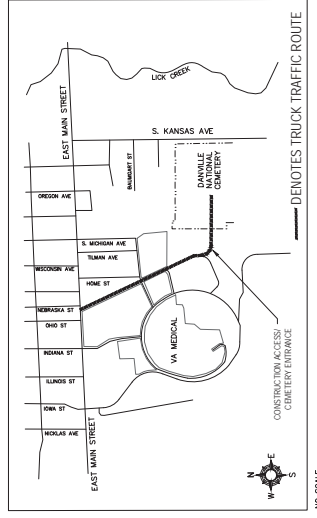

## OVERALL CEMETERY AREA MAP

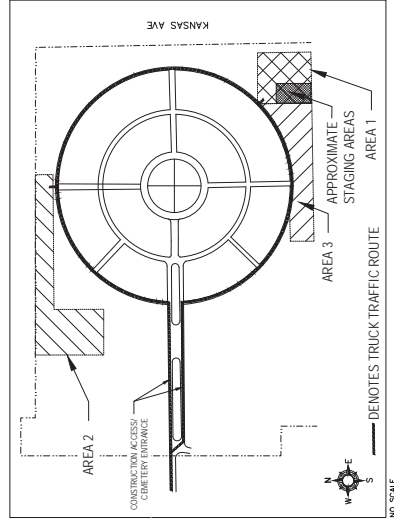

100% CONSTRUCTION DOCUMENTS FOR BID

[illegible]

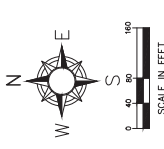
[illegible]

- [illegible]

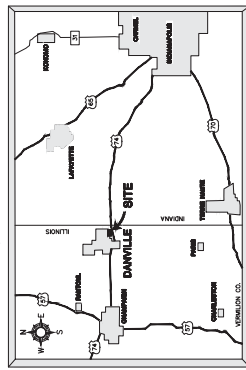

SURVEY CONTROL POINT SCHEDULE				
POINT NO.	NORTHING	EASTING	ELEVATION	DESCRIPTION
10000	1260782.27	1194687.29	639.52	SET 5/8 INCH REGAR WITH CAP
21004	1260892.17	1194653.21	637.99	SET 5/8 INCH REGAR WITH CAP
21005	1261412.77	1194596.73	631.40	SET 5/8 INCH REGAR WITH CAP
21006	1261505.20	1194197.10	616.86	SET 5/8 INCH REGAR WITH CAP

- DEPARTMENT OF VETERANS AFFAIRS

PROPERTY LOCATION: Danville National Cemetery, Danville, Illinois.

Anderson Engineering of Minnesota, LLC

by: Jack Bolke  
Jack Bolke  
Minnesota License No. 20281



## CONSULTANTS:



ARCHITECT/ENGINEERS:



Drawing Title SITE SURVEY

Approved Project Director	Location	NEW STORAGE MATERIAL BINS		
	DAMILE LINOIS	Date	Checked MSB	Drawn DAJ
		February 6, 2015		

**100% CONSTRUCTION DOCUMENTS FOR BID**