

GENERAL DEMOLITION NOTES:

1. CONTRACTOR SHALL PROTECT IN PLACE ITEMS INCLUDING BUT NOT LIMITED TO FENCE, FOOTINGS, HEADSTONES, ETC. DURING CONSTRUCTION. DAMAGE TO EXISTING STRUCTURES RESULTING FROM THE CONTRACTOR'S WORK SHALL BE REPAIRED IN A WORKMANLIKE MANNER TO THE OWNER.
2. IF HEADSTONES ARE FOUND TO BE DAMAGED, CONTRACTOR SHALL VERIFY WITH COR. FOR REPLACEMENT. CONTRACTOR SHALL BE RESPONSIBLE FOR THE COST OF REPLACEMENT AND THE COST OF THE WORK REQUIRED TO CEMENT IN THE NEW HEADSTONE. CONTRACTOR SHALL BE RESPONSIBLE FOR THE COST OF THE WORK REQUIRED TO CEMENT IN THE NEW HEADSTONE.
3. CONTRACTOR TO STAY OUT OF BURIAL SECTIONS AND GRAVESITES AT ALL TIMES.
4. COORDINATE WITH COR. AND MAINTENANCE ON REGARDING EQUIPMENT LOCATED WITHIN CONSTRUCTION LIMITS FOR RELOCATION DURING CONSTRUCTION OPERATIONS.
5. COORDINATE WITH COR. FOR ALTERNATIVE CONTRACTOR STAGING AREAS ON THE CEMETERY PROPERTY.
6. IN AREAS WHERE REMOVAL OF CONCRETE PAD, CONTRACTOR TO FILL PAD WITH GRAVEL AND MATCH EXISTING GRADE. TO PREVENT PONDING OF WATER, COMPACT GRAVEL TO SPECIFICATIONS.

LEGEND

- EXIST GRAVESITE
- EXIST HEADSTONE
- DIRECTION OF HEADSTONE FACE
- REMOVE EXIST TREE
- PROTECT TREE
- CONSTRUCTION LIMITS
- CONTRACTOR STAGING AREA
- FENCE REMOVAL
- PLASTIC MESH TEMPORARY CONSTRUCTION FENCE W/ METAL POSTS

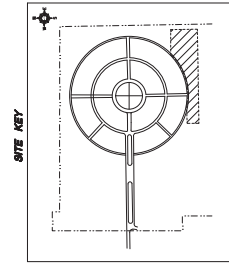
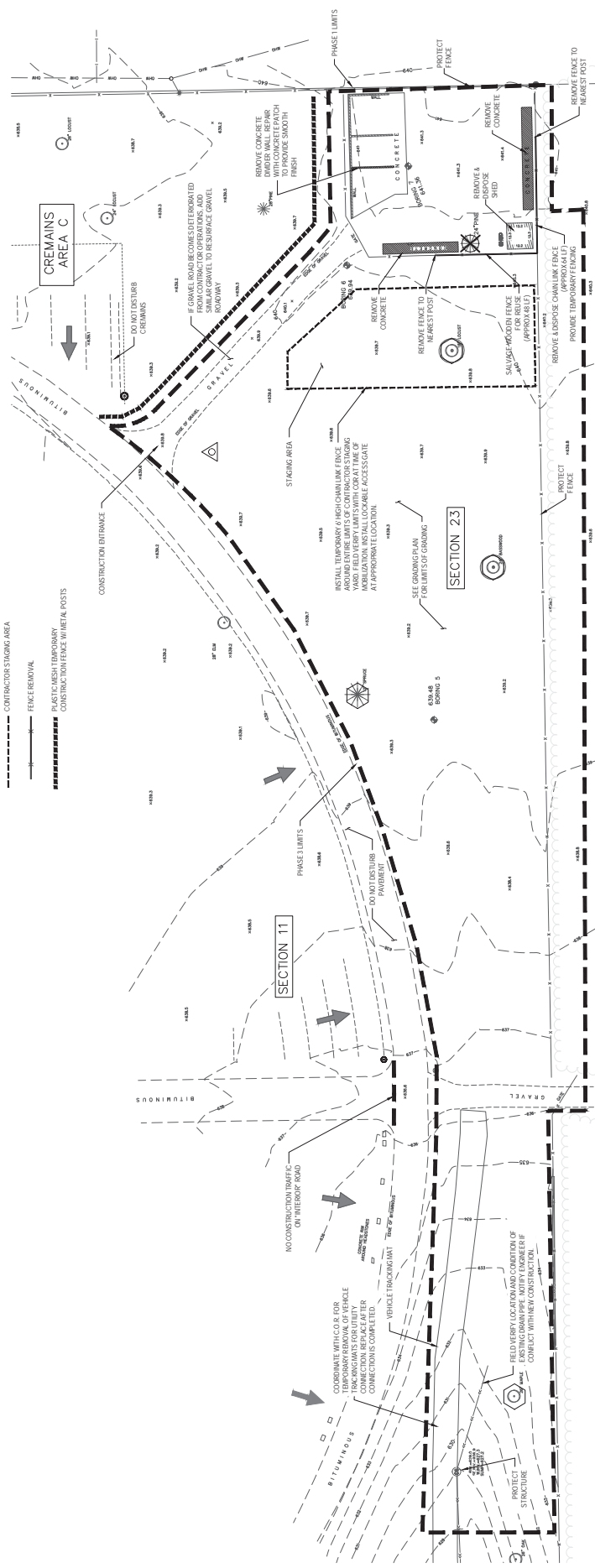

100% CONSTRUCTION DOCUMENTS FOR BID

<p>Project No. 2023-007 Access Road for Section 20 Demolition of Section 20 Site: 100% Construction Documents for Bid</p>	<p>Project No. 2023-007 Access Road for Section 20 Demolition of Section 20 Site: 100% Construction Documents for Bid</p>	<p>Project No. 2023-007 Access Road for Section 20 Demolition of Section 20 Site: 100% Construction Documents for Bid</p>	<p>Project No. 2023-007 Access Road for Section 20 Demolition of Section 20 Site: 100% Construction Documents for Bid</p>	<p>Project No. 2023-007 Access Road for Section 20 Demolition of Section 20 Site: 100% Construction Documents for Bid</p>	<p>Project No. 2023-007 Access Road for Section 20 Demolition of Section 20 Site: 100% Construction Documents for Bid</p>	<p>Project No. 2023-007 Access Road for Section 20 Demolition of Section 20 Site: 100% Construction Documents for Bid</p>	<p>Project No. 2023-007 Access Road for Section 20 Demolition of Section 20 Site: 100% Construction Documents for Bid</p>
<p>Project No. 2023-007 Access Road for Section 20 Demolition of Section 20 Site: 100% Construction Documents for Bid</p>	<p>Project No. 2023-007 Access Road for Section 20 Demolition of Section 20 Site: 100% Construction Documents for Bid</p>	<p>Project No. 2023-007 Access Road for Section 20 Demolition of Section 20 Site: 100% Construction Documents for Bid</p>	<p>Project No. 2023-007 Access Road for Section 20 Demolition of Section 20 Site: 100% Construction Documents for Bid</p>	<p>Project No. 2023-007 Access Road for Section 20 Demolition of Section 20 Site: 100% Construction Documents for Bid</p>	<p>Project No. 2023-007 Access Road for Section 20 Demolition of Section 20 Site: 100% Construction Documents for Bid</p>	<p>Project No. 2023-007 Access Road for Section 20 Demolition of Section 20 Site: 100% Construction Documents for Bid</p>	<p>Project No. 2023-007 Access Road for Section 20 Demolition of Section 20 Site: 100% Construction Documents for Bid</p>

CONSULTANTS

AS Anderson Engineering of Minnesota, LLC
13005 1st Avenue North
Plymouth, MN 55441
(763) 412-4000 (F) (763) 412-4000 (F)

ARCHITECT/ENGINEERS

ANDERSON ENGINEERING
13005 1st Avenue North
Plymouth, MN 55441
(763) 412-4000 (F) (763) 412-4000 (F)

DEVELOPMENT PLAN

ANDERSON ENGINEERING
13005 1st Avenue North
Plymouth, MN 55441
(763) 412-4000 (F) (763) 412-4000 (F)

DEMOLITION PLAN

ANDERSON ENGINEERING
13005 1st Avenue North
Plymouth, MN 55441
(763) 412-4000 (F) (763) 412-4000 (F)

DEMOLITION PLAN

ANDERSON ENGINEERING
13005 1st Avenue North
Plymouth, MN 55441
(763) 412-4000 (F) (763) 412-4000 (F)

DEMOLITION PLAN

ANDERSON ENGINEERING
13005 1st Avenue North
Plymouth, MN 55441
(763) 412-4000 (F) (763) 412-4000 (F)

DEMOLITION PLAN

ANDERSON ENGINEERING
13005 1st Avenue North
Plymouth, MN 55441
(763) 412-4000 (F) (763) 412-4000 (F)

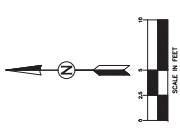

LEGEND

- CONCRETE APRON & SLAB
NEW BOLLARD
NEW FENCE
TEMPORARY FENCE
DRAINAGE ARROW
EXPANSION JOINT
CONTROL JOINT
41.0 NEW ELEVATION POINT
41.0 CONTOUR

BUILDING LAYOUT TABLE

POINT ID	NORTHING	EASTING	DESCRIPTION
1	1,260,693.57	1,195,289.92	NW BLDG CORNER
2	1,260,693.31	1,195,324.42	NE BLDG CORNER
3	1,260,692.02	1,195,338.92	SE WALL CORNER
4	1,260,693.07	1,195,291.43	SW BLDG CORNER

NOTE: CORNER 5 IS DEFINED AS THE FINISHED SURFACE CORNER OF THE EXTERIOR CONCRETE STRUCTURAL WALL.

GENERAL SITE PLAN NOTES:

- CONTRACTOR SHALL STATE LOCATION OF BUILDING AND KEY WITH C.O.R. THAT LOCATION IS CORRECT PRIOR TO CONSTRUCTING.
- GRADE GRAVEL MAINTENANCE YARD AREA SUCH THAT PONDING WILL NOT OCCUR. ADDITIONAL GRAVEL MATCH-EXISTING GRAVEL MATERIAL SHALL BE ADDED TO MAINTAIN GRAVEL MAINTENANCE YARD AREA WITHIN TYPICAL 5% GRADE BUILDING. MATCHING SPOT ELEVATIONS PER PLAN.
- MAINTENANCE YARD AREA SHALL BE ENCLOSED WITH TEMPORARY CHAIN LINK FENCE THROUGHOUT THE DURATION OF CONSTRUCTION. APPROXIMATE LOCATIONS SHOWN ON THE PLAN.
- PROVIDE CONCRETE SLASH BLOCK AT BUILDING DOWNSPOUTS (2 EACH), MINIMUM SIZE 24 INCHES WIDE BY 48 INCHES LONG.
- ELEVATION 100.0 ON ARCHITECTURAL AND STRUCTURAL PLANS CORRESPONDS TO ELEVATION 41.72 ON ONE PLANS.
- SPOT ELEVATIONS OF FLAT WORK SHOWN AT KEY POINTS. CONSTRUCT FLAT WORK WITH STRAIGHT GRADES BETWEEN KEY POINTS.
- GROUNDWATER MAY BE PRESENT DURING EXCAVATION WORK. REFER TO SPECIFICATIONS FOR DRAINAGE.
- EXCAVATED SOILS MAY NOT BE SUITABLE AS AN APPROVED MATERIAL FOR BACKFILL. SOIL CONDITIONING OR REMOVAL AND REPLACEMENT OF SOILS MAY BE REQUIRED. CONTRACTOR TO PROVIDE EVIDENCE OF REMOVAL OF NON-PRODUCTIVE MATERIAL.

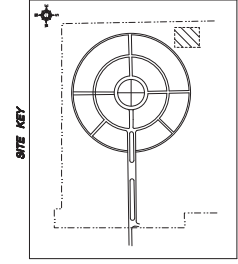

100% CONSTRUCTION DOCUMENTS FOR BID

Project No. 800-487-4874	Project Name National Cemetery Administration
Access Road for Service to DOWNSIDE APPROXIMATE TO SECTION 88	Access Road for Service to DOWNSIDE APPROXIMATE TO SECTION 88
Design Date FEBRUARY 4, 2008	Design By DANIEL LUNOS
Checked DANIEL LUNOS	Drawn DANIEL LUNOS
Scale 1" = 40'	Sheet No. of 25 25

Project No. 800-487-4874	Project Name National Cemetery Administration
Access Road for Service to DOWNSIDE APPROXIMATE TO SECTION 88	Access Road for Service to DOWNSIDE APPROXIMATE TO SECTION 88
Design Date FEBRUARY 4, 2008	Design By DANIEL LUNOS
Checked DANIEL LUNOS	Drawn DANIEL LUNOS
Scale 1" = 40'	Sheet No. of 25 25

Project No. 800-487-4874	Project Name National Cemetery Administration
Access Road for Service to DOWNSIDE APPROXIMATE TO SECTION 88	Access Road for Service to DOWNSIDE APPROXIMATE TO SECTION 88
Design Date FEBRUARY 4, 2008	Design By DANIEL LUNOS
Checked DANIEL LUNOS	Drawn DANIEL LUNOS
Scale 1" = 40'	Sheet No. of 25 25

Project No. 800-487-4874	Project Name National Cemetery Administration
Access Road for Service to DOWNSIDE APPROXIMATE TO SECTION 88	Access Road for Service to DOWNSIDE APPROXIMATE TO SECTION 88
Design Date FEBRUARY 4, 2008	Design By DANIEL LUNOS
Checked DANIEL LUNOS	Drawn DANIEL LUNOS
Scale 1" = 40'	Sheet No. of 25 25

Project No. 800-487-4874	Project Name National Cemetery Administration
Access Road for Service to DOWNSIDE APPROXIMATE TO SECTION 88	Access Road for Service to DOWNSIDE APPROXIMATE TO SECTION 88
Design Date FEBRUARY 4, 2008	Design By DANIEL LUNOS
Checked DANIEL LUNOS	Drawn DANIEL LUNOS
Scale 1" = 40'	Sheet No. of 25 25

Project No. 800-487-4874	Project Name National Cemetery Administration
Access Road for Service to DOWNSIDE APPROXIMATE TO SECTION 88	Access Road for Service to DOWNSIDE APPROXIMATE TO SECTION 88
Design Date FEBRUARY 4, 2008	Design By DANIEL LUNOS
Checked DANIEL LUNOS	Drawn DANIEL LUNOS
Scale 1" = 40'	Sheet No. of 25 25