

FEATURES & SPECIFICATIONS

INTENDED USE — The 2GTL LED recessed troffer offers a wide range of lumen packages, color temperatures, and lens options to meet the lighting needs for a wide range of applications such as schools, offices, and hospitals. The light engine delivers long life and excellent color to ensure a sound quality, low-maintenance lighting installation. **Certain airborne contaminants can diminish integrity of acrylic.** [Click here for Acrylic Environmental Compatibility table for suitable uses.](#)

CONSTRUCTION — Smooth hemmed sides and smooth inward formed end flanges for safe handling. Lighter-weight fixture allows for safe, easy installation.

OPTICS — Highly transmissive pattern #12 lens diffuses the light source without compromising output. Pattern #19 and satin white lens options also available.

ELECTRICAL — Long-life LEDs, coupled with high-efficiency drivers, provide extended service life. 70% LED lumen maintenance at 50,000 hours (L70/50,000).

Optional nLight® embedded controls make each luminaire addressable - allowing it to digitally communicate with other nLight enabled controls such as dimmers, switches, occupancy sensors and photocontrols. Simply connect all the nLight enabled control devices and the GTL luminaires using standard Cat-5 cabling. Unique plug-and-play convenience as devices and luminaires automatically discover each other and self-commission.

Lumen Management: Unique lumen management system (option N80) provides onboard intelligence that actively manages the LED light source so that constant lumen output is maintained over the system life, preventing the energy waste created by the traditional practice of over-lighting.

The bi-level dimming option (BLD) allows the system to be switched to 50% power for compliance with common energy codes while maintaining fixture appearance.

LED drivers deliver full-range dimming from 0-10V control signal. 5% - 100% dimming range.

Ballast disconnect is provided where required to comply with U.S. and Canadian codes.

INSTALLATION — LED boards include plug-in connectors for easy of upgradeability. Suitable for direct insulation contact.

LISTINGS — CSA certified to US and Canadian standards. Damp listed. DesignLights Consortium® (DLC) qualified product. Not all versions of this product may be DLC qualified. Please check the DLC Qualified Products List at www.designlights.org/QPL to confirm which versions are qualified.

WARRANTY — 5-year limited warranty. Complete warranty terms located at www.acuitybrands.com/CustomerResources/Terms_and_conditions.aspx

Note: Specifications subject to change without notice.

Catalog Number
Notes
Type

Type A1, A1a, A2, A2a, B1, B1a & B2, B2a

GTL Series

2GTL

2' x 2' and 2' x 4'
LED Recessed Troffer



Specifications

Length: 24 (61.0) for 2' x 2'
48 (122.0) for 2' x 4'
Width: 24 (61.0)
Depth: 3-1/4 (8.2)

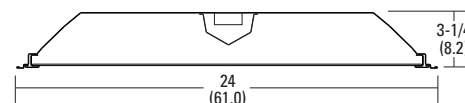

All dimensions are inches (centimeters) unless otherwise indicated.

Configurable Part Number	Stock Contractor Select Part Number
2GTL 2 37L LP835 NX	2GTL2 LP835
2GTL 2 37L LP840 NX	2GTL2 LP840
2GTL 4 40L LP835 NX	2GTL4 LP835
2GTL 4 40L LP840 NX	2GTL4 LP840

ORDERING INFORMATION

Lead times will vary depending on options selected. Consult with your sales representative.

Example: 2GTL 4 48L LP835 NX

2GTL	Length	Trim type	Lumens ¹	Door	Lens	Voltage	Color temperature
2GTL 2' wide recessed LED luminaire	2 2'	(blank) Grid F Overlapping flange	20L 2000 lumens 33L 3300 lumens 37L 3700 lumens	(blank) Flush steel, white FN Flush aluminum, natural FM Flush aluminum, matte black FW Flush aluminum, white RN Regressed aluminum, natural RM Regressed aluminum, matte black RW Regressed aluminum, white	(blank) #12 pattern acrylic, 0.125" thick A19 #19 pattern acrylic SWL Satin white	(blank) MVOLT (120-277V) 120 120V 277 277V 347 347V ²	LP830 82 CRI, 3000 Kelvin LP835 82 CRI, 3500 Kelvin LP840 82 CRI, 4000 Kelvin LP850 82 CRI, 5000 Kelvin
2GTL 2' wide recessed LED luminaire	4 4'	(blank) Grid F Overlapping flange	30L 3000 lumens 40L 4000 lumens 48L 4800 lumens 60L 6000 lumens 72L 7200 lumens				

Controls ³	Options
NX 0-10V, dimming, no nLight	EL14L 1400 lumen emergency battery ⁶
BLD Bi-level dimming ⁴	CP Chicago plenum
N80 nLight with 80% (L80) lumen management	PWS1836 6' pre-wire, 3/8" diameter, 18-gauge, 1-circuit
N80EMG nLight with 80% (L80) lumen management for use with generator supply emergency power ⁵	PWS1846 6' pre-wire, 3/8" diameter, 18-gauge, 2-circuit
N100 nLight without lumen management	ABC Door frame gasketing ⁷
N100EMG nLight without lumen management for use with generator supply emergency power ⁵	GLR Slow-blowing fuse ⁸
	GMF Fast-blowing fuse ⁸
	LATC Earthquake clip
	NPLT Narrow pallet
	PAF Paint after fab

Accessories: Order as separate catalog number.

DGA22	Drywall grid adapter for 2x2 recessed fixture.
DGA24	Drywall grid adapter for 2x4 recessed fixture.

Notes

- 1 Approximate lumen output. Lumen output will vary depending upon lens option chosen. See associated IES files for reference.
- 2 Not available with EL14L, BLD, or 33L.
- 3 Only choose one.
- 4 When using pre-wire option, use PWS1846.
- 5 Only available in 37L, 40L and 48L.
- 6 Not available with the 2GTL2 33L or 2GTL4 72L.
- 7 Only available with aluminum door.
- 8 Must specify voltage, 120 or 277.

FEATURES & SPECIFICATIONS

INTENDED USE — For wall or ceiling mounting, vertical or horizontal. The WL combines digital LED lighting and controls technologies with high-performance optical design to offer the most advanced wall-mount luminaire for general ambient lighting applications. High-efficacy light engine delivers long life and excellent color, ensuring a superior quality lighting installation that is highly efficient and sustainable.

CONSTRUCTION — Housing is roll formed from code-gauge steel.

Refractor is retained in die cast ends providing secure installation and easy maintenance.

Decorative die-cast end caps provide added durability.

Finish: All metal parts are post-painted in white polyester powder coat for smooth, finished edges and uniform light distribution.

OPTICS — Impact modified linear faceted refractor. Optically engineered for superior light distribution and maximum efficacy.

Crescent-shape linear faceted refractor system obscures and integrates individual LED images and uniformly washes fixture surface with light.

ELECTRICAL — Long-life LEDs, coupled with high-efficiency drivers, provide superior quantity and quality of illumination for extended service life. 80% LED lumen maintenance at 50,000 hours (L80/50,000). The LEDs have a CRI of 82.

eldoLED driver options deliver choice of dimming range and choices for control, while assuring flicker-free, low-current inrush, 89% efficiency and low EMI.

Driver disconnect provided where required to comply with US and Canadian codes.

CONTROLS — Optional nLight™ embedded controls continuously monitor system performance and allow for constant lumen management function.

Lumen Management: Unique lumen management system (option N80) provides onboard intelligence that actively manages the LED light source so that constant lumen output is maintained over the system life, preventing energy waste created by the traditional practice of over-lighting.

Integral occupancy control: Integrated occupancy sensors allow luminaire to power off or dim to 10% or 50% output when space is unoccupied. Fixture designed to fail on.

The nES 7 is ideal for small rooms without obstructions or areas with primarily walking motion (e.g. corridors, stairwells). Additionally, the NES7ADCX includes an integrated photocell, which enables daylight harvesting.

For rooms like restrooms and private offices or any space with obstructions, the nES PDT 7 dual technology sensor is recommended. The nES PDT 7 utilizes both PIR (passive infrared) and Microphonics™ technologies to detect occupancy.

Wireless networking: XPoint™ Wireless technology creates a mesh network to ensure communication between fixtures, sensors and wall stations facility-wide. This option provides superior lighting management capabilities including granular control, configuration and custom grouping.

Catalog Number
Notes
Type

Type C1

WSERIES

Wall bracket & Surface Mount LED



WL4

4'

LED



eldoLED

This option enables sensors that detect motion to wirelessly communicate to neighboring fixtures — whether on different floors in a stairwell, to a corridor or hallway — illuminating the desired path.

LISTINGS — CSA certified to meet U.S. and Canadian standards. Suitable for damp location.

DesignLights Consortium® (DLC) qualified product. Not all versions of this product may be DLC qualified. Please check the DLC Qualified Products List at www.designlights.org/QPL to confirm which versions are qualified.

Patents pending.

WARRANTY — 5-year limited warranty. Complete warranty terms located at www.acuitybrands.com/CustomerResources/Terms_and_conditions.aspx

Actual performance may differ as a result of end-user environment and application.

Note: Specifications subject to change without notice.

ORDERING INFORMATION

Lead times will vary depending on options selected. Consult with your sales representative.

Example: WL4 30L EZ1 LP840

WL4					
Series	Lumens ¹	Voltage	Driver	Color temperature	Lumen management
WL4 4' wall-mount LED	20L 2000 lumens 30L 3000 lumens 40L 4000 lumens	(blank) MVOLT (120 - 277V) 347 347V	EZ1 eldoLED dims to 1%, 0-10V EZB eldoLED dims to dark, 0-10V SLD Step-level dimming ²	LP830 3000 K LP835 3500 K LP840 4000 K LP850 5000 K	(blank) No nLight N80 nLight with 80% lumen management N100 nLight without lumen management N80EMG nLight with 80% lumen management for use with generator supply emergency power N100EMG nLight without lumen management for use with generator supply emergency power

Occupancy control ³	Standby mode ⁷	Options	Finish ⁹
NES7 Sensor Switch® nES 7 PIR integral occupancy sensor ⁴	(blank) Fixture turns off when unoccupied	EL7L LED Emergency battery pack (nominal 700 lumens); see Life Safety section ⁸	(blank) White
NESPD7 Sensor Switch® nES PDT 7 dual technology integral occupancy control ⁴	DIM10 Fixture dims to approximately 10% light output when unoccupied	EL14L LED Emergency battery pack (nominal 1400 lumens); see Life Safety section ⁸	
NES7ADCX Sensor Switch® nES 7 ADCX PIR integral occupancy sensor with automatic dimming control photocell ⁴	DIM50 Fixture dims to approximately 50% light output when unoccupied	SC Surface conduit end cap provisions	
XADS7 XPoint™ Wireless controller and micro 360° PIR occupancy and photocell sensor ^{5,6}			
XADNS7 XPoint™ Wireless controller and micro 360° PIR occupancy and photocell sensor (egress lighting) ^{5,6}			

Notes

- 1 Approximate lumen output.
- 2 Not available with XPoint™ Wireless or nLight options.
- 3 See integral occupancy control section in header.
- 4 Requires N80 or N100.
- 5 Select (blank) under "Lumen management" for this option.
- 6 Gateway not included. Requires on-site commissioning. Visit

- 7 www.lightingcontrols.com/XPointWireless for more information.
- 8 Requires occupancy control. For XPoint™ Wireless select (blank). Standby mode is programmed at time of commissioning.
- 9 Not available with 347V.
- 9 For additional paint finishes refer to Architectural Colors.

FEATURES & SPECIFICATIONS

INTENDED USE — The FS Series recessed LED luminaire combines modern aesthetics and performance in a general lighting product that enables the transformation from fluorescent to LED. The high efficacy light engine delivers long life and excellent color to ensure a quality lighting installation. Integrated controls options provide for design flexibility and optimum energy savings. Multiple lumen packages and driver options provide solutions for all your lighting applications. **Certain airborne contaminants can diminish integrity of acrylic. [Click here for Acrylic Environmental Compatibility table for suitable uses.](#)**

CONSTRUCTION — Rugged, one-piece cold-rolled steel coated polyester, painted after fabrication. The satin white lens provides excellent shielding and wide distribution. End plates include integral T-bar clips. Fixture may be mounted and wired in continuous rows. Total fixture height is only 4-3/8".

ELECTRICAL — Long-life LEDs, coupled with high-efficiency drivers, provide superior illumination for extended service life. The FSL is rated to deliver L80 performance for 50,000 hours. The LEDs have a CRI of 82.

eldoLED driver options deliver choice of dimming range, and choices for control, while assuring flicker-free, low-current inrush, 89% efficiency and low EMI.

Optional integrated nLight® controls make each luminaire addressable - allowing it to digitally communicate with other nLight enabled controls such as dimmers, switches, occupancy sensors and photocontrols. Simply connect all the nLight enabled control devices and the FSL luminaires using standard CAT-5 cabling. Unique plug-and-play convenience allows devices and luminaires to automatically discover each other and self-commission.

Lumen Management: Unique lumen management system (option N80) provides onboard intelligence that actively manages the LED light source so that constant lumen output is maintained over the system life, preventing the energy waste created by the traditional practice of over-lighting.

Step-level dimming option allows system to be switched to 50% power for compliance with common energy codes while maintaining fixture appearance.

Driver disconnect provided where required to comply with US and Canadian codes.

INSTALLATION — Unique grid interfacing arrangement provides mounting into standard 1" and 9/16" tee bar or screw slot grids. 9/16" allows fixture trim to hang level with architectural ceiling tiles. Drywall ceiling adaptors available. Suitable for damp location.

LISTINGS — CSA certified to meet US and Canadian standards. IC Rated. DesignLights Consortium® (DLC) qualified product. Not all versions of this product may be DLC qualified. Please check the DLC Qualified Products List at www.designlights.org/QPL to confirm which versions are qualified.

WARRANTY — 5-year limited warranty. Complete warranty terms located at www.acuitybrands.com/CustomerResources/Terms_and_conditions.aspx

Note: Specifications subject to change without notice.

Catalog Number
Notes
Type



FS Series

2FSL4

2' x 4'
LED



Stock Configurations

2FSL4 40L EZ1 LP835
2FSL4 40L EZ1 LP840

ORDERING INFORMATION

Lead times will vary depending on options selected. Consult with your sales representative.

Example: 2FSL4 40L EZ1 LP835 N100

2FSL4									
Series	Air function		Lumens	Lens	Voltage	Driver	Color temperature	Controls ⁵	Options
2FSL4 2X4 FSL	(blank) Static H Heat removal		30L 3000 ¹ 40L 4000 ¹ 48L 4800 ¹ 60L 6000 ¹ 72L 7200 ¹	(blank) Satin white	(blank) MVOLT 347 347 ²	EZ1 eldoLED dims to 1%, 0-10V EZB eldoLED dims to black, 0-10V EDB eldoLED DALI ³ EXB eldoLED DMX/RDM ³ SLD Step-level dimming ^{3,4} EXA1 Dims to 1%, XPoint wire-less enabled EXAB Dims to dark, XPoint wire-less enabled	LP830 3000 K LP835 3500 K LP840 4000 K LP850 5000 K	(blank) No controls N80 nlight® with 80% lumen management N80EMG nlight® with 80% lumen management. For use with generator supply EM power. N100 nlight® without lumen management N100EMG nlight® without lumen management. For use with generator supply EM power.	EL7L 700 lumen battery pack EL14L 1400 lumen battery pack CP Chicago plenum PWS1836 6' prewire, 3/8" diameter, 18-gauge, 1-circuit PWS1846 6' prewire, 3/8" diameter, 18-gauge, 2-circuit RRL_ RELOC®-ready luminaire ⁶ NPLT Narrow pallet

Accessories: Order as separate catalog number.	
2FS4 F916	Trim to adjust fixture mounting flush with 9/16" T-bar; for 2x4 fixture
DGA24	Drywall ceiling adaptor, unit installation

Notes

- 1 Approximate lumen output.
- 2 Consult factory for availability. Not available with SLD, EL7L, or EL14L.
- 3 Not available with N80, N80EMG, N100 or N100EMG.
- 4 When using prewire option, use PWS1846.
- 5 nLO access limitations on 30L or EZB.
- 6 For ordering logic consult: [RRL 2013](#).

FEATURES & SPECIFICATIONS

INTENDED USE — The FS Series recessed LED luminaire combines modern aesthetics and performance in a general lighting product that enables the transformation from fluorescent to LED. The high efficacy light engine delivers long life and excellent color to ensure a quality lighting installation. Integrated controls options provide for design flexibility and optimum energy savings. Multiple lumen packages and driver options provide solutions for all your lighting applications. **Certain airborne contaminants can diminish integrity of acrylic. [Click here for Acrylic Environmental Compatibility table for suitable uses.](#)**

CONSTRUCTION — Rugged, one-piece cold-rolled steel coated polyester, painted after fabrication. The satin white lens provides excellent shielding and wide distribution. End plates include integral T-bar clips. Fixture may be mounted and wired in continuous rows. Total fixture height is only 4-3/8".

ELECTRICAL — Long-life LEDs, coupled with high-efficiency drivers, provide superior illumination for extended service life. The FSL is rated to deliver L80 performance for 50,000 hours. The LEDs have a CRI of 82.

eldoLED driver options deliver choice of dimming range, and choices for control, while assuring flicker-free, low-current inrush, 89% efficiency and low EMI.

Optional integrated nLight® controls make each luminaire addressable - allowing it to digitally communicate with other nLight enabled controls such as dimmers, switches, occupancy sensors and photocontrols. Simply connect all the nLight enabled control devices and the FSL luminaires using standard CAT-5 cabling. Unique plug-and-play convenience allows devices and luminaires to automatically discover each other and self-commission.

Lumen Management: Unique lumen management system (option N80) provides onboard intelligence that actively manages the LED light source so that constant lumen output is maintained over the system life, preventing the energy waste created by the traditional practice of over-lighting.

Step-level dimming option allows system to be switched to 50% power for compliance with common energy codes while maintaining fixture appearance.

Driver disconnect provided where required to comply with US and Canadian codes.

INSTALLATION — Unique grid interfacing arrangement provides mounting into standard 1" and 9/16" tee bar or screw slot grids. 9/16" allows fixture trim to hang level with architectural ceiling tiles. Drywall ceiling adaptors available. Suitable for damp location.

LISTINGS — CSA certified to meet US and Canadian standards. IC Rated. DesignLights Consortium® (DLC) qualified product. Not all versions of this product may be DLC qualified. Please check the DLC Qualified Products List at www.designlights.org/QPL to confirm which versions are qualified.

WARRANTY — 5-year limited warranty. Complete warranty terms located at www.acuitybrands.com/CustomerResources/Terms_and_conditions.aspx

Note: Specifications subject to change without notice.

Catalog Number
Notes
Type

FS Series

2FSL2

2' x 2'
LED



eldoLED  

Stock Configurations

2FSL2 33L EZ1 LP835
2FSL2 33L EZ1 LP840

Type D3

ORDERING INFORMATION

Lead times will vary depending on options selected. Consult with your sales representative.

Example: 2FSL2 20L EZ1 LP835 N100

2FSL2																	
Series		Air function		Lumens		Lens		Voltage		Driver		Color temperature		Controls ⁵		Options	
2FSL2	2X2 FSL	(blank) Static H Heat removal	20L 2000 ¹ 33L 3300 ¹ 40L 4000 ¹	(blank) Satin white	(blank) MVOLT 347 347 ²	EZ1	eldoLED dims to 1%, 0-10V	LP830	3000 K	(blank) No controls N80 nlight® with 80% lumen management N80EMG nlight® with 80% lumen management. For use with generator supply EM power. N100 nlight® without lumen management N100EMG nlight® without lumen management. For use with generator supply EM power.	EL7L 700 lumen battery pack EL14L 1400 lumen battery pack CP Chicago plenum PWS1836 6' prewire, 3/8" diameter, 18-gauge, 1-circuit PWS1846 6' prewire, 3/8" diameter, 18-gauge, 2-circuit RRL_ RELOC®-ready luminaire ⁶ NPLT Narrow pallet						
						EZB	eldoLED dims to black, 0-10V	LP835	3500 K								
						EDB	eldoLED DALI ³	LP840	4000 K								
						EXB	eldoLED DMX/RDM ³	LP850	5000 K								
						SLD	Step-level dimming ^{3,4}										
						EXA1	Dims to 1%, XPoint wire-less enabled										
						EXAB	Dims to dark, XPoint wire-less enabled										

Accessories: Order as separate catalog number.

2FS2 F916 Trim to adjust fixture mounting flush with 9/16" T-bar; for 2x2 fixture
DGA22 Drywall ceiling adaptor, unit installation

Notes

- 1 Approximate lumen output.
- 2 Consult factory for availability. Not available with SLD, EL7L, or EL14L.
- 3 Not available with N80, N80EMG, N100 or N100EMG.
- 4 When using prewire option, use PWS1846.
- 5 nIO access limitations with 20L or EZB.
- 6 For ordering logic consult: [RRL_2013](#).



Luminaire Type:
Catalog Number
(autopopulated):



Gotham Architectural Downlighting
LED Downlights

**6" Evo®
Downlight**

Solid-State Lighting



FEATURES

OPTICAL SYSTEM

- Self-flanged semi-specular, matte-diffuse or specular lower reflector
- Patented Bounding Ray™ optical design (U.S. Patent No. 5,800,050)
- 45° cutoff to source and source image
- Top-down flash characteristic

MECHANICAL SYSTEM

- 16-gauge galvanized steel construction; maximum 1-1/2" ceiling thickness
- Telescopic mounting bars maximum of 32" and minimum of 15", preinstalled, 4" vertical adjustment
- Toolless adjustments post installation
- Junction box capacity: 8 (4 in, 4 out) 12AWG rated for 90°C
- Light engine and driver accessible through aperture

ELECTRICAL SYSTEM

- Fully serviceable and upgradeable lensed LED light engine
- 70% lumen maintenance at 60,000 hours based on IESNA LM-79-2008
- 120-277VAC, 50/60hz power supply with 0-10V dimming (10-100%)
- Overload and short circuit protected
- LEDs tested under LM80

LISTINGS

- Fixtures are CSA certified to meet US and Canadian standards; wet location, covered ceiling

WARRANTY

- 5-year limited warranty. Complete warranty terms located at: www.acuitybrands.com/CustomerResources/Terms_and_conditions.aspx

ORDERING INFORMATION

EXAMPLE: EVO 35/10 6AR 120 AZ10

Series	Color temperature	Nominal lumen values	Aperture/Trim color	Distribution	Finish	Voltage
EVO	27/ 2700 K	10 1000 lumens	6AR Clear	(blank) 1.0 s/mh	(blank) Semi-specular	MVOLT
	30/ 3000 K	14 1400 lumens	6PR Pewter	VND Very narrow (0.5 s/mh)	LD Matte diffuse	120
	35/ 3500 K	18 1800 lumens	6WTR Wheat	ND Narrow (0.6 s/mh)	LS Specular	277
	41/ 4100 K	22 2200 lumens	6GR Gold	MD Medium (0.8 s/mh)		347 ²
			6WR ¹ White	WD Wide (1.2 s/mh)		
			6BR ¹ Black			

Driver	Options
AZ10 ³ Philips Xitanium 0-10V dimming driver. Minimum dimming level 10%	SF Single fuse
EZB eldoLED SOLOdrive 0-10V dimming driver. Minimum dimming level <1%. 120V or 277V	NPP16D nLight® network relay pack with 0-10V dimming. Refer to TN-602 .
EDAB eldoLED SOLOdrive DALI dimming driver. Minimum dimming level <1%. 120V or 277V	NPP16D ER ⁶ nLight® network relay pack with 0-10V dimming for emergency circuit operation. Refer to TN-602 .
EDXB eldoLED POWERdrive DMX with RDM (remote device management). Minimum dimming level <1%. Includes termination resistor. 120V or 277V	NPS80EZ nLight® dimming pack controls 0-10V eldoLED drivers.
ECOS2 ^{3,4,5} Lutron® Hi-Lume® 2-wire forward-phase dimming driver. Minimum dimming level 1%	NPS80EZ ER ⁶ nLight® dimming pack controls 0-10V eldoLED drivers. ER controls fixtures on emergency circuit.
ECOS3 ^{3,4} Lutron® Hi-Lume® 3-wire or EcoSystem® dimming driver. Minimum dimming level 1%	TRW ⁷ White painted flange
	TRBL ⁸ Black painted flange
	EL ⁹ Emergency battery pack with integral test switch
	ELR ⁹ Emergency battery pack with remote test switch
	CR190 High CRI (90+)
	CP ¹⁰ Chicago plenum
	BGTD Bodine generator transfer device
	RRL RELOC®-ready luminaire connectors enable a simple and consistent factory installed option across all ABL luminaire brands. Refer to RRL for complete nomenclature.

ACCESSORIES order as separate catalog numbers (shipped separately)

SCA6	Sloped ceiling adapter. Degree of slope must be specified (10D, 15D, 20D, 25D, 30D). Ex: SCA6 10D. Refer to TECH-190 .
CTA4-8 YK	Ceiling thickness adapter (extends mounting frame to accommodate ceiling thickness up to 2").
GVRT	Vandal-resistant trim accessory. Refer to TECH-200 .
ISD BC	0-10V wallbox dimmer. Refer to ISD-BC .

FEATURES & SPECIFICATIONS

INTENDED USE — Built on the compact, low-profile Z strip channel, this LED strip offers long maintenance-free life, several color temperatures, lumen outputs and lengths. Ideal for new construction and retrofit applications in T8 lengths. Ideal for uplight and downlight in commercial, retail, manufacturing, warehouse, cove and display applications. **Certain airborne contaminants can diminish integrity of acrylic.** [Click here for Acrylic Environmental Compatibility table for suitable uses.](#)

CONSTRUCTION — Compact-design channel and cover are formed from code-gauge cold-rolled steel. Easy to install row aligner included for continuous row mounting.

Finish: Paint options include high-gloss, baked white enamel (WH), galvanized (GALV), matte black (MB) and smoke gray (SKGY). Five-stage iron phosphate pre-treatment ensures superior paint adhesion and rust resistance.

OPTICS — Standard diffuse snap on/snap off lens eliminates pixels, improves uniformity and minimizes glare. L/LENS option available.

ELECTRICAL — Utilizes high-output LEDs integrated on a two-layer circuit board, ensuring cool-running operation. Internal pluggable wiring harness prevents wiring errors. Electronic LED driver is rated for 75 input watts maximum (see Operational Data on page two for actual wattage consumption), **multi-volt input and 0-10V dimming standard.** This fixture is designed to withstand a maximum line surge of 1.5kV at 0.75kA combination wave for indoor locations, for applications requiring higher level of protection additional surge protection must be provided.

LEDs provide 83 CRI at 3000 K, 3500 K, 4000 K or 5000 K.

Lumen output up to 2,000 lumens per foot. In 86°F (30°C) ambient environments, L70 is predicted to be 100,000+ hours, L85 at 65,000 hours. Luminaire should be installed in applications where ambient temperatures do not exceed 86°F (30°C). Ambient temperatures that exceed 86°F (30°C) will result in reduced life and will void warranty.

INSTALLATION — Tool-less channel cover for easy installation.

Fixture may be surface, pendant or stem mounted. Three-point aligner locks in place for easy continuous row mounting.

LISTINGS — UL Listed. CSA certified to US and Canadian safety standards. For use in damp locations between -4°F (-20°C) and 86°F (30°C).

DesignLights Consortium® (DLC) qualified product. Not all versions of this product may be DLC qualified. Please check the DLC Qualified Products List at www.designlights.org to confirm which versions are qualified.

WARRANTY — 5-year limited warranty. Complete warranty terms located at www.acuitybrands.com/CustomerResources/Terms_and_conditions.aspx

Actual performance may differ as a result of end-user environment and application.

Actual wattage may differ by +/- 5% when operating between 120-277V +/- 10%.

Note: Specifications subject to change without notice.

Catalog Number
Notes
Type Type F1



LED Striplight

ZL1N

24", 48" and 96" Lengths

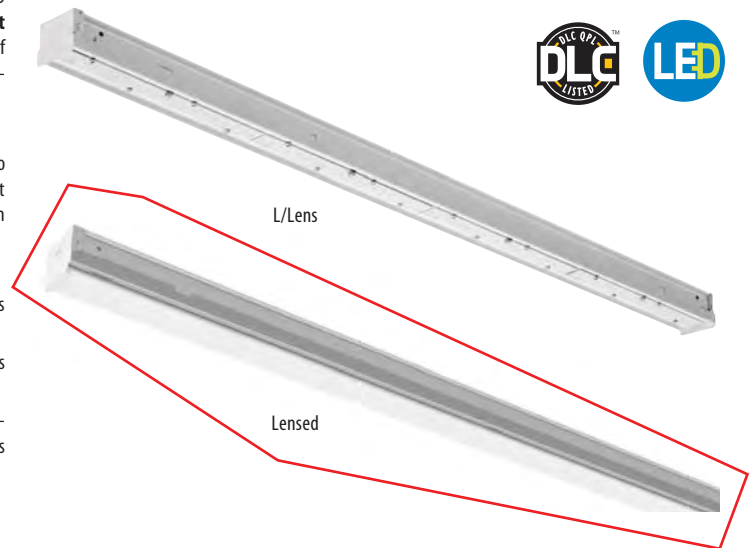

ORDERING INFORMATION

Lead times will vary depending on options selected. Consult with your sales representative.

Example: ZL1N L48 3000LM FST MVOLT 40K 80CRI WH

Series	Length	Nominal lumens ¹	Diffuser	Voltage	Color temperature	Color rendering index	Options	Paint finish
ZL1N LED striplight	L24 24"	3000LM 3,000 lumens	FST Snap on frosted, diffuse	MVOLT 120-277V	40K 4000 K	80CRI 80 CRI	PLR Plug-in wiring ³	WH White
	L46 46"	3000LM 3,000 lumens	L/LENS No diffuser	HVOLT 347-480V ²	30K 3000 K			GALV Galvanized
	L48 48"	5000LM 5,000 lumens			35K 3500 K			MB Matte black
		7000LM 7,000 lumens			50K 5000 K			SKGY Smoke gray
TZL1N LED striplight	L92 92"	6000LM 6,000 lumens						
	L96 96"	10000LM 10,000 lumens						
		14000LM 14,000 lumens						

Accessories: Order as separate catalog number.

HC36	Hanger chain, 36"	ZSPRG	For 15/16" T-grid only
ZACVH	Aircraft cable with hook	WGZ24	24" wireguard, white
LSXR	Sensor Switch® LSXR occupancy sensor ²	WGZ48	48" wireguard, white ⁴

EMERGENCY OPTIONS⁵

Consider EAC ISSM 125 or EAC ISSM 375

Notes

- See Operational Data on page 2 for actual lumens.
- Not available with L24, 24" fixture.
- See ordering information on page 3.
- Order 2 for tandem double length fixtures (TZL1N).
- See ordering information on page 4.

STAIRWELL LIGHT

SLF

SUBMITTAL:

LED

JOB:

TYPE:

VOLTAGE:

EXAMPLE

SLF - 4 - LED*PH75/840 - HIA - OPTIONS - ED*PH - UNV

SERIES

NOMINAL LENGTH

LED PACKAGE

SHIELDING

OPTIONS

DRIVER

VOLTAGE

FEATURES

- Attractive source of direct lighting for use in stairwells and hallways.
- Optional end- or side-mount occupancy sensors provide added energy-efficiency.
- Sleek design for wall or surface-mount applications.
- LEDs are shielded from view by frosted high-impact acrylic lens.
- Heavy-duty 16-gauge C.R.S. spot-welded housing.
- Multiple dimming protocols available.
- Optional system-integrated emergency LED driver available.
- Rated for 50,000 hours at 70% lumen maintenance (L70).
- Minimum 80 CRI; 3000K, 3500K, 4000K CCT.
- Optional tamper-resistant screws available.
- This fixture is proudly made in the USA.

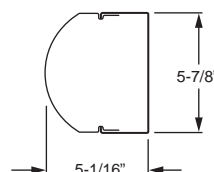

SPECIFICATIONS

Housing – 16-gauge C.R.S.
Shielding – Frosted high-impact acrylic lens, .100" thick.

Finish – 92% minimum average reflective white polyester powder coat bonded to phosphate-free, multi-stage pretreated metal. All parts painted after fabrication to facilitate installation, increase efficiency, and inhibit corrosion.

LED Module – Philips: Fortimo LED light engine. Universal Lighting Technologies: Everline LED light engine.

LED Driver – Constant current, Class 2 driver. Philips, Universal Lighting Technologies, and Lutron drivers available, see back for details.

Mounting – Wall and surface mount.

Labels – cETLus conforms to UL STD 1598 and UL STD 8750. Certified to CAN/CSA STD C22.2 No. 250.0. Suitable for damp locations.

Warranty – 5-year limited fixture warranty, see www.hewilliams.com.

ORDERING INFORMATION

SERIES

SLF Stairwell Light

NOMINAL LENGTH

2 2'
4 4'

LED PACKAGE

See table to right for LED packages.

SHIELDING

HIA Frosted high-impact acrylic
HIA/TP¹ Frosted high-impact acrylic with tamper resistant screws¹

OPTIONS

For color options, visit the SLF online at hewilliams.com.

EM/BSL310 Emergency LED driver (4' only, nominal 1300 lumens module output in EM mode)

TPSN-8¹ #8, tamper-resistant (snake eyes) tool¹

OCCUPANCY SENSORS

Factory-installed (120V or 277V only). See back for details.

Passive Infrared (PIR):

OCCSS SBR-10 End-mount sensor

OCCWS FSP-211² Side-mount sensor

Ultrasonic:

OCCWS FS-505-PP-____ Side-mount sensor (120V or 277V only, must specify voltage)

DRIVER

Philips, Universal Lighting Technologies, and Lutron drivers available, see back for details.

VOLTAGE

UNV 120-277V

LED PACKAGE

LED packages must be specified with corresponding brand or Lutron LED drivers.

EXAMPLE: LED*PH76/840			
LENGTH	LUMEN PACKAGE	NOMINAL LUMENS	MINIMUM CRI & CCT
PHILIPS LED PACKAGES ³			
2'	LED*PH35/	3,500	830 = 80 CRI, 3000K
	LED*PH75/		835 = 80 CRI, 3500K
4'	LED*PH75/	7,500	840 = 80 CRI, 4000K
UNIVERSAL LIGHTING TECHNOLOGIES LED PACKAGES			
2'	LED*UT10	1,000	830 = 82 CRI, 3000K 835 = 82 CRI, 3500K 840 = 82 CRI, 4000K
	LED*UT13	1,300	
	LED*UT17	1,700	
	LED*UT22	2,200	
	LED*UT26	2,600	
	LED*UT32	3,200	
	LED*UT43	4,300	
4'	LED*UT45	4,500	830 = 82 CRI, 3000K 835 = 82 CRI, 3500K 840 = 82 CRI, 4000K
	LED*UT21	2,100	
	LED*UT24	2,400	
	LED*UT31	3,100	
	LED*UT43	4,300	
	LED*UT45	4,500	
	LED*UT62	6,200	
	LED*UT86	8,600	
	LED*UT90	9,000	

F2
F3

¹ Tamper-resistant (TPSN-8) tool is required with HIA/TP option, must be ordered separately. Please specify quantity required per project.

² Optional FSIR-100 remote controller available.

³ Maximum Philips LED lumen packages shown. Lower Philips LED lumen packages available, consult factory.



LED

DRIVER OPTIONS

IMPORTANT:

Electrostatic sensitive unit.
Observe precautions when handling.

PERFORMANCE DATA

Length	LED Package	System Wattage
PHILIPS		
2'	LED*PH35/830	39
	LED*PH35/835	38
	LED*PH35/840	37
4'	LED*PH75/830	79
	LED*PH75/835	77
	LED*PH75/840	76
UNIVERSAL LIGHTING TECHNOLOGIES		
2'	LED*UT10	11
	LED*UT13	12
	LED*UT17	15
	LED*UT22	21
	LED*UT26	23
	LED*UT32	30
4'	LED*UT43	42
	LED*UT45	46
	LED*UT21	21
	LED*UT24	23
	LED*UT31	30
	LED*UT43	42
	LED*UT45	46
	LED*UT62	59
	LED*UT86	84
	LED*UT90	92

Note: Driver must be compatible with LED package. Specify using table below.

CATALOG #	DESCRIPTION	COMPATIBLE LED PACKAGE	
		LED*PH	LED*UT
ED*PH	Philips Xitanium LED driver prewired for non-dimming applications	•	
EDD*PH	Philips Xitanium LED dimming driver prewired for 0-10V controls	•	
EDD*PH*DALI	Philips Xitanium DALI dimming driver	•	
EDSD40*PH	Philips Xitanium 40% step-dimming driver (must specify 120V or 277V)	•	
EDD*PH*MKX	Philips Xitanium Mark X line voltage dimming driver (must specify 120V or 277V)	•	
ED*UT	ULT driver prewired for non-dimming applications		•
EDSD50*UT	ULT driver prewired for 50% step-dimming applications		•
EDD*UT	ULT driver prewired for 0-10V dimming applications		•
EDSD*UT	ULT driver prewired for simultaneous step-dimming and 0-10V dimming applications		•
EDD*LU*HILUME L3D ECO	Lutron Hi-lume® A-Series LED dimming driver for EcoSystem® controls	•	•
EDD*LU*HILUME L3D 3WIRE	Lutron Hi-lume® A-Series LED dimming driver for 3-wire controls	•	•
EDD*LU*HILUME LTE LINE	Lutron Hi-lume® A-Series LED dimming driver for forward phase line voltage controls (120V only)	•	•

PHOTOMETRY – PHILIPS

Catalog #: SLF-4-LED*PH75/840-HIA

TEST REPORT INFORMATION

- Test Report #: 17257.0
- Date: 04/25/13
- Lamp Type: Philips Fortimo LED light engine
- **Rated Lumens: 7522**
- **Watts: 75.8**
- **Lumens Per Watt: 99.2**
- **CRI: 84.8**
- **CCT: 4016K**

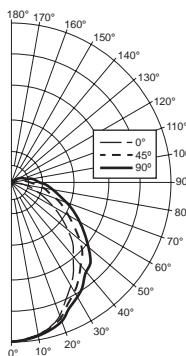

CANDLEPOWER DISTRIBUTION

Vertical Angle	Horizontal Angle			Zonal Lumens
	0°	45°	90°	
0	2443.	2443.	2443.	
5	2411.	2411.	2414.	230.2
15	2287.	2316.	2339.	656.0
25	1971.	2045.	2111.	945.4
35	1649.	1789.	1903.	1119.9
45	1314.	1535.	1713.	1181.3
55	903.	1164.	1360.	1030.8
65	569.	855.	1059.	829.2
75	278.	563.	733.	566.2
85	82.	390.	549.	388.6
90	10.	284.	417.	
95	0.	240.	367.	232.9
105	0.	144.	237.	138.4
115	0.	91.	163.	79.1
125	0.	65.	113.	50.3
135	0.	51.	82.	31.9
145	0.	49.	68.	22.8
155	0.	43.	51.	13.8
165	0.	0.	45.	4.9
175	0.	0.	0.	0.0
180	0.	0.	0.	

LUMEN SUMMARY

Zone	Lumens	% Fixture
0 - 30	1832.	24.4
0 - 40	2951.	39.2
0 - 60	5163.	68.6
0 - 90	6948.	92.4
90 - 120	450.	6.0
90 - 130	501.	6.7
90 - 150	555.	7.4
90 - 180	574.	7.6
Total Luminaire:		
0 - 180	7522.	100.0
IES Spacing Criteria: End = 1.1, Diagonal = 1.2, Across = 1.2		

LOW VOLTAGE MINI COVE

CVM

SUBMITTAL:

LED

JOB:

TYPE:

VOLTAGE:

EXAMPLE

CVM - 8 - 02 - LED*OS - 27K - 12V

SERIES

NOMINAL

LENGTH

LAMP

SPACING

LED

TYPE

COLOR

TEMPERATURE

VOLTAGE

FEATURES

- ▶ Energy-efficient LED cove lighting solution.
- ▶ Directional lighting can be easily achieved by rotating LED festoons.
- ▶ Extruded Noryl® track with 12-gauge solid copper conductors; up to 8' lengths available.
- ▶ 12VAC system includes track, lampholders, OSRAM SYLVANIA lamps, terminal block, and mounting hardware.
- ▶ Track is flexible for 18" lateral and 12" radial curves to fit various applications.
- ▶ Required mounting clips create an air gap to minimize heat transfer; included.
- ▶ Optional accessories available, see Cove Lighting Accessories.
- ▶ UL 2108 listed Class 2 transformer required.
- ▶ L70 of up to 50,000 hours.
- ▶ 85 CRI.
- ▶ This fixture proudly made in the USA.

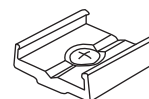
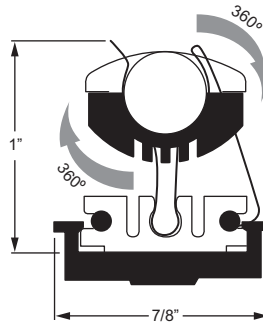

Mounting Clip

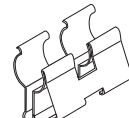

Lampholder

ORDERING INFORMATION

SERIES

CVM Low Voltage LED Mini Cove

NOMINAL LENGTH

1	1'	5	5'
2	2'	6	6'
3	3'	7	7'
4	4'	8	8'

LAMP SPACING

02	2" O.C.
03	3" O.C.
04	4" O.C.
06	6" O.C.

LED TYPE

LED*OS OSRAM SYLVANIA LEDstixx® festoon lamp

COLOR TEMPERATURE

27K	2700K, 20 lumens, 40 LPW, 85 CRI
30K	3000K, 21 lumens, 42 LPW, 85 CRI
40K	4000K, 23 lumens, 46 LPW, 85 CRI

VOLTAGE

12V 12-volt AC system, 99 watts max. per feed

Tables represent non-dimming applications only.

12-VOLT SYSTEM

FEED LENGTH	LAMP WATTAGE	NUMBER OF LAMPS			
		2" O.C.	3" O.C.	4" O.C.	6" O.C.
1'	0.5	6	4	3	2
2'	0.5	12	8	6	4
3'	0.5	19	12	9	6
4'	0.5	25	16	12	8
5'	0.5	32	20	15	10
6'	0.5	39	24	18	12
7'	0.5	45	28	21	14
8'	0.5	52	32	24	16

SPECIFICATIONS

Track – Extruded Noryl® track with 12-gauge solid copper conductors; available in nominal 1' to 8' lengths.

Terminal Block – Set screw connections for power feeds and track connections where junction box is not required. Max. 10 AWG.

Lampholder – Double festoon, nickel-plated brass lampholder snaps into CVM track at any point a lamp is needed. Nominal 2", 3", 4" and 6" O.C. available.

Electrical Package – 0.5-watt, 12VAC, clear, directional LED festoon lamps. UL 2108 listed Class 2 transformer required (furnished by others).¹

Mounting – Easily mounts by snapping into mounting clips, installed 12" O.C. (approximately). Track can be mounted with radial and lateral bends in three mounting positions. Additional clips may be needed for curved applications.

Labels – cETLus conforms to UL STD 1598; Certified to CAN/CSA STD C22.2 No. 250.0. Suitable for dry locations.

¹ When sizing the transformer for this system, the system wattage must be matched to the transformer specifications. H.E. Williams, Inc. recommends that the system wattage is at least 50% of the transformer's rated maximum output.



FEATURES & SPECIFICATIONS

INTENDED USE — The T Series LED surface mount combines digital lighting and control technologies with a high-performance optical system to deliver general ambient lighting for many applications such as schools, offices and hospitals. High-efficacy light engine delivers long life and excellent color, ensuring a superior quality light installation that is highly efficient and sustainable. **Certain airborne contaminants can diminish integrity of acrylic.** [Click here for Acrylic Environmental Compatibility table for suitable uses.](#)

CONSTRUCTION — Housing formed from cold-rolled steel. Housing is painted after fabrication for superior finish.

Smooth hemmed sides and smooth inward-formed end flanges, for easy handling.

Standard extruded aluminum door frame has superior structural integrity with premium appearance and mitered corners. Door frame is painted after fabrication, standard. Powder-painted rotary cam latches provide easy, secure door closure. Integral T-bar clips are standard. Acrylic shielding material is 100% UV stabilized.

OPTICS — Standard pattern #19 lens, 0.156" thick with highly transmissive overlay, is standard for superior brightness control. Overlay is 0.040" thick. Other lenses are available.

ELECTRICAL — Long-life LEDs, coupled with high-efficiency drivers, provide superior level and quality of illumination for extended service life. TLX is rated to deliver L80 performance for 50,000 hours.

Standard nLight® embedded controls continuously monitor system performance, allow for constant lumen management/compensation function, facilitate simple "plug-and-play" network and controls upgrading via CAT5 cable.

LED driver delivers full-range dimming from 0-10V control signal.

Ballast disconnect is provided where required to comply with US and Canadian codes.

INSTALLATION — Surface mount. Drivers and internal components are accessible from floor. LED boards include plug-in connectors for easy replacement or servicing. Suitable for damp location.

LISTINGS — CSA certified to US and Canadian standards.

DesignLights Consortium® (DLC) qualified product. Not all versions of this product may be DLC qualified. Please check the DLC Qualified Products List at www.designlights.org/QPL to confirm which versions are qualified.

WARRANTY — 5-year limited warranty. Complete warranty terms located at www.acuitybrands.com/CustomerResources/Terms_and_conditions.aspx

Actual performance may differ as a result of end-user environment and application.

Note: Specifications subject to change without notice.

Catalog Number
Notes
Type

TLED

Type H

T SERIES SURFACE MOUNT

2TLX2



2' x 2' LED



Specifications

Length: 24-3/4 (62.9)

Width: 24-3/4 (62.9)

Depth: 4-3/4 (12.1)

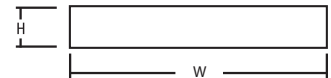

All dimensions are inches (centimeters) unless otherwise indicated.

ORDERING INFORMATION

Lead times will vary depending on options selected. Consult with your sales representative.

Example: 2TLX2 33L FW A19 D38 LP835 N100

2TLX2	33L				D38
Series	Lumens	Door	Lens	Voltage	Wattage
2TLX2 Surface mount LED	33L 3300 lumens ¹	FW Flush aluminum, white RW Regressed aluminum, white	A12 #12 pattern acrylic A19 #19 pattern acrylic, 0.156" thick MWS Matte white .040 thick MPL Micro prism SWL Satin white	(blank) MVOLT (120-277V)	D38 38W ^{2,3}
Color temperature	Control	Options			
LP830 82 CRI, 3000 K ⁴ LP835 82 CRI, 3500 K LP840 82 CRI, 4000 K LP850 82 CRI, 5000 K ⁴	NX Dimming, no nLight BLD Bi-level dimming N80 nLight with 80% (L80) lumen management ⁵ N80EMG nLight with 80% (L80) lumen management for use with generator supply EM power ⁵ N100 nLight without lumen management ⁵ N100EMG nLight without lumen management for use with generator supply EM power ⁵	EL14L 1400 lumen battery pack			

Notes

- Nominal lumens.
- Nominal wattage.
- Actual wattage may differ by +/- 5% when operating between 120-277V +/- 10%.
- Extended lead time.
- Consider CAT5 access when specifying.



CSXW LED LED Wall Luminaire



CONTOUR
SERIES

Type K

Specifications

Height:	7-1/8" (29.2 cm)
Width:	16-3/8" (41.6 cm)
Depth:	9-5/16" (23.6 cm)
Weight (max):	30 lbs (13.6 kg)



Catalog
Number

Notes

Type

Hit the Tab key or mouse over the page to see all interactive elements.

Introduction

The Contour® Series luminaires offer traditional square dayforms with softened edges for a versatile look that complements many applications.

The CSXW LED combines the latest in LED technology with the familiar aesthetic of the Contour® Series for stylish, high-performance illumination that lasts. It is ideal for replacing 100-400W metal halide in wall-mounted applications with typical energy savings of 80% and expected service life of over 100,000 hours.

Ordering Information

EXAMPLE: CSXW LED 30C 700 40K T3M MVOLT DDBXD

CSXW LED								
Series	LEDs	Drive current	Color temperature ¹	Distribution	Voltage	Mounting	Options	Finish <i>(required)</i>
CSXW LED	30C 30 LEDs	700 700 mA 1000 1000 mA	40K 4000K 50K 5000K	T2M Type II, medium T3M Type III, medium T4M Type IV, medium TFTM Type forward throw, medium	MVOLT ² 120 ² 208 ² 240 ² 277 ² 347 ³ 480 ³	Shipped included (blank) Surface mount Shipped separately BBW Surface-mounted back box (for conduit entry) ⁴	Shipped installed PE Photoelectric cell, button type ^{5,6} DMG 0-10V dimming driver (no controls) SF Single fuse (120, 277, 347V) ⁷ DF Double fuse (208, 240, 480V) ⁷ Shipped separately⁴ VG Vandal guard WG Wire guard	DDBXD Dark bronze DBLXD Black DNAXD Natural aluminum DWHXD White DDBTXD Textured dark bronze DBLBXD Textured black DNATXD Textured natural aluminum DWHGXD Textured white

Mounting Detail

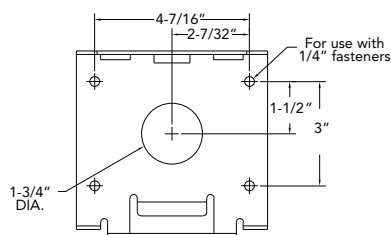

Accessories

Ordered and shipped separately.

CSXWBBW DDBXD U	Back box accessory (specify finish)
CSXWWGU U	Wire guard accessory
CSXWVG U	Vandal guard accessory

NOTES

- 1 Configured with 4000K (/40K) provides the shortest lead times. Consult factory for 5000K (/50K) lead times.
- 2 MVOLT driver operates on any line voltage from 120-277V (50/60 Hz). Specify 120, 208, 240 or 277 options only when ordering with fusing (SF, DF options) or photocontrol (PE option).
- 3 Available with 700 mA options only (30C 700).
- 4 Also available as a separate accessory; see Accessories information at left.
- 5 Photocontrol (PE) requires 120, 208, 240, 277 or 347 voltage option.
- 6 Must be ordered with fixture; cannot be field installed.
- 7 Single fuse (SF) requires 120, 277 or 347 voltage option. Double fuse (DF) requires 208, 240 or 480 voltage option.



One Lithonia Way • Conyers, Georgia 30012 • Phone: 800.279.8041 • Fax: 770.918.1209 • www.lithonia.com
© 2012-2013 Acuity Brands Lighting, Inc. All rights reserved.



VRC LED

LED Canopy/Ceiling Luminaire

Type L

Catalog
Number

Notes

Type

Hit the Tab key or mouse over the page to see all interactive elements.

Specifications

Width: 12-3/8"
(31.5 cm)

Height: 8-3/4"
(22.3 cm)

Depth: 12-3/8"
(31.5 cm)

Weight: 7.5 lbs
(3.4kg)

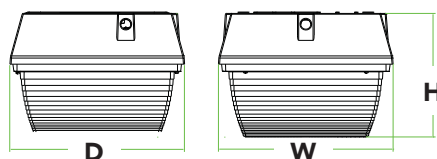

Introduction

The popular VRC luminaire is now available with long-lasting, energy-efficient LED technology. Featuring a classic dayform, the VRC LED offers a traditional appearance and is powered by advanced LEDs.

The VRC LED luminaire is powerful yet energy efficient, capable of replacing up to a 250W metal halide luminaire while saving up to 86% in energy costs. Offering an expected service life of more than 20 years, the VRC LED eliminates frequent lamp and ballast replacements associated with traditional technologies.

Ordering Information

EXAMPLE: VRC LED 1 50K MVOLT

VRC LED				
Series	Performance Package	Color Temperature	Voltage	Finish
VRC LED	1 3389 lumens	50K 5000K ¹	MVOLT ²	(blank) Dark bronze

NOTES

- Correlated color temperature (CCT) shown is nominal per ANSI C78, 377-2008.
- MVOLT driver operates on any line voltage from 120-277V (50/60 Hz).

FEATURES & SPECIFICATIONS

INTENDED USE

41 watt LED ceiling light delivers 3,389 lumens for an energy-efficient replacement of 250W MH canopy/ceiling lights. Traditional style does not detract from current building aesthetics. The VRC LED provides years of maintenance-free general illumination for outdoor applications. Ideal for entrances, parking areas, covered walkways and loading docks.

CONSTRUCTION

Rugged cast-aluminum, corrosion-resistant housing with bronze polyester powder paint for lasting durability. Castings are sealed with a one-piece gasket to inhibit the entrance of external contaminants. Rated for outdoor installations, -40°C minimum ambient.

ELECTRICAL

Two high-powered LEDs provide 3,400 lumens. Includes an MVOLT (120-277V) driver.

OPTICS

High-performance LEDs maintain 84% of light output at 100,000 hours of service life (L84/100,000 hours). Polycarbonate lens is designed for even light distribution.

INSTALLATION

Mounts to a recessed junction box or surface mount with three conduit entry points.

LISTINGS

UL Listed to U.S. and Canadian safety standards for wet locations. Tested in accordance with IESNA LM-79 and LM-80 standards.

WARRANTY

Five-year limited warranty. Full warranty terms located at www.acuitybrands.com/CustomerResources/Terms_and_conditions.aspx.

Note: Specifications are subject to change without notice. Actual performance may differ as a result of end-user environment and application



FEATURES & SPECIFICATIONS

INTENDED USE — Ideal for use in applications where smart, energy-efficient fixtures are desired. Typical applications include parking garage, canopy, transportation, school, hospital, cold storage and exterior retail environments where moisture or dust is a concern. Polycarbonate enclosure protects fixture while remaining easy to service and clean.

CONSTRUCTION — UV-stabilized, injection-molded, impact-resistant, frosted polycarbonate housing with continuous poured-in-place, closed-cell gasket. 20-gauge steel channel and channel cover. Aluminum sheet metal board plate for thermal conduction and support. Fixture design allows for uplight.

OPTICS — UV-stabilized, injection-molded, impact-resistant, clear transparent, polycarbonate lens with aesthetic rib detail (.080" thick). Asymmetric (ASY) optical control film provides broad light distribution (ideal for lower mounting heights). Symmetric (SYM) optical control film is well suited for general lighting environments. Clear transparent, tamper-resistant, polycarbonate latches standard (8 Torx T-20 tamper-resistant screws included). Stainless steel latches also available.

ELECTRICAL — Utilizes high-efficiency LEDs mounted to core circuit boards. 4100 Kelvin temperature standard, with additional color temperatures also available. High efficiency driver operates 100V through 277V, 50-60HZ. Integral surge protection standard and tested in accordance with IEEE/ANSI C62.41.2 to Category C Low. Includes a temperature-sensing component that will limit the temperature of the LEDs in case of excessive ambient temperatures or mis-application. One driver used for 39W and 59W; two drivers used for 79W and 114W. Low (0-10) voltage dimming standard (see options for prewiring). L93 at 60,000 hours (350mA) and L85 at 60,000 hours (525mA).

INSTALLATION — Stainless steel surface spring-mounting brackets standard (2 included) allows for ceiling or suspended mount. A variety of stainless steel mounting options also available: J-box mounting and mounting brackets for suspension with aircraft cable (cable not included). Optional stainless steel V-hooks available for chain hanging (chain not included). Surface conduit entry on each end and on top. For horizontal and vertical mounting on a wall, application must be under a covered ceiling and QMB option recommended. 1/2" - 3/4" KO.

LISTINGS — CSA Certified to UL and C-UL standards. Minimum ambient temperature of -20°F (-29°C) (see matrix on page 2 for maximum ambient temperatures). VAP LED is wet location listed for covered ceiling applications. IP65 and IP66 rated. Product will be rated for damp location only when wall mounted.

See "ARCHWAY™ PASSAGE™ LED Specification Matrix" below for ambient temperature listings.

WARRANTY — 5-year limited warranty. Complete warranty terms located at

www.acuitybrands.com/CustomerResources/Terms_and_conditions.aspx

For installed Rough Service Product(s), Acuity warrants that, for the lifetime of the product(s), the polycarbonate lens and/or polycarbonate housing will withstand breakage resulting from occasional physical abuse and rough handling (the "Rough Service Warranty"), notwithstanding the vandalism exclusion set forth at www.acuitybrands.com/CustomerResources/Terms_and_conditions.aspx

Actual performance may differ as a result of end-user environment and application.

Actual wattage may differ by +/- 5% when operating between 120-277V +/- 10%.

Note: Specifications subject to change without notice.

Catalog Number
Notes
Type

ARCHWAY™
PASSAGE™

Rough Service Fixture

VAP LED

CEILING/
SUSPEND MOUNT

Asymmetric

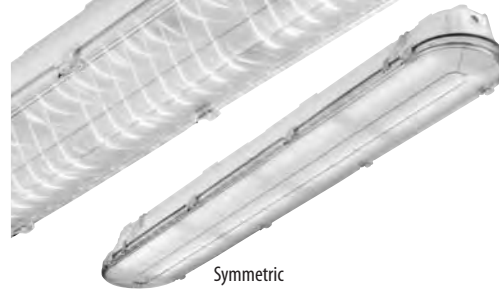

Symmetric



Specifications

Length: 54-3/4 (139.1)

Width: 8-1/4 (21.0)

Depth: 4-1/8 (10.5)

Weight: 13.5 lbs. (5.9 kg)

All dimensions are shown in inches (centimeters) unless otherwise noted.

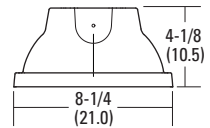

Type M2

Type M1

ORDERING INFORMATION

Lead times will vary depending on options selected. Consult with your sales representative.

Example: VAP 39LED ASY

VAP Series	Wattage/Color temperature ¹	Light control film	Voltage	Options ²
VAP	39LED 39 watts (blank) 4100K (CRI 65)	ASY Asymmetric beam	(blank) MVOLT	SF Single fuse ³
	59LED 59 watts 27 2700K (CRI 80)	SYM Symmetric beam	120 120V	BSL722 Bodine® emergency LED battery pack for 0°C and up ^{3,4}
	79LED 79 watts 35 3500K (CRI 80)		277 277V	BSL722C Bodine® emergency LED battery pack for -20°C and up ^{3,4}
	114LED 114 watts 57 5700K (CRI 70)		347 347V	WLF Wet location fitting (two outboard, top) ⁵
	AMB Amber LED's		480 480V	WLFIN Wet location fitting (two inboard, top) ⁵
				WLFEND Wet location fitting (one end) ⁵
				WLFEND2 Wet location fitting (both ends) ^{5,6}
				CS89 6' white cord, 16/3, no plug, wet location
				CS88 6' Brad Harrison 16/3 cord and straight blade plug set
				CS88L12 12' Brad Harrison 16/3 cord and straight blade plug set
				STSL Stainless steel tamper resistant latches
				QMB Quick-mount ceiling bracket
				CMB Chain-mount suspension bracket
				JSB Junction box snap-bracket
				DIM Pre-wired for 0-10V low-voltage dimming (100-10%)
				DIM2 Line-voltage power control (100-50%) ⁷
				L/SP Less surge protector
				MSI Wet location motion sensor and bracket ^{4,8}
				PE Photoelectric cell (button type) ³
				LSC Lens safety clip

Accessories: Order as separate catalog number. (Ships separately)			
VAPSMB	Surface spring-mount bracket	RK1 T20BIT	Hex base driver bit, Torx T20.
VAPQMB	Quick-mount ceiling bracket		Tamper resistant screws with center reject pin
VAPCMB	Chain-mount bracket ⁹	RK1 T20DRV	Torx T20 screwdriver for use with tamper resistant screws with center reject pin
VAPJSB	Junction box snap bracket		
HC36	Wire hook and 36" chain set ¹⁰		

Notes

- The CCT value provided is of lamp source and actual CCT will vary upon levels.
- For additional options, consult factory.
- Must specify voltage.
- Not available with 114LED.
- 5/8" long NPT threaded hub.
- Not available with cord, sensor or photocell options.

- Available with 79LED and 114LED only.
- For mounting up to 8', specify MS18; for mounting up to 20', specify MS120.
- Requires CMB (chain mount bracket) option.
- For stainless steel, specify STS (example: HC36 STS).

FEATURES & SPECIFICATIONS

INTENDED USE — The OLWP provides years of maintenance-free general illumination for commercial or residential outdoor applications such as driveways, patios, loading areas and warehouses.

CONSTRUCTION — Rugged cast-aluminum, corrosion-resistant rear mounting plate.

Impact resistant polycarbonate front cover/diffuser resists fading and cracking.

Driver operates at 120V.

Operating temperature -30°C to 40°C.

OPTICS — High-performance LEDs maintain 70% of light output at 50,000 hours of service. (LED lifespan based on IESNA LM-80-08 results and calculated per IESNA TM-21-11 methodology.)

Lenses are engineered for superior lighting distribution, uniformity and fixture spacing.

See Lighting Facts Labels for specific fixture performance.

INSTALLATION — Designed for wall mounting more than 4' above the ground. Mounts to a recessed junction box (by others).

LISTINGS — UL Listed to US and Canadian safety standards for wet locations.

WARRANTY — 5-year limited warranty. Complete warranty terms located at

www.acuitybrands.com/CustomerResources/Terms_and_conditions.aspx

Actual performance may differ as a result of end-user environment and application.

Note: Specifications subject to change without notice.

Catalog Number
Notes
Type

Type N

Outdoor General Purpose

OLWP

LED WALL PACK

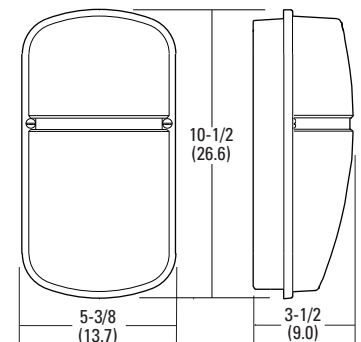

All dimensions are inches (centimeters) unless otherwise indicated.

ORDERING INFORMATION

All configurations of this product are considered "standard" and have short lead times.

Example: OLWP 11 PE BZ

OLWP	11		PE	BZ
Series	Lumens / Color temperature (CCT) ¹	Voltage	Control	Finish
OLWP	11 1096 lumens / 4000K	(blank) 120V	PE Button photocell	BZ Bronze

Notes

1 Nominal Correlated Color Temperature (CCT) per ANSI C78.377-2008.