

5/20/2013 10:55:57 AM z:\My Documents\2067 FFH CF_mattthews.rvt
one-eighth inch = one foot
one-quarter inch = one foot
three-eighths inch = one foot
one-half inch = one foot
three-quarters inch = one foot
one inch = one foot
one and one-half inches = one foot
two inches = one foot
three inches = one foot

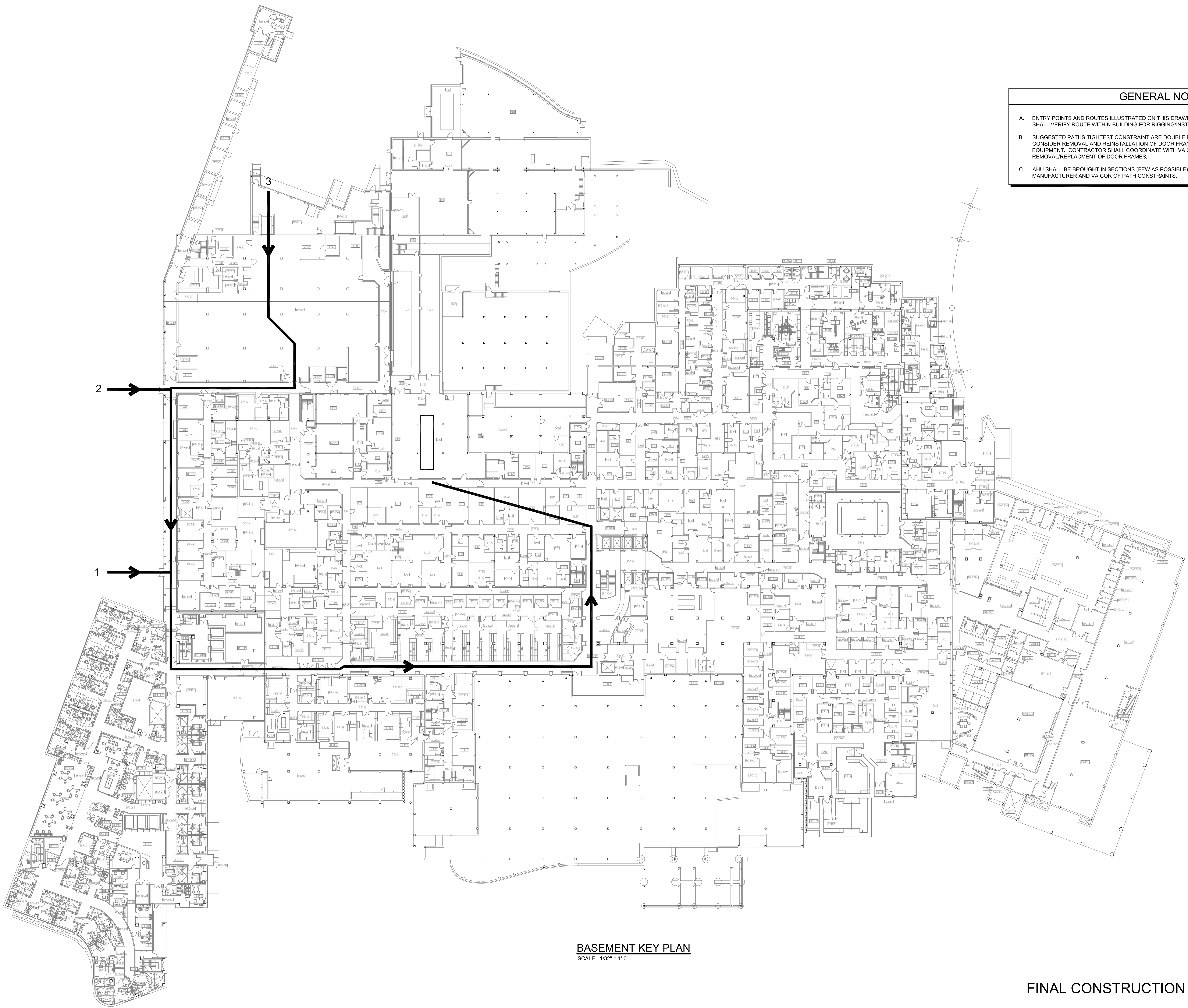

- GENERAL NOTES:**
- A. ENTRY POINTS AND ROUTES ILLUSTRATED ON THIS DRAWING ARE SUGGESTIONS ONLY. CONTRACTOR SHALL VERIFY ROUTE WITHIN BUILDING FOR RIGGING/INSTALLING AHU.
 - B. SUGGESTED PATHS TIGHTEST CONSTRAINT ARE DOUBLE DOOR FRAMES. CONTRACTOR SHALL CONSIDER REMOVAL AND REINSTALLATION OF DOOR FRAMES IN ORDER TO PERMIT PASSAGE OF EQUIPMENT. CONTRACTOR SHALL COORDINATE WITH VA COR ANY NECESSARY REMOVAL/REPLACEMENT OF DOOR FRAMES.
 - C. AHU SHALL BE BROUGHT IN SECTIONS (FEW AS POSSIBLE). CONTRACTOR SHALL NOTIFY MANUFACTURER AND VA COR OF PATH CONSTRAINTS.

BASEMENT KEY PLAN
SCALE: 1/32" = 1'-0"

FINAL CONSTRUCTION DOCUMENTS SUBMISSION
FULLY SPRINKLERED

ADDENDUM #1 08/14/15		CONSULTANTS:		ARCHITECTS:		Drawing Title SUGGESTED OPTIONS FOR AHU INSTALLATION		Project Title ENHANCE MEDICAL, SPECIALTY CARE, AND ADMIN. SERVICES		Office of Facilities Management	
Revisions		Date		13212 Shaker Square Suite 204 Cleveland, Ohio 44120 P. 216.752.1800 F. 216.752.3833		Approved: Project Director		Location VAMC - WADE PARK		Department of Veterans Affairs	
		FREDRICK, FREDRICK & HELLER ENGINEERS, INC. 672 EAST ROYALTON ROAD BROADVIEW HTS., OHIO 44147 TEL: (440) 546-9696 FAX: (440) 546-9699		1100 West 9th Street Cleveland, OH 44113-1003 216-875-0100 (F) 216-875-0111 barberhoffman.com				Building Number 1			
		BARBER & HOFFMAN, INC. Consulting Engineers						Drawing Number 1-H0.3B			
								Date 11/04/2014		Dwg. of -	
								Checked LDH			
								Drawn LDH			