

A  
ONE INCH = FORTY FEET (1" = 40')  
0' 15' 30' 45' 60' 75' 90'

B  
THREE INCHES = ONE FOOT  
0' 6" 12" 18" 24" 30" 36" 42" 48" 54" 60" 66" 72" 78" 84" 90'

C  
ONE AND ONE HALF INCHES = ONE FOOT  
0' 6" 12" 18" 24" 30" 36" 42" 48" 54" 60" 66" 72" 78" 84" 90'

D  
THREE QUARTERS INCH = ONE FOOT  
0' 6" 12" 18" 24" 30" 36" 42" 48" 54" 60" 66" 72" 78" 84" 90'

E  
ONE HALF INCH = ONE FOOT  
0' 6" 12" 18" 24" 30" 36" 42" 48" 54" 60" 66" 72" 78" 84" 90'

F  
ONE QUARTER INCH = ONE FOOT  
0' 6" 12" 18" 24" 30" 36" 42" 48" 54" 60" 66" 72" 78" 84" 90'

G  
ONE EIGHT INCH = ONE FOOT  
0' 6" 12" 18" 24" 30" 36" 42" 48" 54" 60" 66" 72" 78" 84" 90'

H  
ONE SIXTEENTH INCH = ONE FOOT  
0' 6" 12" 18" 24" 30" 36" 42" 48" 54" 60" 66" 72" 78" 84" 90'

NEW AND OLD ROOM NUMBERS LEGEND

NEW	OLD	NEW	OLD
1N121	1N116	1N122	1N129
1N121A	1N116A	1N122A	1N129B
1N121B	1N114	1N122B	1N129C
1N121C	1N112	1N124	1N131

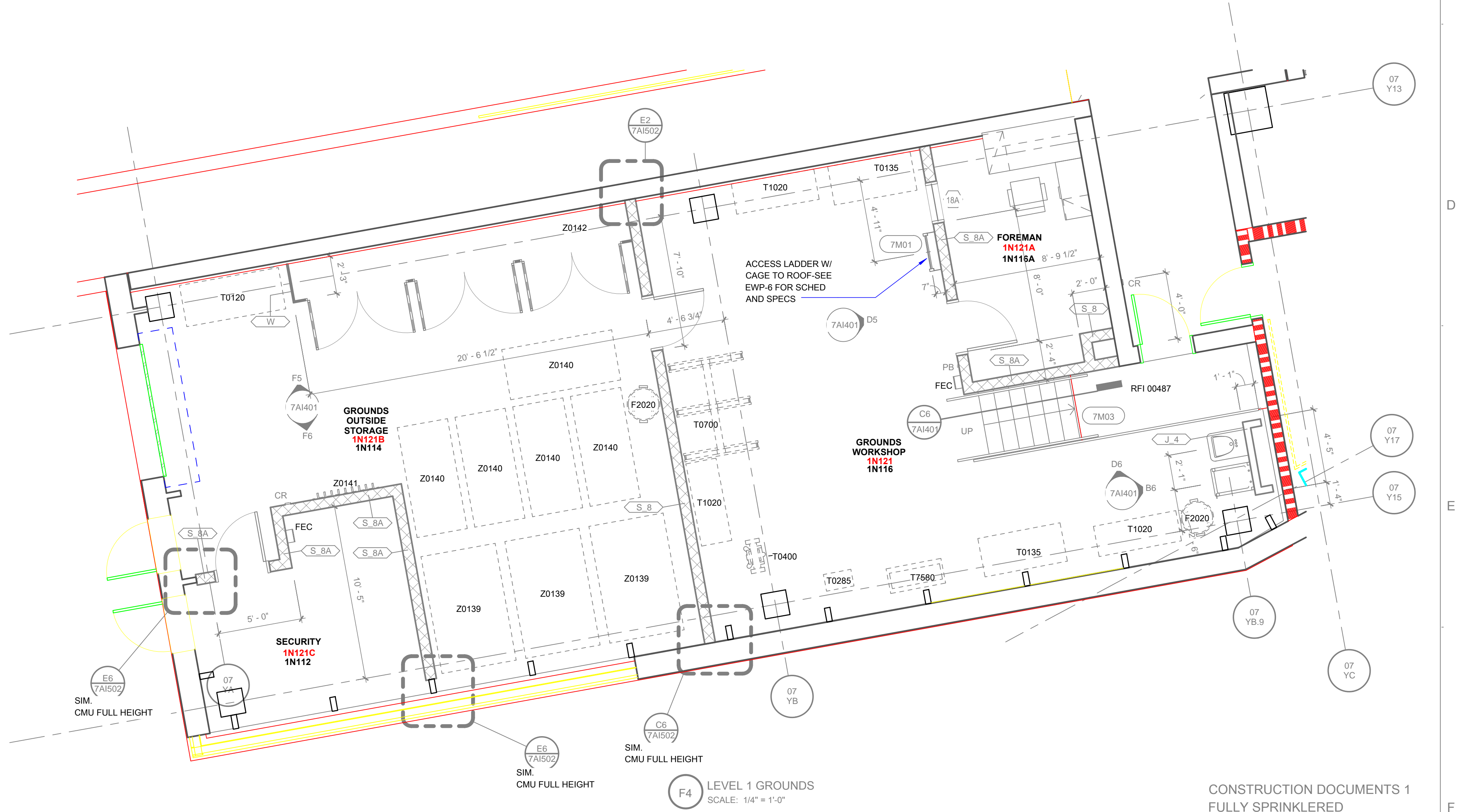
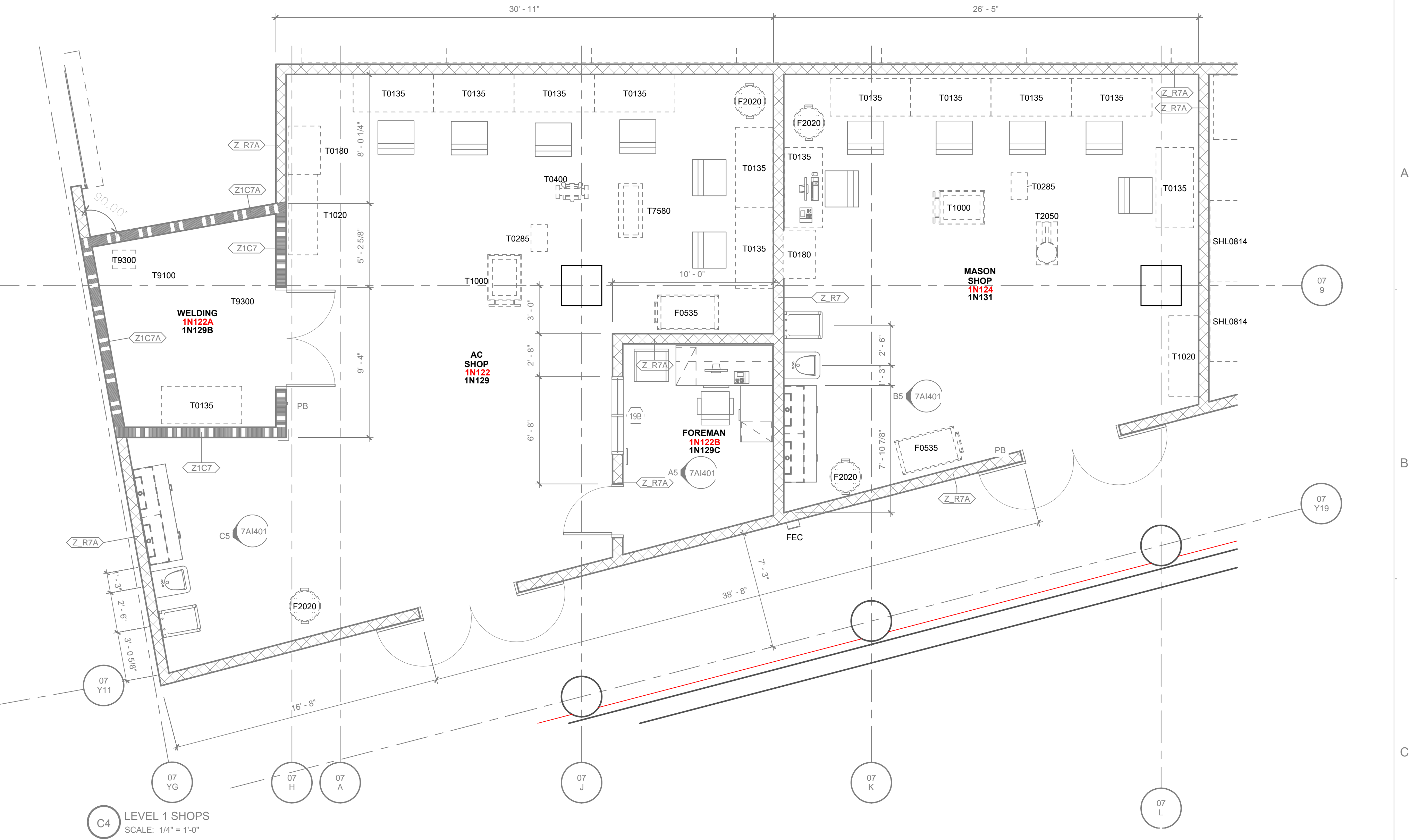

3	RFI Responses	5/1/2012
REVISIONS:		DATE

**CONSULTANTS:**  
DESMAN ASSOCIATES / PARKING  
CODE CONSULTANTS, INC. / CODE CONSULTANT  
THE SEXTANT GROUP / AV & ACOUSTICAL  
HAMMER DESIGN ASSOCIATES / FOOD SERVICE  
PYBURN & ODOM / ABATEMENT  
TATA & HOWARD / TANK CONSULTANT

**ARCHITECT/ENGINEERS:**  
SCHRENK & PETERSON CONSULTING ENGINEERS / CIVIL  
KORDA/NEMETH ENGINEERING / STRUCTURAL  
BR+A CONSULTING ENGINEERS / MECH, ELECT, PLUMBING, LOW VOLTAGE  
ARCHITECTURAL ENGINEERING / PLUMBING  
SCALES ASSOCIATES / FIRE PROTECTION

DRAWING TITLE  
BLDG 7 ENLARGED VIEWS

APPROVED: PROJECT DIRECTOR

PROJECT TITLE  
SLVHCS REPLACEMENT MEDICAL CENTER PROJECT

LOCATION  
NEW ORLEANS, LOUISIANA

DATE  
February 29, 2012

CHECKED  
DV

DRAWN  
JEN

PROJECT NUMBER  
629-HS2-401

BUILDING NUMBER  
7

DOCUMENT SET PACKAGE  
WP\_08

DRAWING NUMBER  
7A1401

CONSTRUCTION DOCUMENTS 1  
FULLY SPRINKLERED

OFFICE OF  
CONSTRUCTION  
AND FACILITIES  
MANAGEMENT

Department of  
Veterans Affairs