

Key Notes (X) INDICATES KEY NOTE ON THIS SHEET.

- EXISTING MANHOLE.
- ALTERNATE #2 - REMOVE EXISTING TRANSFORMER TO BE REPLACED.
- EXISTING PULLBOX TO REMAIN. REMOVE EXISTING FEEDERS CONTAINED WITHIN. (NOTE: VA TO CONFIRM EXISTING FEEDERS WITHIN PULLBOX FEED T-7 WITH NO OTHER FEEDERS CONTAINED WITHIN).
- INVESTIGATE EXISTING PULLBOX. PULLBOXES WHICH ARE A PART OF RACEWAY SYSTEM ROUTED FROM OLD "SWBD-4" TO SWITCHBOARD "BLDG 7" SHALL REMAIN. REMOVE PULLBOXES WHICH ARE RADIALLY SERVED DEAD ENDS AND DO NOT CONSTITUTE A CONTINUATION OF THE DUCTBANKS.
- RELOCATE EXISTING STORAGE CONTAINER.

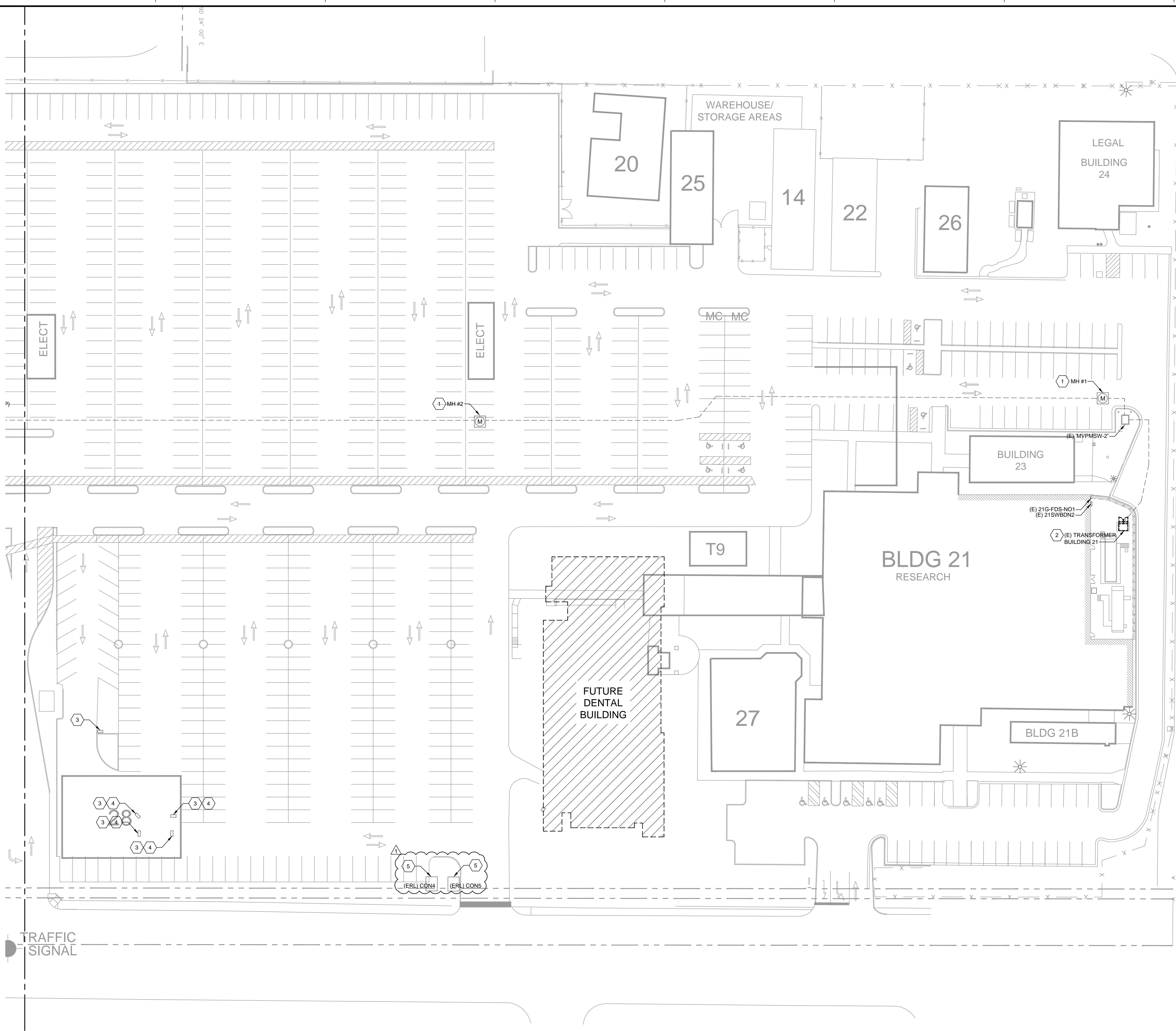

1 OVERALL ELECTRICAL SITE PLAN - NORTH
1" = 30'-0"

<div>Revisions</div> <div>ADDENDUM NO. 1</div> <div>08/18/2015</div> <div>Date</div>		<div>CONSULTANT:</div> <div></div>	<div>CONSULTANT:</div> <div>Westlake Reed Leskosky</div> <div>One East Camelback Road Suite 690 Phoenix, Arizona 85012 www.WRLdesign.com</div>	<div>ARCHITECT/ENGINEERS:</div> <div>AES Group, Inc.</div> <div>11021 SOUTH PIKES PEAK DRIVE #202 PARADISE, COLORADO 80138 PH: 303.843.3922 WWW.AES-GRP.COM</div>	<div>Drawing Title</div> <div>OVERALL ELECTRICAL SITE PLAN - NORTH</div> <div>Approved Project Director</div>	<div>Project Title</div> <div>SITE ELECTRICAL DISTRIBUTION UPGRADE</div> <div>Location</div> <div>PHOENIX, AZ</div> <div>Date</div> <div>03-06-2015</div> <div>Checked</div> <div>Drawn</div>	<div>Project Number</div> <div>644-13-015 / 644-14-003</div> <div>Building Number</div> <div>1, 8, 16, 21, 31</div> <div>Drawing Number</div> <div>ESD-100B</div> <div>Dwg. -- of 49</div>	<div>Office of Construction and Facilities Management</div> <div>Department of Veterans Affairs</div>
--	--	------------------------------------	---	--	---	---	--	---