

		AMERICAN ENGINEERS, INC.						B-3			
		PROFESSIONAL ENGINEERING 65 Aberdeen Drive Glasgow, KY 42141 (270) 651-7220						PAGE 1 OF 1			
CLIENT ANDERSON ENGINEERING OF MN LLC		PROJECT NAME CNNC WASH BAY & STORAGE BUILDING									
PROJECT NUMBER 214-085		PROJECT LOCATION JESSAMINE COUNTY, KY									
DATE STARTED 5/20/14 COMPLETED 5/20/14		GROUND ELEVATION 935.2 ft									
DRILLER Don Cash		GROUND WATER LEVELS:									
DRILLING METHOD Hollow Stem Auger		AT TIME OF DRILLING ---									
LOGGED BY Zack Pennington CHECKED BY Dusty Barrett		AT END OF DRILLING ---									
NOTES		AFTER DRILLING ---									
DEPTH (ft)	GRAPHIC LOG	MATERIAL DESCRIPTION	SAMPLE TYPE NUMBER	RECOVERY % (RQD)	BLOW COUNTS (N-VALUE)	POCKET PEN. (tsf)	MOISTURE CONTENT (%)	ATTERBERG LIMITS			REMARKS
								LIQUID LIMIT	PLASTIC LIMIT	PLASTICITY INDEX	
0		Topsail (14")	X SS 1	67	3-5-5 (10)	3.0	27				
		(CL) Lean CLAY, trace gravel, brown, dry to moist, medium stiff	X SS 2	40	3-3-5 (8)	1.0	28				
5			ST 3	100		2.25	36				
			X SS 4	100	3-2-3 (5)	1.5	41				
10			X SS 5	100	2-3-5 (8)	1.5	39				
15			X SS 6	67	4-8-8 (16)	3.25	36				
		Bottom of borehole at 16.5 feet.									



100% CONSTRUCTION DOCUMENTS



1
D-1.02

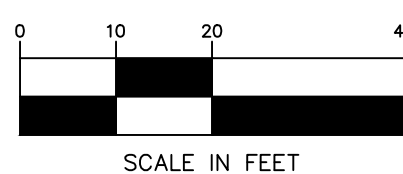

SEQUENCE 1 ITEMS:

1. SECURE SITE WITH CONSTRUCTION FENCING.
2. MAINTAIN ACCESS TO EXISTING PUBLIC RESTROOMS.
4. COORDINATE RELOCATION OF PROPANE TANK WITH PROPANE SUPPLIER. SEE MECHANICAL PLANS.
5. RELOCATE GENERATOR AND RECONNECT POWER.
6. CONSTRUCT NEW BUILDING AND FRONT ENTRANCE SIDEWALK.
7. SECURE MAINTENANCE YARD AREA.
8. LANDSCAPE RESTORATION.



2
0-1.02

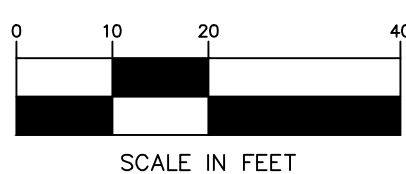

SEQUENCE 2 ITEMS:

1. COORDINATE WITH COR AND CEMETERY DIRECTOR FOR ACCESS TO MAINTENANCE YARD.
2. REMOVE AND DISPOSE OF EXISTING FENCE ALONG SIDEWALK.
3. CONSTRUCT CONCRETE DRIVEWAY AND COURTYARD ELEMENTS, DEMOLISH STORAGE BIN WALLS AND RESTORE PAVEMENT.
4. LANDSCAPE RESTORATION.
5. DECOMMISSION PUBLIC RESTROOMS (BY OTHERS).

NOTES

1. NOTIFY COR AND CEMETERY DIRECTOR OF STREET AND UTILITY CONSTRUCTION OR CLOSURE SCHEDULE.
2. THE CONTRACTOR SHALL AVOID DAMAGE TO EXISTING SITE ELEMENTS THAT ARE TO REMAIN, INCLUDING BUT NOT LIMITED TO: CURB & GUTTER, TREES, UTILITIES AND OTHER CEMETERY FEATURES. CONTRACTOR SHALL BE RESPONSIBLE TO REPAIR AND/OR REPLACE ANY SITE ELEMENT TO REMAIN THAT IS DAMAGED BY CONSTRUCTION ACTIVITIES AT NO ADDITIONAL COST TO OWNER. CONTRACTOR SHALL NOT DISTURB EXISTING SITE OUTSIDE OF FENCED OR CONSTRUCTION LIMITS UNLESS OTHERWISE NOTED ON PLANS.
3. CONTRACTOR TO CONTAIN ALL EQUIPMENT/TRUCKS AND VEHICLES TO CONSTRUCTION ZONE. NO HEAVY TRUCKS/EQUIPMENT ALLOWED ON CEMETERY ROADWAY OTHER THAN ROUTE SHOWN ON CONSTRUCTION ACCESS & STAGING PLAN.
4. CONSTRUCTION ACTIVITIES SHALL NOT IMPACT NORMAL OPERATIONS OF CEMETERY STAFF AND MAINTENANCE PERSONNEL. COORDINATE MAINTENANCE YARD GATE ACCESS WITH CEMETERY DIRECTOR DURING SEQUENCE 2 WORK.
5. SEQUENCE ZONES SHOWN ARE APPROXIMATE. CONTRACTOR TO VERIFY WITH CEMETERY DIRECTOR AND COR BEST AREAS FOR CONSTRUCTION AND DEMOLITION WORK TO MAINTAIN CEMETERY OPERATIONS.
6. SEQUENCE ITEMS ARE IN NO PARTICULAR ORDER. CONTRACTOR TO SEQUENCE AS NEEDED FOR CONSTRUCTION.

LEGEND



SEQUENCE 1 WORK

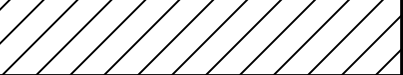

SEQUENCE 2 WORK

CONSTRUCTION LIMITS

[illegible]

three inches = one foot
one and one half inches = one foot
one inch = one foot
three quarters inch = one foot
one half inch = one foot
three eighths inch = one foot
one quarter inch = one foot
one eighth inch = one foot
one sixteenth inch = one foot

VA 13600 (3/06) VA NCA IDQ - Camp Nelson New Wash Bay - Storage Building- Nicholasville, KY (Dwg=C&A/Civil-D-1.01) DEMOLITION PLAN.dwg 5-27-15 11:22:31 AM daster

CALL 48 HOURS BEFORE DIGGING
Utilities Underground Location Center
DIAL 811
Know what's below.
Call before you dig.

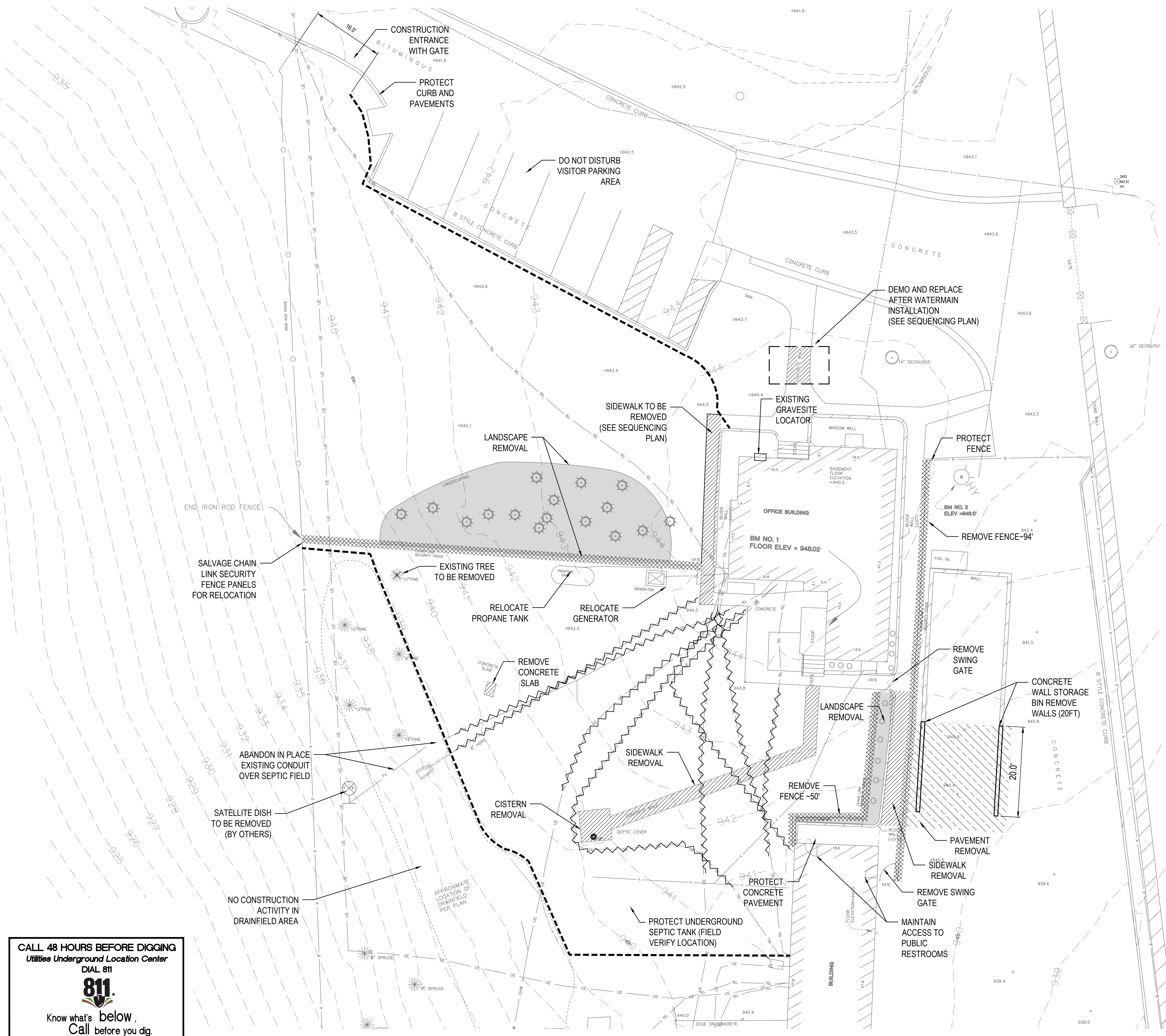

DEMOLITION NOTES - CONSTRUCTION

- CONTRACTOR IS RESPONSIBLE FOR OBTAINING ALL PERMITS AND DISPOSAL CERTIFICATIONS. CONTRACTOR RESPONSIBLE FOR OBTAINING ALL NECESSARY CONSTRUCTION PERMITS TO CARRY OUT ENTIRE PROJECT. PERMITS SHALL BE IN PLACE PRIOR TO ANY CONSTRUCTION ACTIVITIES. NOTIFY APPROPRIATE UTILITY COMPANY OF ANY AND ALL PROPOSED WORK.
- VERIFY LOCATION OF DRAINFIELD PRIOR TO CONSTRUCTION. PROVIDE CONSTRUCTION FENCE AROUND PERIMETER. NO CONSTRUCTION ACTIVITY ALLOWED OVER DRAINFIELD.
- ALL EXISTING BURIED UTILITY LINE LOCATIONS ARE APPROXIMATE ONLY. CONTRACTOR IS RESPONSIBLE FOR FIELD LOCATING EXISTING UTILITIES PRIOR TO EXCAVATION, DEMOLITION OR RECONNECTION. CONTRACTOR TO VERIFY BURIED UTILITY LOCATIONS WITH "811" UNDERGROUND UTILITIES LOCATION CENTER AND/OR PRIVATE LOCATE.
- UNSATURABLE, NON-STRUCTURAL FILL MATERIAL SHALL BE REMOVED WITHIN WORK AREA. SEE SPECIFICATIONS AND APPENDICES IN SPECIFICATIONS FOR REPORT OF GEOTECHNICAL EXPLORATION.
- INSTALL TEMPORARY ROCK CONSTRUCTION ENTRANCE. (SEE L-2.01 - SEDIMENT & EROSION CONTROL PLAN)
- NOTIFY COR AND CEMETERY DIRECTOR FOR CONSTRUCTION ACTIVITIES IN GATED MAINTENANCE AREAS.
- CONTRACTOR TO COORDINATE WITH COR, UTILITY COMPANIES AND CITY FOR TEMPORARY UTILITY CONNECTION/DISCONNECTIONS.
- INSTALL SILT FENCE ON ALL DOWN SLOPE AREAS AND AS SHOWN ON PLANS. (SEE L-2.01 - SEDIMENT & EROSION CONTROL PLAN)
- ADJUST AND/OR REINSTALL SILT FENCE AS NECESSARY. (SEE L-2.01 - SEDIMENT & EROSION CONTROL PLAN FOR COMPLETE SILT FENCE AND EROSION CONTROL PRACTICES.)
- ALL WATER DISRUPTIONS SHALL BE LIMITED TO NO MORE THAN FOUR HOURS DURING NORMAL BUSINESS HOURS AND SCHEDULED AT TIMES THAT LEAST INCONVENIENCE CEMETERY OPERATIONS. LONGER SHUTDOWNS CAN ONLY BE APPROVED FOR EVENINGS OR WEEKENDS. ALL SHUTDOWNS MUST BE APPROVED BY COR AND COORDINATED WITH CEMETERY DIRECTOR.
- TREE REMOVAL SHALL INCLUDE CUTTING, DISPOSAL AND STUMP/ROOT REMOVAL TO A MINIMUM DEPTH OF 4 FT BELOW FINISHED GRADE. ONSITE BURIAL OF REMOVED VEGETATION IS NOT PERMITTED.
- CONTRACTOR TO CONTAIN ALL EQUIPMENT/TRUCKS AND VEHICLES TO CONSTRUCTION ZONE. NO HEAVY TRUCKS/EQUIPMENT ALLOWED ON CEMETERY ROADWAY OTHER THAN ROUTE SHOWN ON CONSTRUCTION ACCESS & STAGING PLAN.
- LIMIT LANDSCAPE REMOVAL AS SHOWN ON PLANS.
- PRIOR TO CONSTRUCTION, CONTRACTOR SHALL PROVIDE PRE-CONSTRUCTION CONDITION REPORT OF ALL ACCESS ROUTES AND ROADS AND HAVE IT APPROVED BY COR. DAMAGE TO EXISTING ROADS THAT ARE USED AS DELIVERY ACCESS ROUTES DURING CONSTRUCTION SHALL BE REVIEWED BY THE COR FOR IMPLEMENTATION OF REPAIR.
- CONTRACTOR TO TRIMPRUNE OVERHANGING TREE BRANCHES/LIMBS AS NECESSARY TO COMPLETE CONSTRUCTION. ALL WORK SHALL BE PERFORMED IN ACCORDANCE WITH AMERICAN NATIONAL STANDARDS INSTITUTE (ANSI) A30D PRUNING STANDARDS AND 2133.3 SAFETY STANDARDS. ALL WORK SHALL BE PERFORMED UNDER THE SUPERVISION OF A LICENSED CERTIFIED ARBORIST.
- GREAT CARE SHALL BE TAKEN BY THE CONTRACTOR TO AVOID DAMAGE TO EXISTING SITE ELEMENTS THAT ARE TO REMAIN, INCLUDING BUT NOT LIMITED TO: CURB & GUTTER, TREES, UTILITIES AND OTHER CEMETERY BUILDINGS AND FEATURES. CONTRACTOR SHALL BE RESPONSIBLE TO REPAIR AND/OR REPLACE ANY SITE ELEMENT TO REMAIN THAT IS DAMAGED BY CONSTRUCTION ACTIVITIES AT NO ADDITIONAL COST TO OWNER. CONTRACTOR SHALL NOT DISTURB EXISTING SITE OUTSIDE OF FENCED OR WORK ZONE AREAS UNLESS OTHERWISE NOTED ON PLANS.
- CONTRACTOR TO VIDEO EXISTING SANITARY LINE FROM SEPTIC TANK TO DRAINFIELD. SEE UTILITY PLAN AND SPECIFICATIONS.
- CONCRETE STORAGE BIN WALLS SHALL BE REMOVED TO A DEPTH OF 12" BELOW FINISHED GRADE. REMAINDER OF FOOTING MAY STAY IN PLACE.
- ALL PAVEMENT AND SIDEWALK REMOVAL AREAS SHALL BE SAWCUT TO FULL DEPTH.
- SEE MECHANICAL PLANS INFORMATION REGARDING PROPANE TANK AND GENERATOR RELOCATION.
- CONTRACTOR SHALL REMOVE TEMPORARY CONSTRUCTION FENCE UPON COMPLETION OF PROJECT.

LEGEND

- BORING
- CULVERT
- CLEAN OUT
- CATCH BASIN
- CONTROL POINT
- HYDRANT
- LIGHT POLE
- MANHOLE
- POWER POLE
- WATER VALVE
- CONIFEROUS TREE
- DECIDUOUS TREE
- CHAIN LINK FENCE
- ROD IRON FENCE
- GAS MAIN
- OVERHEAD WIRES
- STORM SEWER
- STORM SEWER PER PLANS
- TEMP. CHAIN LINK FENCE
- UNDERGROUND ELECTRIC
- WATER MAIN
- SANITARY SEWER
- TEMP. CONSTRUCTION FENCE (3" PLASTIC MESH)
- UTILITY REMOVAL (LIMITS ARE APPROXIMATE)
- TREE/SHRUB REMOVAL
- CONSTRUCTION ENTRANCE GATE
- LANDSCAPE REMOVAL
- SIDEWALK REMOVAL
- CONCRETE PAVEMENT REMOVAL
- CHAIN LINK FENCE REMOVAL

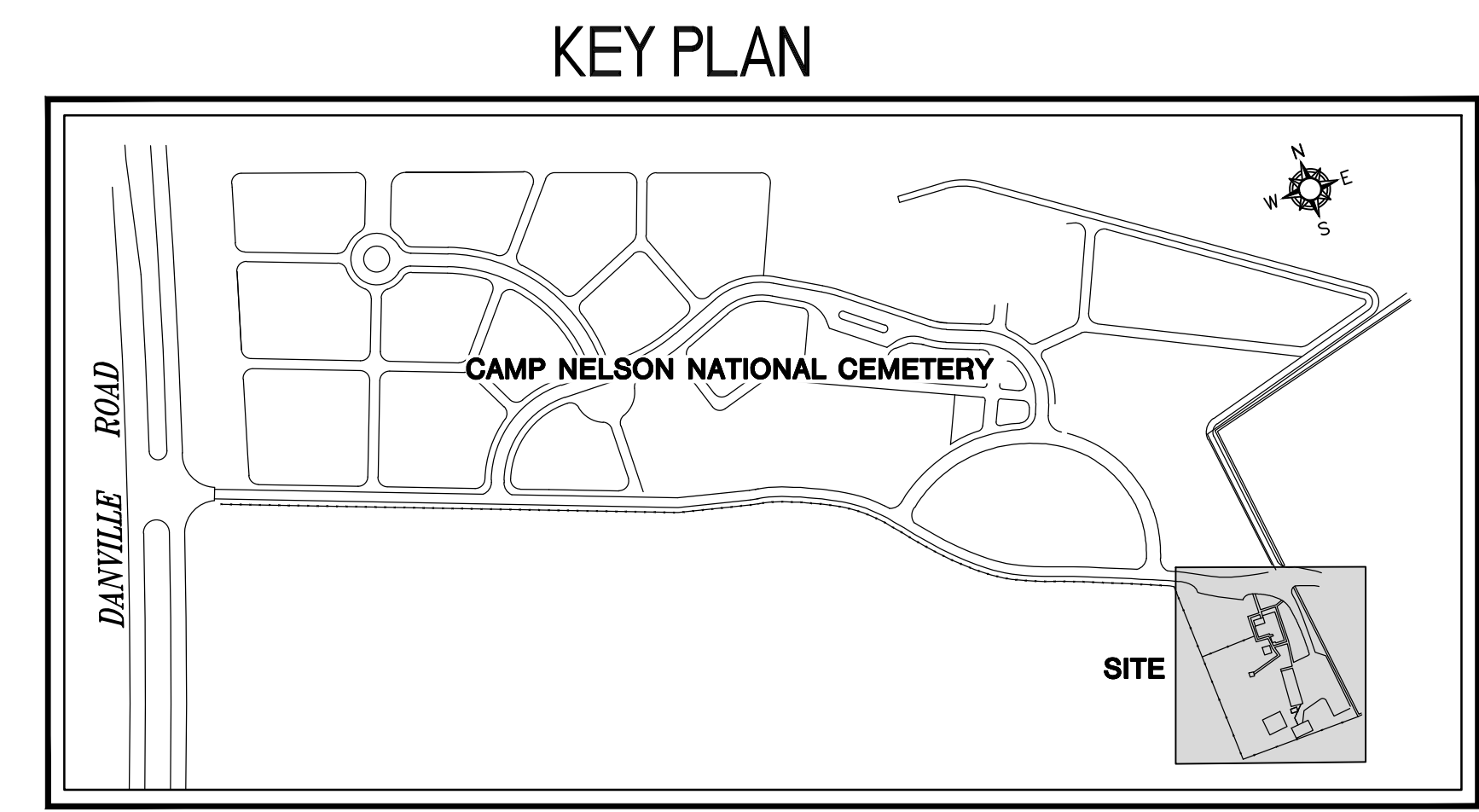
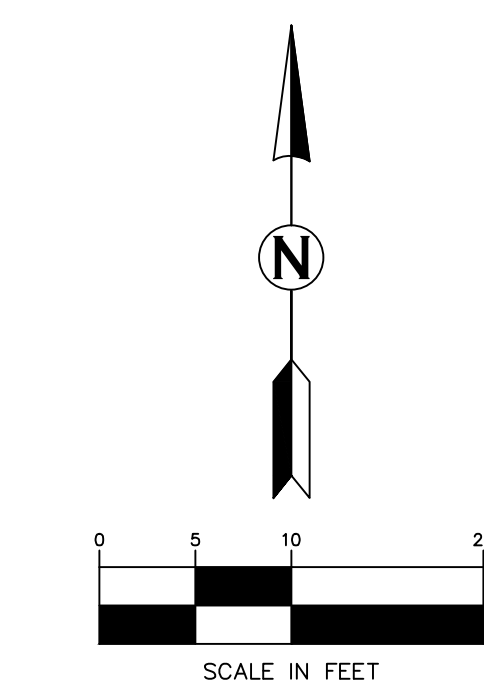

100% CONSTRUCTION DOCUMENTS

--	--	--	--	--	--	--	--	--	--	--	--	--	--	--	--	--	--	--	--	--	--	--	--	--	--	--	--	--	--	--	--	--	--	--	--	--	--	--	--	--	--	--	--	--	--	--	--	--	--	--	--	--	--	--	--	--	--	--	--	--	--	--	--	--	--	--	--	--	--	--	--	--	--	--	--	--	--	--	--	--	--	--	--	--	--	--	--	--	--	--	--	--	--	--	--	--	--	--	--	--	--	--	--	--	--	--	--	--	--	--	--	--	--	--	--	--	--	--	--	--	--	--	--	--	--	--	--	--	--	--	--	--	--	--	--	--	--	--	--	--	--	--	--	--	--	--	--	--	--	--	--	--	--	--	--	--	--	--	--	--	--	--	--	--	--	--	--	--	--	--	--	--	--	--	--	--	--	--	--	--	--	--	--	--	--	--	--	--	--	--	--	--	--	--	--	--	--	--	--	--	--	--	--	--	--	--	--	--	--	--	--	--	--	--	--	--	--	--	--	--	--	--	--	--	--	--	--	--	--	--	--	--	--	--	--	--	--	--	--	--	--	--	--	--	--	--	--	--	--	--	--	--	--	--	--	--	--	--	--	--	--	--	--	--	--	--	--	--	--	--	--	--	--	--	--	--	--	--	--	--	--	--	--	--	--	--	--	--	--	--	--	--	--	--	--	--	--	--	--	--	--	--	--	--	--	--	--	--	--	--	--	--	--	--	--	--	--	--	--	--	--	--	--	--	--	--	--	--	--	--	--	--	--	--	--	--	--	--	--	--	--	--	--	--	--	--	--	--	--	--	--	--	--	--	--	--	--	--	--	--	--	--	--	--	--	--	--	--	--	--	--	--	--	--	--	--	--	--	--	--	--	--	--	--	--	--	--	--	--	--	--	--	--	--	--	--	--	--	--	--	--	--	--	--	--	--	--	--	--	--	--	--	--	--	--	--	--	--	--	--	--	--	--	--	--	--	--	--	--	--	--	--	--	--	--	--	--	--	--	--	--	--	--	--	--	--	--	--	--	--	--	--	--	--	--	--	--	--	--	--	--	--	--	--	--	--	--	--	--	--	--	--	--	--	--	--	--	--	--	--	--	--	--	--	--	--	--	--	--	--	--	--	--	--	--	--	--	--	--	--	--	--	--	--	--	--	--	--	--	--	--	--	--	--	--	--	--	--	--	--	--	--	--	--	--	--	--	--	--	--	--	--	--	--	--	--	--	--	--	--	--	--	--	--	--	--	--	--	--	--	--	--	--	--	--	--	--	--	--	--	--	--	--	--	--	--	--	--	--	--	--	--	--	--	--	--	--	--	--	--	--	--	--	--	--	--	--	--	--	--	--	--	--	--	--	--	--	--	--	--	--	--	--	--	--	--	--	--	--	--	--	--	--	--	--	--	--	--	--	--	--	--	--	--	--	--	--	--	--	--	--	--	--	--	--	--	--	--	--	--	--	--	--	--	--	--	--	--	--	--	--	--	--	--	--	--	--	--	--	--	--	--	--	--	--	--	--	--	--	--	--	--	--	--	--	--	--	--	--	--	--	--	--	--	--	--	--	--	--	--	--	--	--	--	--	--	--	--	--	--	--	--	--	--	--	--	--	--	--	--	--	--	--	--	--	--	--	--	--	--	--	--	--	--	--	--	--	--	--	--	--	--	--	--	--	--	--	--	--	--	--	--	--	--	--	--	--	--	--	--	--	--	--	--	--	--	--	--	--	--	--	--	--	--	--	--	--	--	--	--	--	--	--	--	--	--	--	--	--	--	--	--	--	--	--	--	--	--	--	--	--	--	--	--	--	--	--	--	--	--	--	--	--	--	--	--	--	--	--	--	--	--	--	--	--	--	--	--	--	--	--	--	--	--	--	--	--	--	--	--	--	--	--	--	--	--	--	--	--	--	--	--	--	--	--	--	--	--	--	--	--	--	--	--	--	--	--	--	--	--	--	--	--	--	--	--	--	--	--	--	--	--	--	--	--	--	--	--	--	--	--	--	--	--	--	--	--	--	--	--	--	--	--	--	--	--	--	--	--	--	--	--	--	--	--	--	--	--	--	--	--	--	--	--	--	--	--	--	--	--	--	--	--	--	--	--	--	--	--	--	--	--	--	--	--	--	--	--	--	--	--	--	--	--	--	--	--	--	--	--	--	--	--	--	--	--	--	--	--	--	--	--	--	--	--	--	--	--	--	--	--	--	--	--	--	--	--	--	--	--	--	--	--	--	--	--	--	--	--	--	--	--	--	--	--	--	--	--	--	--	--	--	--	--	--	--	--	--	--	--	--	--	--	--	--	--	--	--	--	--	--	--	--	--	--	--	--	--	--	--	--	--	--	--	--	--	--	--	--	--	--	--	--	--	--	--	--	--	--	--	--	--	--	--	--	--	--	--	--	--	--	--	--	--	--	--	--	--	--	--	--	--	--	--	--	--	--	--	--	--	--	--	--	--	--	--	--	--	--	--	--	--	--	--	--	--	--	--	--	--	--	--	--	--	--	--	--	--	--	--	--	--	--	--	--	--	--	--	--	--	--	--	--	--	--	--	--	--	--	--	--	--	--	--	--	--	--	--	--	--	--	--	--	--	--	--	--	--	--	--	--	--	--	--	--	--	--	--	--	--	--	--	--	--	--	--	--	--	--	--	--	--	--	--	--	--	--	--	--	--	--	--	--	--	--	--	--	--	--	--	--	--	--	--	--	--	--	--	--	--	--	--	--	--	--	--	--	--	--	--	--	--	--	--	--	--	--	--	--	--	--	--	--	--	--	--	--	--	--	--	--	--	--	--	--	--	--	--	--	--	--	--	--	--	--	--	--	--	--	--	--	--	--	--	--	--	--	--	--	--	--	--	--	--	--	--	--	--	--	--	--	--	--	--	--	--	--	--	--	--	--	--	--	--	--	--	--	--	--	--	--	--	--	--	--	--	--	--	--	--	--	--	--	--	--	--	--	--	--	--	--	--	--	--	--	--	--	--	--	--	--	--	--	--	--	--	--	--	--	--	--	--	--	--	--	--	--	--	--	--	--	--	--	--	--	--	--	--	--	--	--	--	--	--	--	--	--	--	--	--	--	--	--	--	--	--