

BUILDING 103 ROOM FINISH SCHEDULE

ROOM NO.	ROOM NAME	FLOOR	BASE	WALLS	ACCENT WALL	CEILING	COUNTER TOP	VERTICAL	NOTES
BASEMENT									
B01-103	DEBRIEFING OFFICE	CPT-02	RB-01	P-07	P-08	AT-01	----	----	----
B02-103	SHARED OFFICE #2	CPT-02	RB-01	P-07	P-08	AT-01	----	----	----
B03-103	PROGRAM SUPPORT	CPT-02	RB-01	P-07	P-08	AT-01	----	----	----
B04-103	SHARED OFFICE #1	CPT-02	RB-01	P-07	P-08	AT-01	----	----	----
B05-103	MEN	RES-01	RES-01	P-07	----	GYP-MR	----	----	4" COVE BASE RES-01
B06-103	MECHANICAL	----	----	----	----	----	----	----	----
B07-103	SHARED OFFICE #3	CPT-02	RB-01	P-07	P-11	AT-01	----	----	----
B08-103	ANE/E OFFICE	CPT-02	RB-01	P-07	P-08	AT-01	----	----	----
B09-103	BREAKROOM	SVT-01	RB-01	P-07	P-11	AT-01	----	----	----
B10-103	ADMIN OFFICE	CPT-02	RB-02	P-07	P-10	AT-01	----	----	----
B10A-103	STORAGE	VCT-05	RB-01	P-09	----	AT-01	----	----	----
B10B-103	STAFF UNISEX RESTROOM W/ SHOWER	RES-01	RES-01	P-07	----	GYP-MR	----	----	----
B11-103	TRANSPORTATION CHIEF	CPT-02	RB-02	P-07	P-08	AT-01	----	----	----
B12-103	WAITING ROOM	SVT-01	RB-01	P-07	P-11	AT-01	----	----	STAIR TREADS MATCH BASE
B13-103	MECHANICAL	----	----	----	----	----	----	----	----
B14-103	OFFICE #2	CPT-02	RB-01	P-07	P-08	AT-01	----	----	----
B15-103	OFFICE #1	CPT-02	RB-01	P-07	P-08	AT-01	----	----	----
B16-103	WOMEN	RES-01	RES-01	P-07	----	GYP-MR	----	----	4" COVE BASE RES-01
B17-103	CORRIDOR	SVT-01	RB-01	P-01	P-11	AT-01	----	----	----
B17A-103	SPRINKLER	VCT-05	RB-01	P-09	----	----	----	----	----
B18-103	COPY/WORK ROOM	VCT-03	RB-01	P-09	P-11	AT-01	----	----	----
B18-105	COMPUTER LAB	CPT-05/ CPT-06	RB-01	P-07	----	AT-01	----	----	----
B18A-103	ELECTRICAL	----	----	----	----	----	----	----	----
B19-103	CORRIDOR	SVT-01	RB-01	P-07	P-11	AT-01	----	----	----
B20A-103	SIMULATION ROOM #1	SVT-01	RB-01	P-07	P-11	AT-01	----	----	----
B20B-103	STORAGE	VCT-05	RB-01	P-09	----	AT-01	----	----	----
B20C-103	CONTROL BOOTH	SVT-01	RB-01	P-07	P-11	AT-01	SS-03	HONEY MAPLE	----
B20D-103	SIMULATION ROOM #2	SVT-01	RB-01	P-07	P-11	AT-01	----	----	----
B20E-103	STORAGE	VCT-05	RB-01	P-09	----	AT-01	----	----	----
B21-103	WAITING	SVT-01	RB-01	P-07	P-11	AT-01	----	----	----
B22A-103	CORRIDOR	SVT-01	RB-01	P-07	----	AT-01	----	----	----
B22B-103	TELE/COMM	----	----	----	----	GYP	----	----	----
B23-103	NURSING ORIENTATION	CPT-05/ CPT-06	RB-01	P-07	P-08	AT-01	----	----	----
B23A-103	STORAGE	VCT-05	RB-01	P-09	----	AT-01	----	----	----
B24A-103	ELEC	----	----	----	----	----	----	----	----
B24B-103	WAITING	SVT-01	RB-01	P-07	P-08	AT-01	----	----	----
B25-103	CORRIDOR	SVT-01	RB-01	P-07	P-08	AT-01	----	----	----
B26-103	MECH	----	----	----	----	----	----	----	----
B27-103	ELEC	VCT-05	RB-01	P-09	----	----	----	----	----
B28-103	CORRIDOR	SVT-01	RB-01	P-07	----	AT-01	----	----	----
B29-103	CORRIDOR	SVT-01	RB-01	P-07	P-11	AT-01	----	----	----
B31A-103	CORRIDOR	SVT-01	RB-01	P-07	----	AT-01	----	----	----
B31B-103	STAFF UNISEX	RES-01	RES-01	P-01	----	AT-01	----	----	4" COVE BASE RES-01
B32A-103	STAIR	VCT-02	RB-01	P-07	----	AT-01	----	----	----
B32B-103	CORRIDOR	VCT-02	RB-01	P-07	P-11	AT-01	----	----	----
B33-103	STAFF UNISEX RESTROOM	RES-01	RES-01	P-07	P-11	GYP-MR	----	----	4" COVE BASE RES-01
B33-104	DISPATCH AREA	----	----	----	----	----	----	----	----
B34-103	HAC	RES-01	RES-01	----	----	GYP	----	----	4" COVE BASE RES-01
B40-103	CIRC.	SVT-01	RB-01	P-07	----	AT-01	----	----	----
B42-103	CIRC.	SVT-01	RB-01	P-07	----	AT-01	----	----	----
B44-103	DISPATCH AREA	SVT-01	RB-01	P-07	P-03	AT-01	----	----	----

NOTE
1. SEE SHEET G1010 FOR INTERIOR SIGNAGE DETAILS. ALL SIGNS ARE TO BE MANUFACTURED AND INSTALLED PER THE VA SIGNAGE DESIGN GUIDE. ILLUSTRATIONS SHOWN ARE FOR TYPE AND LOCATION REFERENCE ONLY.
2. CONTRACTOR TO SUBMIT SIGNAGE SCHEDULE FOR APPROVAL AS PER SECTION USE ROOM NUMBERS AND NAMES AS SHOWN ON THE DRAWINGS WHERE TEXT IS TO INDICATE AN INITIAL SUBMITTAL.

EXISTING CONDITIONS NOTES

GENERAL:
1. DEPICTION OF EXISTING CONDITIONS BASED ON OWNER-FURNISHED DOCUMENTS AND LIMITED FIELD OBSERVATIONS. EXISTING ELEMENTS AND CONDITIONS CONCEALED BY IN-PLACE EQUIPMENT AND FINISHES WERE NOT OBSERVED OR INVESTIGATED. ONCE CUTTING AND SELECTIVE DEMOLITION WORK IS COMPLETE, REPORT ANY CONFLICTS TO GOVERNMENT. THE CONTRACTOR SHALL MAKE ADJUSTMENTS AND/OR ALTERATIONS AS NECESSARY TO INSTALL COMPLETE AND OPERABLE SYSTEMS IN ACCORDANCE WITH THE CODES HAVING JURISDICTION AT NO ADDITIONAL COST TO THE GOVERNMENT.
2. REFER TO CEILING PLANS FOR LOCATION AND EXTENTS OF GWB SOFFITS, FURRINGS, ETC.

FLOOR FINISH SYMBOL LEGEND

- VCT - VINYL COMPOSITION TILE
- CPT - CARPET
- CT - CERAMIC TILE
- SVT - SOLID VINYL TILE
- RES - RESINOUS FLOORING
- - EXISTING TO REMAIN

GENERAL NOTES

- 1. ALL CASEWORK AND COUNTERTOPS SHALL USE MIDMARK'S RITTER AS THE BASIS OF DESIGN.
- 2. CABINET FACE TO BE MIDMARK HONEY MAPLE AND REFER TO FINISH SCHEDULE FOR COUNTER-TOP SELECTION

6E BUILDING 103 - BASEMENT FLOOR FINISHES
1/8" = 1'-0"

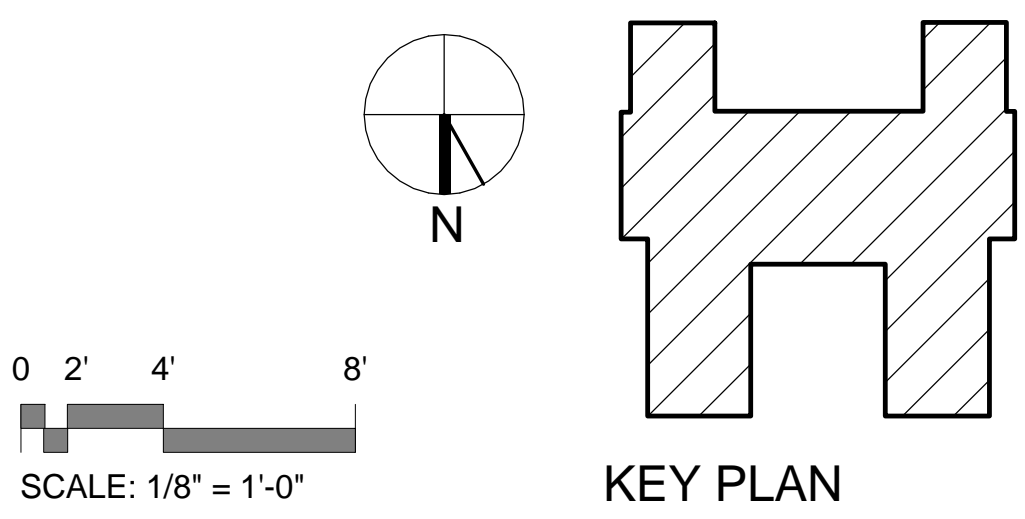

CONSTRUCTION DOCUMENTS SUBMISSION
FULLY SPRINKLERED

CONSULTANTS:		ARCHITECT/ENGINEERS:		Drawing Title FINISH PLAN AND SCHEDULE - BASEMENT FLOOR		Project Title EXPANSION OUTPATIENT AND SUPPORT SPACE (EXPAND ADMIN)		Project Number 658-14-105		OFFICE OF CONSTRUCTION AND FACILITIES MANAGEMENT Department of Veterans Affairs					
1 ADDENDUM #1 Revisions: 15 Date: 2015.08.31		BES DESIGN/BUILD 658 Middle St, Fairhope, AL 36532 Phone: 251.990.5778 Fax: 251.990.3716		Approved: Project Director		Location EUT HEALTHCARE CENTER N. LITTLE ROCK, AR 72114		Building Number 103							
						Date 2015.02.11		Drawn KB		Checked RW		Drawing Number 103.AI101		Dwg. 205 of 214	