

three inches = one foot  
one and one half inches = one foot  
one inch = one foot  
three quarters inch = one foot  
one half inch = one foot  
three eighths inch = one foot  
one quarter inch = one foot  
one eighth inch = one foot  
one sixteenth inch = one foot

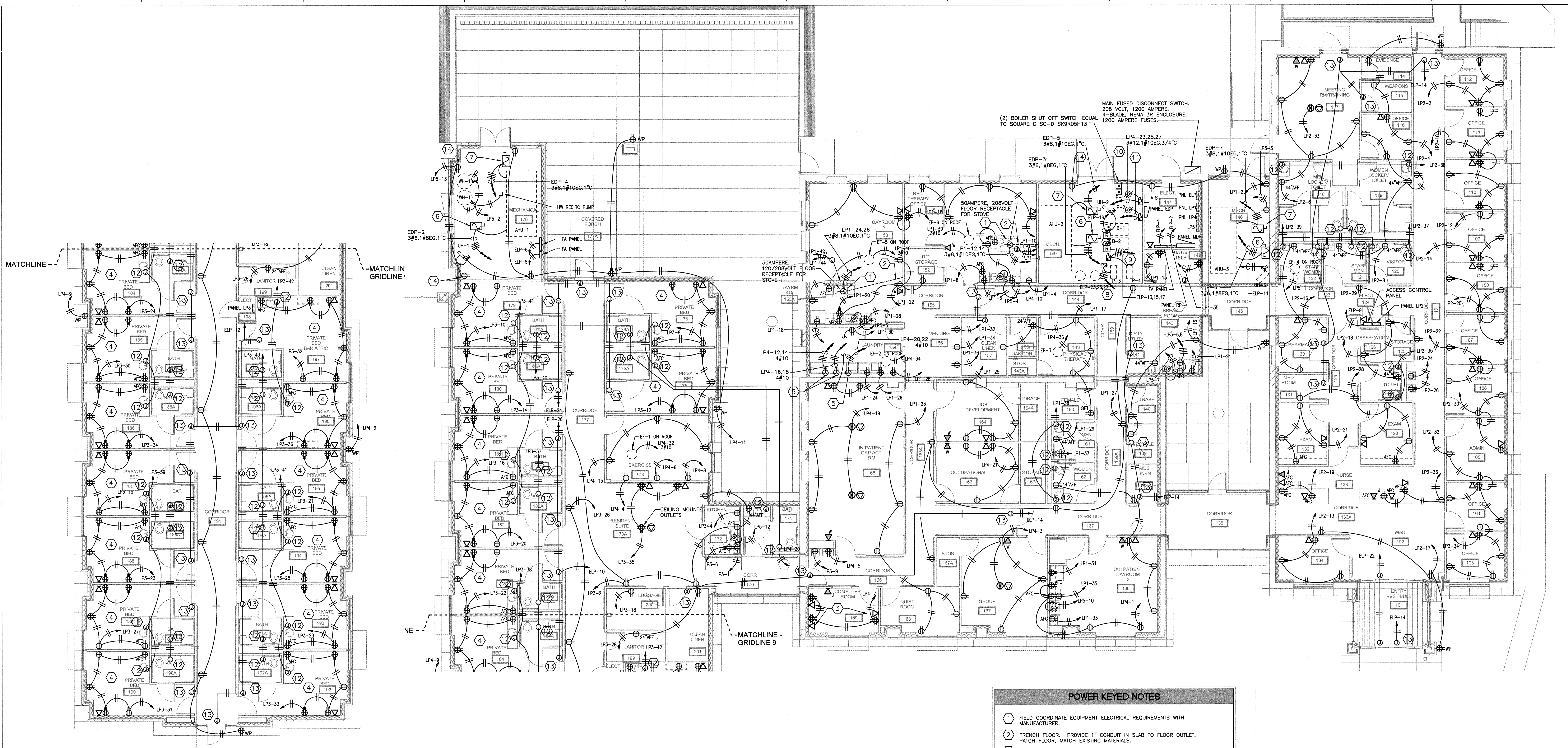

**E3 POWER FLOOR PLAN**  
1/8" = 1'-0"

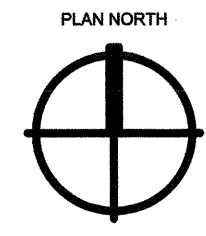

- POWER KEYED NOTES**
- 1 FIELD COORDINATE ELECTRICAL REQUIREMENTS WITH MANUFACTURER.
  - 2 TRENCH FLOOR. PROVIDE 1" CONDUIT IN SLAB TO FLOOR OUTLET. PATCH FLOOR, MATCH EXISTING MATERIALS.
  - 3 PROVIDE RJ-45 JACK AND F-TYPE COAX CONNECTOR IN THIS OUTLET.
  - 4 PROVIDE TAMPER PROOF ELECTRICAL OUTLETS IN PRIVATE BED ROOMS. OUTLET PLATES SHOULD HAVE TAMPER RESISTANT SCREWS.
  - 5 PROVIDE 120/208VOLT, 30 AMPERE RECEPTACLE FOR DRYER.
  - 6 PROVIDE 208 VOLT, THREE PHASE, 10HP VFD. MOUNT ELECTRICAL EQUIPMENT ON UNISTRUT IF NOT LOCATED ON A WALL OR UNIT.
  - 7 PROVIDE 208 VOLT, THREE PHASE, 5HP VFD. MOUNT ELECTRICAL EQUIPMENT ON UNISTRUT IF NOT LOCATED ON A WALL OR UNIT.
  - 8 PROVIDE 208 VOLT, THREE PHASE, 3HP VFD. MOUNT ELECTRICAL EQUIPMENT ON UNISTRUT OR UNIT.
  - 9 PROVIDE 208 VOLT, THREE PHASE, 2HP VFD. MOUNT ELECTRICAL EQUIPMENT ON UNISTRUT OR UNIT.
  - 10 PROVIDE 208 VOLT, THREE PHASE, 7.5HP VFD.
  - 11 LP4-29,31,33. 3#12,1#10EG,3/4". PROVIDE 208 VOLT, THREE PHASE, 5HP VFD.
  - 12 PROVIDE 120VOLT POWER TO SENSOR CONTROL TRANSFORMER FOR PLUMBING FUTURE. CONTROL TRANSFORMER AND CONTROL WIRING PROVIDED BY PLUMBING CONTRACTOR. FIELD COORDINATE TRANSFORMER LOCATION WITH PLUMBING CONTRACTOR.
  - 13 PROVIDE 120 VOLT POWER TO DOOR ELECTRIC STRIKE/LATCH POWER SUPPLY.
  - 14 PROVIDE CONDUIT TO CONNECT TO RECEPTACLE FOR GAS/WATER METER

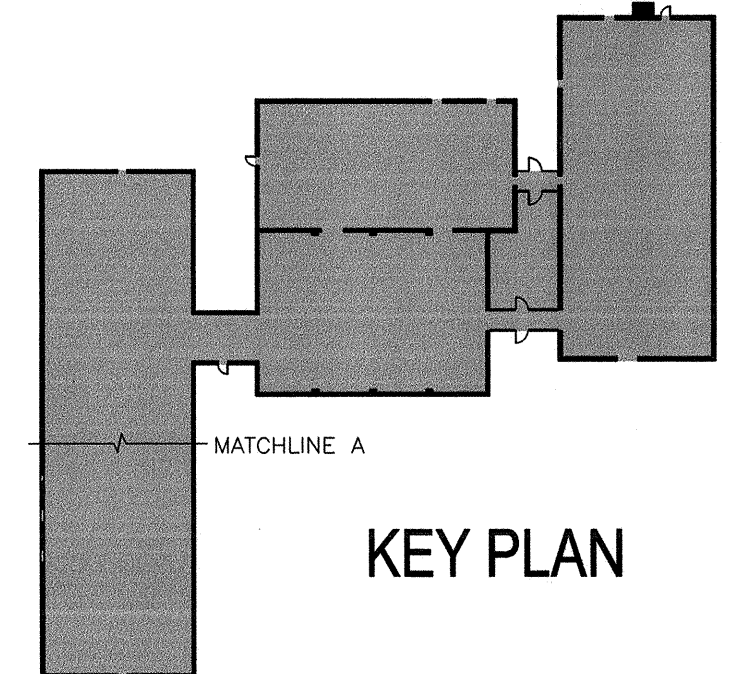

**KEY PLAN**

FULLY SPRINKLERED  
100% CONSTRUCTION DOCUMENTS

<b>CONSULTANTS:</b>  <b>PETTIT &amp; PETTIT</b> Consulting Engineers, Inc. Heritage West Building, Suite 400 201 East Markham Street Little Rock, Arkansas 72201-1631 Telephone (501) 374-3731		<b>ARCHITECT / ENGINEERS:</b>  <b>TAGGART</b> ARCHITECTS 4500 Burrow Drive North Little Rock, AR 72116 Phone: 501-758-7443 Fax: 501-753-7309 www.taggartarch.com		Drawing Title <b>RESIDENTIAL TREATMENT BUILDING POWER FLOOR PLAN</b> Approved: Project Director ▪ ▪	Project Title <b>Renovate Leroy Pond Army Reserve Center for Mental Health Residential Rehabilitation Treatment/ Police Training</b> Location <b>Fayetteville, AR</b> Date 9/7/12 Checked ADA Drawn RAS	Project Number <b>564-341</b> Building Number  Drawing Number <b>EP-104</b> Dwg. 114 of 126	<b>Office of Facilities Management</b> 
--	--	--	--	---	--	---	--