



# Department of Veterans Affairs

## CHEYENNE VAMC

2360 E. PERSHING BOULEVARD, CHEYENNE, WY 82001

PROJECT #442-14-101

REDUCE HEAT AND POWER LOSS

**PARADIGM**  
ENGINEERS AND CONSTRUCTORS

200 Envoy Circle Suite #201, Louisville, KY 40299 - PH: 502.339.8511 - www.paradigmusa.com

### INDEX OF DRAWINGS

<b>GENERAL</b> G1001	COVER SHEET
GS101	SITE PLAN
<b>BUILDING 1</b>	
<b>MECHANICAL</b> M-001	MECHANICAL LEGEND, ABBREVIATIONS, AND GENERAL NOTES
1A.MD400 1A.MD601 1A.MP400 1A.MP501	ENLARGED MECHANICAL DEMOLITION PLAN - BASEMENT EXISTING SITE PHOTOS - BASEMENT ENLARGED MECHANICAL PIPING PLAN - BASEMENT MECHANICAL PIPING DETAILS AND SCHEDULES
1B.MD400 1B.MP400	ENLARGED MECHANICAL PIPING DEMOLITION PLAN - BASEMENT ENLARGED MECHANICAL PIPING PLAN - BASEMENT
1CA.MD400 1CA.MD403 1CA.MD601 1CA.MH403 1CA.MP400 1CA.MP403 1CA.MP501 1CA.MP601	ENLARGED MECHANICAL DEMOLITION PLAN - BASEMENT ENLARGED MECHANICAL DEMOLITION PLAN - MECHANICAL PENTHOUSE EXISTING SITE PHOTOS - BASEMENT ENLARGED MECHANICAL HVAC PLAN - MECHANICAL PENTHOUSE ENLARGED MECHANICAL PIPING PLAN - BASEMENT ENLARGED MECHANICAL PIPING PLAN - MECHANICAL PENTHOUSE MECHANICAL PIPING DETAILS MECHANICAL PIPING SCHEDULES
<b>ELECTRICAL</b> E-001	ELECTRICAL LEGEND, GENERAL NOTES, AND ABBREVIATIONS
1CA.EP400	ELECTRICAL POWER PLAN
<b>BUILDING 13</b>	
<b>ARCHITECTURAL</b> 13.AD100 13.AD101	ARCHITECTURAL PIPING DEMOLITION PLAN - BASEMENT ARCHITECTURAL PIPING DEMOLITION PLAN - FIRST FLOOR
<b>MECHANICAL</b> 13.MD100 13.MD101 13.MD102 13.MD601 13.MD602	MECHANICAL PIPING DEMOLITION PLAN - BASEMENT MECHANICAL PIPING DEMOLITION PLAN - FIRST FLOOR MECHANICAL PIPING DEMOLITION PLAN - ROOF EXISTING SITE PHOTOS EXISTING SITE PHOTOS
13.MP100 13.MP101 13.MP102 13.MP501 13.MP601	MECHANICAL PIPING PLAN - BASEMENT MECHANICAL PIPING PLAN - FIRST FLOOR MECHANICAL PIPING PLAN - ROOF MECHANICAL PIPING DETAILS MECHANICAL PIPING SCHEDULES
<b>ELECTRICAL</b> 13.ED100 13.EP100	ELECTRICAL DEMOLITION PLAN - BASEMENT ELECTRICAL POWER PLAN - BASEMENT

PROJECT LOCATION MAP

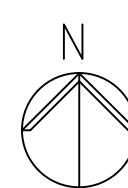
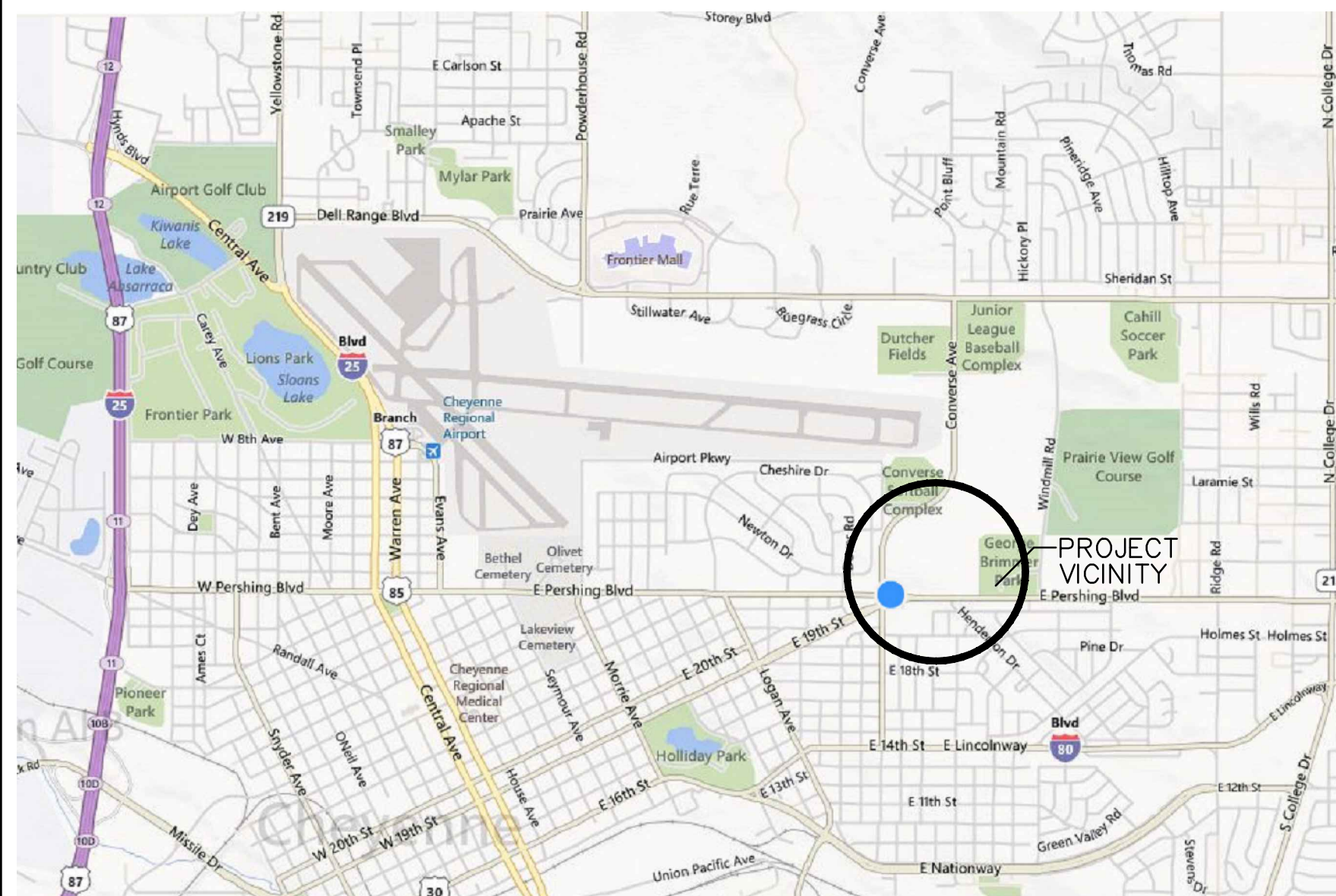

PROJECT SITE MAP

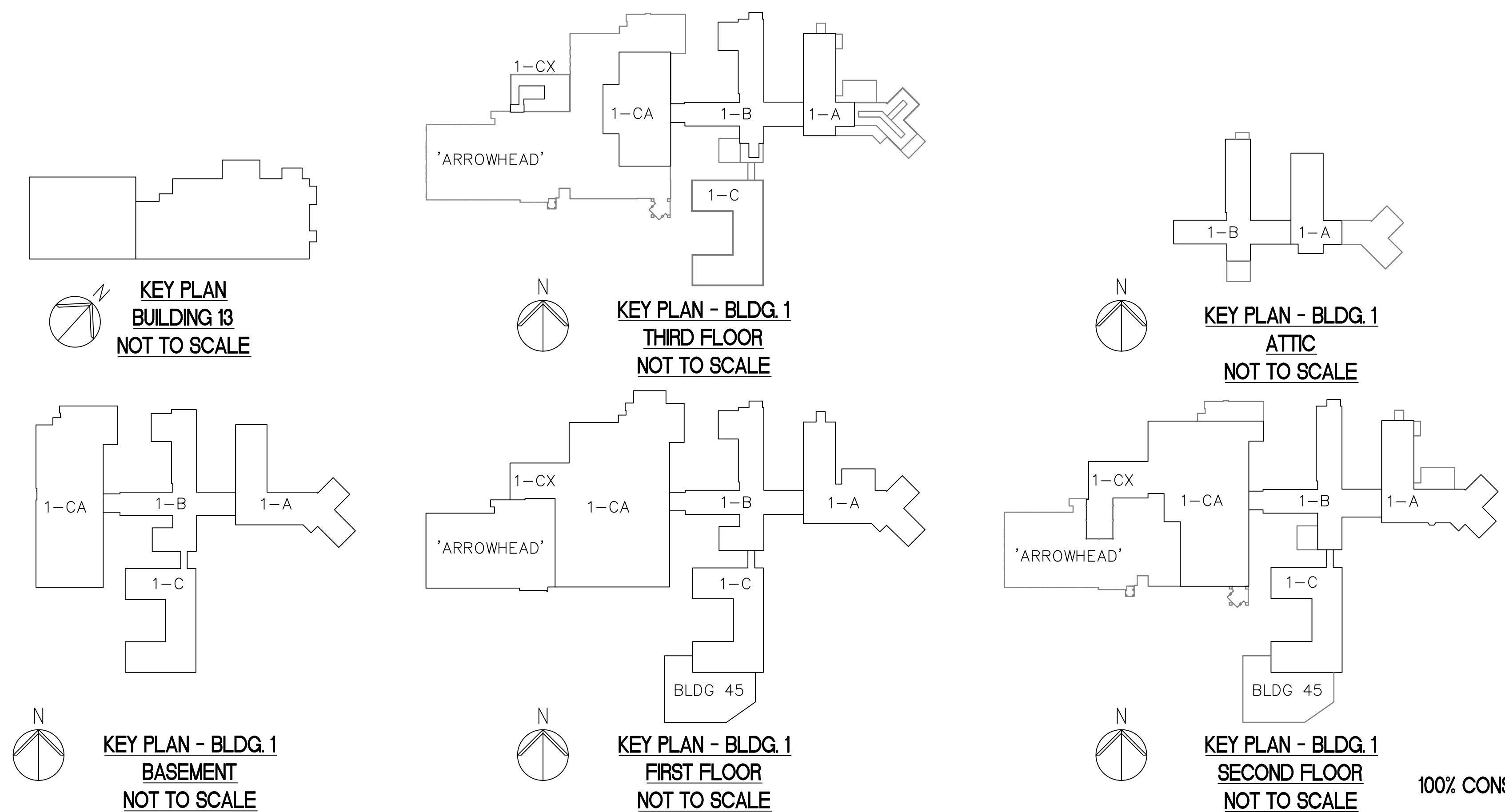
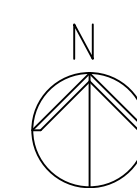
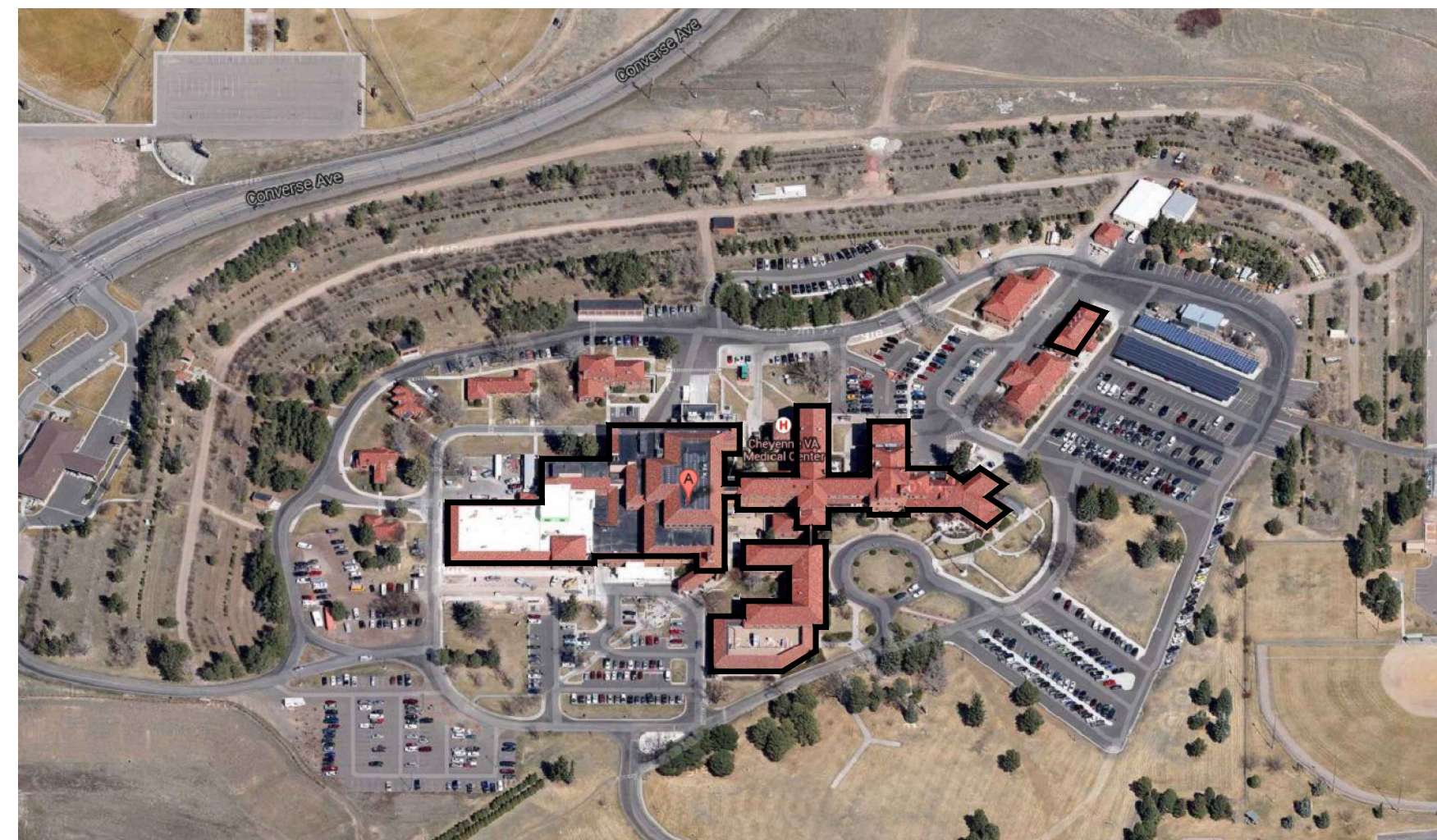

FULLY SPRINKLERED  
100% CONSTRUCTION DOCUMENTS

ARCHITECT/ENGINEERS:

**PARADIGM**  
ENGINEERS AND CONSTRUCTORS

200 Envoy Circle #201, Louisville KY 40299 - PH: 502.339.8511 - www.paradigmusa.com

Drawing Title:

COVER SHEET

Approved Project Director:

Project Title:

REDUCE HEAT AND POWER LOSS

Location: CHEYENNE VAMC

2360 E. PERSHING BOULEVARD, CHEYENNE, WY 82001

Date:

08-12-2015

Checked:

KLP

Drawn:

JDM

Project Number:

442-14-101

Building Number:

1-B, 1-CA, 13

Drawing Number:

G1001

Office of  
Construction  
and Facilities  
Management



AMENDMENT #001

08/12/15

Revisions

Date