

A  
THREE INCHES = ONE FOOT  
1  
B  
ONE AND ONE HALF INCHES = ONE FOOT  
2  
C  
ONE INCH = ONE FOOT  
2  
D  
THREE QUARTERS INCH = ONE FOOT  
4  
E  
ONE HALF INCH = ONE FOOT  
4  
F  
THREE EIGHTHS INCH = ONE FOOT  
8  
ONE QUARTER INCH = ONE FOOT  
16  
ONE EIGHTH INCH = ONE FOOT  
16

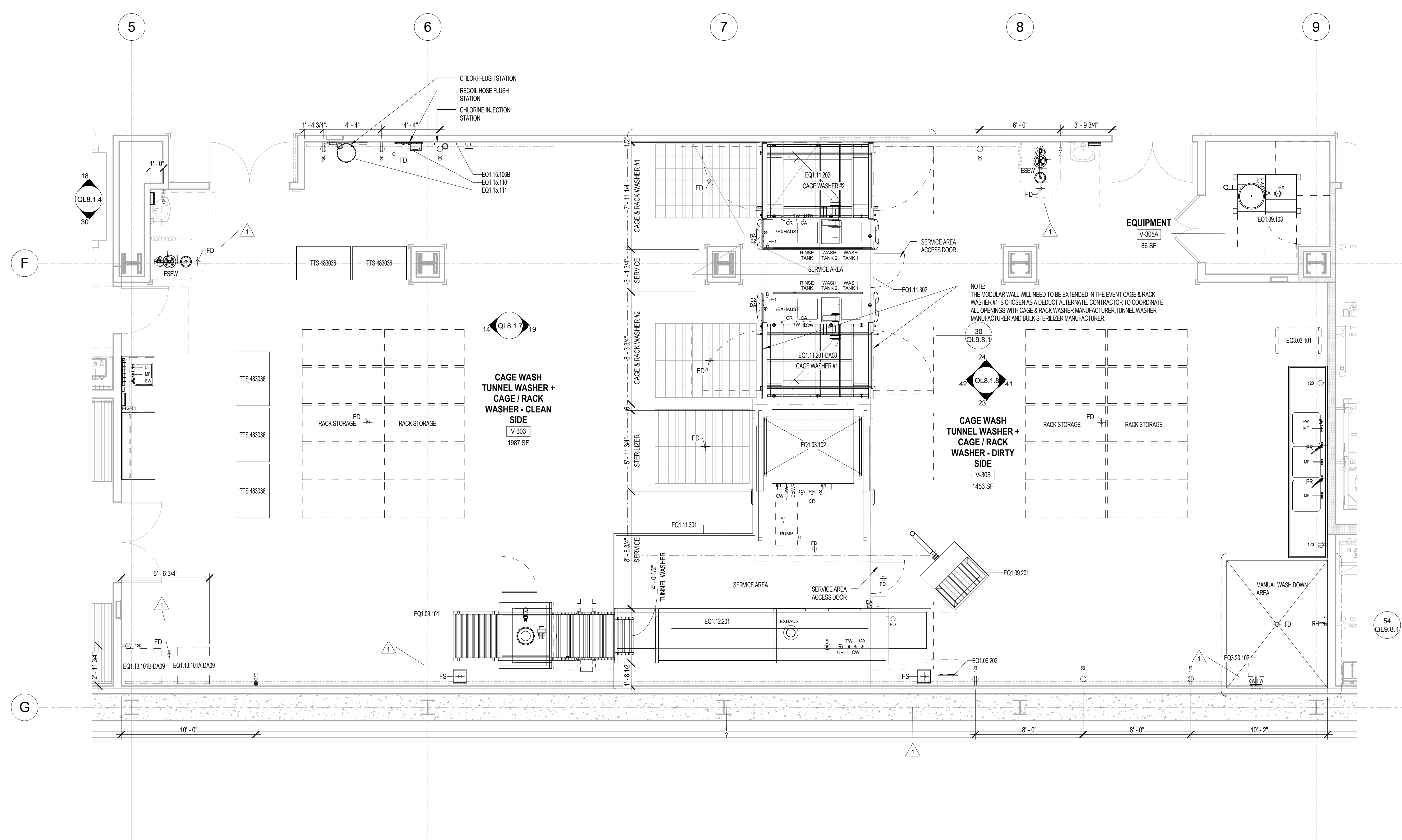

GENERAL NOTES

- A. REFER TO SHEET QL0.0.2 FOR CASEWORK DETAILS
- B. REFER TO SHEET QL0.0.3 FOR THE LAYOUTS OF CEILING SERVICE PANELS
- C. REFER TO SHEETS QL0.0.6-QL0.0.7 FOR BENCH DETAILS, ELECTRICAL, DATA AND GAS LAYOUTS
- D. ELECTRICAL TO PROVIDE ELECTRICAL AND TELECOM TO PROVIDE DATA CONNECTIONS FOR WIRELESS ANTENNAS TO BE MOUNTED ON THE CEILING IN EACH ANIMAL HOLDING ROOM WITH IVC IN THEM.
- E. REFER TO PLUMBING DRAWINGS AND SPECIFICATIONS FOR INFORMATION ON HAND WASH SINKS.
- F. VERIFY THE LAYOUT OF ALL ANIMAL WATERING EQUIPMENT WITH MANUFACTURER.
- G. REFERENCE SPECIFICATIONS FOR INFORMATION REGARDING THE BEDDING DISPENSING/DISPOSAL SYSTEM. COORDINATE WITH MANUFACTURER REGARDING TYPE, SIZE AND LOCATION OF THE STAINLESS STEEL TUBES FOR BEDDING DISPENSING AND DISPOSAL. TUBES SHOWN ARE FOR REFERENCE ONLY.
- H. COORDINATE PIPING LAYOUT WITH MEP FOR ANY CONFLICTS AND INTERFERENCES.
- I. ALL TABLES AND COUNTERTOPS IN THE VIVARIUM ARE TO HAVE STAINLESS STEEL TOPS.
- J. ALL TABLES AND COUNTERTOPS ON LEVELS 1 & 2 ARE TO HAVE EPOXY RESIN TOPS.
- K. ROOM PRESSURE MONITORS ARE LOCATED, CENTER ABOVE THE DOOR, WHERE INDICATED, REFER TO QL0.0.3
- L. FOR ALL EQUIPMENT, REFER TO EQUIPMENT SCHEDULES AND SPECIFICATIONS FOR INFORMATION ON ELECTRICAL, DATA, MECHANICAL AND PLUMBING REQUIREMENTS.
- M. ANY EQUIPMENT WITH A EQX.XX.XXX-XXX INDICATES THE EQUIPMENT IS PART OF THE DEDUCT ALTERNATE LIST. REFER TO EQUIPMENT SCHEDULES.
- N. REFER TO QL0.0.2 SHEETS FOR INFORMATION REGARDING CASEWORK THAT IS APART OF THE DEDUCT ALTERNATE LIST.
- P. REFER TO QL0.0.3 FOR ELECTRICAL, DATA AND GAS LAYOUTS FOR ALL CEILING SERVICE CARRIERS.
- Q. ALL ELECTRICAL OUTLETS ARE SHOWN FOR REFERENCE ONLY. REFER TO ELECTRICAL DRAWINGS.
- R. ALL FLOOR DRAINS AND FLOOR SINKS SHOWN ARE FOR REFERENCE ONLY. REFER TO ARCHITECTURAL AND PLUMBING DRAWINGS.
- S. COORDINATE ALL DRAINS NEEDED FOR SPECIFIC EQUIPMENT WITH THE EQUIPMENT MANUFACTURERS.
- T. ALL EQUIPMENT DIMENSIONS ARE FOR INFO ONLY. COORDINATE EXACT DIMENSION WITH EQUIPMENT MANUFACTURER.

KEYNOTES

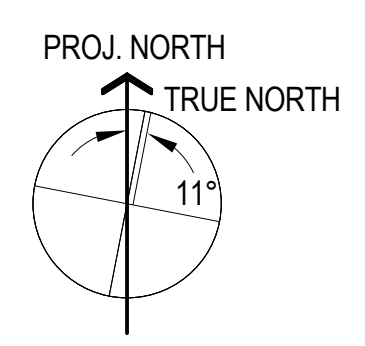
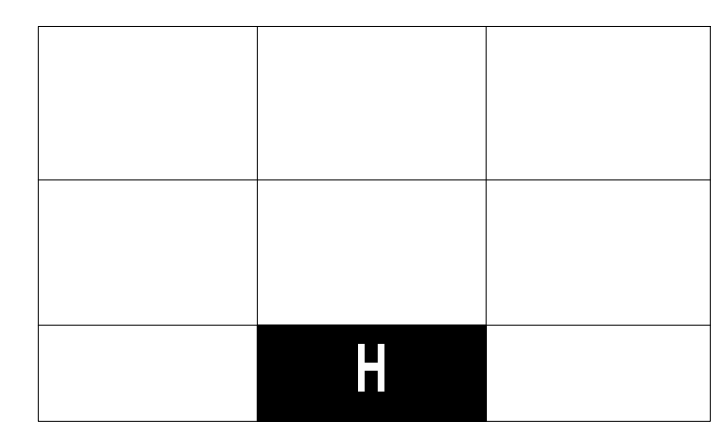

FULLY SPRINKLERED  
CONSTRUCTION DOCUMENTS

GRAPHIC SCALE: 1/4" = 1'-0"

<b>CONSULTANTS:</b>		<b>Seals and Signatures</b>		<b>ARCHITECT/ENGINEERS:</b>		<b>Drawing Title</b>		<b>Project Title</b>		<b>Project Number</b>	
				<b>SMITHGROUP</b> architecture engineering interiors planning 301 BATTERY STREET, 7TH FLOOR SAN FRANCISCO, CA 94111 T 415.227.0100 F 415.908.0862 www.smithgroup.com		<b>LEVEL V AREA H ENLARGED LABORATORY PLAN</b>		<b>CENTERS FOR AMBULATORY CARE, POLYTRAUMA AND BLIND REHABILITATION RESEARCH AND VMU</b>		<b>Building Number</b>	
				<b>The Design Partnership LLP</b> Associate Architect: <b>Architects + Planners</b> 1412 VAN NESS AVE., 2ND FLOOR SAN FRANCISCO, CA 94109 T 415.777.3737 F 415.777.3476 www.dpsf.com		<b>Approved: Project Director</b> 		<b>Location</b> 3801 Miranda Ave., Palo Alto CA		<b>Drawing Number</b> <b>QL2.1.8</b>	
<b>Revisions:</b>								<b>Date</b> 30 JULY 2015		<b>Checked</b> VC	
								<b>Drawn</b> LF			