

**REFLECTED CEILING GENERAL NOTES:**

1. ALL CEILING HEIGHTS SHALL BE 7'-0" UNLESS OTHERWISE NOTED.
2. ALL SPACED HEIGHTS SHALL BE 7'-2" UNLESS OTHERWISE NOTED.
3. ALL ACoustical CEILING TILE SHALL BE ACT TYPE 1 UNLESS OTHERWISE NOTED.
4. COORDINATE ALL ABOVE CEILING WORK PRIOR TO START OF CONSTRUCTION AND INDICATION OF COMPONENTS.

**REFLECTED CEILING LEGEND:**

- 2x4 FLUORESCENT LIGHT FIXTURE
- 1x4 FLUORESCENT LIGHT FIXTURE
- DOWN LIGHT
- UNDER COUNTER LIGHT FIXTURE
- EXIT SIGN
- HEIGHT
- CEILING HEIGHT SYMBOL
- SPRINKLER
- 2x2x2 Acoustic TILE
- OVERSIZED WALLMOUNTED CEILING OR SPACED
- MECHANICAL DUCTS
- MECHANICAL EXHAUST

CONSULTANTS:

ARCHITECT/ENGINEERS:

SECOND FLOOR REFLECTED CEILING PLAN  
SCALE: 1/8" = 1'-0"  
APPROVED PROJECT DIRECTOR:

PROJECT TITLE:  
OUTPATIENT MENTAL HEALTH RENOVATION  
LOCATION:  
VAMC, Memphis, Tennessee  
DATE:  
August 8, 2008  
CHECKED:  
DRAWN:

PROJECT NUMBER:  
614-310  
BUILDING NUMBER:  
1  
DRAWING NUMBER:  
1-AC102  
DWG. OF

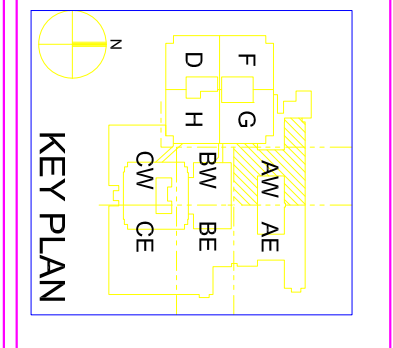

FULLY SPRINKLERED