

1 WIRELESS ACCESS POINTS PLAN

Scale: 1/8"=1'-0"

ISSUE FOR BID	
ISSUE FOR BID (13-311)	12/23/14
FINAL CONSTRUCTION DOCUMENTS (13-304)	9/19/14
100% CONSTRUCTION DOCUMENTS (13-289)	7/17/14
75% CONSTRUCTION DOCUMENTS (13-285)	6/27/14
100% DESIGN DEVELOPMENT (13-266)	3/28/14
100% SCHEMATIC DESIGN (13-237)	1/20/14
50% SCHEMATIC DESIGN (13-227)	12/20/13
PROGRESS REPORT	11/12/13
Revisions:	Date

CONSULTANTS:

TELADATA

44061 Old Warm Springs Blvd - Fremont, Co 94538  
510-979-1200 - www.teladata.com  
Consultants for Converging Technologies

KEY PLAN

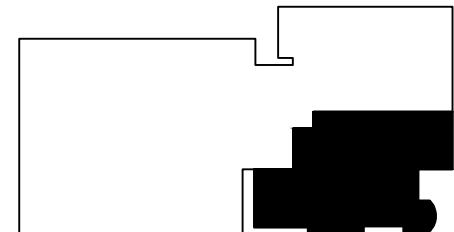

STAMP

ARCHITECT/ENGINEERS:

ADVANCE DESIGN CONSULTANTS, INC.

998 PARK AVENUE SAN JOSE CALIFORNIA 95128  
P: (408) 287-1881 F: (408)294-3186 www.adcengineers.com

ATTENTION:

ONLY WET SIGNED DOCUMENTS CONSTITUTE ADVANCE DESIGN CONSULTANTS, INC. PROFESSIONAL WORK AND BECAUSE OTHER REPRODUCIBLE DOCUMENTS MAY BE EASILY ALTERED WITHOUT THE CONSENT OF ADVANCE DESIGN CONSULTANTS, INC., THE WET SIGNED DOCUMENTS MUST BE REFERRED TO FOR THE ORIGINAL AND CORRECT INFORMATION. IF THERE ARE ANY DIFFERENCES BETWEEN THE WET SIGNED DOCUMENTS AND ANY OTHER DOCUMENTS, THE WET SIGNED DOCUMENTS SHALL GOVERN.  
ADVANCE DESIGN CONSULTANTS, INC. IS NOT RESPONSIBLE FOR ANY MODIFICATIONS MADE TO OUR DOCUMENTS BY ANYONE OTHER THAN AUTHORIZED REPRESENTATIVES OF ADVANCE DESIGN CONSULTANTS, INC.

POB 13-308-29

Drawing Title

TELECOMMUNICATIONS  
WIRELESS ACCESS POINTS  
PLAN

Approved: Project Director

Project Title

VA MEDICAL CENTER, MATHERS CA  
BUILDING 650, 1ST FLOOR RENOVATION  
AND EXPANSION

Location

10535 HOSPITAL WAY, MATHER, CA.

Date

04/27/14

Checked

GP/BD

Drawn

MRO

Project Number

612-126

Building Number

650

Drawing Number

TT101.1

Office of  
Facilities  
Management

Department of  
Veterans Affairs



three inches = one foot  
one and one half inches = one foot  
one inch = one foot  
three quarters inch = one foot  
one half inch = one foot  
three eighths inch = one foot  
one quarter inch = one foot  
one eighth inch = one foot  
one eighth inch = one foot

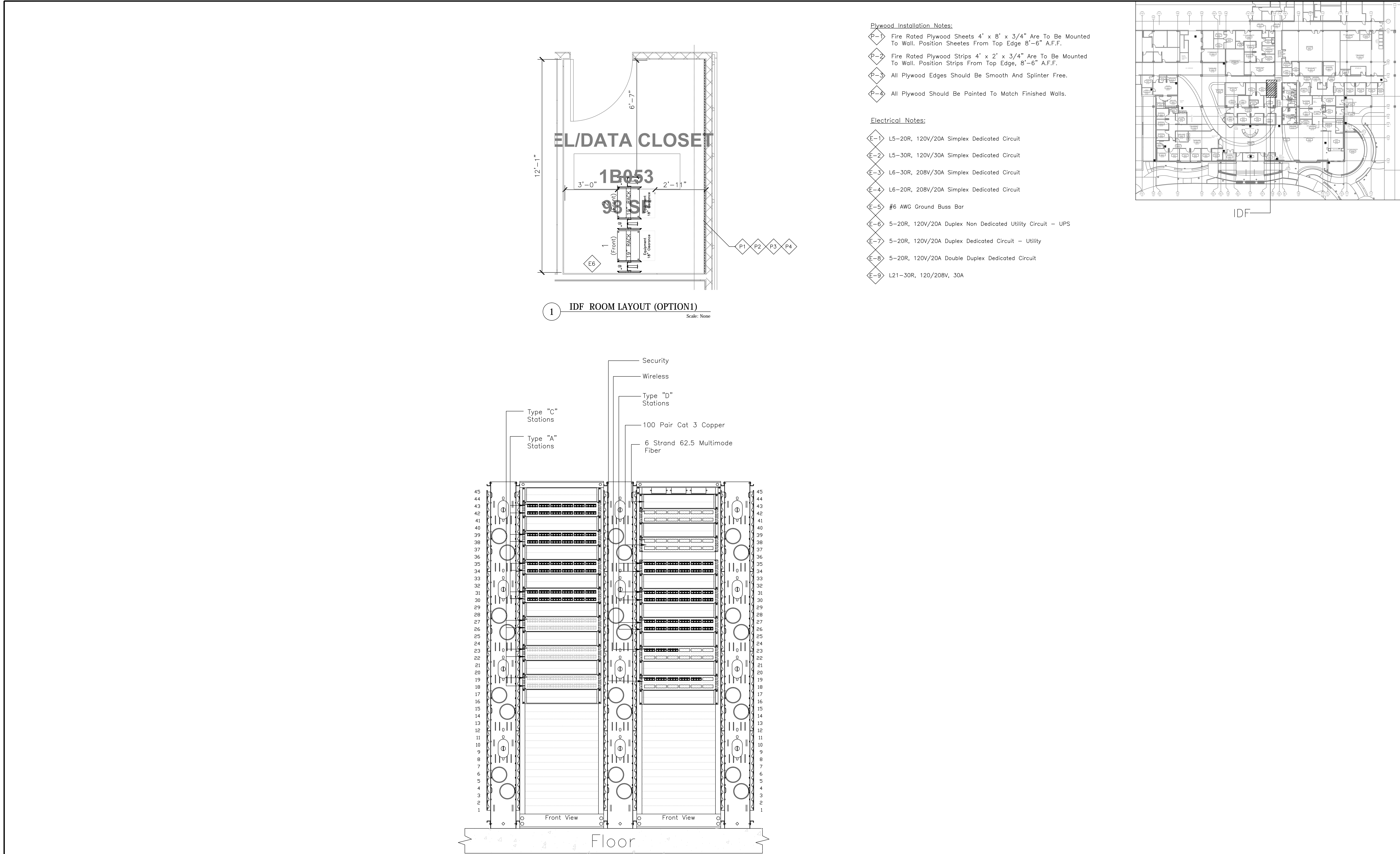

ISSUE FOR BID	
ISSUE FOR BID (13-311)	12/23/14
FINAL CONSTRUCTION DOCUMENTS (13-304)	9/19/14
100% CONSTRUCTION DOCUMENTS (13-289)	7/17/14
75% CONSTRUCTION DOCUMENTS (13-285)	6/27/14
100% DESIGN DEVELOPMENT (13-266)	3/28/14
100% SCHEMATIC DESIGN (13-237)	1/20/14
50% SCHEMATIC DESIGN (13-227)	12/20/13
PROGRESS REPORT	11/12/13
Revisions:	Date

<b>CONSULTANTS:</b> <b>TELADATA</b> 44061 Old Warm Springs Blvd - Fremont, Ca 94538 510-979-1200 - www.teladata.com Consultants for Converging Technologies		<b>KEY PLAN</b> 	<b>STAMP</b>	<b>ARCHITECT/ENGINEERS:</b>  998 PARK AVENUE SAN JOSE CALIFORNIA 95128 P: (408) 287-1881 F: (408) 294-3186 www.adcengineers.com PO# 13-308-29	<b>Drawing Title</b> <b>IDF ROOM LAYOUT</b> Approved: Project Director	<b>Project Title</b> VA MEDICAL CENTER, MATHERS CA BUILDING 650, 1ST FLOOR RENOVATION AND EXPANSION Location 10535 HOSPITAL WAY, MATHER, CA. Date 04/27/14 Checked GP/BD Drawn MRO	<b>Project Number</b> <b>612-126</b> Building Number <b>650</b> Drawing Number <b>TT101.2</b>	<b>Office of Facilities Management</b> Department of Veterans Affairs
---	--	---------------------	--------------	---	--	---	--	--