

**LEGEND**

---	MATCHLINE
---	PROPERTY LINE
W	WATER
RW	RECYCLED WATER
SD	STORM DRAIN
SS	SANITARY SEWER
G	GAS LINE
○	EXISTING MAN HOLE
□	EXISTING WATER METER
○	TREE
○	12345 TREE TAG #
○	OAK 10" SIZE
○	SPECIES
⊕	FIRE HYDRANT
-OT/OHE-	OVERHEAD TELEPHONE/ OVERHEAD ELECTRICAL
●	POWER POLE
-XXX-	EXISTING CONTOUR
---	EXISTING CONC. CURB
□	CATCH BASIN

**NOTE:**  
ALL EXISTING ROADWAYS ARE PAVED WITH ASPHALT PAVING UNLESS OTHERWISE NOTED.

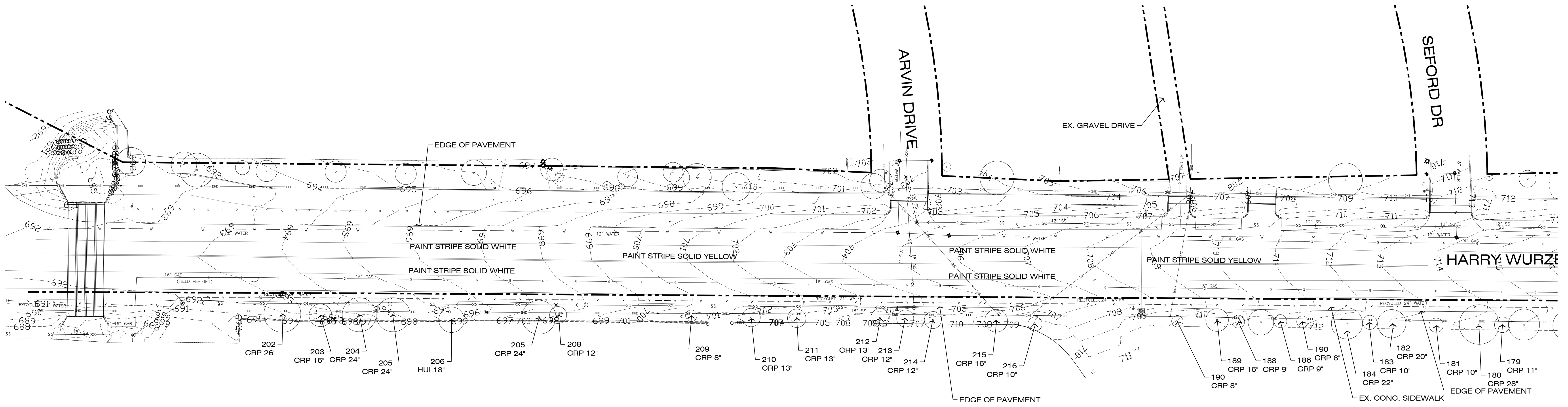

Bain Medina Bain, Inc.  
Digital Survey Provided 17 Feb. 2014

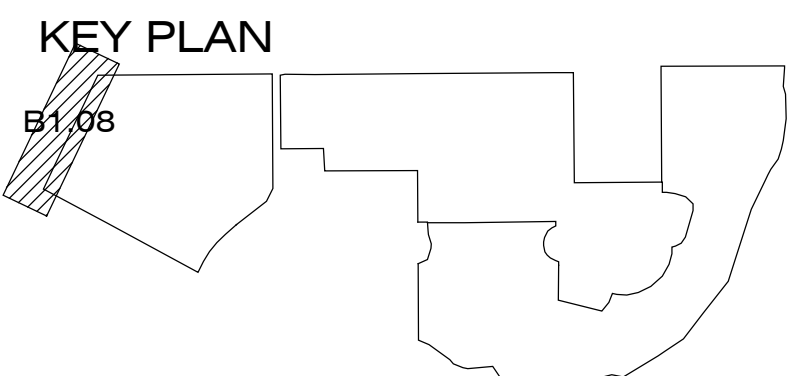
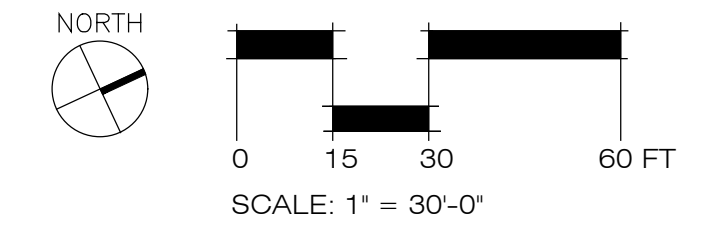

100% Construction Documents

Revisions	Date



Prime Contact:  
**Rialto Studio, Inc.**  
*Landscape Architecture*  
2422 Broadway, Suite 105  
San Antonio, Texas 78215  
P: 210.828.1399  
F: 210.828.1399

Sub Consultant:  
**GLHN**  
ARCHITECTS & ENGINEERS, INC.  
2939 E. BROADWAY, TUCSON, ARIZONA 85716 520/881-4546 FAX 795-1822



NATIONAL  
CEMETERY  
ADMINISTRATION

Drawing Title	Project Title	Date
Topographic Survey	Fort Sam Houston National Cemetery Phase B Cemetery Improvements	May 8, 2015
	Building Number	Checked
		Drawn
	Location	Fort Sam Houston National Cemetery San Antonio, TX
		Project No. 846CM2036
		DRAWING NO. <b>B1.08</b>
		Dwg 11 of 216