

- ① REFER TO GENERAL NOTES G1 AND G3 ON DWG. E0-2.
- ② RESERVE SPACE FOR FUTURE CCTV SYSTEM CABINET.
- ③ JUNCTION BOX FOR AUTOMATIC DOOR OPERATION. COORDINATE WITH MANUFACTURERS INSTALLATION INSTRUCTIONS.
- ④ JUNCTION BOX FOR CONNECTION TO LIGHT FIXTURES IN AIR HANDLING UNIT.
- ⑤ JUNCTION BOX FOR CONNECTION TO MECHANICAL CONTROL PANEL.
- ⑥ CIRCUITS CONTROLLED BY PANEL PP-171 (C-HI), REFER TO DWG. E9-6 FOR CONTACTOR CONTROL DIAGRAM.
- ⑦ REFER TO DWG. A5.6-4 FOR INFRARED ELECTRIC HEATER MOUNTING DETAIL.
- ⑧ REFER TO DWG. E6-15 FOR 1/4" SCALE LAYOUT OF SUBSTATION ROOM.

Revisions	Date
-----------	------

455 West Fort Street, Detroit, Michigan 48226
313/964-3000

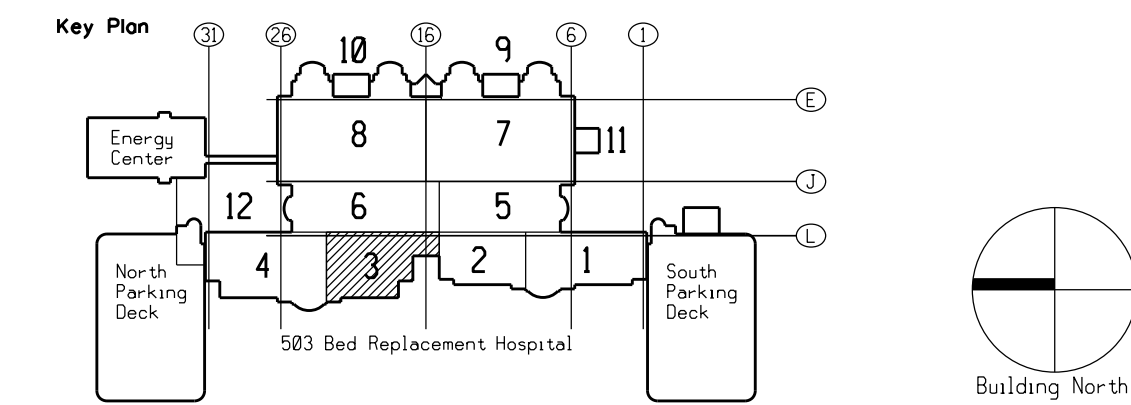

Scale: $\frac{1}{8}" = 1' - 0"$

Approved: Area Project Manager

Building Number 100	Checked	Drawn zochowski
Location Detroit, Michigan		

DRAWING NO.
E3-1.3
Dwg.

**Veterans
Administration**