

FULLY SPRINKLERED

GENERAL NOTES:

A. THE ELECTRICAL CONTRACTOR IS RESPONSIBLE FOR ALL ELECTRICAL WORK ASSIGNED TO THE ELECTRICAL CONTRACTOR OR OWNER AS INDICATED ON THE SIEMENS MRI DRAWINGS. THIS INCLUDES BUT NOT LIMITED TO, CONDUITS, WIRE, CABLE TRAYS, BOXES, WIREWAYS MOUNTING OF EQUIPMENT, AND CABLES. PLEASE REFER TO ATTACHED SIEMENS DRAWINGS FOR ADDITIONAL SCOPE.

NOTES:

- POWER SUPPLY FOR TYPE "F1" MRI LIGHT FIXTURES.
- LOCATION OF MRI FILTERS AND WALL PENETRATION. REFER TO SIEMENS MRI SHEETS FOR ADDITIONAL WORK. THE ELECTRICAL CONTRACTOR IS RESPONSIBLE FOR ALL CONDUIT, WIREWAYS, EQUIPMENT CONNECTIONS, WIRE AND CABLES ASSIGNED TO THE ELECTRICAL CONTRACTOR ON THE SIEMENS SHEETS.
- REINSTALL CEILING SPEAKER.
- 175A/3P 100% RATED SHUNT TRIP CIRCUIT BREAKER IN AN SURFACE ENCLOSURE. MRI DISCONNECT.
- EPO EMERGENCY BUTTON. MUSHROOM BUTTON MAINTAINED TWO POSITION. N.O. PULLED OUT, N.C. PUSHED IN. NON-FERROUS CONSTRUCTION. 120V CONTACTS. WIRE TO SHUNT TRIP COIL ON MRI DISCONNECT CIRCUIT BREAKER. PROVIDE 120V CONTROL CIRCUIT C2F-20.
- ONLY NON-FERROUS CONDUIT, BOXES AND FITTINGS SHALL BE USED INSIDE OF THE MRI EXAM ROOM. CONDUITS SHALL BE ALUMINUM.
- PROVIDE JUNCTION BOX ABOVE THE CEILING FOR SINK VALVE TRANSFORMER. TRANSFORMER PROVIDED BY PC AND INSTALLED BY EC. EC TO RUN 1/2" CONDUIT DOWN TO SINK VALVE LEVEL. LOW VOLTAGE WIRING BY PC.
- TEMPORARY CONSTRUCTION WALL.
- PROVIDE 120V CIRCUIT FROM C2F-20 FOR SHUNT TRIP CONTROL CIRCUIT.
- PROVIDE 120V CIRCUIT FROM C2F-20 FOR MRI IN USE SIGN. WIRE BACK TO MRI EQUIPMENT TO ILLUMINATE.
- 3#20 AWG, 200 GROUND, 2" C.
- MRI INTERCOM SYSTEM. PROVIDE DESK MOUNTED MICROPHONES WITH PUSH TO TALK BUTTON IN CONTROL ROOM. SPEAKER LOCATION PER MANUFACTURER. IN MRI ROOM PROVIDE A WALL MOUNTED MICROPHONE. JUNCTION BOX, CEILING HUNG EQUIPMENT. FIBER OPTIC CABLE. 400VDC-20V POWER FOR EQUIPMENT. SYSTEM SHALL BE LISTED FOR MRI ROOM USE.
- RELOCATE NURSE CALL 4" SQUARE JUNCTION BOX AND 3/4" CONDUIT APPROXIMATELY 12" WEST OF ITS CURRENT LOCATION TO ALLOW NEW EXHAUST DUCT TO BE INSTALLED BELOW. EXISTING NURSE CALL IS MANUFACTURED BY GE TELLUENCE. CAT 6 CABLES INTERCONNECT VARIOUS COMPONENTS OF THE NURSE CALL SYSTEM.



PARTIAL SECOND FLOOR PLAN
Scale: 1/8" = 1'-0"



PARTIAL SECOND FLOOR PLAN
Scale: 1/8" = 1'-0"

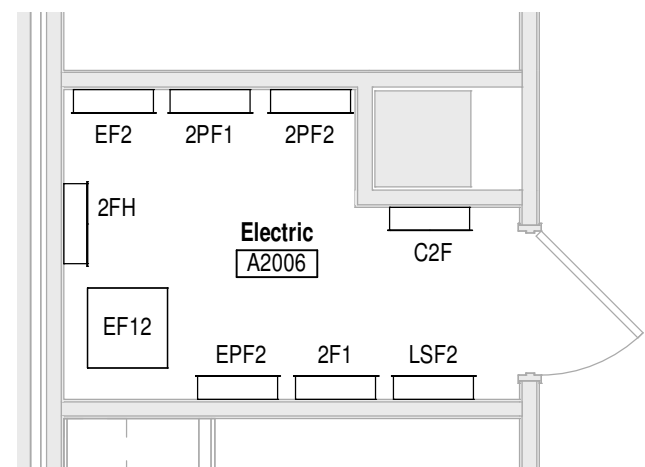

ELECTRIC RM A2007
SCALE: 1/4" = 1'-0"

1/26/2016 9:43:05 AM

1	Addendum 1	01/26/16
Revisions		Date

CONSULTANTS:

Heapy Engineering
MEP Design Technology Planning Commissioning Energy
Nationally Recognized Leader in Sustainability
1400 W Dorothy Lane, Dayton, OH 45409-1310
Ph 937-224-0861 Fax 937-224-5777 www.heapy.com
HEAPY PROJECT No.: 2015-04016 FIRM LICENSE No.: 01528

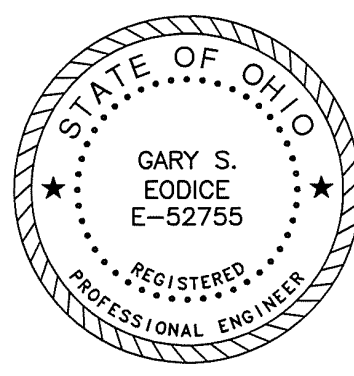

ARCHITECT/ENGINEERS:

pfb architects
Cincinnati • Chicago
PFB Architects, Inc.
9481 Kenwood Road
Cincinnati, Ohio 45242
(513) 861 3200

Drawing Title

PARTIAL SECOND FLOOR - NEW WORK

Approved: Project Director

Project Title

MRI SITE PREP

Location

Cincinnati, Ohio

Date

10/30/2015

Checked

MSG

Drawn

JB

Project No.

539-CSI-201

Building Number

01

Drawing Number

E102

Dwg. of

Office of
Construction
and Facilities
Management

