



PHASING GENERAL NOTES

1. The construction phase for all work in Basement and First Floor shall have a total duration of 125 calendar days. In the event that Deduct Alternate #1 is accepted, the construction phase for all work on first floor shall have a total duration of 110 days.
2. Temporary partitions and phasing will need to coordinate w/ Owner's operation of facility.
3. Temporary partitions and contractor access doors for each Area are to be constructed in their entirety prior to start of demolition.
4. Coordinate exact locations of temporary partitions w/ existing items in corridor ceilings and walls.
5. Contractor shall at all times provide and/or maintain separation between Owner occupied areas and areas under construction or partially constructed.
6. All areas outside of temporary partitions requiring new work are to be performed during off hours.
7. Remove temporary partitions completely after completion of work and when approved by COR. Patch all surfaces damaged by the installation partitions.
8. Project scope line is indicated for general intent only. Contractor will complete all work regardless if it is located outside of project scope area as indicated on any drawing.
9. Coordinate all phasing work with the entire set of project documents.
10. Contractor shall coordinate sequencing of work w/ Owner.

PHASING PLAN CODED NOTES

- 1 Rooms shall be unoccupied during Work in Area 1.4. However, contractor shall allow emergency access by VAMC personnel at all times.
- 2 Contractor to temporarily relocate fixtures to permit installation of new flooring. Protect fixtures from damage during Work. Reinstall fixtures at conclusion of Work.
- 3 Work in this area shall take place after normal facility operation hours.
- 4 Provide temporary 3' x 7' Type 'A' door in knock-down frame in new temporary partition (equivalent to 1 hour smoke barrier). Provide door hardware for a complete installation including but not limited to hinge, latch set (non locking), closer, gasketing. At conclusion of Work in Area 1.4, remove temporary door and partition and restore all surfaces to existing condition.

PHASING LEGEND

Area of construction

Project Scope

PHASING DURATION

Phasing duration during the construction period should be as follows:

Base Bid	Preconstruction	60 days
	Phase 1	Day 1 through 35
	Phase 2	Day 15 through 49
	Phase 3	Day 23 through 70
	Phase 4	Day 43 through 77
	Phase 5	Day 57 through 91
	Phase 6	Day 85 through 125
	Total project	185 days
Deduct Alt #1	Preconstruction	60 days
	Phase 1	Day 1 through 35
	Phase 2	(Does not occur)
	Phase 3	Day 15 through 56
	Phase 4	Day 36 through 70
	Phase 5	(Does not occur)
	Phase 6	Day 71 through 110
	Total project	170 days

PROJECT SCOPE

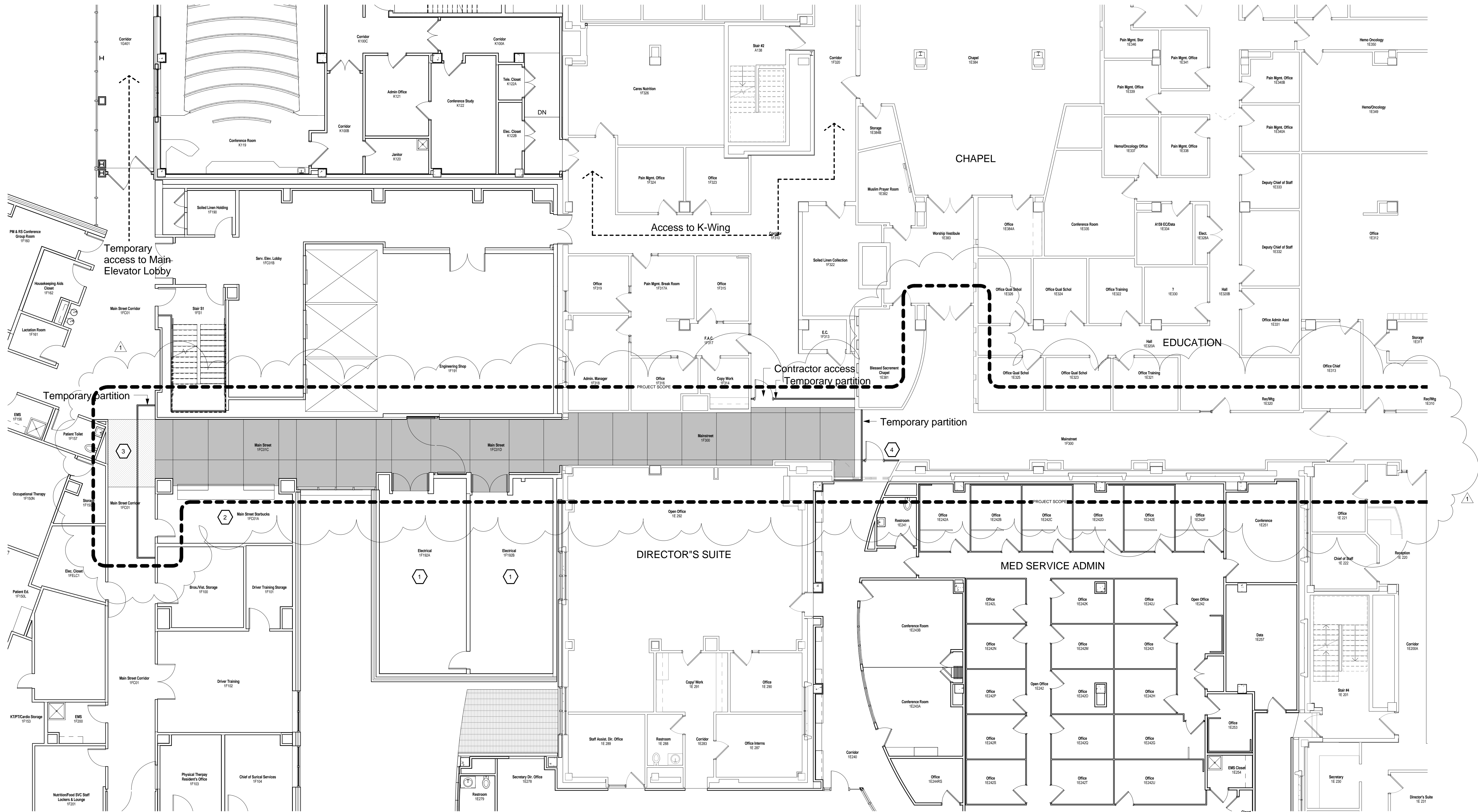

1 PHASING PLAN - FIRST FLOOR - PHASE 6

Scale 1/8" = 1'-0"

DESIGN DEVELOPMENT	19 MARCH 2015
65% CD'S FOR PRICING	13 APRIL 2015
65% CD SUBMITTAL	20 APRIL 2015
100% CD FOR PRICING	13 MAY 2015
100% CD SUBMITTAL	20 MAY 2015
FINAL CD SUBMITTAL	14 AUG 2015
ADDENDUM 1	25 JAN 2016

CONSULTANTS:

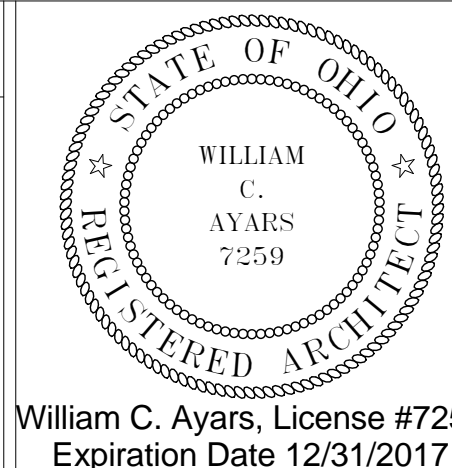

William C. Ayars, License #7259  
Expiration Date 12/31/2017

ARCHITECT:

Perspectus  
architecture

13212 Shaker Square Suite 204 Cleveland, Ohio 44120  
P. 216.752.1800 F. 216.752.3833

DESIGN AND CONSTRUCTION DOCUMENTS ARE INSTRUMENTS OF SERVICE AND ARE GIVEN IN CONFIDENCE AND REMAIN THE PROPERTY OF PERSPECTUS ARCHITECTURE. THE USE OF THIS DESIGN AND THESE CONSTRUCTION DOCUMENTS FOR PURPOSES OTHER THAN THE SPECIFIC PROJECT NAMED HEREIN IS STRICTLY PROHIBITED WITHOUT THE EXPRESSED WRITTEN CONSENT OF PERSPECTUS ARCHITECTURE. COPYRIGHT © 2013

Drawing Title  
**PHASING PLAN - FIRST FLOOR - PHASE 6**

Approved: Project Director

Project Title  
**Replace Main Street Floor Tile**

Location  
**VAMC - WADE PARK**

Date  
14 August 2015

Checked  
RN

Drawn  
MH

Project Number  
541-17-210

Building Number  
1

Drawing Number  
**1-02.4**

Dwg. of

Office of  
Facilities  
Management

Department of  
Veterans Affairs