

three inches = one foot
one and one half inches = one foot
one inch = one foot
three quarters inch = one foot
one half inch = one foot
three eighths inch = one foot
one quarter inch = one foot
one eighth inch = one foot
one sixteenth inch = one foot

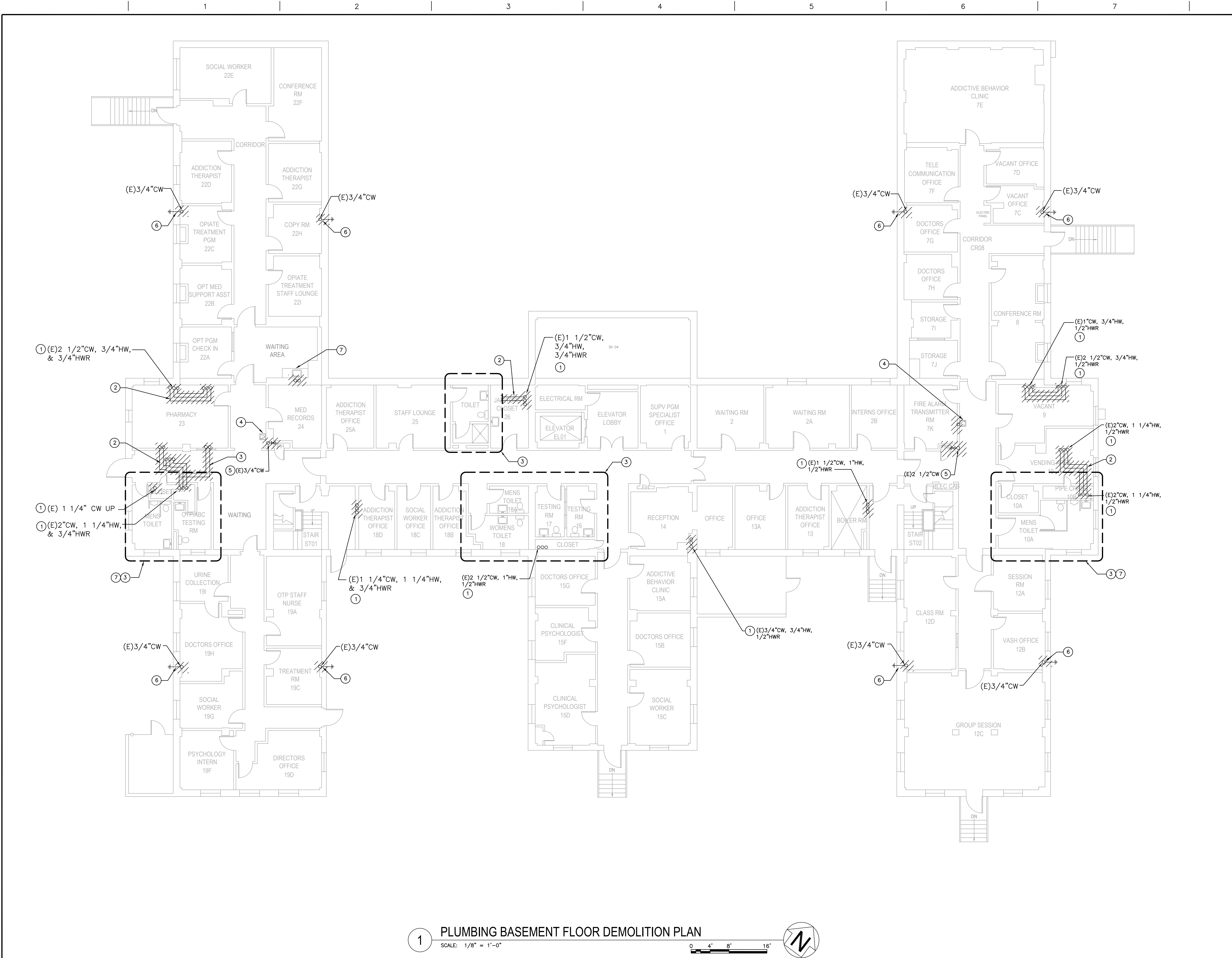

GENERAL NOTES

- ALL (E) PLUMBING FIXTURES, ASSOCIATED FLUSH VALVES, AND STOP VALVES TO REMAIN.
- ALL (E) ABANDONED PIPING INSIDE (E) WALLS FROM PREVIOUS RENOVATION PROJECTS TO BE DEMOLISHED.

KEY NOTES

- (E) DOMESTIC COLD, HOT, AND HOT WATER RETURN RISERS TO BE DEMOLISHED.
- (E) SUPPLY PIPING AND ASSOCIATED VALVES OVERHEAD/ABOVE CEILING TO BE DEMOLISHED.
- DISCONNECT (E) SUPPLY PIPING FROM (E) FIXTURE FLUSH VALVES AND STOP VALVES. DEMOLISH ALL (E) PIPING, SHUT-OFF VALVES, AND WATER HAMMER ARRESTERS. (E) RESTROOM FIXTURES, VALVES, AND TRIMMINGS TO REMAIN.
- DISCONNECT AND DEMOLISH (E) SUPPLY PIPING AND ASSOCIATED VALVES FROM (E) DRINKING FOUNTAIN. DRINKING FOUNTAIN TO REMAIN.
- DEMOLISH (E) SUPPLY PIPING AND ASSOCIATED VALVES FROM THE (E) FIRE HOSE CABINET. (E) FIRE HOSE CABINET TO REMAIN.
- POINT OF DISCONNECTION TO (E) EXTERIOR HOSE BIBB. (E) EXTERIOR HOSE BIBB TO REMAIN.
- DISCONNECT (E) SUPPLY PIPING FROM (E) FIXTURE STOP VALVES. DEMOLISH ALL (E) PIPING, SHUT-OFF VALVES. (E) FIXTURE AND TRIMMINGS TO REMAIN.

KEY PLAN

100% CD SUBMITTAL	08/05/15	ARCHITECT/ENGINEERS/CONSULTANTS:		VA PROJECT ENGINEER (138E)		CHIEF, OCCUPATIONAL SAFETY AND HEALTH (130)		Drawing Title PLUMBING BASEMENT FLOOR DEMOLITION PLAN		Project Title CORRECT POTABLE WATER DEFICIENCIES - BUILDING 256/257		Project Number 691-15-115-WL		Office of Facilities Management Department of Veterans Affairs	
		 Schwab Engineering & Management A Certified SB/DVBE Firm 1000 E. Walnut Street, Suite 227, Pasadena, CA 91106 t: 888.900.3823 f: 626.463.2739 www.schwabeng.com Project No.: 0215.182.00		CHIEF, PROJECT SECTION (138E)		CHIEF, ENV. MANAGEMENT DEPT. (137)		ASSOCIATE DIRECTOR, ADMINISTRATION & SUPPORT SERVICES (10A)		Building Number 256/257		Drawing Number 257-PD200			
				CHIEF, MAINT. & OPERATIONS OFFICE (138F)		DIR., FACILITIES MANAGEMENT (10A4)		Date APRIL 14, 2015		Checked WM		Drawn LC			
				CHIEF, ENGINEERING DEPT. (138)		CHIEF OF STAFF (11)		Dwg 12 of 20							
Revisions:		Date:													