

three-eighths inch = one foot
one-eighth inch = one foot
one-quarter inch = one foot
one-half inch = one foot
three-quarters inch = one foot
one inch = one foot
one and one-half inches = one foot
two inches = one foot
three inches = one foot
four inches = one foot
six inches = one foot
eight inches = one foot
ten inches = one foot
twelve inches = one foot
fifteen inches = one foot
twenty inches = one foot
twenty-four inches = one foot

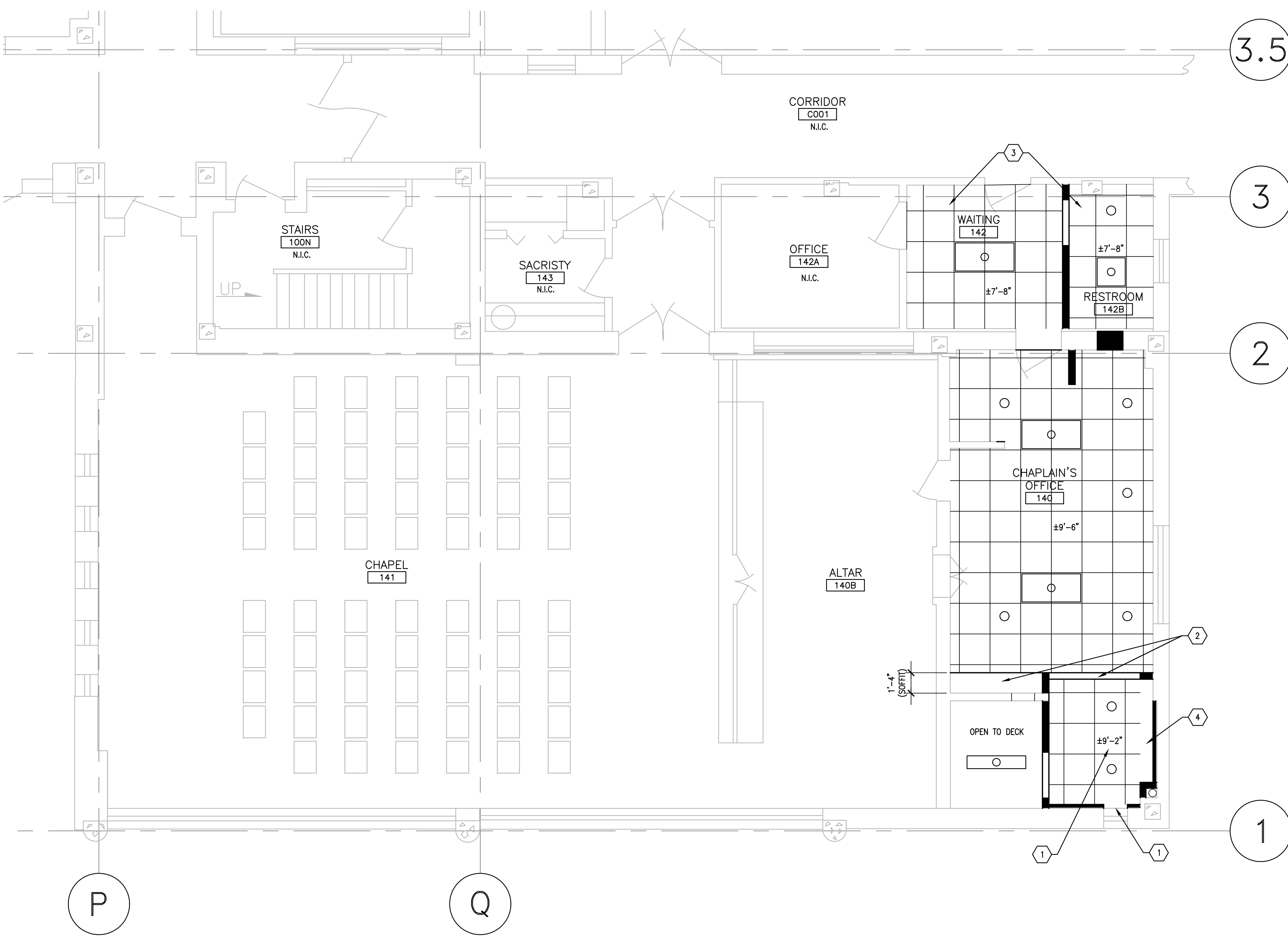

F1 CHAPEL REFLECTED CEILING PLAN - NEW WORK
SCALE: 1/4"=1'-0"

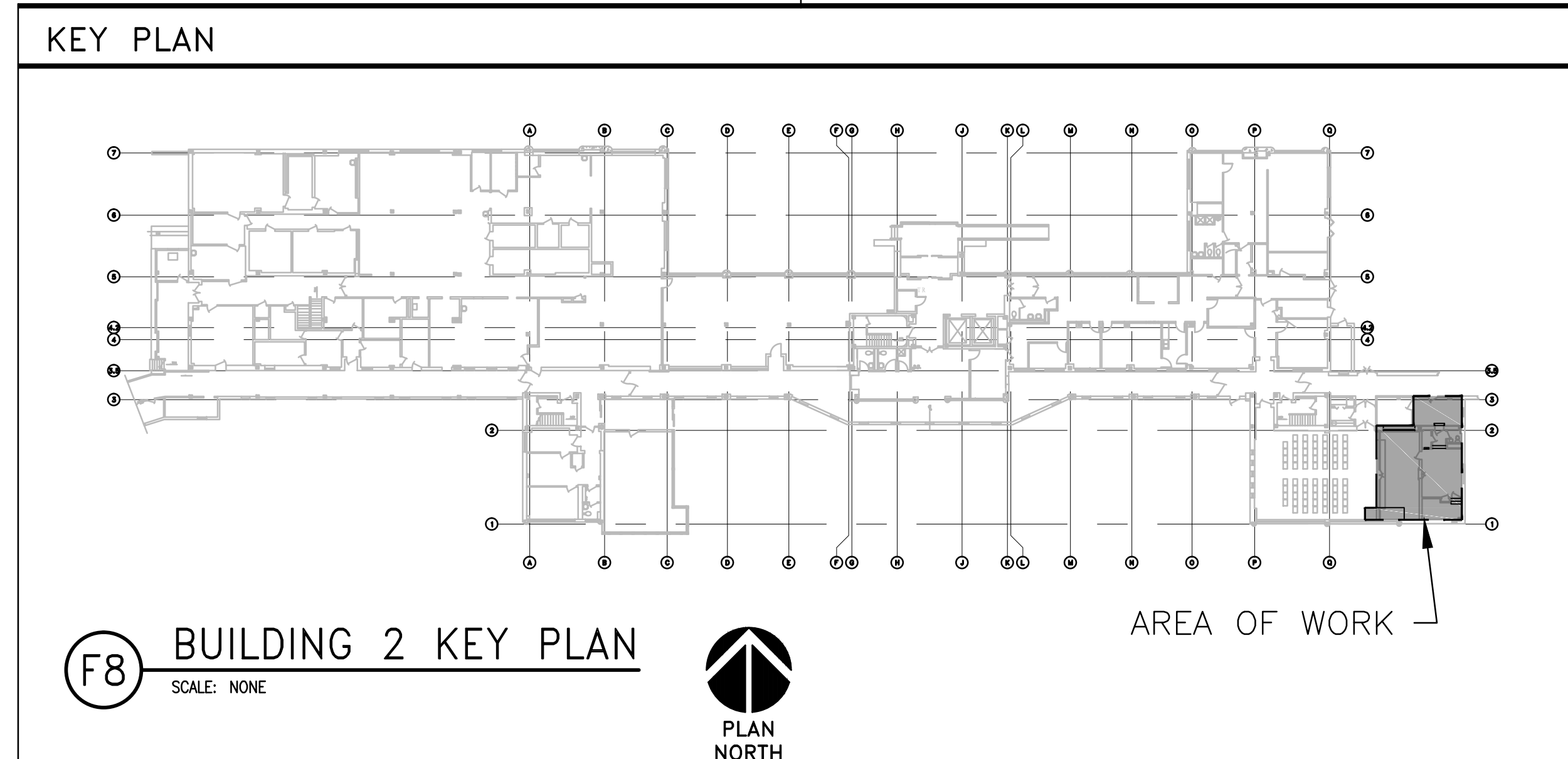

F8 BUILDING 2 KEY PLAN
SCALE: NONE



100% CONSTRUCTION ISSUE

- ### GENERAL NOTES
- FIELD VERIFY ALL DIMENSIONS.
 - COORDINATE ALL WORK AND PROJECT SCHEDULING WITH VA SAFETY, INFECTION CONTROL AND POLICE DEPARTMENTS.
 - PROJECT SCOPE OF WORK (SOW) INCLUDES ACCESSIBILITY UPGRADES TO THE EXISTING CHAPEL AND CHAPLAIN'S OFFICE LOCATED WITHIN BUILDING 2, FIRST FLOOR. SCOPE SHALL INCLUDE THE FOLLOWING:
 - SELECT DEMOLITION WITHIN CHAPLAIN'S OFFICE SUITE (ROOMS 140 AND 142) AND CHAPEL WORSHIP PLATFORM (SPACE 140B).
 - SELECT DEMOLITION WITHIN EXISTING MECHANICAL ROOM (140A); REMOVAL OF EXISTING CONCRETE STEPS.
 - INSTALLATION OF NEW ACCESSIBLE RESTROOM WITHIN RECEPTION AREA, ROOM 142.
 - INSTALLATION OF ACCESSIBLE RAMP AND LOCKABLE STORAGE ON WORSHIP PLATFORM.
 - SELECT PLUMBING, MECHANICAL, ELECTRICAL AND AUDIO / VISUAL UPGRADES.
 - INSTALLATION OF NEW ARCHITECTURAL FINISHES.
 - SELECT PATCH AND REPAIR OF EXISTING FINISHES AFFECTED BY NEW WORK.

- ### KEY NOTES
- ALIGN NEW CEILING AT 2" ABOVE EXISTING WINDOW HEAD ON SOUTH ELEVATION.
 - NEW SOFFIT AT BUILT-IN BOOKCASE; 9'-0" A.F.F.
 - NEW CEILING GRID AND TILE SHALL BE HELD AS CLOSE AS POSSIBLE TO EXISTING OVERHEAD UTILITIES AND STRUCTURE.
 - NEW SOFFIT AT DESK ALCOVE AT 8'-10".

- ### LEGEND
- 2 X 2 CEILING GRID AND ACOUSTICAL TILE
 - 1 X 4 LIGHT FIXTURE
 - 2 X 4 LIGHT FIXTURE
 - 2 X 2 LIGHT FIXTURE
 - WALL MOUNTED VANITY FIXTURE
 - CAN DOWN LIGHT FIXTURE

Revisions	Date	FEI ENGINEERING INC. 2201 N. Collins, Suite 205 Arlington, Texas 76011-2055 (817) 461-5337 Fax: (817) 461-1105 MECHANICAL • ELECTRICAL • PLUMBING FEI Project No.: 14030	MPI Architects Architecture • Planning • Interior Design 4949 Addison Circle • Addison, Texas 75001 MPI Project No.: 8140205	Seal STATE OF TEXAS PLUMBING 5/30/14	Seal	Drawing Title CHAPEL REFLECTED CEILING PLAN NEW WORK Approved: Area Project Manager	Project Title VA BONHAM CHAPLAIN'S OFFICE RENOVATION Building Number 2 Checked DJD Drawn EB/DC Location 1201 East Ninth Street Bonham, Texas 75418	Date 5/30/14 Project No. 549-3C-1528 Drawing No. A103 Dwg. of	VANTHC Dallas, Texas VA NORTH TEXAS HEALTH CARE SYSTEM
-----------	------	-----------------------------------------------------------------------------------------------------------------------------------------------------------------------------------------	---------------------------------------------------------------------------------------------------------------------------------------	-----------------------------------------------	------	-------------------------------------------------------------------------------------------------	----------------------------------------------------------------------------------------------------------------------------------------------------------------------------------------	---------------------------------------------------------------------------------	--------------------------------------------------------------------