

KEYNOTES

1. DISTRIBUTION BOARD LOCATED ON MEZZANINE LEVEL.
2. ROUTE CONDUIT FOR IDF-1 AND IDF-2 THROUGH EXISTING 4" C ROOF PENETRATION SEAL AS REQUIRED. SEE SHEET EP141 - AREA A ELECTRICAL ROOF PLAN FOR LOCATION OF EQUIPMENT.
3. MOUNT VFD'S ON WALL ADJACENT TO DISTRIBUTION BOARD ALLOW 36" CLEARANCE IN FRONT OF VFD'S FOR MAINTENANCE.
4. ADD ALTERNATE #5: CONNECT INLINE PUMP; 120V, 1/3 HP, PROVIDE (2) #12, (1) #12 GND IN 3/4" C. COORDINATE WITH OWNER AND FIELD VERIFY AVAILABLE 120V, 1PH CIRCUIT BREAKER FROM OWNER-DESIGNATED PANELBOARD IN ELECTRICAL ROOM E211.
5. ADD ALTERNATE #5: PROVIDE SINGLE POLE MANUAL MOTOR STARTER SWITCH, LEVITON CATALOG #MS302-DS OR APPROVED EQUAL.

AREA A - ELECTRICAL
PLAN

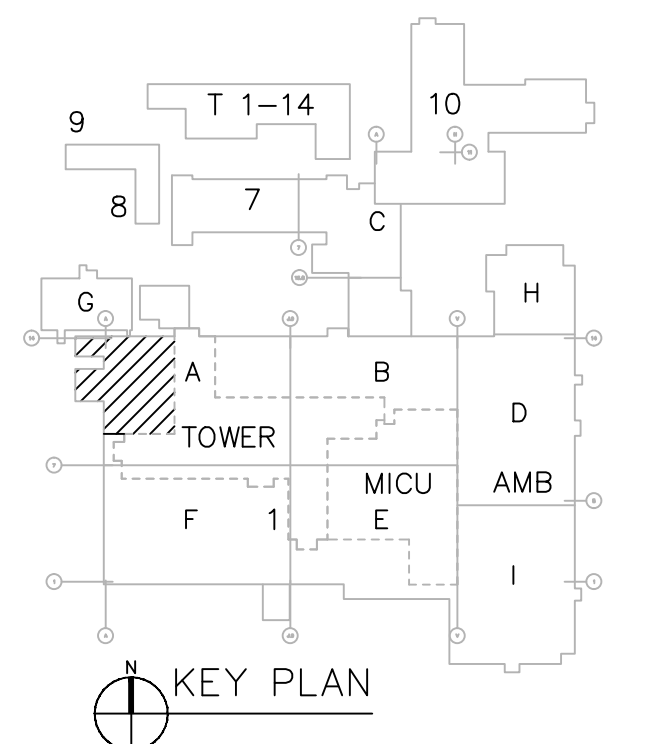

DESIGN DEVELOPMENT - NOT FOR CONSTRUCTION

[illegible]