

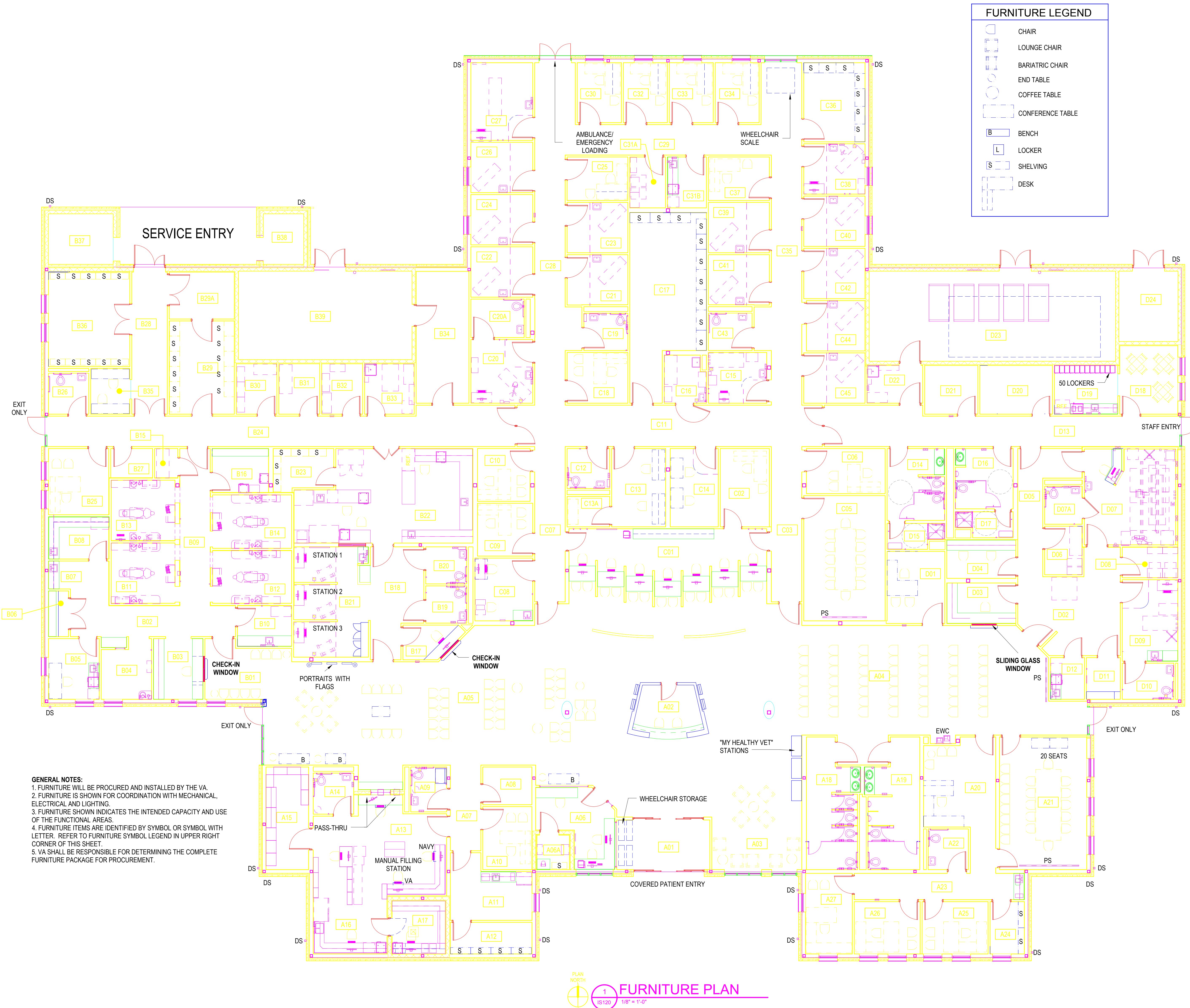

three inches = one foot
one and one half inches = one foot
one inch = one foot
three quarters inch = one foot
one half inch = one foot
three eighths inch = one foot
one eighth inch = one foot
one quarter inch = one foot
one eighth inch = one foot



GENERAL NOTES:
1. FURNITURE WILL BE PROCURED AND INSTALLED BY THE VA.
2. FURNITURE IS SHOWN FOR COORDINATION WITH MECHANICAL, ELECTRICAL AND LIGHTING.
3. FURNITURE SHOWN INDICATES THE INTENDED CAPACITY AND USE OF THE FUNCTIONAL AREAS.
4. FURNITURE ITEMS ARE IDENTIFIED BY SYMBOL OR SYMBOL WITH LETTER. REFER TO FURNITURE SYMBOL LEGEND IN UPPER RIGHT CORNER OF THIS SHEET.
5. VA SHALL BE RESPONSIBLE FOR DETERMINING THE COMPLETE FURNITURE PACKAGE FOR PROCUREMENT.

FURNITURE LEGEND	
	CHAIR
	LOUNGE CHAIR
	BIARIATRIC CHAIR
	END TABLE
	COFFEE TABLE
	CONFERENCE TABLE
	BENCH
	LOCKER
	SHELVING
	DESK

ROOM NAME LEGEND	
ROOM NAME	RM#
VESTIBULE	A01
VOL. INFO DESK	A02
WAITING AREA "C"	A03
WAITING AREA "B"	A04
WAITING AREA "A"	A05
OPER. ROOM	A06
SECURE STG. VAULT	A06A
CORR.	A07
COMM.	A08
FAM. TLT	A09
VOL. SERV. OFF.	A10
VOL. MP ROOM	A11
STG.	A12
RECEP. WKST.	A13
TLT: UNISEX	A14
LOW VOLUME BULK STOR.	A15
STOR. / DISPENSING	A16
SECURE STOR. VAULT	A17
WOMEN RR	A18
MEN'S RR	A19
OFFICE, SECT. & WAITING	A20
CONFERENCE ROOM	A21
ST. TLT	A22
CORR.	A23
SUPP. EQUIP.	A24
ADMIN. OFF.	A25
NURSE MGR.	A26
CHIEF MED. OFFICE	A27
WAITING	B01
CORR.	B02
RECEP / CHECK-IN FILES	B03
X-RAY	B04
OFF / MED. ROOM	B05
BULK STG.	B06
PROS. PREP.	B07
PROS. LAB	B08
CORR.	B09
STER. INST. STG.	B10
HYGIENE OP.	B11
GEN. TREATMENT OP.	B12
HYGIENE OP.	B13
GEN. TREATMENT OP.	B14
SOIL UTIL.	B15
CLEAN STG.	B16
TECH/CHECK-IN	B17
CORR.	B18
LAB. TLT	B19
LAB. TLT	B20
BLOOD SPECIMEN COLL.	B21
CLINICAL LAB	B22
BULK STG.	B23
CORR.	B24
AFGE OFFICE	B25
MECH.	B26
RECEIVING	B27
STOR. / STERILE	B28
BULK STOR.	B29A
STG. CLEAN LINEN CT	B30
STG. SOILED LINEN CT	B31
INFECT / HAZ. WASTE	B32
HAC	B33
FMS	B34
FMS WORK SPACE	B35
STG. EMS / LARGE EQUIP.	B36
MEDICAL GAS STG.	B37
RECYCLE RM	B38
MECHANICAL ROOM	B39
MAS: CENTRAL RECEPTION	C01
LEAD CLERK / WORKROOM	C02
CORR.	C03
MULTI PURPOSE CLASS/CONF.	C05

ROOM NAME LEGEND	
ROOM NAME	RM#
SOCIAL WORKER	C06
CORR.	C07
VISION SCREENING (TELERETINAL)	C08
FEE PHARMACIST	C09
CLINICAL PHARMACIST	C10
CORR.	C11
ST. TLT.	C12
COHT NURSE / PSA	C13
COHT PSA STG	C13A
TELEHEALTH	C14
EKG	C15
S. UTILITY RM	C16
MED. EQUIP. / CRASH CART STG.	C17
DIETITIAN	C18
PT. TLT	C19
GYN. EXAM RM	C20
PT. TLT	C20A
EXAM RM	C21
EXAM RM	C22
EXAM RM	C23
EXAM RM	C24
CASE MGR. OFF.	C25
EXAM RM	C26
MULTIPURPOSE PROC. RM	C27
CORR.	C28
CORR.	C29
CASE MGR. OFF.	C30
CLEAN UTIL.	C31A
MED. RM.	C31B
CASE MGR. OFF.	C32
CASE MGR. OFF.	C33
CASE MGR. OFF.	C34
CORR.	C35
LINEN, STRETCHER, MEDICAL EQUIP. STOR.	C36
CASE MGR. OFF.	C37
EXAM RM	C38
EXAM RM	C39
EXAM RM	C40
EXAM RM	C41
EXAM RM	C42
PT. TLT	C43
EXAM RM	C44
EXAM RM	C45
R.O.I.	D01
CIRCULATION	D02
RECEP.	D03
TECHS	D04
CORR.	D05
S. UTILITY	D06
RADIOLOGY	D07
PT. TLT	D07A
CLEAN STG.	D08
ULTRASOUND	D09
PT. TLT	D10
DRESS	D11
MED. RM.	D12
CORR.	D13
WOMEN'S ST. TLT	D14
SHOWER	D15
MEN'S ST. TLT	D16
SHOWER	D17
BREAK RM.	D18
LOCKER/IT.	D19
COMM. RM	D20
ELEC. SYS.	D21
HAC	D22
MECHANICAL	D23
ELECTRICAL	D24
Grand total: 140	

CONSULTANTS:			ARCHITECT/ENGINEERS:			Drawing Title FURNITURE PLAN		Project Title PANAMA CITY JOINT OUTPATIENT CLINIC VA GULF COAST HEALTH CARE		Office of Construction and Facilities Management	
CIVIL: KENNETH HORNE & ASSOCIATES 7201 NORTH 9TH AVENUE, STE. 6 PENSACOLA, FLORIDA 32504 PH: (850) 471-8005 FX: (850) 471-8003			SURVEYORS: KCI TECHNOLOGIES, INC. 10401 HIGHLAND MANOR DRIVE, SUITE 120 TAMPA, FLORIDA 33618 PH: (813) 740-2300			Approved: Project Director		Location PANAMA CITY, FLORIDA		Dwg. 1 of 6	
LANDSCAPE ARCHITECT: CSA GROUP, INC. 6300 PICCADILLY SQUARE DRIVE MOBILE, ALABAMA 36689 PH: (251) 344-4023 FX: (251) 344-4022			ARCHITECTURE: BULLOCK TIGHE ASSOCIATES, INC. 909 EAST CERVANTES STREET PENSACOLA, FL 32501 PH: (850) 434-5444 FX: (850) 432-5208			Date MARCH 2012		Checked BM		Drawn TWMF	
Revisions:			Date								