

**MEN'S RESTROOM**

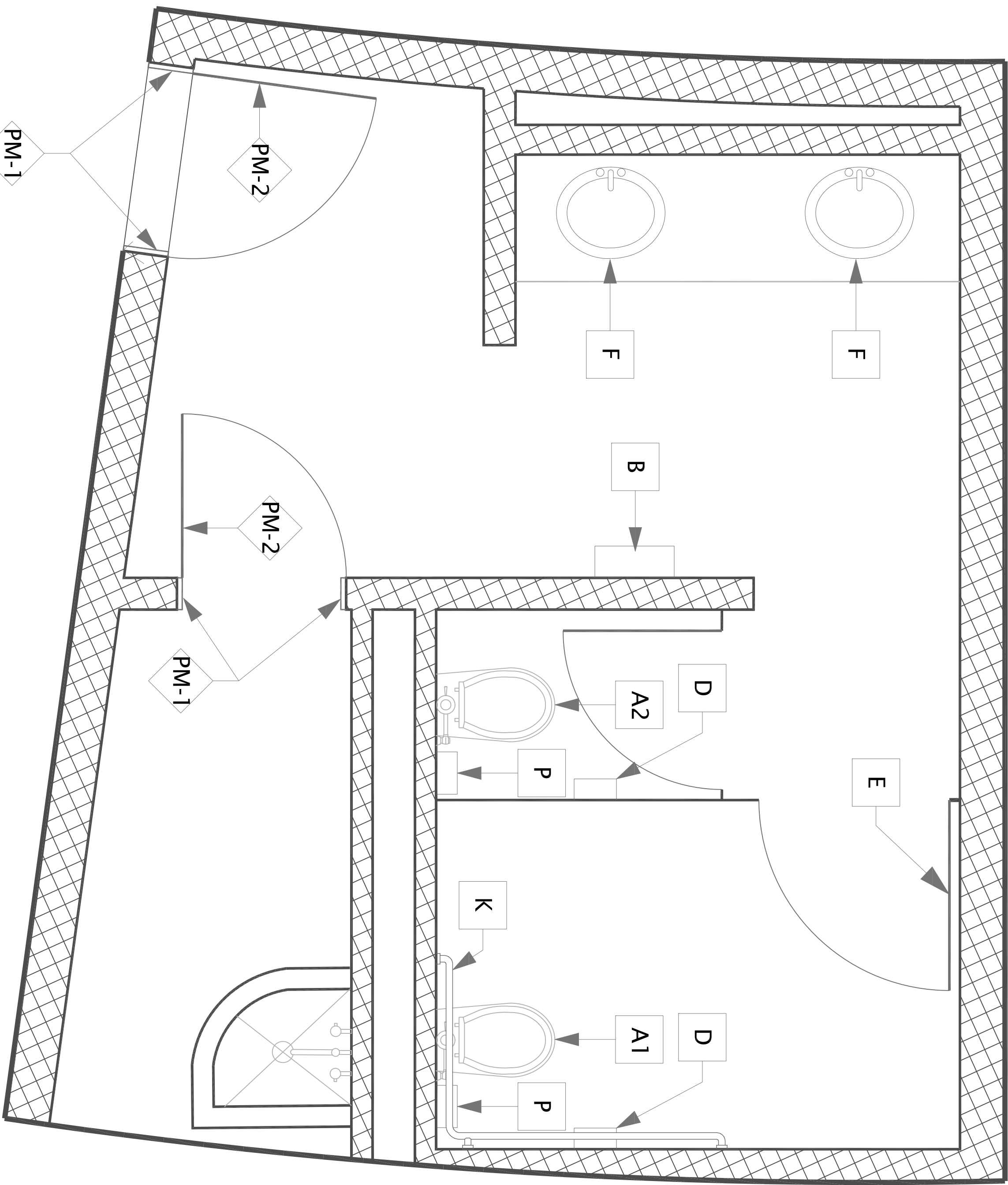

WOMEN'S RESTROOM

## 1 FINISH PLAN

SCALE: 1/2" = 1'-0"

## ROOM FINISH GENERAL NOTES

1. 1/4" MFG. TO BE CUT AND INSTALLED AS SHOWN IN 1401-AS02 ELEVATIONS
2. PM-1 TO BE USED FOR HOLLOW METAL DOOR FRAMES
3. ALL PT. TO BE INSTALLED WITH GR-1
4. RESTROOM VANITY REMOVABLE PANEL TO BE PL-2
5. ALL TOILET PARTITIONS TO BE TP
6. REFERENCE TO MANUFACTURERS AND PRODUCT NUMBERS IS TO ESTABLISH COLORS AND PATTERNS REQUIRED ONLY

ROOM FINISH AND COLOR SCHEDULE							
SPACE					CEILING		REMARKS BY NUMBER
NUMBER	ROOM NAME	FLOOR	BASE	WALL	MAT'L	HEIGHT	
MENS		VC1-1	PT-4	PT-4, PT-5, PT-6	P-1	8'0"	1,2
MENS JANITOR		VC1-1	P-6		P-1	8'0"	2
WOMENS		VC1-1	PT-4	PT-4, PT-5, PT-6	P-1	8'0"	1,2
WOMENS JANITOR		VC1-1	P-6		P-1	8'0"	2

## ROOM FINISH LEGEND

GR	GROUT	PT	PORCELAN TILE	
1	MAPEL: 1/8" SANDED GROUT: 94 STRAW	4	12" X 24" REFIN CERAMICHE: STONE-LEADER, BEIGE, RNT1000	
IP	GYPSUM BOARD, REPAINT BENJAMIN MOORE: EGGSHELL, OC-31 FOG MIST	5	12" X 24" REFIN CERAMICHE: STONE-LEADER, BROWN, RN1001	
		6	6" X 12" REFIN CERAMICHE: STONE-LEADER MOSAICO, BEIGE, RT1500	
		SS	SOLID SURFACE	
PL	PLASTIC LAMINATE	3	DUPONT: CORIAN, CAMEL (F)	
2	WILSONART: 4941-80 DESERT ZEPHYR	TP	TOILET PARTITIONS	
PMF	PAINTED METAL BENJAMIN MOORE: SEMI-GLOSS, 1477 DEEP CREEK	VCT	1	VINYL COMPOSITION TILE
			2	ARMSTRONG: RAFRIA 55805 COCOA

## ROOM FINISH LEGEND

PT	PORCELAIN TILE
4	12 X 24" REFIN CERAMIC: STONE-LEADER, BEIGE, RN1000
5	12 X 24" REFIN CERAMIC: STONE-LEADER, BROWN, RN1001
6	6" X 12" REFIN CERAMIC: STONE-LEADER MOSAICO, BEIGE, RT1500
SS	SOLID SURFACE
3	DUPONT® CORIAN (F)
TPP	TOLLETT PARTITIONS
	STAINLESS STEEL, FLOOR MOUNTED WITH OVERHEAD BRACING
VCT	VINYL COMPOSITION TILE
1	ARMSTRONG, RAFFIA 55805 COCOA

Revisions	Date

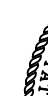

NATIONAL  
C EMETERY  
ADMINISTRATION

<div> <div>Drawing Title</div> <div><b>FINISH PLAN</b></div> </div>
<div> <div>Approved: Division Chief</div> <div>Approved: Service Director</div> </div>

Project Title	<b>RENOV. HEMICYCLE RESTROOMS</b>		
Building Number	*****	Checked	Drawn <b>CFC</b>
Location	<b>HOUSTON NATIONAL CEMETERY</b>		

Date	03/14/2016
Project No.	851-16-201
DRAWING NO.	<b>A-102</b>
Dwg. 3 Of 4	