

6 TYPICAL SMOKE / HEAT DETECTOR WIRING DIAGRAM
NOT TO SCALE

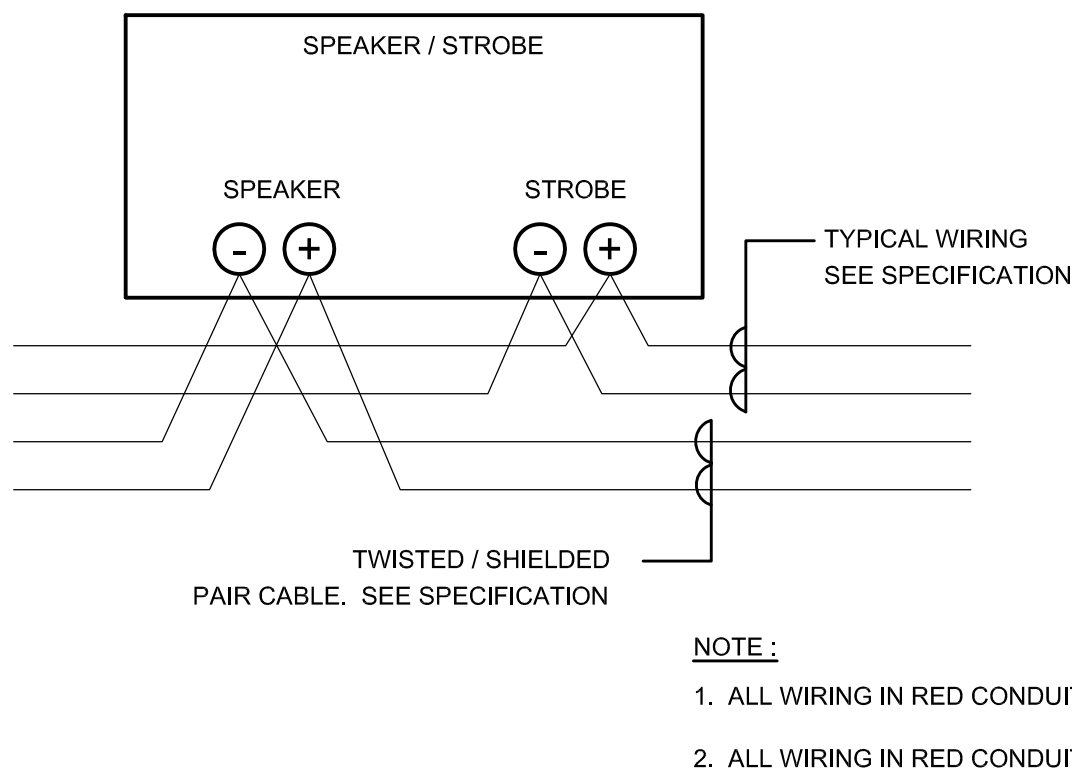

7 TYPICAL SPEAKER / STROBE WIRING DETAIL
NOT TO SCALE

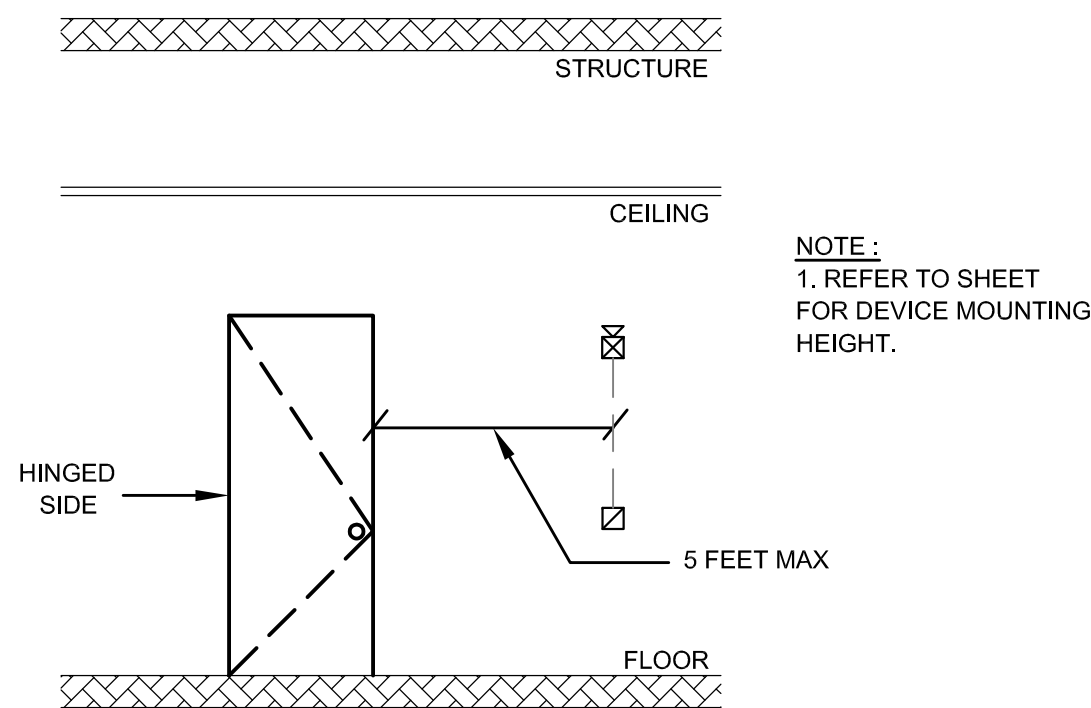

8 TYPICAL INSTALLATION AT EXIT DOOR
NOT TO SCALE

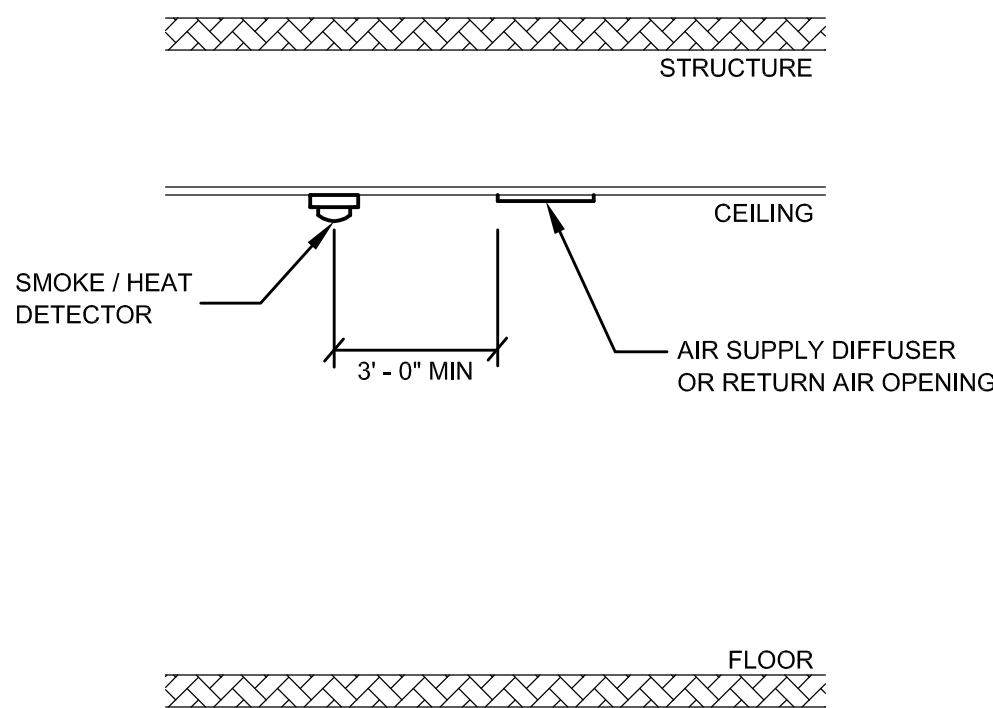

9 TYPICAL HEAT / SMOKE DETECTOR INSTALLATION BY MECHANICAL DIFFUSER
NOT TO SCALE

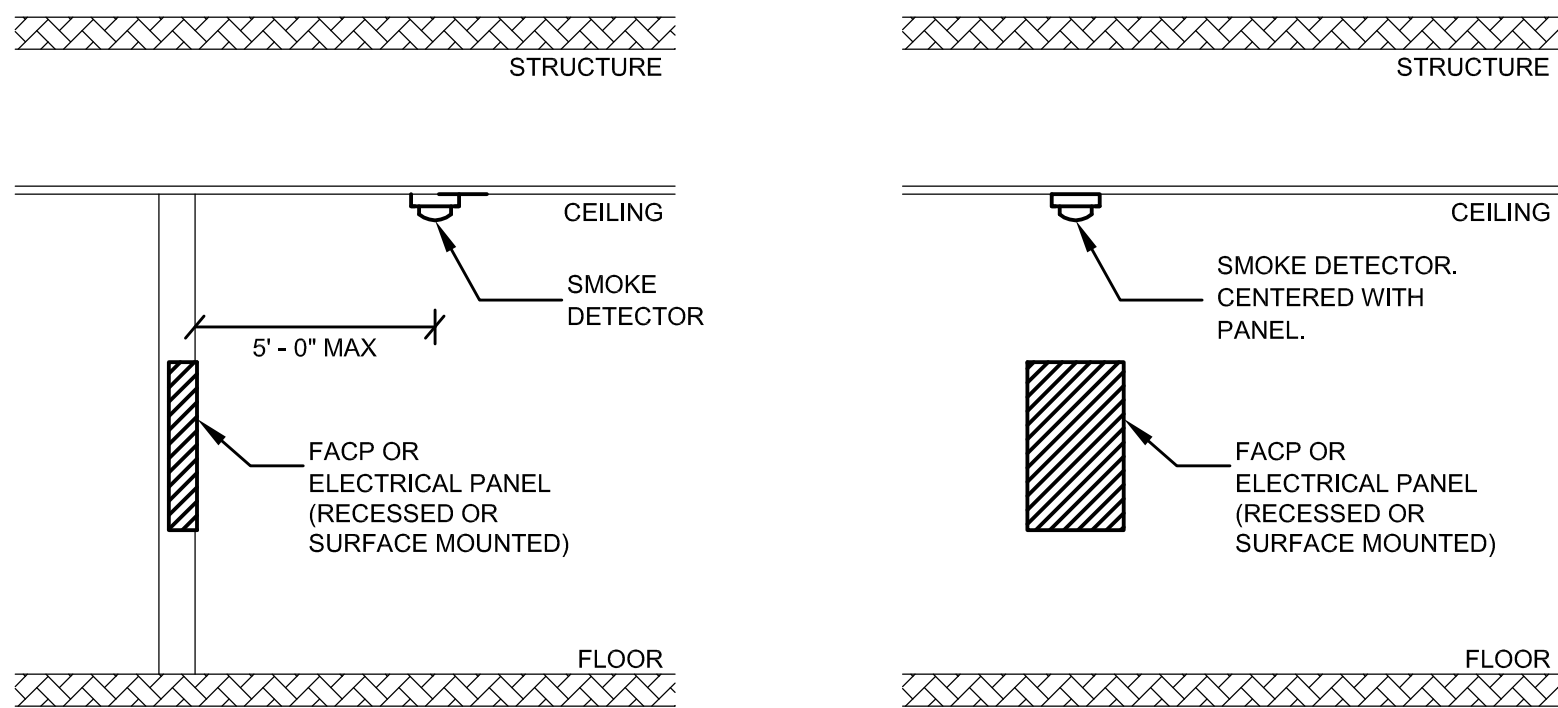

10 TYPICAL SMOKE DETECTOR INSTALLATION AT PANEL
NOT TO SCALE

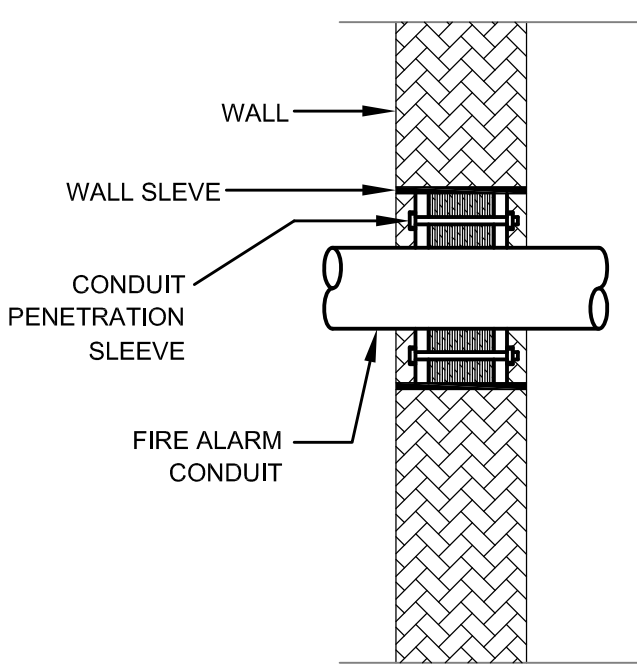

11 PVC, RIGID CONDUIT PENETRATION, TYPICAL
NOT TO SCALE

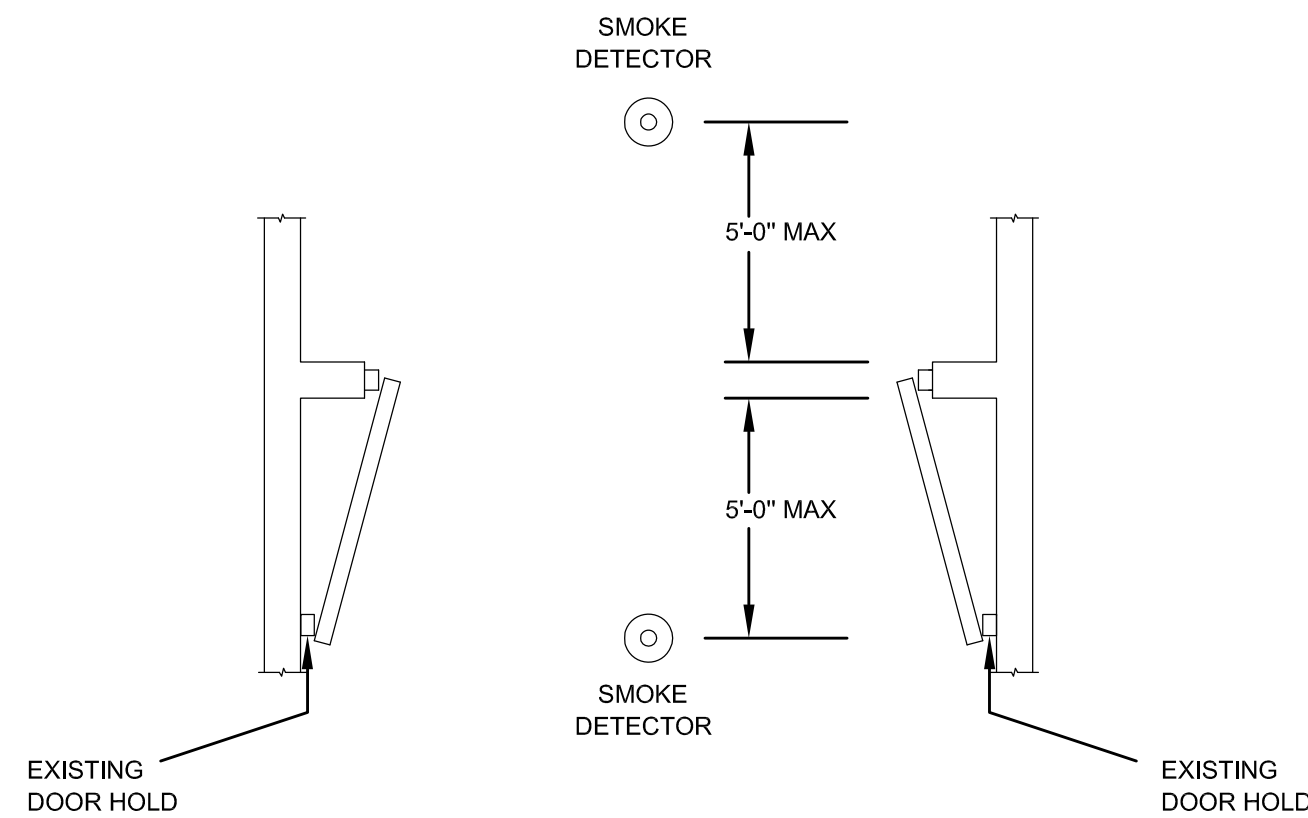

12 TYPICAL SMOKE DOOR INSTALLATION
NOT TO SCALE

ADDENDUM #4

13 NOT USED
NOT TO SCALE

LINE 1 TEXT
LINE 2 TEXT
LINE 3 TEXT
LINE 4 TEXT

- NOTES:
1. LINE 1 AND LINE 2 TEXT SHALL BE A MINIMUM 1 / 2 ".
 2. LINE 3 AND LINE 4 TEXT SHALL BE A MINIMUM 1 / 4 ".
 3. CONTRACTOR SHALL CONFIRM ALL LABELLING WITH VA FIRE MARSHALL.
 4. LABEL SIZE SHALL VARY BASED ON CONTENTS OF LABEL.

LABEL TYPE	FACP	FACP	FACP	FACP
FACP	FIRE ALARM CONTROL PANEL	FACP ID NUMBER	ROOM NUMBER	BUILDING NUMBER
AUXILIARY POWER PANELS	FIRE ALARM AUXILIARY POWER PANEL	AUXILIARY PANEL ID NUMBER	FLOORS BEING SERVED	ROOM AND BUILDING NUMBER
ABOVE CEILING DEVICES	DEVICE TYPE	DEVICE ADDRESS	EQUIPMENT BEING SERVED	ROOM AND BUILDING NUMBER
FLOW / TAMPER SWITCHES	DEVICE TYPE	DEVICE ADDRESS	EQUIPMENT BEING SERVED	ROOM AND BUILDING NUMBER

14 TYPICAL FIRE ALARM DEVICE AND EQUIPMENT LABELING
NOT TO SCALE

CONSTRUCTION DOCUMENT

ADDENDUM 4	10/25/11
Revisions:	Date



Dept. of Veterans Affairs
Medical Center
500 E. Veterans Street
Tomah, WI



PROJECT LEADER / ENGINEER:

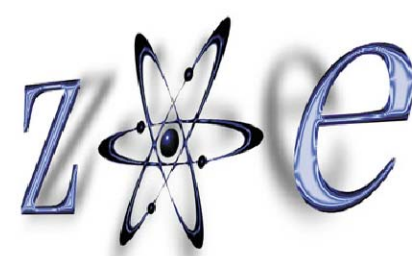

Zoe Engineering, L.L.C.
1126 South 70th Street
Suite S204A
Milwaukee, WI 53214
(414) 475-2715 Office
(414) 475-2716 Fax

CONSULTANT:

Drawing Title
Fire Alarm Details

Approved: Project Director

Project Title
Fire Alarm System Upgrade Project

Location
VA Medical Center, Tomah, WI

Date
27 JUNE, 2011

Checked
Zoe

Drawn
Zoe

Project Number
676-10-106

Building Number
-

Drawing Number

FA-900
Sh 2 of 2

Office of
Facilities
Management

