

one eighth inch = one foot  
one quarter inch = one foot  
three eighths inch = one foot  
one half inch = one foot  
three quarters inch = one foot  
one inch = one foot  
one and one half inches = one foot  
two inches = one foot  
three inches = one foot

C:\Users\parched\Documents\31000\_pawshot  
1/30/2015 1:21 PM

DIRTT Finish Schedule		
Tag	Finish	Specification
M1	ANO	Grade 1 Anodized; Anodized Finish - Clear
M2	PWD	DIRTT Powder Coated; Powder Coat - Shimmer DPM50
M4	PWD	DIRTT Powder Coated Metallic; Powder Coat - Shimmer DPM50
M8	THRM	Thermofoil Grade 1; DIRTT Thermofoil Ash White
M9	THRM	LPL White Side B
M10	MEL	Finished Back Panel - Double Sided LPL Substrate (Pre-Finished); LPL White
M11	PWD	Default Powder Coat; Custom Powder Coat
M12	PNT	Grade 1 - Standard; Chroma Coat - Riff DC51
M13	GLS	Grade 1 (Non-metallic) Backpaint; Clear Glass: Riff; Flat Polish all edges;6.0mm
M14	TFAB	Xorel Dash; DIRTT Fabric Xorel - Bio Dash 36
M15	VEN	Veneer - Grade 2; Veneer - Teck Cherry Quarter Cut ST 10000; Quarter Cut
M16	GLS	Center Mounted Tempered Glass Tile; 6mm Tempered Glass - Clear; No Edge Polish;6.0mm
M17	WGLS_Graphic	Corning Willow Glass; DIRTT Pattern; Graphic - Gem Stoned Blue DWP112;12.7mm
M18	THRM	Thermofoil Grade 1; DIRTT Thermofoil Snow White
M19	MEL	LPL White Drawer Parts
M20	PNT	Grade 1 - Standard; Chroma Coat - Polar White DC22
M21	GLS	Stick Built Tempered Glass Tile; 10mm Tempered Glass - Clear; Flat Polish all edges;10.0mm
M22	VEN	Veneer - Grade 2; Veneer - Teck Cherry Quarter Cut ST 10000; Quarter Cut
M23	PNT	Grade 1 - Standard; Chroma Coat - Nuwhite DC19
M25	MCF	Write Away Tile - White

FINISH SCHEDULE

DIRTT Door Schedule								
Tag	Size	Handedness	Locking	Closer Type	Stopper	Finish Tag	Hardware	
BD1	Height 9' - 1 7/8" X Width 3' - 4 1/4"	LH	No	Piston		M15, M16, M11,	30" x 24" C to C Bar Pull 630 Finish()	Barivot Barn Door Slim Track
BD2	Height 9' - 1 7/8" X Width 3' - 4 1/4"	RH	No	Piston		M15, M16, M11,	30" x 24" C to C Bar Pull 630 Finish()	Barivot Barn Door Slim Track
BD3	Height 9' - 1 7/8" X Width 3' - 4 1/4"	RH	No	Piston		M15, M16, M11,	30" x 24" C to C Bar Pull 630 Finish()	Barivot Barn Door Slim Track
BD4	Height 9' - 1 7/8" X Width 3' - 4 1/4"	LH	No	Piston		M15, M11, M16,	30" x 24" C to C Bar Pull 630 Finish()	Double Barn Door V4 Track
BD5	Height 9' - 1 7/8" X Width 3' - 4 1/4"	RH	No	Piston		M15, M11, M16,	30" x 24" C to C Bar Pull 630 Finish()	Double Barn Door V4 Track
BD6	Height 9' - 10 1/2" X Width 3' - 4 1/4"	RH	No	Piston		M15, M16, M11,	30" x 24" C to C Bar Pull 630 Finish()	Barivot Barn Door Slim Track
PD1	Height 9' - 1 5/16" X Width 3' - 2"	LH	PassageSet	Regular	Dome (Floor Location) S100-626	M15, M16,	Barivot Goldie Door Passage Set()	Door Lever Schlage Passage Saturn()
PD3	Height 9' - 1 5/16" X Width 3' - 2"	LH	Deadlock	Regular	Dome (Floor Location) S100-626	M15, M16,	Barivot Goldie Door Pull(), ( ), 30" x 24" C to C Bar Pull 630 Finish()	Schlage Deadlock B560P Single Cylinder Deadbolt()
PD7	Height 6' - 7 5/16" X Width 3' - 2"	RH	PassageSet	Regular	Dome (Floor Location) S100-626	M15, M16,	Barivot Goldie Door Passage Set()	Door Lever Schlage Passage Saturn()
PD8	Height 6' - 7 5/16" X Width 3' - 2"	LH	PassageSet	Regular	Dome (Floor Location) S100-626	M15, M16,	Barivot Goldie Door Passage Set()	Door Lever Schlage Passage Saturn()

DOOR SCHEDULE

SHEET NOTES

KEY NOTES

SEISMIC REQUIRED

EXTRUSION PROFILE: RECTILINEAR

FRAME FINISH: COM POWDER COAT AND VENEER WRAPPED

BASE TRIM FINISH: SILVER SANTOPRENE

PVC/GLASS WIPE: SILVER

CEILING HEIGHT: 9' 6"

CEILING TYPE: GRID

FLOOR TYPE: CARPET

DOORS: OFFICES - GOLDIE PIVOT DOORS AND BARN DOORS (4" STILE), WITH VENEER WRAPPED ALUMINUM- 30" C to C BAR PULL WITH 630 FINISH.

CONFERENCE ROOMS - FRAMELESS GLASS PIVOT DOORS NON-LOCKING- 30" C to C BAR PULL WITH 630 FINISH

LEGEND

ELECTRICAL PROVISION REQUIRED:

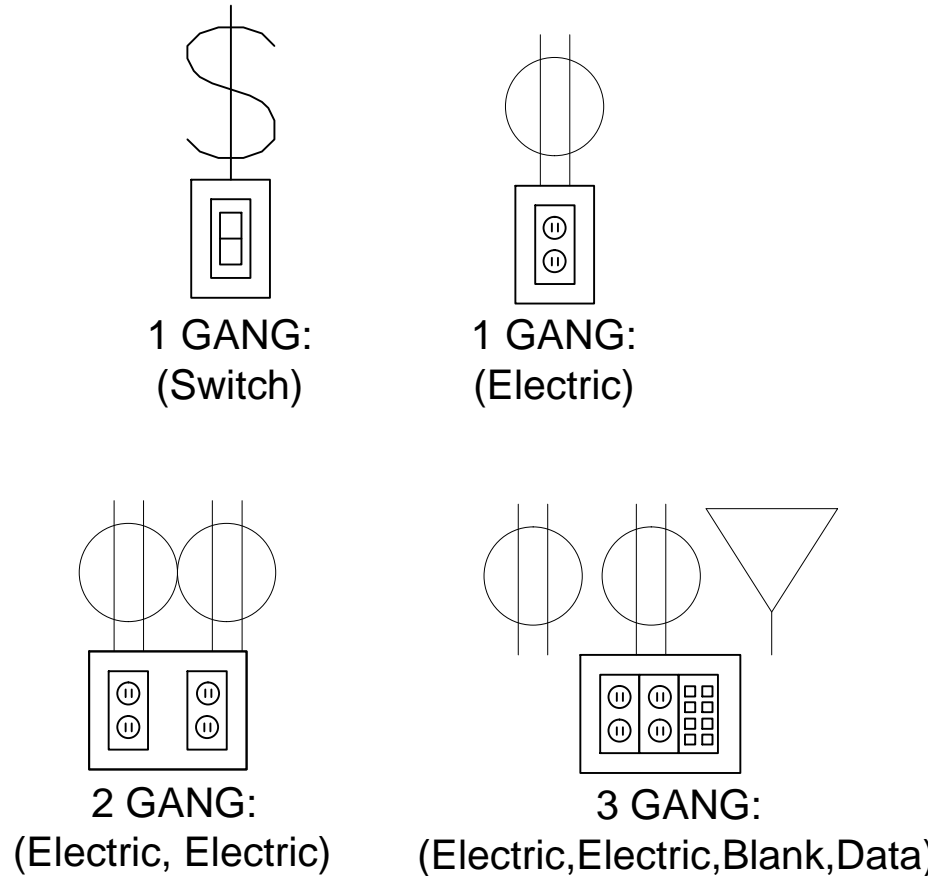

KEY PLAN

CLIENT APPROVAL

- APPROVED DRAWING PACKAGE
- APPROVED, AS NOTED
- REVISED, RESUBMIT

Authorized Signing Officer \_\_\_\_\_ Date \_\_\_\_\_

This drawing represents DIRTT's interpretation of the design intent and serves as our shop drawings for manufacturing purposes. The details and scope in these drawings represent the product that will be produced by DIRTT Environmental Solutions and delivered to site. All additions, changes or deviations from this approval drawing package will be regarded as a change order and processed accordingly. Approval of this drawing package is one of the conditions precedent to commencement of manufacturing.

DIRTT Environmental Solutions

N.I.C. - FOR REFERENCE ONLY

65% CD SUBMISSION  
MARCH 16, 2015  
NOT FOR CONSTRUCTION

CONSULTANTS:

ARCHITECT

POLYTECH ASSOCIATES INC.  
235 Pine Street, 17th Floor  
San Francisco, CA 94104  
TEL (415) 397-3117  
FAX (415) 397-1517

Drawing Title  
DIRTT OVERALL PLAN

Approved: Project Director

Project Title  
POST TRAUMATIC STRESS DIAGNOSIS (PTSD)  
EXPANSION & RENOVATION

Location  
795 WILLOW ROAD, MENLO PARK, CA

Date  
07.30.15

Checked  
Author

Drawn  
Checker

Project Number  
640-235003

Building Number  
BUILDING 334 & 360

Drawing Number  
334 AI718

Office of  
Construction  
and Facilities  
Management









three inches = one foot  
one and one half inches = one foot  
one inch = one foot  
three quarters inch = one foot  
one half inch = one foot  
one quarter inch = one foot  
one eighth inch = one foot  
10/20/15 15:21 PM  
C:\Users\jared\Documents\31000\_00000.dwg

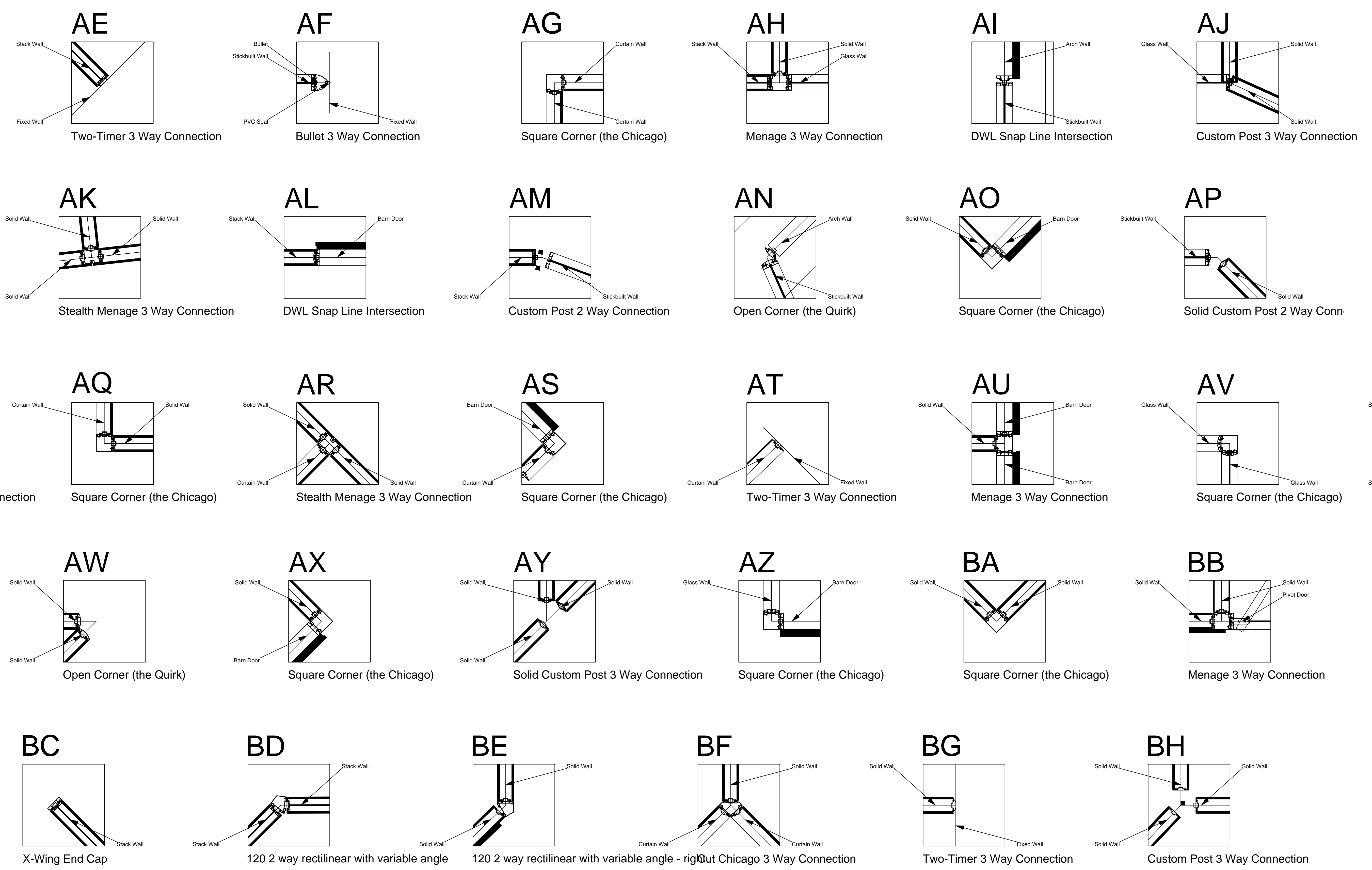

**INTERSECTION DETAILS**  
SCALE- 1"= 1'-0"

**SHEET NOTES**

**KEY NOTES**

SEISMIC REQUIRED

EXTRUSION PROFILE: RECTILINEAR

FRAME FINISH: COM POWDER COAT AND VENEER WRAPPED

BASE TRIM FINISH: SILVER SANTOPRENE

PVC/GLASS WIPE: SILVER

CEILING HEIGHT: 9' 6"

CEILING TYPE: GRID

FLOOR TYPE: CARPET

DOORS:  
OFFICES - GOLDIE PIVOT DOORS AND BARN DOORS (4" STILE), WITH VENEER WRAPPED ALUMINUM- 30" C to C BAR PULL WITH 630 FINISH.

CONFERENCE ROOMS - FRAMELESS GLASS PIVOT DOORS NON-LOCKING- 30" C to C BAR PULL WITH 630 FINISH

**LEGEND**

**ELECTRICAL PROVISION REQUIRED:**

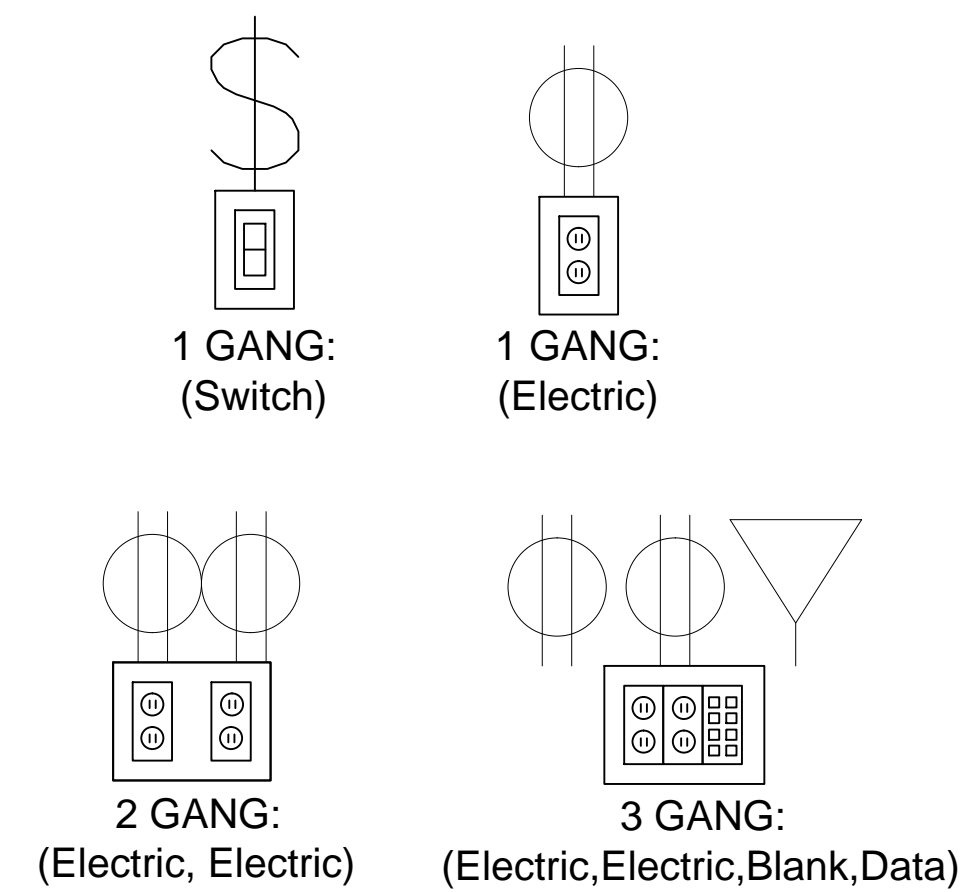

**KEY PLAN**

**CLIENT APPROVAL**

☐ APPROVED DRAWING PACKAGE  
☐ APPROVED, AS NOTED  
☐ REVISED, RESUBMIT

Authorized Signing Officer: \_\_\_\_\_ Date: \_\_\_\_\_

This drawing represents DIRT's interpretation of the design intent and serves as our shop drawings for manufacturing purposes. The details and scope in these drawings represent the product that will be produced by DIRT Environmental Solutions and delivered to site. All additions, changes or deviations from this approval drawing package will be regarded as a change order and processed accordingly. Approval of this drawing package is one of the conditions precedent to commencement of manufacturing.

DIRTT Environmental Solutions

**N.I.C. - FOR REFERENCE ONLY**

65% CD SUBMISSION  
MARCH 16, 2015  
NOT FOR CONSTRUCTION

Revisions:	Date	CONSULTANTS:	ARCHITECT	Drawing Title	Project Title	Project Number	Office of Construction and Facilities Management Department of Veterans Affairs
			POLYTECH ASSOCIATES INC. 235 Pine Street, 17th Floor San Francisco, CA 94104 TEL (415) 397-3117 FAX (415) 397-1517	DIRTT OVERALL PLAN	POST TRAUMATIC STRESS DIAGNOSIS (PTSD) EXPANSION & RENOVATION	640-235003	
				Approved: Project Director	Location	Building Number	
					795 WILLOW ROAD, MENLO PARK, CA	BUILDING 334 & 360	
					Date	Drawing Number	
					07.30.15	334 AI720	
					Checked Author	Drawn Checker	

three inches = one foot  
one and one half inches = one foot  
one inch = one foot  
three quarters inch = one foot  
one half inch = one foot  
three eighths inch = one foot  
one quarter inch = one foot  
one eighth inch = one foot  
C:\Users\jared\Documents\31000\_sawtooth  
1/20/2015 1:21 PM

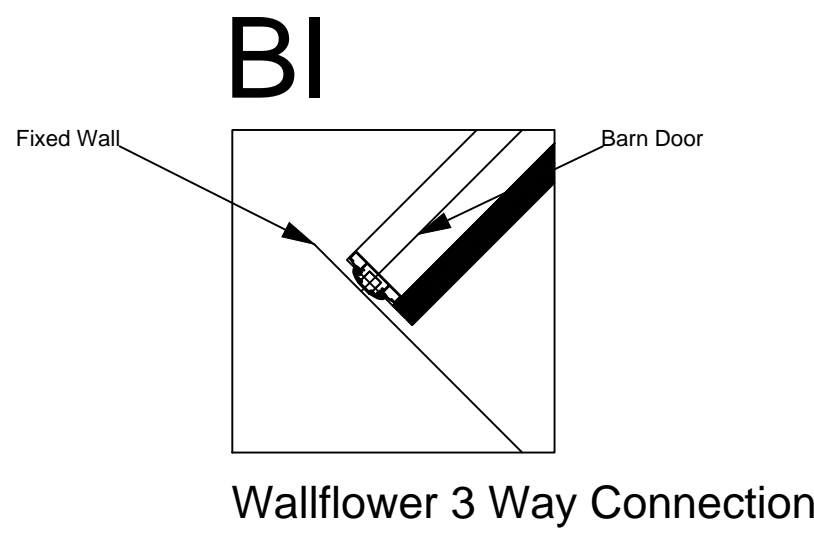

Wallfollower 3 Way Connection

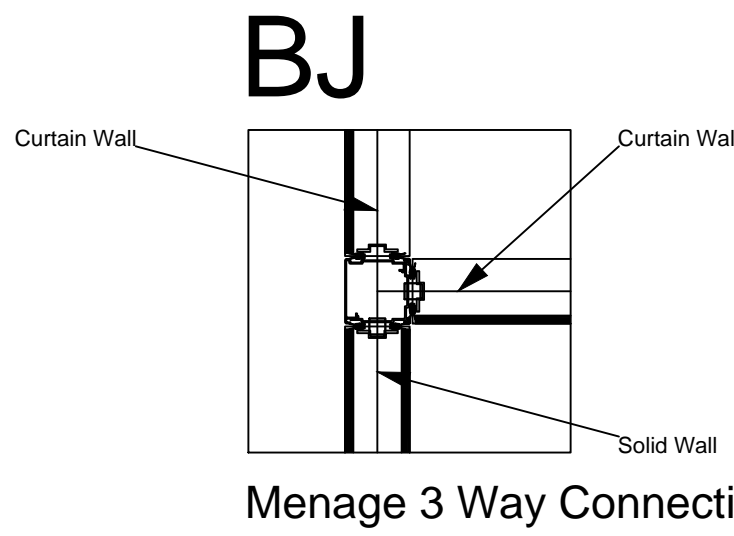

Menage 3 Way Connection

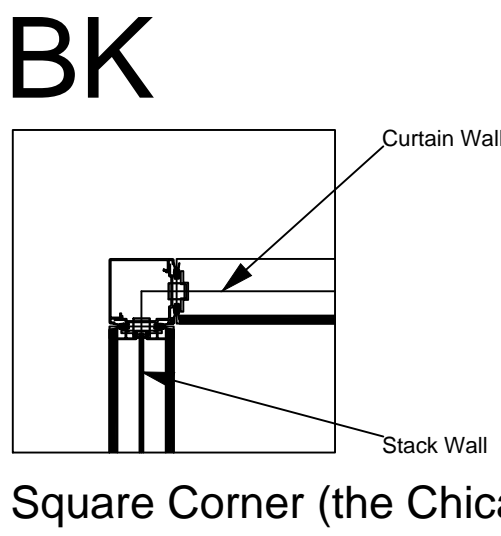

Square Corner (the Chicago)

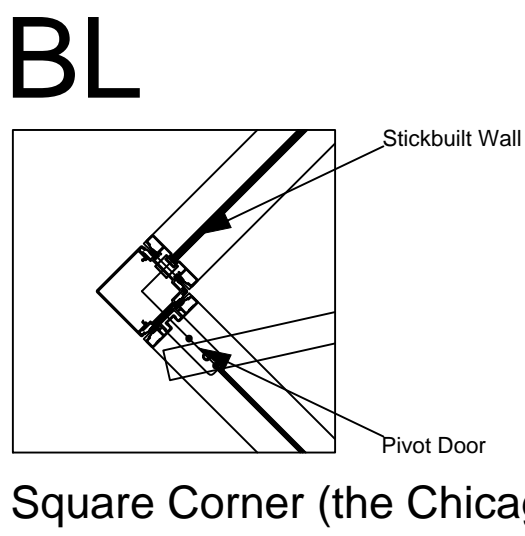

Square Corner (the Chicago)

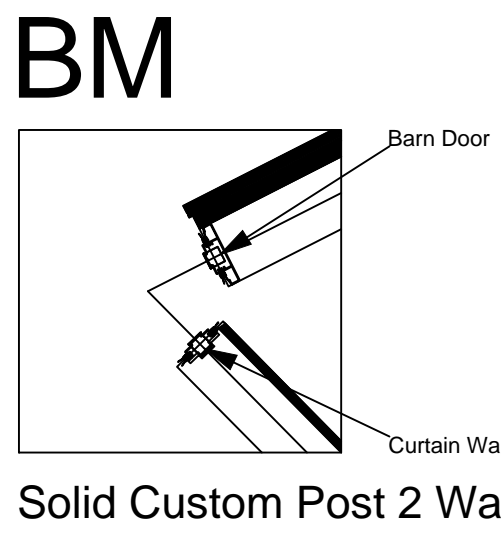

Solid Custom Post 2 Way Connection

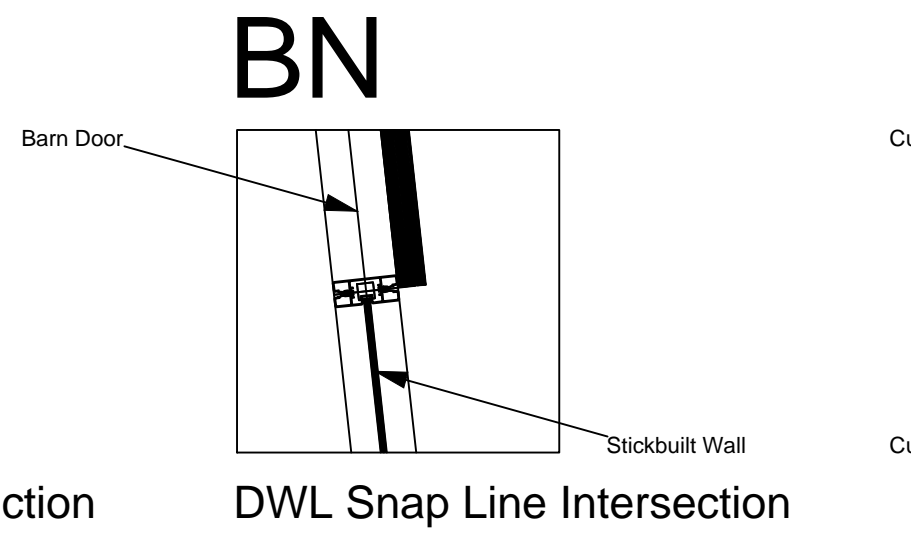

DWL Snap Line Intersection

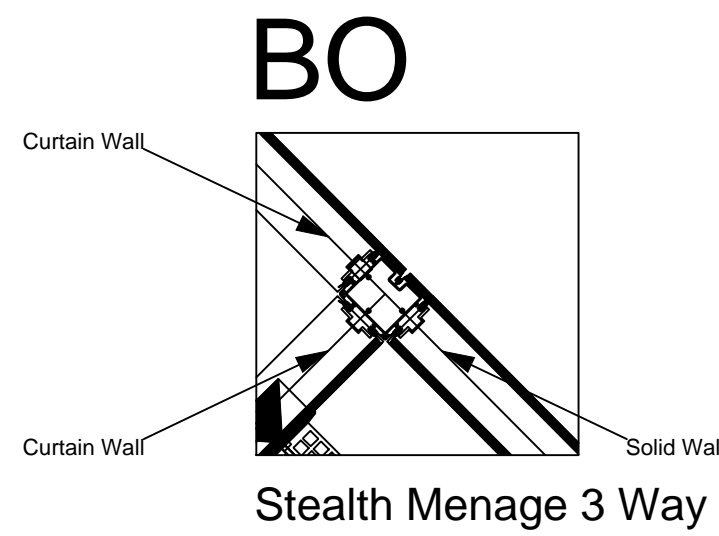

Stealth Menage 3 Way Connection

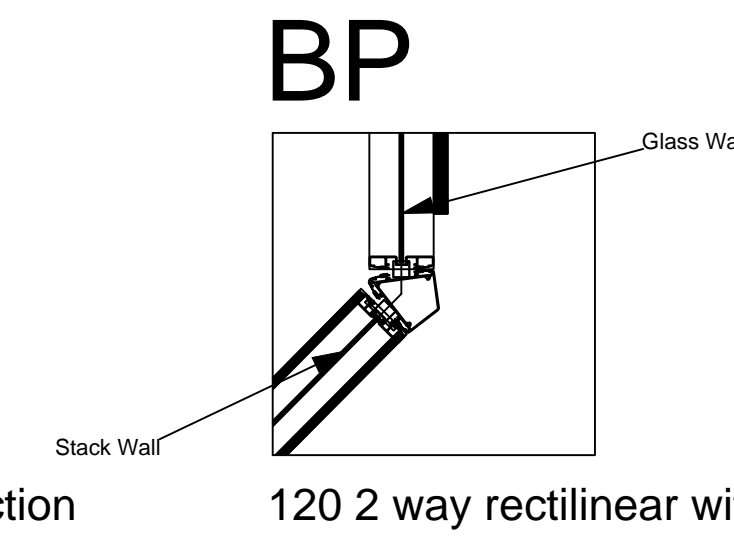

120 2 way rectilinear with variable angle

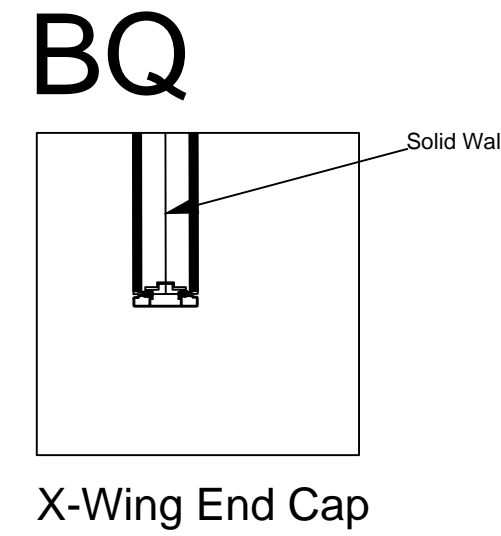

X-Wing End Cap

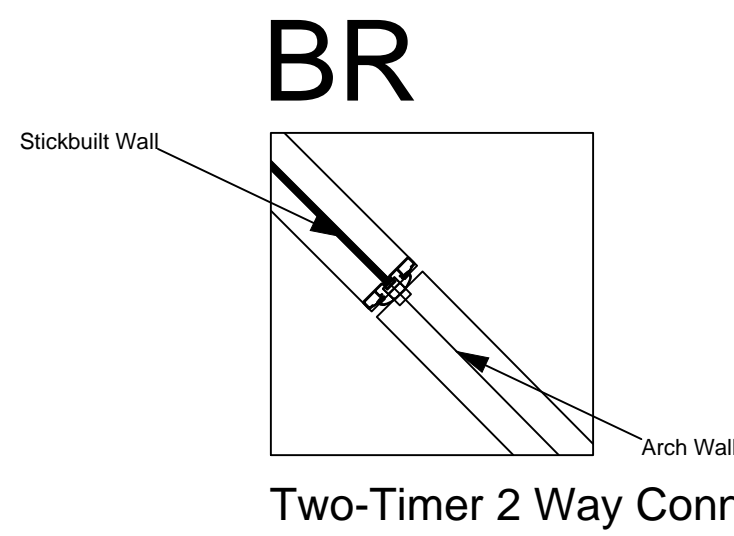

Two-Timer 2 Way Connection

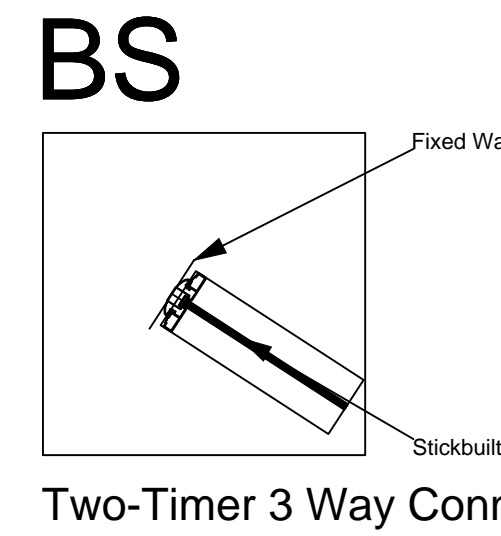

Two-Timer 3 Way Connection

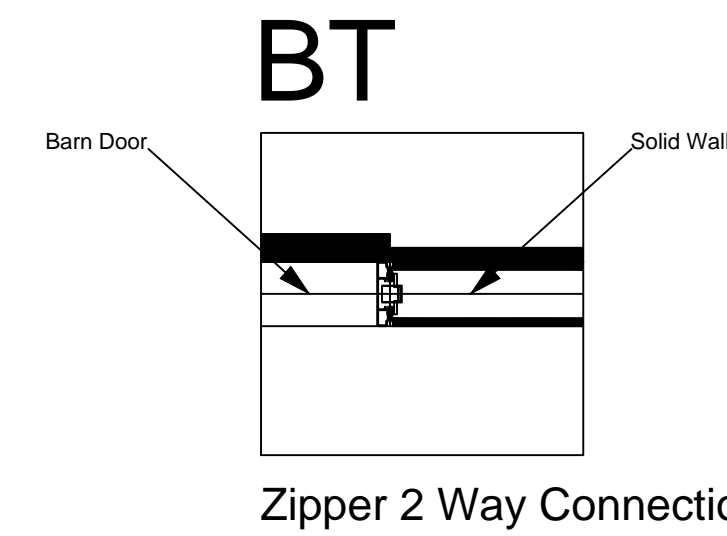

Zipper 2 Way Connection

## INTERSECTION DETAILS

SCALE- 1"= 1'-0"

CLIENT APPROVAL

☐ APPROVED DRAWING PACKAGE

☐ APPROVED, AS NOTED

☐ REVISED, RESUBMIT

Authorized Signing Officer

Date

This drawing represents DIRT's interpretation of the design intent and serves as our shop drawings for manufacturing purposes. The details and scope in these drawings represent the product that will be produced by DIRT Environmental Solutions and delivered to site. All additions, changes or deviations from this approval drawing package will be regarded as a change order and processed accordingly. Approval of this drawing package is one of the conditions precedent to commencement of manufacturing.

DIRTT Environmental Solutions

N.I.C. - FOR REFERENCE ONLY

CONSULTANTS:

ARCHITECT

POLYTECH ASSOCIATES INC.  
235 Pine Street, 17th Floor  
San Francisco, CA 94104  
TEL (415) 397-3117  
FAX (415) 397-1517

Drawing Title  
DIRTT OVERALL PLAN

Approved: Project Director

Project Title  
POST TRAUMATIC STRESS DIAGNOSIS (PTSD)  
EXPANSION & RENOVATION

Location  
795 WILLOW ROAD, MENLO PARK, CA

Date  
07.30.15

Checked  
Author

Drawn  
Checker

Project Number  
640-235003

Building Number  
BUILDING 334 & 360

Drawing Number  
334 AI721

65% CD SUBMISSION  
MARCH 16, 2015  
NOT FOR CONSTRUCTION

Office of  
Construction  
and Facilities  
Management

Department of  
Veterans Affairs

SHEET NOTES

### KEY NOTES

SEISMIC REQUIRED

EXTRUSION PROFILE: RECTILINEAR

FRAME FINISH: COM POWDER COAT  
AND VENEER WRAPPED

BASE TRIM FINISH: SILVER SANTOPRENE

PVC/GLASS WIPE: SILVER

CEILING HEIGHT: 9' 6"

CEILING TYPE: GRID

FLOOR TYPE: CARPET

DOORS:  
OFFICES - GOLDIE PIVOT DOORS AND BARN  
DOORS (4" STILE), WITH VENEER WRAPPED  
ALUMINUM- 30" C to C BAR PULL WITH 630  
FINISH.

CONFERENCE ROOMS - FRAMELESS GLASS  
PIVOT DOORS NON-LOCKING- 30" C to C BAR  
PULL WITH 630 FINISH

### LEGEND

#### ELECTRICAL PROVISION REQUIRED:

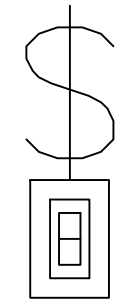

1 GANG:  
(Switch)

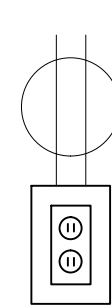

1 GANG:  
(Electric)

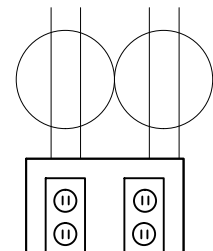

2 GANG:  
(Electric, Electric)

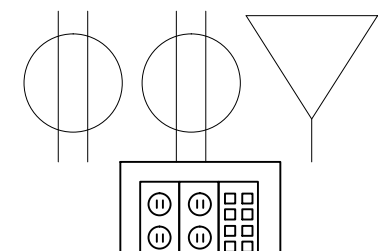

3 GANG:  
(Electric, Electric, Blank, Data)

### KEY PLAN



NOTE:  
CAUTION SHOULD BE TAKEN WHEN FASTENING TO POST TENSION  
SLABS OR TO FLOORS CONTAINING RADIANT HEATING. FLOORS MAY  
REQUIRE X-RAY TO ENSURE FASTENERS DO NOT CONFLICT WITH  
CONCEALED STRUCTURAL OR MECHANICAL ELEMENTS. ALL RELATIVE  
COSTS WILL BE PASSED ONTO THE CLIENT (NOT COVERED BY DIRT).

A THOROUGH REVIEW WITH LOCAL AUTHORITIES MAY BE REQUIRED  
TO ESTABLISH AN ACCEPTABLE ALTERNATIVE FASTENING METHOD  
WHICH MEETS BOTH INTERNATIONAL BUILDING CODE AND LOCAL  
REQUIREMENTS BASED ON THE INSTALLATION LOCATION.

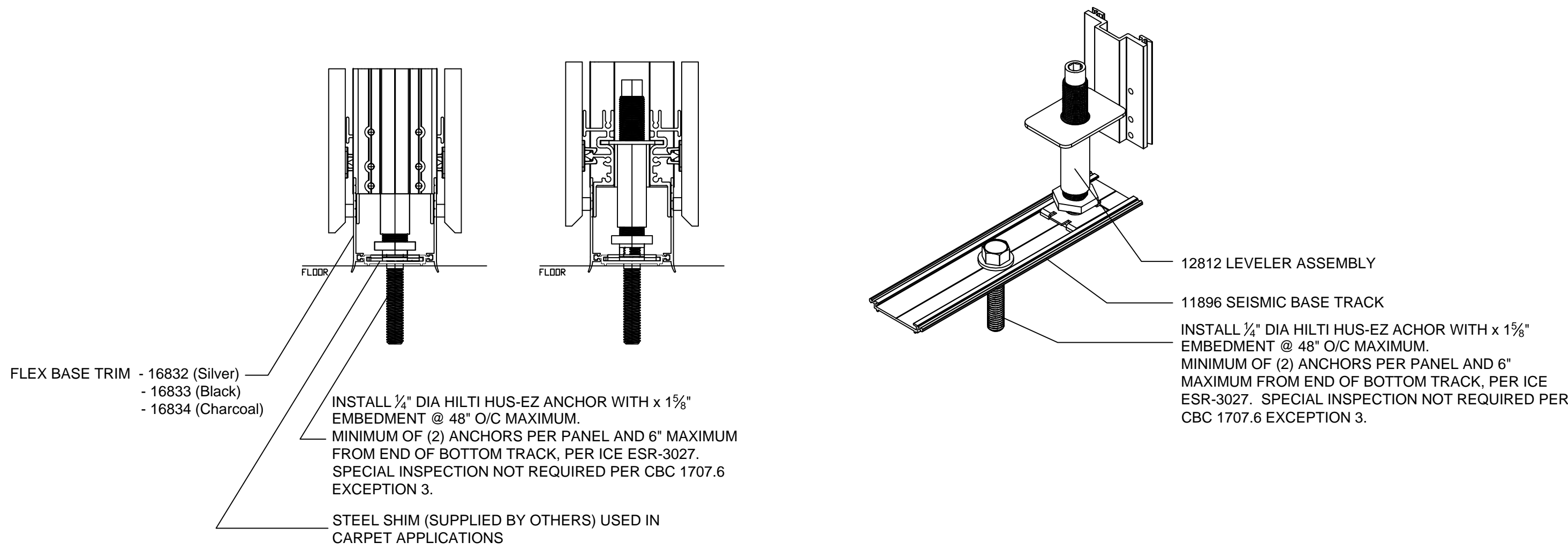

SEISMIC DETAIL: SOLID WALL ATTACHMENT AT BASE

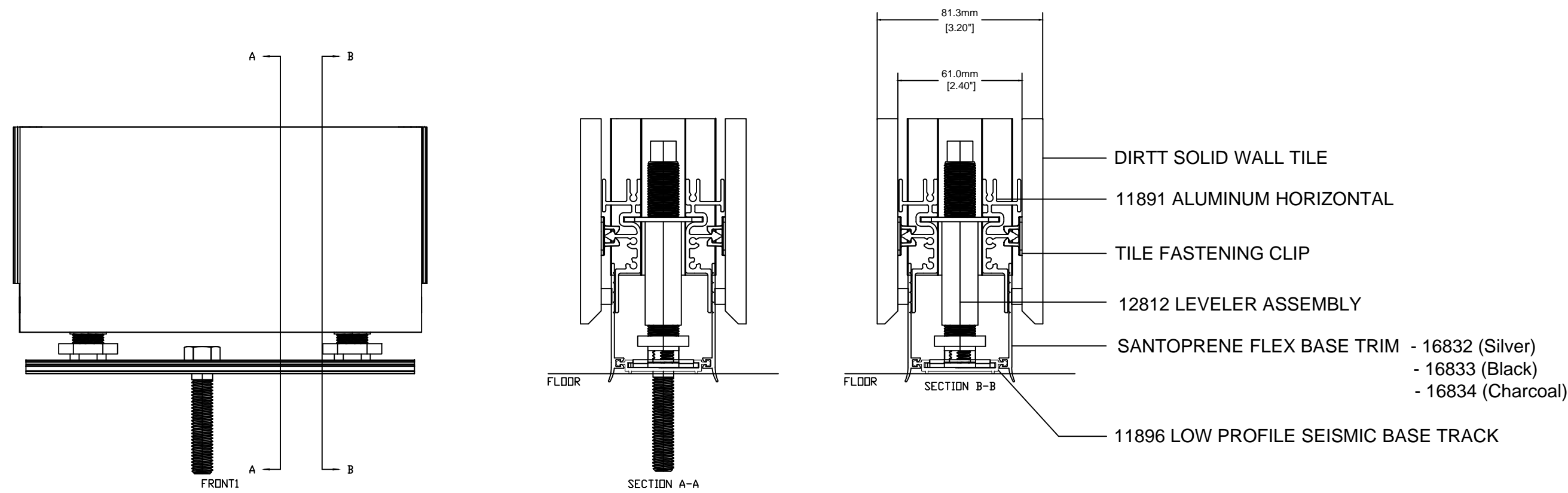

SEISMIC DETAIL - SOLID WALL SECTION

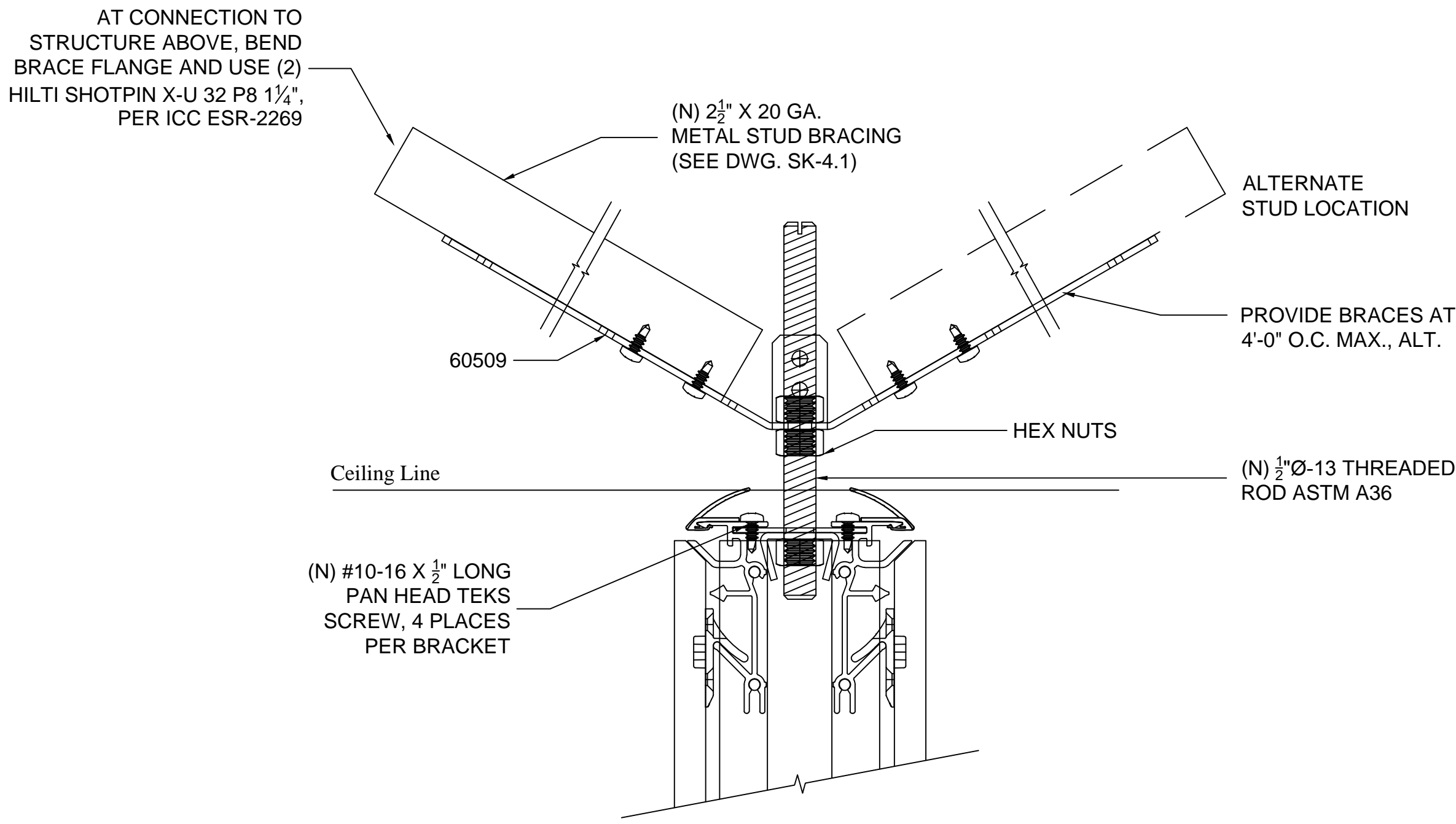

GRID CEILING KICKER CONNECTION TO SOLID WALL

SHEET NOTES

KEY NOTES

SEISMIC REQUIRED

EXTRUSION PROFILE: RECTILINEAR

FRAME FINISH: COM POWDER COAT  
AND VENEER WRAPPED

BASE TRIM FINISH: SILVER SANTOPRENE

PVC/GLASS WIPE: SILVER

CEILING HEIGHT: 9' 6"

CEILING TYPE: GRID

FLOOR TYPE: CARPET

DOORS:  
OFFICES - GOLDIE PIVOT DOORS AND BARN  
DOORS (4" STILE), WITH VENEER WRAPPED  
ALUMINUM- 30" C to C BAR PULL WITH 630  
FINISH.

CONFERENCE ROOMS - FRAMELESS GLASS  
PIVOT DOORS NON-LOCKING- 30" C to C BAR  
PULL WITH 630 FINISH

LEGEND

ELECTRICAL PROVISION  
REQUIRED:

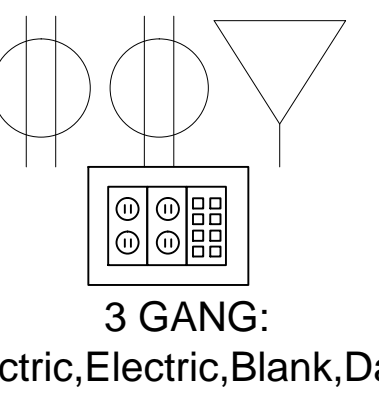
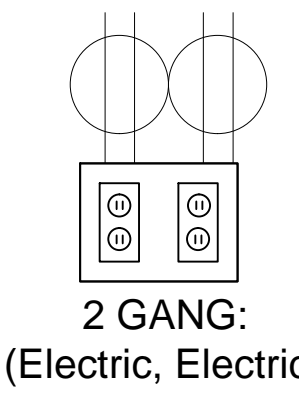
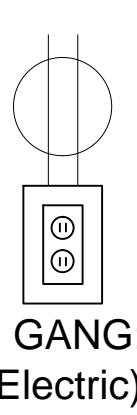
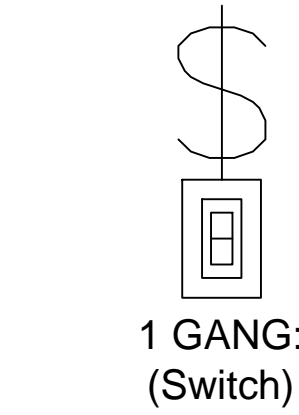

KEY PLAN

N.I.C. - FOR REFERENCE ONLY

65% CD SUBMISSION  
MARCH 16, 2015  
NOT FOR CONSTRUCTION

CONSULTANTS:

ARCHITECT

POLYTECH ASSOCIATES INC.  
235 Pine Street, 17th Floor  
San Francisco, CA 94104  
TEL (415) 397-3117  
FAX (415) 397-1517

Drawing Title  
DIRTT OVERALL PLAN

Approved: Project Director

Project Title  
POST TRAUMATIC STRESS DIAGNOSIS (PTSD)  
EXPANSION & RENOVATION

Location  
795 WILLOW ROAD, MENLO PARK, CA

Date  
07.30.15

Checked  
Author

Drawn  
Checker

Project Number  
640-235003

Building Number  
BUILDING 334 & 360

Drawing Number

334 AI722

Office of  
Construction  
and Facilities  
Management

Department of  
Veterans Affairs



NOTE:  
CAUTION SHOULD BE TAKEN WHEN FASTENING TO POST TENSION  
SLABS OR TO FLOORS CONTAINING RADIANT HEATING. FLOORS MAY  
REQUIRE X-RAY TO ENSURE FASTENERS DO NOT CONFLICT WITH  
CONCEALED STRUCTURAL OR MECHANICAL ELEMENTS. ALL RELATIVE  
COSTS WILL BE PASSED ONTO THE CLIENT (NOT COVERED BY DIRT).

A THOROUGH REVIEW WITH LOCAL AUTHORITIES MAY BE REQUIRED  
TO ESTABLISH AN ACCEPTABLE ALTERNATIVE FASTENING METHOD  
WHICH MEETS BOTH INTERNATIONAL BUILDING CODE AND LOCAL  
REQUIREMENTS BASED ON THE INSTALLATION LOCATION.

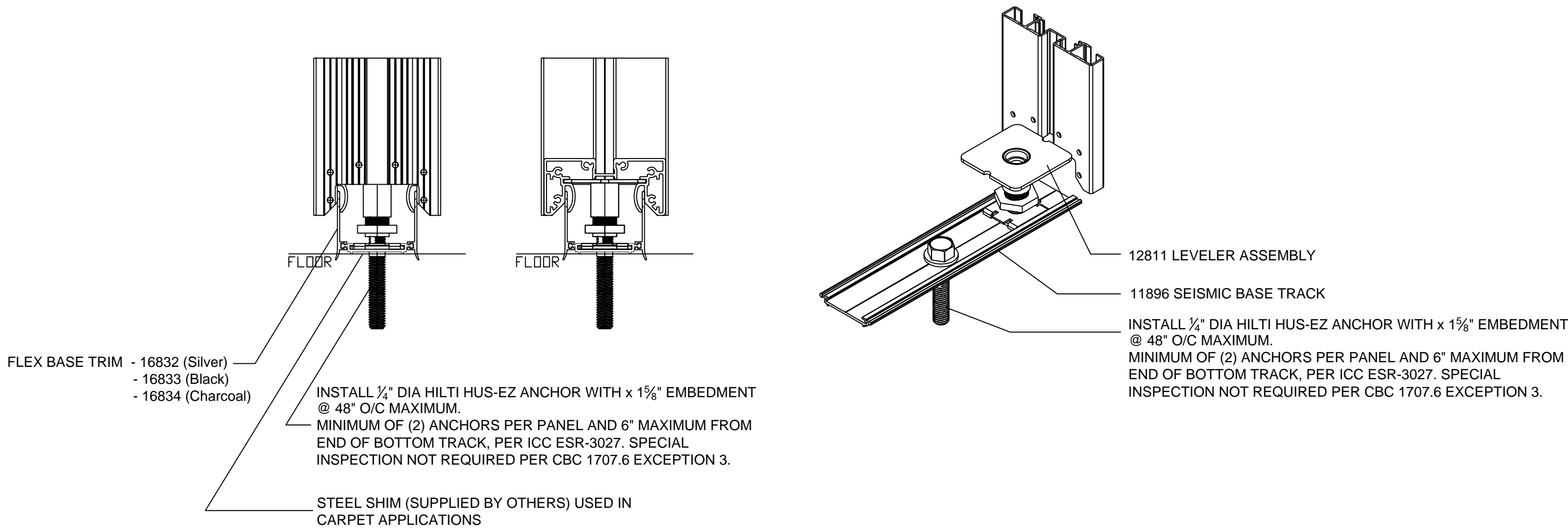

SEISMIC DETAIL: GLASS WALL ATTACHMENT AT BASE

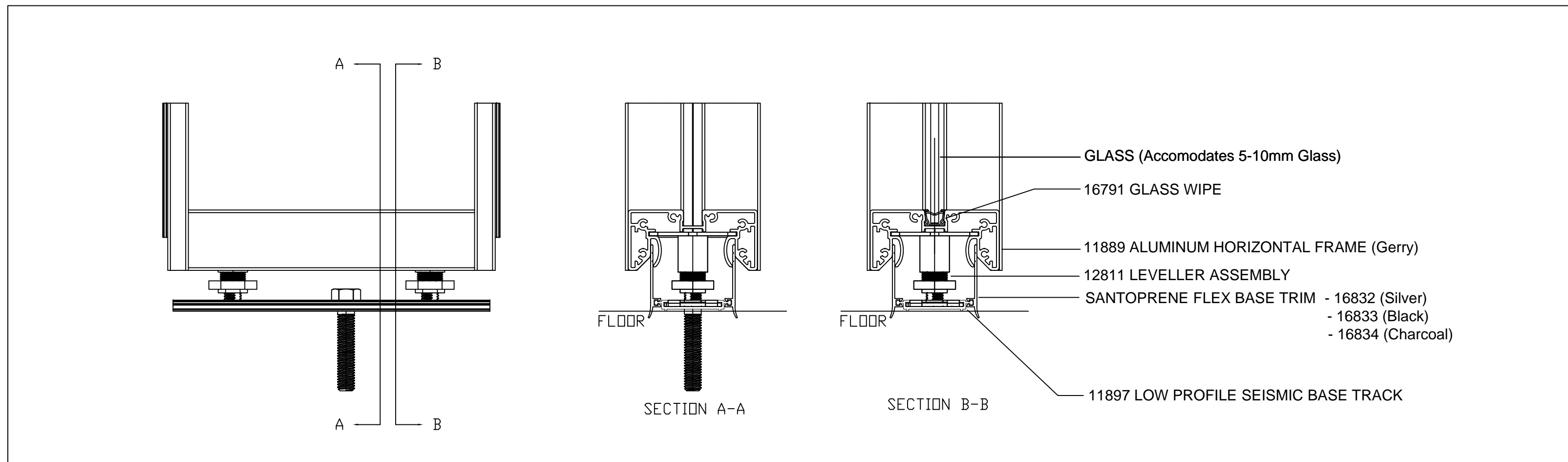

SEISMIC DETAIL - GLASS WALL SECTION

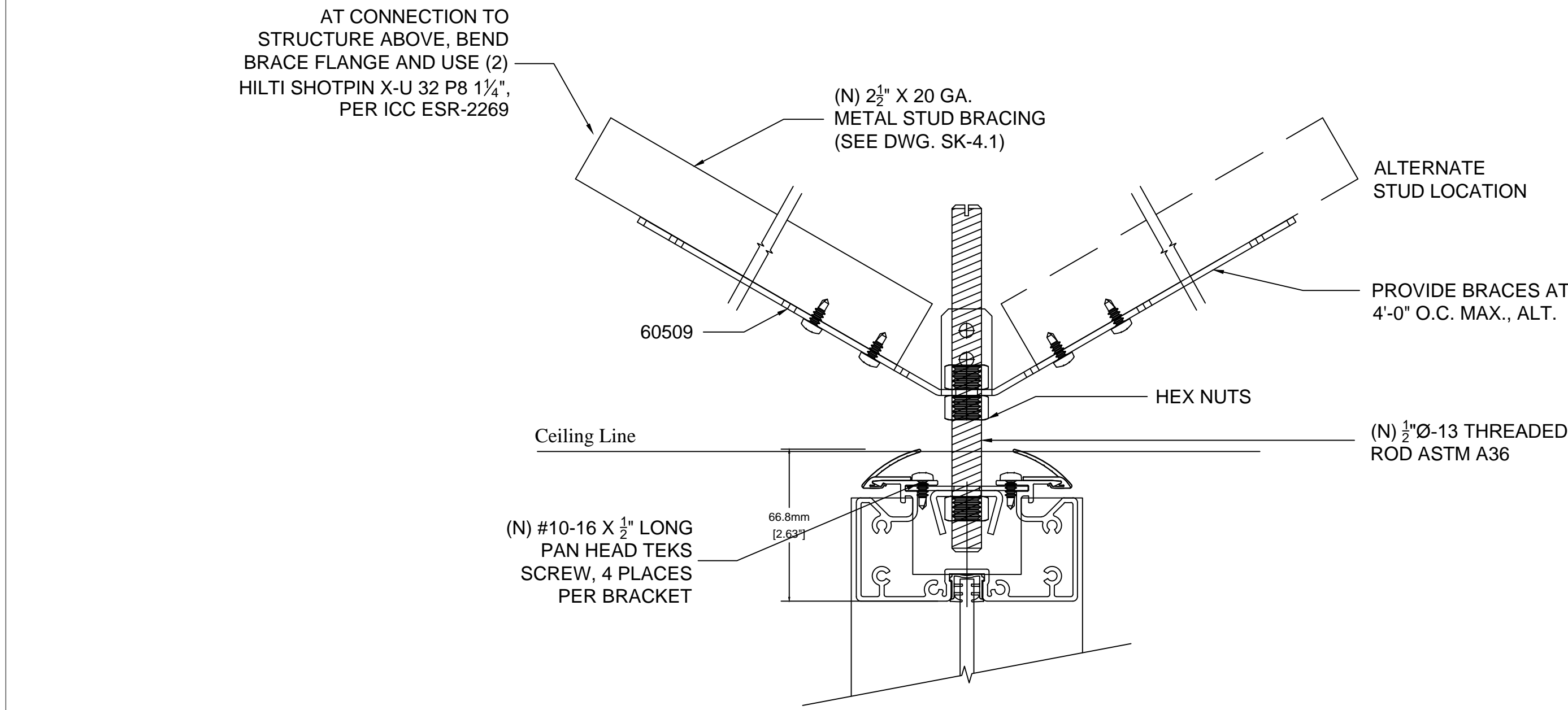

GRID CEILING KICKER CONNECTION TO GLASS WALL

SHEET NOTES

KEY NOTES

- SEISMIC REQUIRED
- EXTRUSION PROFILE: RECTILINEAR
- FRAME FINISH: COM POWDER COAT AND VENEER WRAPPED
- BASE TRIM FINISH: SILVER SANTOPRENE
- PVC/GLASS WIPE: SILVER
- CEILING HEIGHT: 9' 6"
- CEILING TYPE: GRID
- FLOOR TYPE: CARPET
- DOORS:  
OFFICES - GOLDIE PIVOT DOORS AND BARN DOORS (4" STILE), WITH VENEER WRAPPED ALUMINUM- 30" C to C BAR PULL WITH 630 FINISH.
- CONFERENCE ROOMS - FRAMELESS GLASS PIVOT DOORS NON-LOCKING- 30" C to C BAR PULL WITH 630 FINISH

LEGEND

ELECTRICAL PROVISION  
REQUIRED:

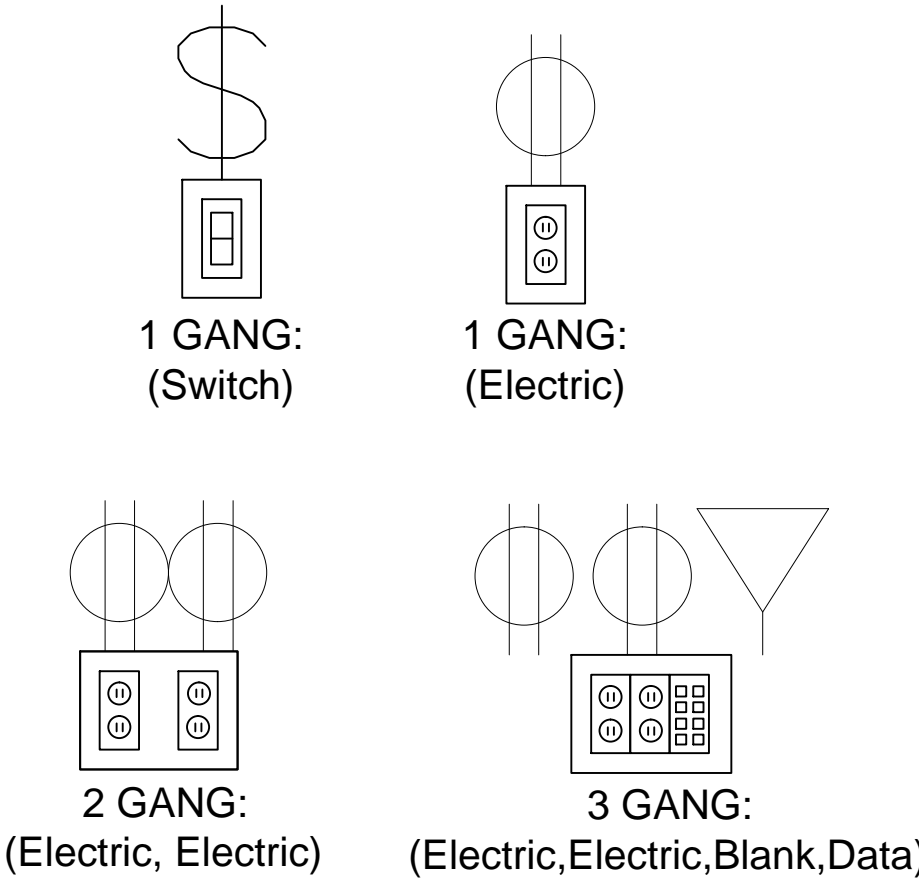

KEY PLAN

N.I.C. - FOR REFERENCE ONLY

65% CD SUBMISSION  
MARCH 16, 2015  
NOT FOR CONSTRUCTION

		CONSULTANTS:		ARCHITECT		<div><div></div><div>POLYTECH ASSOCIATES INC. 235 Pine Street, 17th Floor San Francisco, CA 94104 TEL (415) 397-3117 FAX (415) 397-1517</div></div>		Drawing Title		Project Title		Project Number		Office of Construction and Facilities Management	
								DIRTT OVERALL PLAN		POST TRAUMATIC STRESS DIAGNOSIS (PTSD) EXPANSION & RENOVATION		640-235003			
								Approved: Project Director		Location 795 WILLOW ROAD, MENLO PARK, CA		Building Number			
												BUILDING 334 & 360			
												Drawing Number			
										Date 07.30.15		Checked Author		Drawn Checker	
Revisions:		Date										 Department of Veterans Affairs			



## KEY NOTES

SEISMIC REQUIRED

EXTRUSION PROFILE: RECTILINEAR

FRAME FINISH: COM POWDER COAT  
AND VENEER WRAPPED

BASE TRIM FINISH: SILVER SANTOPRENE

PVC/GLASS WIPE: SILVER

CEILING HEIGHT: 9' 6"

CEILING TYPE: GRID

FLOOR TYPE: CARPET

DOORS:  
OFFICES - GOLDIE PIVOT DOORS AND BARN  
DOORS (4" STILE), WITH VENEER WRAPPED  
ALUMINUM- 30° C to C BAR PULL WITH 630  
FINISH.

CONFERENCE ROOMS - FRAMELESS GLASS  
PIVOT DOORS NON-LOCKING- 30° C to C BAR  
PULL WITH 630 FINISH

ELECTRICAL PROVISION  
REQUIRED:

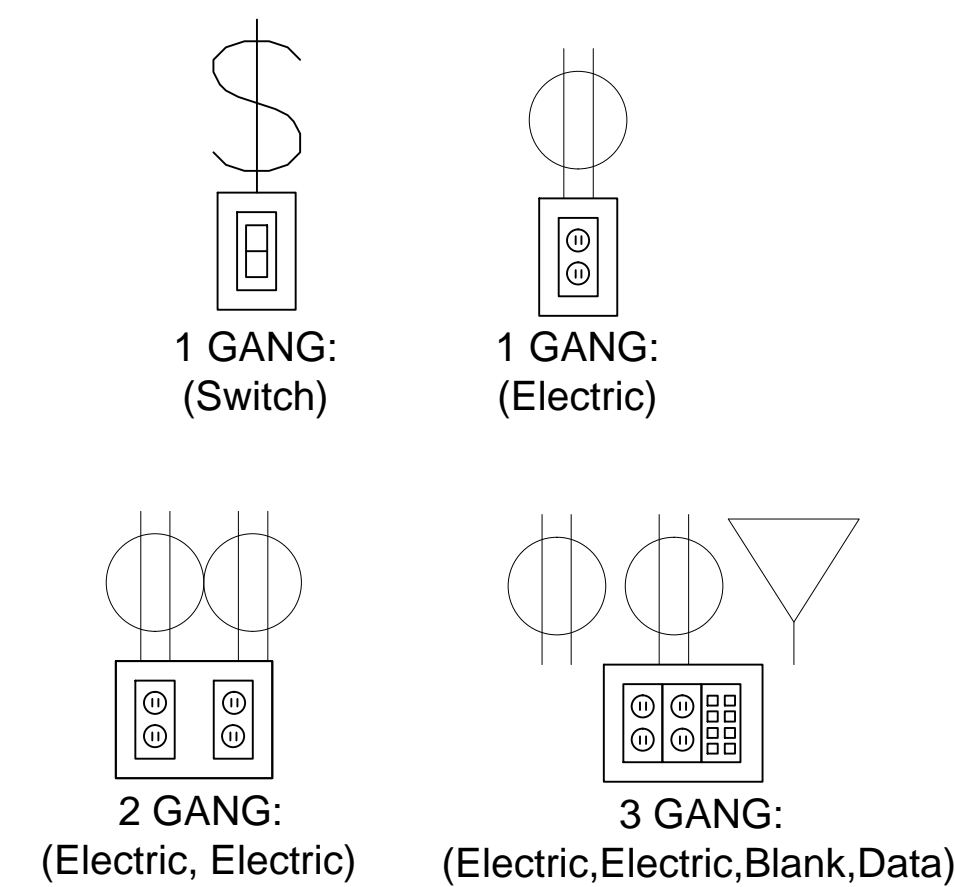

## KEY PLAN

65% CD SUBMISSION  
MARCH 16, 2015  
NOT FOR CONSTRUCTION

**N.I.C. - FOR REFERENCE ONLY**

		CONSULTANTS:		ARCHITECT	Drawing Title DIRTT OVERALL PLAN	Project Title POST TRAUMATIC STRESS DIAGNOSIS (PTSD) EXPANSION & RENOVATION	Project Number 640-Z35003	Office of Construction and Facilities Management		
					POLYTECH ASSOCIATES INC.  235 Pine Street, 17th Floor San Francisco, CA 94104 TEL (415) 397-3117 FAX (415) 397-1517	Approved: Project Director	Location 795 WILLOW ROAD, MENLO PARK, CA		Building Number BUILDING 334 & 360	334 AI724
						Date 07.30.15	Checked Author		Drawn Checker	
										
Revisions:	Date									



