

three inches = one foot  
one and one half inches = one foot  
one inch = one foot  
three quarters inch = one foot  
one half inch = one foot  
three eighths inch = one foot  
one quarter inch = one foot  
one eighth inch = one foot

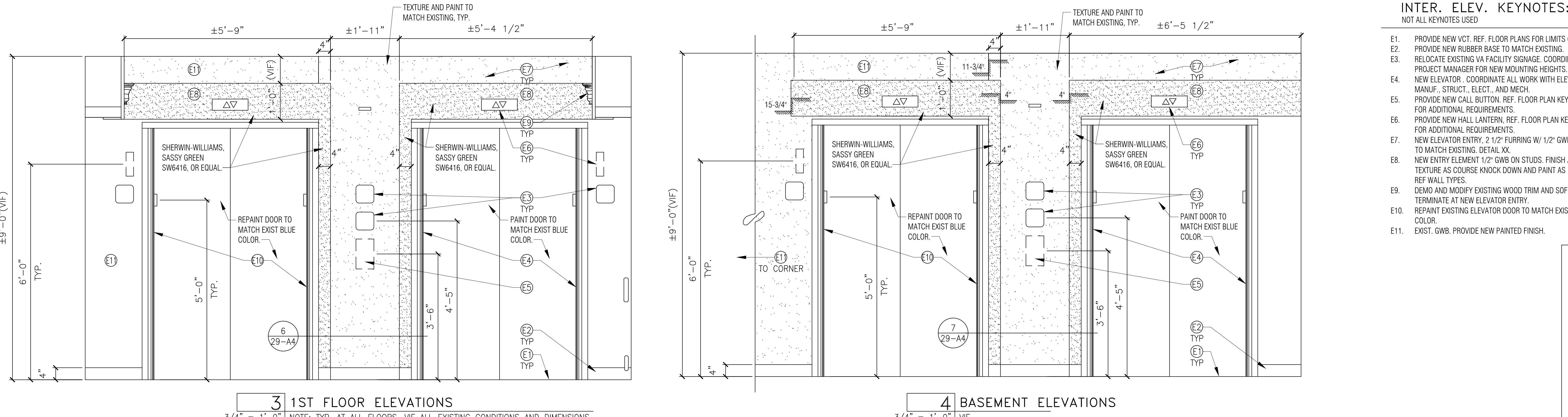
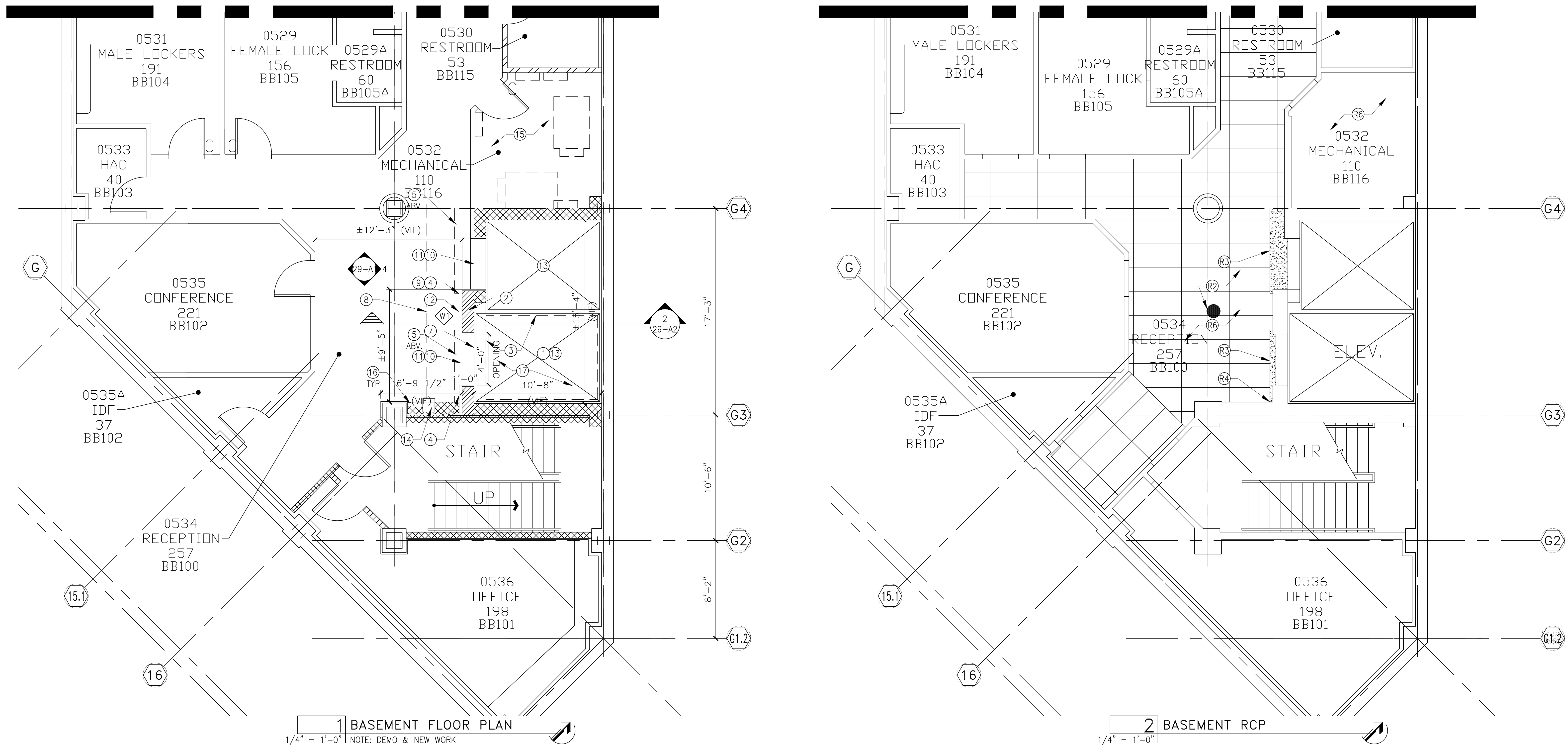

- GENERAL NOTES:**
- COORDINATE ALL WORK W/ MECHANICAL & ELECTRICAL PLANS FOR ADDITIONAL REQUIREMENTS.
  - VERIFY ALL CONDITIONS PRIOR TO START OF WORK.
  - DEMOLITION AND NEW CONSTRUCTION SHALL BE COORDINATED WITH MEDICAL FACILITY TO MINIMIZE DISRUPTION DURING NEW WORK.
  - PATCHING AND REPLACEMENT OF EXISTING FINISHES SHALL BE OF EQUAL OR GREATER VALUE, MATCHED TO EXISTING COLORS AND TEXTURES.
  - EXISTING ELEVATOR SHAFT WALLS & WALLS OF EQUIPMENT ROOM ARE FIRE RATED. ANY PENETRATIONS THROUGH WALL OR FACE OF WALL SHALL BE FIRE STOPPED TO MAINTAIN RATING (2 HR.).
  - REF. WALL LEGEND, SHEET 29-A4.
- FLOOR PLAN KEYNOTES:**  
NOT ALL KEYNOTES USED THIS SHEET
- PROVIDE NEW ELEVATOR, SCHINDLER 330A HOLESSE HYDRAULIC. HOSPITAL/SERVICE OR EQUAL. COORDINATE ALL WORK WITH ELEC., STRUC. AND ELEVATOR MANUF.
  - PROVIDE NEW CONC. ELEVATOR SHAFT WALL (2HR RATED). REF. STRUCTURAL DOCUMENTS FOR ADDITIONAL REQUIREMENTS.
  - DEMO EXISTING WALL AND SLAB/STRUCTURE, AS REQUIRED TO ENLARGE EXISTING ELEVATOR SHAFT & TO LOWER PIT FLOOR. REF. STRUCT. FOR ADDITIONAL REQUIREMENTS. DEMO EXIST CONC. PER SOLUTION 2.
  - PROVIDE NEW CONC. WALL WITH 2 1/2" MTL STUD FURRING W/ 5/8" GWB. NEW ELEVATOR ENTRY, 5/8" GWB ON HC STUDS AND 2X4 FURRING. TEXTURE AND PAINT AS SPECIFIED. REF. INTERIOR ELEVATIONS FOR LIMITS.
  - REPLACE DOOR & TRACK OF EXISTING ELEVATOR. COORD. ALL WORK WITH ELEVATOR MANUF.
  - SAW CUT EXIST CONC./STEEL DECK FLOOR SLAB AS REQ'D FOR NEW WORK. REF. STRUCT. FOR NEW WORK. PROVIDE NEW STEEL ANGLE EDGE, & PATCH ANY GAPS BETWEEN CONC. & ANGLE FLUSH W/ FINISH FLOOR.
  - REMOVE EXIST. VCT & MASTIC TO BARE CONC. REMOVE TILES TO NEAREST FULL TILE. PROVIDE NEW TILE TO MATCH EXIST. SEE FLOOR PATTERN 3/29-A2.
  - PROVIDE NEW BASE TO MATCH EXISTING.
  - PROVIDE NEW HALL LANTERN (LED), CENTERLINE MOUNTED AT 72" A.F.F. MIN. VISUAL ELEMENTS SHALL BE AT LEAST 2-1/2" IN THE SMALLEST DIMENSION. NEW HALL LANTERN SHALL INCORPORATE AUDIBLE SIGNAL AND SHALL SOUND ONCE FOR UP AND TWICE FOR DOWN, OR SHALL HAVE VERBAL ENUNCIATORS THAT SAY "UP" OR "DOWN". COORDINATE HALL LANTERN WITH ELEC. DOCUMENTS.
  - EXISTING/NEW RAISED AND BRAILLE CHARACTER SIGNAGE TO BE SALVAGED BUT MUST MEET FOLLOWING REQUIREMENTS. REPLACE AS NECESSARY TO COMPLY:  
A. ALL HOISWAY ENTRANCES SHALL HAVE BRAILLE-SIGNAGE FLOOR DESIGNATIONS PROVIDED BOTH JAMS.  
B. CENTERLINE OF CHARACTERS SHALL BE MOUNTED AT 60" A.F.F., 2" CHARACTERS.
  - PROVIDE NEW CALL BUTTON. CENTERLINE MOUNTED AT 42" A.F.F. CALL BUTTON SHALL HAVE VISUAL SIGNALS. MIN. 3/4" IN THE SMALLEST DIMENSION.
  - INSTALL NEW ENERGY EFFICIENT LIGHTING WITHIN EXISTING ELEVATOR CAB. COORDINATE WORK WITH ELEVATOR MANUF. REF. ELECTRICAL DOCUMENTS FOR ADDITIONAL REQUIREMENTS. REMOVE AND SALVAGE EXIST. T-12 LIGHTING TO VA FACILITY.
  - RELOCATE FIRE EXTINGUISHER AND F.E. CABINET. COORDINATE WORK WITH EXISTING FIRE ALARMS AND SPRINKLERS WERE NECESSARY. DEMO AND PATCH WALL AS REQ'D FOR WORK.
  - PROVIDE NEW MECHANICAL FOR NEW ELEVATOR. COORDINATE WORK AND REQUIREMENTS WITH ELEVATOR MANUF., ELEC., AND MECH. RELOCATE ANY EXISTING EQUIPMENT AS NEEDED FOR NEW WORK.
  - EXISTING WALL RAIL AND GUARDS. MODIFY FOR NEW WORK. EXISTING HEIGHTS TO REMAIN.
  - RELOCATE EXIST CONDUIT & PIPING AS REQ'D FOR NEW WORK.

- RCP KEYNOTES:**  
NOT ALL KEYNOTES USED
- REMOVE AND SALVAGE CEILING WOOD FOR REUSE. REINSTALL AS REQUIRED TO FIT NEW LAYOUT. REPLACE DAMAGED WOOD FROM CONSTRUCTION. ANY REMAINING WOOD TO BE SALVAGED TO FACILITY MNGT.
  - MODIFY ELEC., HVAC, PLUMB, SPECIAL SYSTEM, FIRE SPRINKLERS ETC. ABOVE CEILING SPACE AS REQUIRED FOR NEW WORK.
  - NEW ELEVATOR ENTRY ELEMENT BELOW, 1/2" GWB ON STUD. TEXTURE WITH COURSE KNOCK DOWN FINISH AND PAINT AS SPECIFIED. REF. INTERIOR ELEVATIONS FOR LIMITS OF NEW ENTRY.
  - REMOVE AND SALVAGE WOOD TRIM AND SOFFIT TO FACILITY.
  - EXISTING WOOD SOFFIT TO TERMINATE AT NEW ELEVATOR ENTRY ELEMENT. RELOCATE GLOWE LIGHTING AS REQUIRED TO ALLOW FOR NEW OPENING.
  - COORD. ALL FIRE ALARM WORK WITH ELEC., MECH., AND ELEVATOR MANUF.
  - EXIST SUSPENDED GRID CLG TO REMAIN. MODIFY AS REQUIRED FOR NEW WORK.

- INTER. ELEV. KEYNOTES:**  
NOT ALL KEYNOTES USED
- PROVIDE NEW VCT. REF. FLOOR PLANS FOR LIMITS OF WORK.
  - PROVIDE NEW RUBBER BASE TO MATCH EXISTING.
  - RELOCATE EXISTING VA FACILITY SIGNAGE. COORDINATE WITH PROJECT MANAGER FOR NEW MOUNTING HEIGHTS.
  - NEW ELEVATOR. COORDINATE ALL WORK WITH ELEVATOR MANUF., STRUCT., ELEC., AND MECH.
  - PROVIDE NEW CALL BUTTON. REF. FLOOR PLAN KEYNOTE 12 FOR ADDITIONAL REQUIREMENTS.
  - NEW ELEVATOR ENTRY. 2 1/2" FURRING W/ 1/2" GWB. FINISH TO MATCH EXISTING. DETAIL XX.
  - NEW ENTRY ELEMENT 1/2" GWB ON STUDS. FINISH AND TEXTURE AS COURSE KNOCK DOWN AND PAINT AS NOTED. REF. WALL TYPES.
  - DEMO AND MODIFY EXISTING WOOD TRIM AND SOFFIT, TERMINATE AT NEW ELEVATOR ENTRY.
  - REPAINT EXISTING ELEVATOR DOOR TO MATCH EXIST PAINT COLOR.
  - EXIST. GWB. PROVIDE NEW PAINTED FINISH.

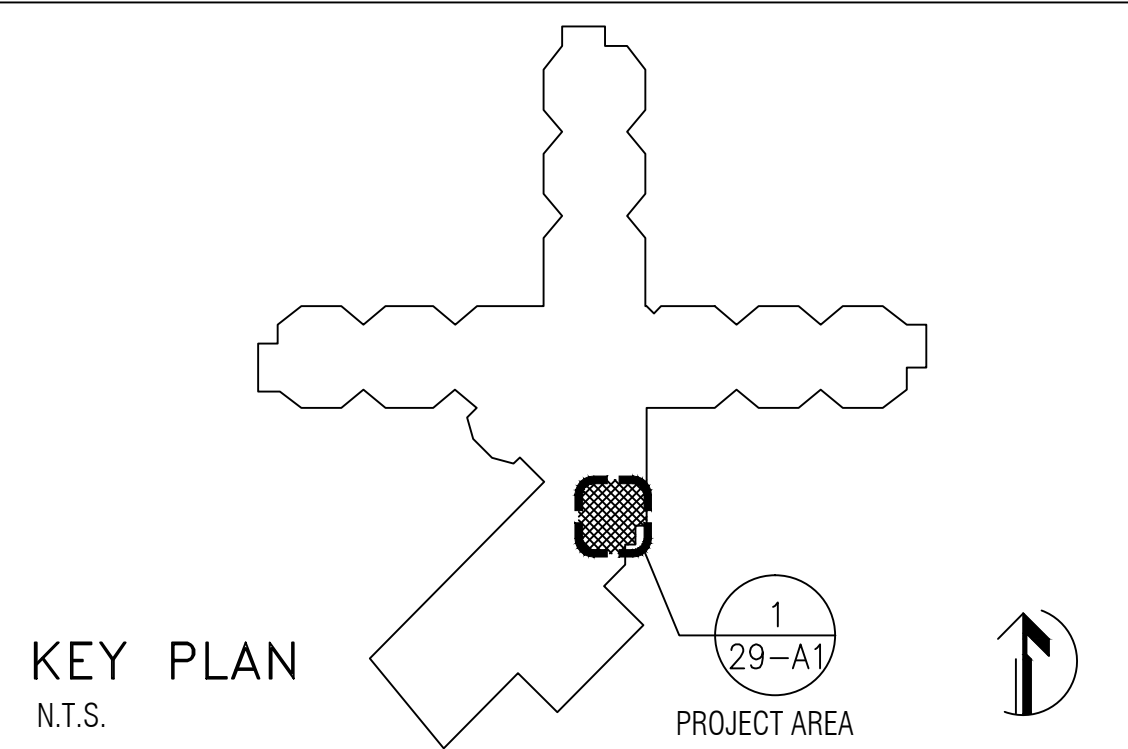

<b>CONSULTANTS:</b>			<b>ARCHITECT/ENGINEERS:</b>		<b>Drawing Title</b> BASEMENT-FLOOR-PLAN		<b>Project Title</b> ELEVATOR REPAIRS AND UPGRADES, BUILDINGS 29		<b>Project Number</b> VA 504-11-105 <b>Building Number</b> 29		<b>Office of Construction and Facilities Management</b> 
					Approved: CHIEF ENGINEERING Approved: ASSOCIATE DIRECTOR Approved: FACILITY DIRECTOR		Location VAMC - THOMAS E. CREEK Date 2.18.10 Checked KI Drawn BM		<b>Drawing Number</b> 29-A1 Dwg. of 8		
<b>Revisions:</b>		<b>SBBL Architecture + Planning</b> 1001 North Alvernon Way #105, Tucson, Arizona 85711 e: sbbl@sbbl.biz									