

three inches = one foot  
one and one half inches = one foot  
one inch = one foot  
one inch = one foot  
three quarters inch = one foot  
one half inch = one foot  
three eighths inch = one foot  
one quarter inch = one foot  
one eighth inch = one foot

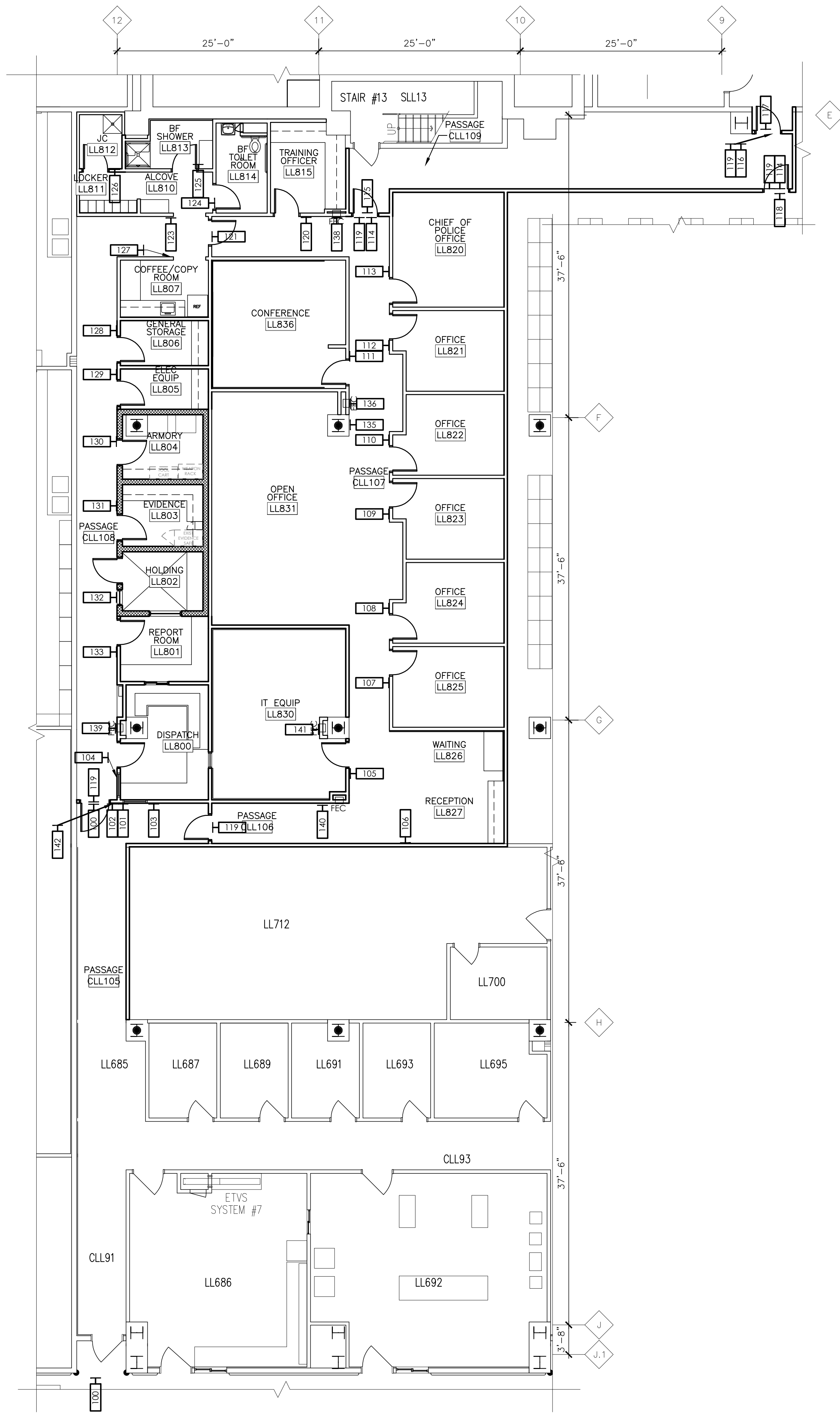

NORTH  
POLICE SERVICES --  
SIGNAGE PLAN  
1/8" = 1'-0"

|                                     |          |
|-------------------------------------|----------|
| ISSUE 006 - CD BID                  | 01.20.11 |
| ISSUE 005 - CD OWNER REVIEW         | 12.17.10 |
| ISSUE 004 DESIGN DEVELOPMENT RECORD | 11.12.10 |
| ISSUE 003 DESIGN DEVELOPMENT REVIEW | 09.08.10 |
| Revisions:                          | Date     |

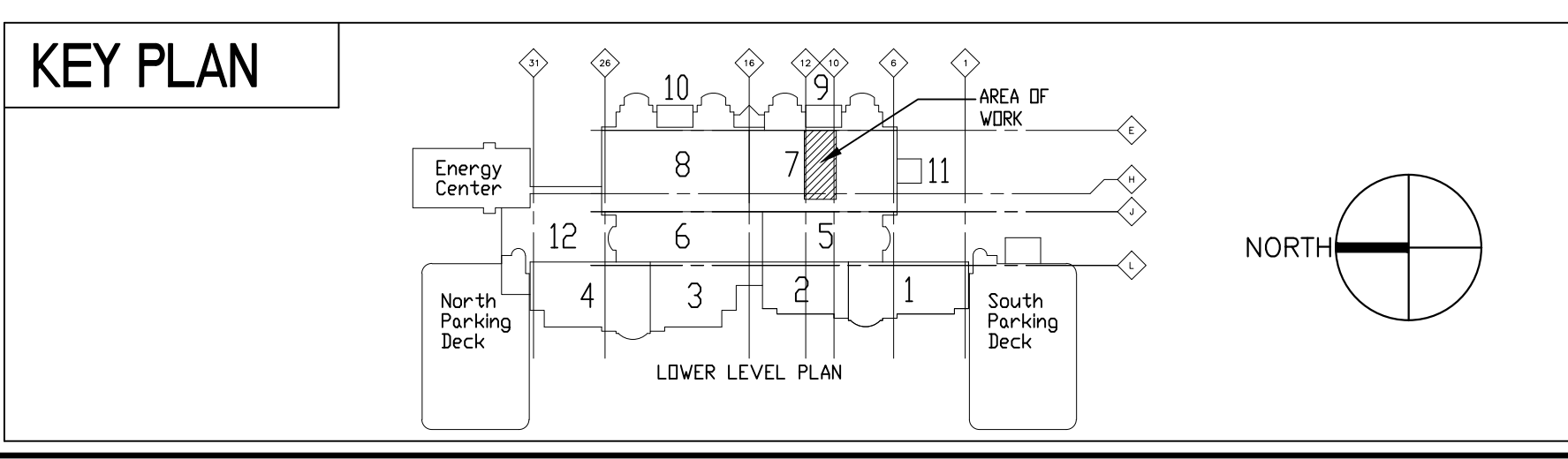

US DEPARTMENT OF  
VETERANS AFFAIRS  
JOHN D. DINGELL  
VA MEDICAL CENTER  
4646 JOHN R. STREET  
DETROIT, MI 48202

ARCHITECT/ENGINEERS:

**Kahn**

Albert Kahn Associates, Inc.  
Albert Kahn Building  
7430 Second Ave.  
Detroit, Michigan 48202-2798  
Albert Kahn Associates, Inc. is a member of  
the Albert Kahn Family of Companies. © 2007  
ALBERT KAHN JOB # 0398-00000

Drawing Title  
**ENLARGED SIGNAGE PLAN AND  
SIGNAGE SCHEDULE**

Approved Project Director  
K. JAPOWICZ

Project Title  
**POLICE SERVICES RELOCATION**

Location  
**DETROIT, MICHIGAN**

Date  
01-20-2011

Checked  
EAM

Drawn  
CAT

Project Number  
**553-11-108**

Building Number  
**100**

Drawing Number  
**IG-400**  
Dwg. 16 of 50

Office of  
Construction  
and Facilities  
Management

Department of  
Veterans Affairs

## INTERIOR MESSAGE SCHEDULE

### RELOCATION OF POLICE SERVICE TO LOWER LEVEL

| FLOOR | LOCATION | SIGN TYPE            | SIGN TEXT  | SIDE | QUANTITY | LAYOUT/<br>SYMBOL                          | NOTES                       | GLASS<br>BACKER | REVISED<br>DATE |
|-------|----------|----------------------|--|------|----------|--|-----------------------------|-----------------|-----------------|
| LL    | 100      | IN-15.09-12          | (Up Arrow Symbol) VA Police Services   |      | 2        | UP ARROW                                   |                             |                 |                 |
| LL    | 101      | IN-02.04             | Business Hours (TBD)   |      | 1        |  |                             |                 |                 |
| LL    | 102      | IN-08.02             | (Do Not Enter Symbol) Authorized Personnel Only  |      | 1        | DO NOT ENTER                               | MOUNT TO DOOR               |                 |                 |
| LL    | 103      | IN-14.05             | (Right Arrow Symbol) Receptionist<br>Check In  |      | 1        | RIGHT ARROW                                | WALL<br>DIRECTIONAL<br>SIGN |                 |                 |
| LL    | 104      | IN-03.01<br>IN-04.02 | LL800 (Braille)<br>Dispatch  |      | 1        |  |                             | YES             |                 |
| LL    | 105      | IN-03.01             | LL830 (Braille)  |      | 1        |  |                             |                 |                 |
| LL    | 106      | IN-12.01             | Check In   |      | 1        |  | FREESTANDING<br>ON DESK     |                 |                 |
| LL    | 107      | IN-03.01<br>IN-04.02 | LL825 (Braille)<br>Office  |      | 1        |  |                             |                 |                 |
| LL    | 108      | IN-03.01<br>IN-04.02 | LL824 (Braille)<br>Office  |      | 1        |  |                             |                 |                 |
| LL    | 109      | IN-03.01<br>IN-04.02 | LL823 (Braille)<br>Office  |      | 1        |  |                             |                 |                 |
| LL    | 110      | IN-03.01<br>IN-04.02 | LL822 (Braille)<br>Office  |      | 1        |  |                             |                 |                 |
| LL    | 111      | IN-03.01<br>IN-04.02 | LL836 (Braille)<br>Conference  |      | 1        |  |                             |                 |                 |
| LL    | 112      | IN-03.01<br>IN-04.02 | LL821 (Braille)<br>Office  |      | 1        |  |                             |                 |                 |
| LL    | 113      | IN-03.01<br>IN-04.02 | LL820 (Braille)<br>Chief of Police   |      | 1        |  |                             |                 |                 |
| LL    | 114      | IN-01.05             | Fire Door<br>Keep Closed<br>at all times   |      | 2        |  | MOUNT TO DOOR               |                 |                 |
| LL    | 115      | IN-01.05             | Fire Door<br>Keep Closed<br>at all times   |      | 1        |  | MOUNT TO DOOR               |                 |                 |
| LL    | 116      | IN-01.05             | Fire Door<br>Keep Closed<br>at all times   |      | 1        |  | MOUNT TO DOOR               |                 |                 |
| LL    | 117      | IN-01.05             | Fire Door<br>Keep Closed<br>at all times   |      | 1        |  | MOUNT TO DOOR               |                 |                 |
| LL    | 118      | IN-01.05             | Fire Door<br>Keep Closed<br>at all times   |      | 1        |  | MOUNT TO DOOR               |                 |                 |
| LL    | 119      | IN-01.05             | EXIT (Braille)   |      | 5        |  | MOUNT TO DOOR               |                 |                 |
| LL    | 120      | IN-03.01<br>IN-04.02 | LL815 (Braille)<br>Training Officer  |      | 1        |  |                             |                 |                 |
| LL    | 121      | IN-08.02             | (Do Not Enter Symbol)<br>Authorized Personnel Only   |      | 1        | DO NOT ENTER                               | MOUNT TO DOOR               |                 |                 |
| LL    | 123      | IN-03.01<br>IN-04.02 | LL811 (Braille)<br>Locker Room   |      | 1        |  |                             |                 |                 |
| LL    | 124      | IN-09.06             | (Symbol) (Symbol)<br>RESTROOM (Braille)  |      | 1        | UNISEX,<br>BARRIER FREE                    | MOUNT TO DOOR               |                 |                 |
| LL    | 125      | IN-09.06             | (Symbol) (Symbol)<br>SHOWER (Braille)  |      | 1        | UNISEX,<br>BARRIER FREE                    | MOUNT TO DOOR               |                 |                 |
| LL    | 126      | IN-03.01             | LL812 (Braille)  |      | 1        |  |                             |                 |                 |
| LL    | 127      | IN-03.01<br>IN-04.02 | LL807 (Braille)<br>Coffee/Copy Room  |      | 1        |  |                             |                 |                 |
| LL    | 128      | IN-03.01<br>IN-04.02 | LL806 (Braille)<br>General Storage   |      | 1        |  |                             |                 |                 |
| LL    | 129      | IN-03.01<br>IN-04.02 | LL805 (Braille)  |      | 1        |  |                             |                 |                 |
| LL    | 130      | IN-03.01<br>IN-04.02 | LL804 (Braille)<br>Armory  |      | 1        |  |                             |                 |                 |
| LL    | 131      | IN-03.01<br>IN-04.02 | LL803 (Braille)<br>Evidence  |      | 1        |  |                             |                 |                 |
| LL    | 132      | IN-03.01<br>IN-04.02 | LL802 (Braille)<br>Holding   |      | 1        |  |                             |                 |                 |
| LL    | 133      | IN-03.01<br>IN-04.02 | LL801 (Braille)<br>Report Room   |      | 1        |  |                             |                 |                 |
| LL    | 135      | IN-03.01<br>IN-04.02 | LL831 (Braille)<br>Open Office   |      | 1        |  |                             |                 |                 |
| LL    | 136      | IN-01.31             | (Symbol)<br>Fire Equipment   | A    | 1        | FIRE EQUIPMENT<br>IDENTIFICATION<br>SYMBOL |                             |                 |                 |
| LL    | 138      | IN-01.31             | (Symbol)<br>Fire Equipment   | A    | 1        | FIRE EQUIPMENT<br>IDENTIFICATION<br>SYMBOL |                             |                 |                 |
| LL    | 139      | IN-01.31             | (Symbol)<br>Fire Equipment   | A    | 1        | FIRE EQUIPMENT<br>IDENTIFICATION<br>SYMBOL |                             |                 |                 |
| LL    | 140      | IN-01.31             | (Symbol)<br>Fire Equipment   | A    | 1        | FIRE EQUIPMENT<br>IDENTIFICATION<br>SYMBOL |                             |                 |                 |
| LL    | 141      | IN-01.31             | (Symbol)<br>Fire Equipment   | A    | 1        | FIRE EQUIPMENT<br>IDENTIFICATION<br>SYMBOL |                             |                 |                 |
| LL    | 142      | IN-02.01             | Introduction of weapons, unauthorized drugs and alcoholic<br>beverages on this property is prohibited (Title 18 USC Section 930<br>and Title 38 CFR Section 1.218) Persons entering this property<br>consent to an inspection of all packages, luggage and containers in<br>their possession when arriving. Refusal of content to search is<br>basis for denial of admittance. Violators are subject to arrest and<br>prosecution. Refusal of consent to an authorized search by<br>medical personnel is basis for discharge.  |      |          |  |                             |                 |                 |
| LL    | 142      | IN-02.02             | (Symbol)<br>No Smoking<br>For the sake of your health & comfort of others, smoking is prohibited<br>in this Medical Center. If you must smoke, please do so only in<br>designated areas.   |      | 1        |  | MANDATORY<br>POLICY SIGNS   |                 |                 |
| LL    | 142      | IN-02.03             | Whoever knowingly possesses or causes the presence of a firearm<br>or other dangerous weapon on the grounds or buildings of this<br>facility, or attempts to do so, is subject to fine or imprisonment of<br>not more than one year, or both. 18 U.S.C. Section 930a. Whoever<br>intends that a firearm or other dangerous weapon be used in the<br>commission of a crime and knowingly possesses or causes the<br>presence of a firearm or other dangerous weapon on the grounds or<br>buildings of this facility, or attempts to do so, is subject to fine or<br>imprisonment of not more than five years, or both. 18 U.S.C. Section<br>930b. |      |          |  |                             |                 |                 |

## GENERAL NOTES

- ALL SIGNAGE MUST COMPLY WITH VA SIGNAGE DESIGN GUIDE. ACCESS  
SIGNAGE DESIGN GUIDE AT: [WWW.CFM.VA.GOV/TIL/SPCLROMTS.ASP](http://WWW.CFM.VA.GOV/TIL/SPCLROMTS.ASP)
- REFER TO POLICE SERVICES SIGNAGE PLAN FOR SIGN LOCATIONS.
- CONFIRM ALL TEXT ON SIGNS WITH CASEY THAYER OF DET VA MEDICAL  
CENTER PRIOR TO PLACING SIGN ORDER.
- SIGN FINISHES: MATCH DETROIT VA SIGN STANDARDS 2/90 SIGN  
SYSTEMS WITH CUSTOM BANANA YELLOW RAILS / TRIM.