

three inches = one foot  
one and one half inches = one foot  
one inch = one foot  
three quarters inch = one foot  
one half inch = one foot  
three eighths inch = one foot  
one quarter inch = one foot  
one eighth inch = one foot

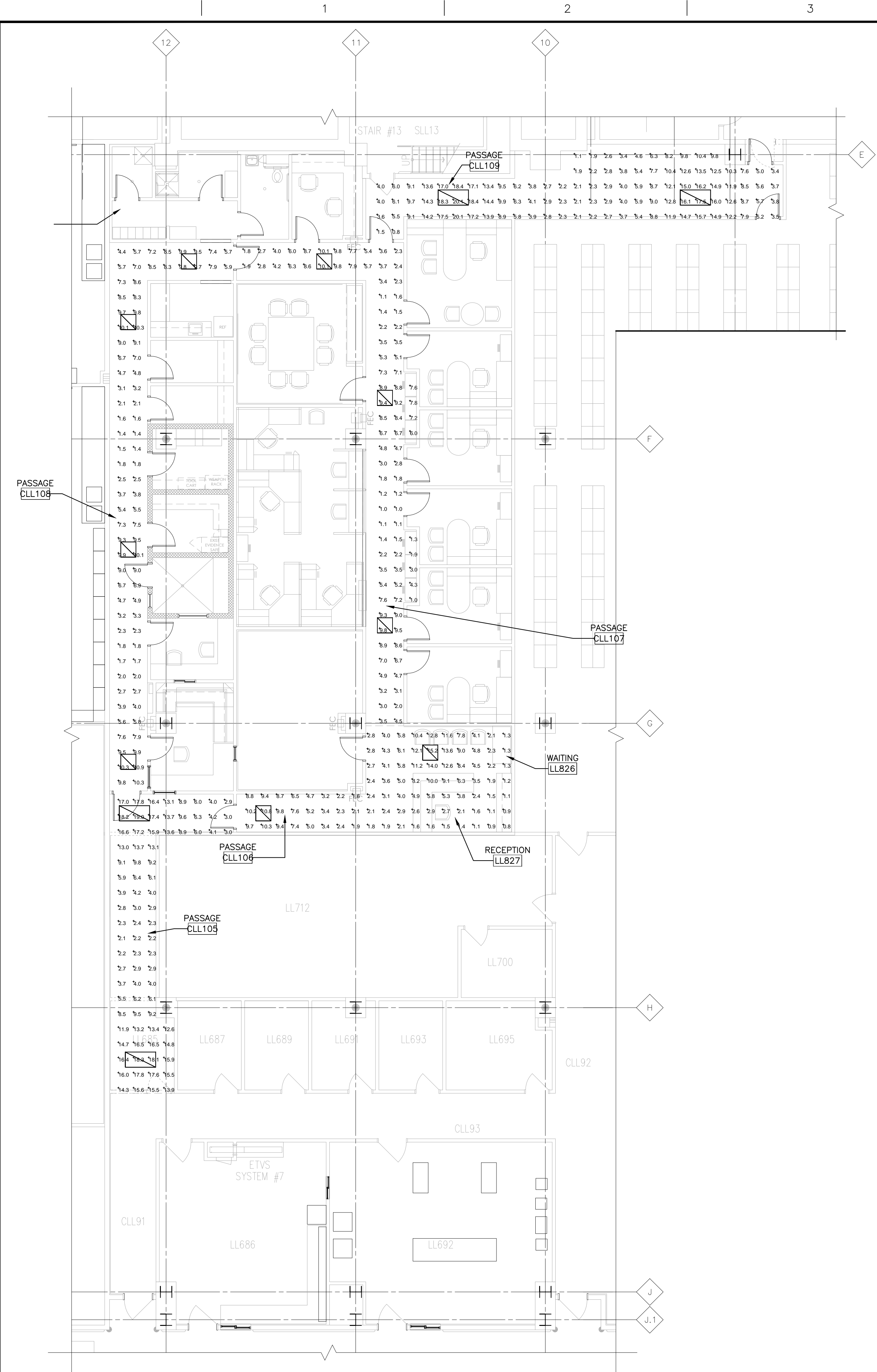

LUMINAIRE SCHEDULE									
Symbol	Label	Qty	Catalog Number	Description	Lamp	File	Lumens	LLF	Watts
	FC1	4	2SP8 2 28 A12125	PREMIUM ENERGY SAVING T8, 2'X4' RECESSED, 2 LAMP, A12125 LENS, ELECTRONIC BALLAST.	TWO 28-WATT LINEAR FLUORESCENT T8, HORIZONTAL POS.	2SP8_2_32_A 12125.rls	2645	0.72	49
	FE1	9	2SP8 2 17 A12 1/4 ADDE	SP8 SPECIFICATION PREMIUM T8 TROFFER 2'X2 2 LP T8 #A12 LENS 1/4 ELEC	TWO 17-WATT T8 LINEAR FLUORESCENT.	2SP8_4_17_A 12_1_4_ADDE.rls	675	0.72	29

STATISTICS						
Description	Symbol	Avg	Max	Min	Max/Min	Avg/Min
PASSAGE CLL105	+	9.5 fc	19.0 fc	2.1 fc	9.0:1	4.5:1
PASSAGE CLL106	+	4.8 fc	10.8 fc	1.6 fc	6.8:1	3.0:1
PASSAGE CLL107	+	4.9 fc	10.1 fc	1.0 fc	10.1:1	4.9:1
PASSAGE CLL108	+	5.9 fc	10.9 fc	1.4 fc	7.8:1	4.2:1
PASSAGE CLL109	+	8.2 fc	20.1 fc	0.8 fc	25.1:1	10.3:1
WAITING/RECEPTION	+	5.1 fc	15.2 fc	0.8 fc	19.0:1	6.4:1

- GENERAL NOTES**
- REFER TO SYMBOLS AND ABBREVIATIONS LIST ON SHEET E-001.
  - REFER TO MOUNTING HEIGHTS, GENERAL, AND ELECTRICAL NOTES ON SHEET E-001.
  - REFER TO SPECIFICATIONS FOR ADDITIONAL ELECTRICAL REQUIREMENTS.
  - REFER TO FIXTURE SCHEDULE ON SHEET EL-400.
- SHEET NOTES**
- LIGHTING CALCULATIONS PERFORMED BY ACUTY LIGHTING GROUP'S (LITHONIA LIGHTING) VISUAL PROFESSIONAL EDITION VERSION 2.6 SOFTWARE.
  - REFER TO LUMINAIRE SCHEDULE ON THIS SHEET FOR FIXTURE MANUFACTURER, CATALOG NUMBER, LUMENS, MOUNTING HEIGHT, AND LIGHT LOSS FACTORS USED TO BASE THESE CALCULATIONS.
  - CALCULATED ILLUMINANCE VALUES ARE SHOWN IN MAINTAINED FOOT CANDLES AND MEASURED AT A WORK PLANE HEIGHT AS INDICATED IN THE SPACE ILLUMINANCE CATEGORIES AND DESIGN GUIDE SCHEDULE SHOWN ON THIS SHEET.
  - THIS LIGHTING LAYOUT REPRESENTS ILLUMINATION LEVELS CALCULATED FROM LABORATORY DATA TAKEN UNDER CONTROLLED CONDITIONS IN ACCORDANCE WITH ILLUMINATING ENGINEERS SOCIETY APPROVED METHODS. ACTUAL PERFORMANCE OF ANY MANUFACTURER'S LUMINAIRE MAY VARY DUE TO VARIATION IN ELECTRICAL VOLTAGE TOLERANCE IN LAMPS, TEMPERATURE, AND OTHER VARIABLE FIELD CONDITIONS.
  - REFER TO FIXTURE SCHEDULE AND NOTES ON SHEET EL601 FOR ADDITIONAL FIXTURE DESCRIPTION AND OPTIONS.

**POLICE SERVICES – EGRESS PHOTOMETRIC CALCULATION PLAN**  
1/8" = 1'-0"

ISSUE 006 - CD BID	01.20.11
ISSUE 005 - CD OWNER REVIEW	12.17.10
ISSUE 004 - DESIGN DEVELOPMENT RECORD	11.12.10
ISSUE 003 - DESIGN DEVELOPMENT REVIEW	09.08.10
Revisions:	Date

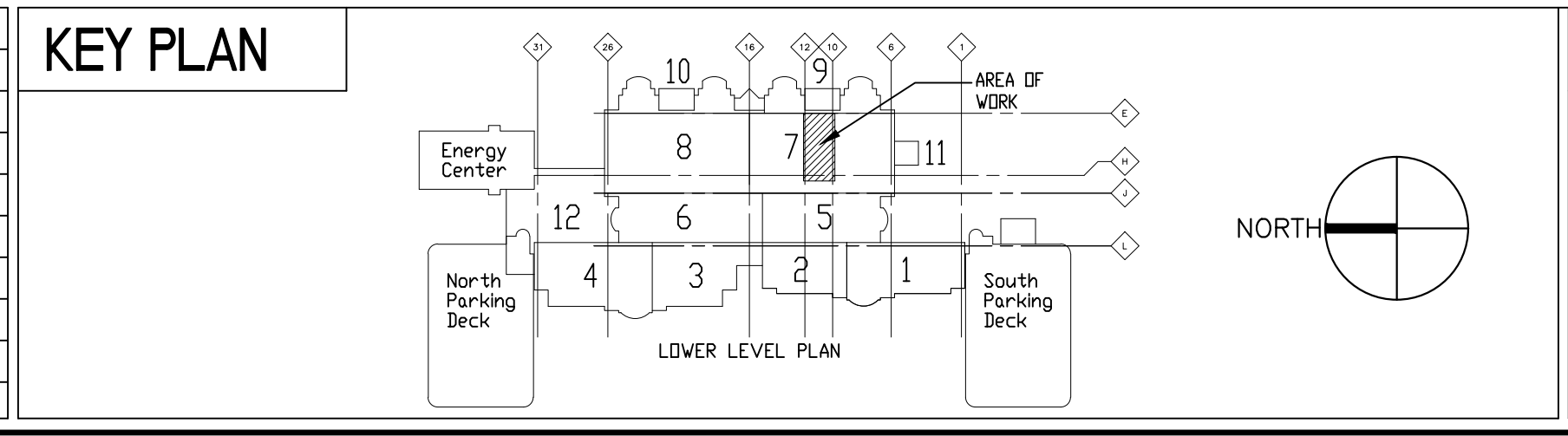

US DEPARTMENT OF VETERANS AFFAIRS  
JOHN D. DINGELL  
VA MEDICAL CENTER  
4646 JOHN R. STREET  
DETROIT, MI 48202

ARCHITECT/ENGINEERS:

**Albert Kahn Associates, Inc.**  
Albert Kahn Building  
7430 Second Ave.  
Detroit, Michigan 48202-2798  
Albert Kahn Associates, Inc. is a member of  
the Albert Kahn Family of Companies. © 2007  
ALBERT KAHN JOB # 03988-00.000

Drawing Title  
**ENLARGED LOWER LEVEL EGRESS  
PHOTOMETRIC CALCULATIONS**

Approved Project Director

Project Title  
**POLICE SERVICES RELOCATION**

Location  
**DETROIT, MICHIGAN**

Date  
01-20-2011

Checked  
-

Drawn  
-

Project Number  
**553-11-108**

Building Number  
**100**

Drawing Number  
**EL-402**  
Dwg. 35 of 50

**Office of  
Construction  
and Facilities  
Management**

Department of  
Veterans Affairs

FULLY SPRINKLERED