

three inches = one foot
one and one half inches = one foot
one inch = one foot
three quarters inch = one foot
one half inch = one foot
three eighths inch = one foot
one quarter inch = one foot
one eighth inch = one foot

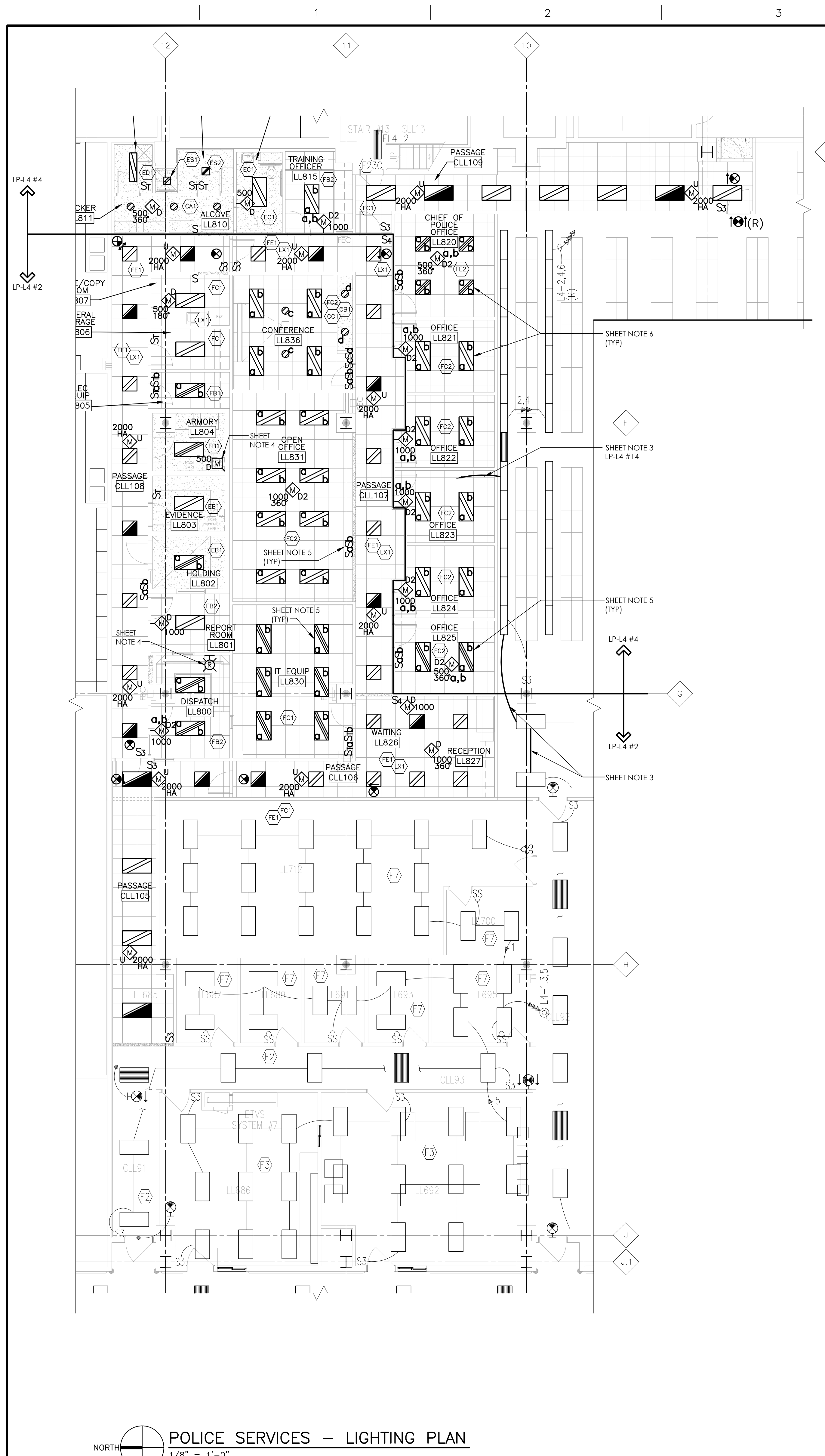

ISSUE 006 - CD BID01.20.11

ISSUE 005 - CD OWNER REVIEW12.17.10

ISSUE 004 - DESIGN DEVELOPMENT RECORD11.12.10

ISSUE 003 - DESIGN DEVELOPMENT REVIEW09.08.10

Revisions

Date

KEY PLAN

Energy Center

North Parking Deck

South Parking Deck

ARC'D VDRK

LOWER LEVEL PLAN

North

US DEPARTMENT OF VETERANS AFFAIRS

JOHN D. DINGELL

VA MEDICAL CENTER

4646 JOHN R. STREET

DETROIT, MI 48202

ARCHITECT/ENGINEERS:

Albert Kahn Associates, Inc.

Albert Kahn Building

7430 Second Avenue

Detroit, Michigan 48202-2798

Albert Kahn Associates, Inc. is a member of the Albert Kahn Family of Companies.

ALBERT KAHN JOB # 0088-00000

© 2007

Drawing Title

ENLARGED LOWER LEVEL LIGHTING PLANS

Approved Project Director

Project Title

POLICE SERVICES RELOCATION

Location

DETROIT, MICHIGAN

Date

01-20-2011

Checked

-

Drawn

-

Project Number

553-11-108

Building Number

100

Drawing Number

EL-400

Dwg. 33 of 50

Office of Construction and Facilities Management

Department of Veterans Affairs

FIXTURE SCHEDULE							
CONTRACTOR FURNISHED AND INSTALLED FIXTURES							
TYPE	VOLTAGE (WATTAGE)	SIZE AND MOUNTING	LAMPS	BALLAST	LENS, REFLECTOR, HOUSING, ETC.	MANUFACTURER	REMARKS
EB1	277V (72W)	2'x4' RECESSED VANDAL RESISTANT FLANGE	3-F28T8 PS	SINGLE OR DUAL ELECTRONIC/ SOLID STATE <10% THD WITH LINE SIDE FUSE (NOTE 2)	.250 INCH THICK HIGH IMPACT POLYCARBONATE LENS WITH 125 INCH THICK PATTERN 12 VIRGIN ACRYLIC PRISMATIC OVERLAY, ALL STEEL CONSTRUCTION, WHITE POWDER COAT ENAMEL FINISH, WHITE ALUMINUM REGRESSED HINGED DOOR FRAME, AND TAMPER-PROOF SCREWS	LITHONIA "2VRT" SERIES, FAL-SAFE "2VRGC" SERIES, DAYBRITE "2DP" SERIES, LIGHTOLIER "MES" SERIES, HUBBELL " " SERIES, COLUMBIA " " SERIES, OR WILLIAMS "EP" SERIES	REFER TO FIXTURE NOTES FOR ADDITIONAL REQUIREMENTS
EC1	277V (49W)	2'x4' RECESSED VANDAL RESISTANT FLANGE	2-F28T8 PS	SINGLE OR DUAL ELECTRONIC/ SOLID STATE <10% THD WITH LINE SIDE FUSE (NOTE 2)	.250 INCH THICK HIGH IMPACT POLYCARBONATE LENS WITH 125 INCH THICK PATTERN 12 VIRGIN ACRYLIC PRISMATIC OVERLAY, ALL STEEL CONSTRUCTION, WHITE POWDER COAT ENAMEL FINISH, WHITE ALUMINUM REGRESSED HINGED DOOR FRAME, AND TAMPER-PROOF SCREWS	LITHONIA "2VRT" SERIES, FAL-SAFE "2VRGC" SERIES, DAYBRITE "2DP" SERIES, LIGHTOLIER "MES" SERIES, HUBBELL " " SERIES, COLUMBIA " " SERIES, OR WILLIAMS "EP" SERIES	REFER TO FIXTURE NOTES FOR ADDITIONAL REQUIREMENTS
ED1	277V (49W)	1'x4' RECESSED VANDAL RESISTANT FLANGE	2-F28T8 PS	SINGLE OR DUAL ELECTRONIC/ SOLID STATE <10% THD WITH LINE SIDE FUSE (NOTE 2)	.250 INCH THICK HIGH IMPACT POLYCARBONATE LENS WITH 125 INCH THICK PATTERN 12 VIRGIN ACRYLIC PRISMATIC OVERLAY, ALL STEEL CONSTRUCTION, WHITE POWDER COAT ENAMEL FINISH, WHITE ALUMINUM REGRESSED HINGED DOOR FRAME, AND TAMPER-PROOF SCREWS	LITHONIA "2VRT" SERIES, FAL-SAFE "2VRGC" SERIES, DAYBRITE "2DP" SERIES, LIGHTOLIER "MES" SERIES, HUBBELL " " SERIES, COLUMBIA " " SERIES, OR WILLIAMS "EP" SERIES	REFER TO FIXTURE NOTES FOR ADDITIONAL REQUIREMENTS
ES1	277V (36W)	12" SQUARE (NOMINAL) RECESSED GASKETED DOWNLIGHT (NOTE 2)	1-32 WATT TRIPLE TUBE PS	SINGLE OR DUAL ELECTRONIC/ SOLID STATE <10% THD WITH LINE SIDE FUSE (NOTE 2)	ALL METAL CONSTRUCTION WITH WHITE ACRYLIC FINISHED HOUSING, WHITE ALUMINUM GROOVELESS FLARE TRIM, MULTI-FACETED SPECULAR ALUMINUM REFLECTOR, AND CLEAR 1/8" FLAT POLYCARBONATE LENS BELOW WITH TEMPERED PRISMATIC FLAT GLASS LENS ABOVE	INFINITY "PHSQ12" SERIES, KURLIN "FRS-09105" SERIES, OR PEACHTREE "PFTX" SERIES	SUITABLE FOR WET LOCATIONS WITH WET LOCATION LABEL, HORIZONTAL LAMP ORIENTATION, REFER TO FIXTURE NOTES FOR ADDITIONAL REQUIREMENTS
ES2	277V (68W)	12" SQUARE (NOMINAL) RECESSED GASKETED DOWNLIGHT (NOTE 2)	2-32 WATT TRIPLE TUBE PS	SINGLE OR DUAL ELECTRONIC/ SOLID STATE <10% THD WITH LINE SIDE FUSE (NOTE 2)	ALL METAL CONSTRUCTION WITH WHITE ACRYLIC FINISHED HOUSING, WHITE ALUMINUM GROOVELESS FLARE TRIM, MULTI-FACETED SPECULAR ALUMINUM REFLECTOR, AND CLEAR 1/8" FLAT POLYCARBONATE LENS BELOW WITH TEMPERED PRISMATIC FLAT GLASS LENS ABOVE	INFINITY "PHSQ12" SERIES, KURLIN "FRS-09105" SERIES, OR PEACHTREE "PFTX" SERIES	SUITABLE FOR WET LOCATIONS WITH WET LOCATION LABEL, HORIZONTAL LAMP ORIENTATION, REFER TO FIXTURE NOTES FOR ADDITIONAL REQUIREMENTS
FB1	277V (72W)	2'x4' RECESSED GRID	3-F28T8 PS	DUAL ELECTRONIC, PROGRAM START, > 98 PF, 88 BF, <10% THD WITH LINE SIDE FUSE (NOTE 2)	.125 INCH THICK PATTERN 12 VIRGIN ACRYLIC PRISMATIC LENS, WITH ALL STEEL CONSTRUCTION, WHITE POWDER COAT ENAMEL FINISH, WHITE ALUMINUM REGRESSED DOOR FRAME, AND POSITIVE CLOSURE LATCHES	LITHONIA "SP8" SERIES, METALUX "GC8" SERIES, DAYBRITE "2SP" SERIES, LIGHTOLIER "SPS" SERIES, COLUMBIA "4PS" SERIES, OR WILLIAMS "50G" SERIES	REFER TO FIXTURE NOTES FOR ADDITIONAL REQUIREMENTS
FB2	277V (72W)	2'x4' RECESSED GRID	3-F28T8 PS	DUAL ELECTRONIC, PROGRAM START, > 98 PF, 88 BF, <10% THD WITH LINE SIDE FUSE (NOTE 2)	5 INCH DEEP AND 27-CELL (3x9) PARABOLIC LOUVER, WITH LOW-IRIDESCENT DIFFUSE SILVER FINISH AND FLOATING BLACK REVEAL, ALL STEEL CONSTRUCTION WITH WHITE POWDER COAT ENAMEL FINISH, AND POSITIVE CLOSURE LATCHES	LITHONIA "2PMO" SERIES, METALUX "2P5GAX" SERIES, DAYBRITE "2UGS" SERIES, LIGHTOLIER "VPS" SERIES, COLUMBIA "HC" SERIES, OR WILLIAMS "USG" SERIES	FIXTURE SHALL MEET IES STANDARDS RP-24 AND RP-1 REFER TO FIXTURE NOTES FOR ADDITIONAL REQUIREMENTS
FC1	277V (49W)	2'x4' RECESSED GRID	2-F28T8 PS	SINGLE OR DUAL ELECTRONIC, PROGRAM START, > 98 PF, 88 BF, <10% THD WITH LINE SIDE FUSE (NOTE 2)	.125 INCH THICK PATTERN 12 VIRGIN ACRYLIC PRISMATIC LENS, WITH ALL STEEL CONSTRUCTION, WHITE POWDER COAT ENAMEL FINISH, WHITE ALUMINUM REGRESSED DOOR FRAME, AND POSITIVE CLOSURE LATCHES	LITHONIA "SP8" SERIES, METALUX "GC8" SERIES, DAYBRITE "2SP" SERIES, LIGHTOLIER "SPS" SERIES, COLUMBIA "4PS" SERIES, OR WILLIAMS "50G" SERIES	REFER TO FIXTURE NOTES FOR ADDITIONAL REQUIREMENTS
FC2	277V (49W)	2'x4' RECESSED GRID	2-F28T8 PS	SINGLE OR DUAL ELECTRONIC, PROGRAM START, > 98 PF, 88 BF, <10% THD WITH LINE SIDE FUSE (NOTE 2)	5 INCH DEEP AND 18-CELL (2x9) PARABOLIC LOUVER, WITH LOW-IRIDESCENT DIFFUSE SILVER FINISH AND FLOATING BLACK REVEAL, ALL STEEL CONSTRUCTION WITH WHITE POWDER COAT ENAMEL FINISH, AND POSITIVE CLOSURE LATCHES	LITHONIA "2PMO" SERIES, METALUX "2P5GAX" SERIES, DAYBRITE "2UGS" SERIES, LIGHTOLIER "VPS" SERIES, COLUMBIA "HC" SERIES, OR WILLIAMS "USG" SERIES	FIXTURE SHALL MEET IES STANDARDS RP-24 AND RP-1 REFER TO FIXTURE NOTES FOR ADDITIONAL REQUIREMENTS
FE1	277V (29W)	2'x2' RECESSED GRID	2-F17T8 PS	SINGLE OR DUAL ELECTRONIC, PROGRAM START, > 98 PF, 88 BF, <10% THD WITH LINE SIDE FUSE (NOTE 2)	.125 INCH THICK PATTERN 12 VIRGIN ACRYLIC PRISMATIC LENS, WITH ALL STEEL CONSTRUCTION, WHITE POWDER COAT ENAMEL FINISH, WHITE ALUMINUM REGRESSED DOOR FRAME, AND POSITIVE CLOSURE LATCHES	LITHONIA "SP8" SERIES, METALUX "GC8" SERIES, DAYBRITE "2SP" SERIES, LIGHTOLIER "SPS" SERIES, COLUMBIA "4PS" SERIES, OR WILLIAMS "50G" SERIES	REFER TO FIXTURE NOTES FOR ADDITIONAL REQUIREMENTS
FE2	277V (29W)	2'x2' RECESSED GRID	2-F17T8 PS	SINGLE OR DUAL ELECTRONIC, PROGRAM START, > 98 PF, 88 BF, <10% THD WITH LINE SIDE FUSE (NOTE 2)	5 INCH DEEP AND 18-CELL (2x9) PARABOLIC LOUVER, WITH LOW-IRIDESCENT DIFFUSE SILVER FINISH AND FLOATING BLACK REVEAL, ALL STEEL CONSTRUCTION WITH WHITE POWDER COAT ENAMEL FINISH, AND POSITIVE CLOSURE LATCHES	LITHONIA "2PMO" SERIES, METALUX "2P5GAX" SERIES, DAYBRITE "2UGS" SERIES, LIGHTOLIER "VPS" SERIES, COLUMBIA "HC" SERIES, OR WILLIAMS "USG" SERIES	FIXTURE SHALL MEET IES STANDARDS RP-24 AND RP-1 REFER TO FIXTURE NOTES FOR ADDITIONAL REQUIREMENTS
CA1	277V (48W)	8" ROUND (NOMINAL) RECESSED DOWNLIGHT	1-42 WATT TRIPLE TUBE PS	SINGLE OR DUAL ELECTRONIC, PROGRAM START, > 98 PF, 1.00 BF, <10% THD WITH LINE SIDE FUSE (NOTE 2)	ALL METAL CONSTRUCTION, WITH OPEN TRIM, LOW IRIDESCENT DIFFUSE SILVER REFLECTOR, AND ACRYLIC DUST SHIELD IN PATIENT CARE AREAS	LITHONIA "AFV" SERIES, PORTFOLIO "C7032" SERIES, OMEGA "OM8" SERIES, KURT VERSEN "P973" SERIES, LIGHTOLIER "8022" SERIES, PRESCOLITE "CFT8" SERIES, OR INFINITY "PV75" SERIES	VERTICAL LAMP ORIENTATION, 45 DEGREE LAMP AND LAMP IMAGE CUTOFF, REFER TO FIXTURE NOTES FOR ADDITIONAL REQUIREMENTS
CB1	277V (36W)	8" ROUND (NOMINAL) RECESSED DOWNLIGHT	1-32 WATT TRIPLE TUBE PS	SINGLE OR DUAL ELECTRONIC, PROGRAM START, > 98 PF, 1.00 BF, <10% THD WITH LINE SIDE FUSE (NOTE 2)	ALL METAL CONSTRUCTION, WITH OPEN TRIM, LOW IRIDESCENT DIFFUSE SILVER REFLECTOR, AND ACRYLIC DUST SHIELD IN PATIENT CARE AREAS	LITHONIA "AFV" SERIES, PORTFOLIO "C7032" SERIES, OMEGA "OM8" SERIES, KURT VERSEN "P973" SERIES, LIGHTOLIER "8022" SERIES, PRESCOLITE "CFT8" SERIES, OR INFINITY "PV75" SERIES	VERTICAL LAMP ORIENTATION, 45 DEGREE LAMP AND LAMP IMAGE CUTOFF, REFER TO FIXTURE NOTES FOR ADDITIONAL REQUIREMENTS
CC1	277V (29W)	8" ROUND (NOMINAL) RECESSED DOWNLIGHT	1-28 WATT TRIPLE TUBE PS	SINGLE OR DUAL ELECTRONIC, PROGRAM START, > 98 PF, 1.00 BF, <10% THD WITH LINE SIDE FUSE (NOTE 2)	ALL METAL CONSTRUCTION, WITH OPEN TRIM, LOW IRIDESCENT DIFFUSE SILVER REFLECTOR, AND ACRYLIC DUST SHIELD IN PATIENT CARE AREAS	LITHONIA "AFV" SERIES, PORTFOLIO "C7032" SERIES, OMEGA "OM8" SERIES, KURT VERSEN "P973" SERIES, LIGHTOLIER "8022" SERIES, PRESCOLITE "CFT8" SERIES, OR INFINITY "PV75" SERIES	VERTICAL LAMP ORIENTATION, 45 DEGREE LAMP AND LAMP IMAGE CUTOFF, REFER TO FIXTURE NOTES FOR ADDITIONAL REQUIREMENTS

GENERAL NOTES

1. REFER TO SYMBOLS AND ABBREVIATIONS LISTS ON SHEET NO. E-001.

2. REFER TO MOUNTING HEIGHTS AND ELECTRICAL NOTES ON SHEET NO. E-001.

3. REFER TO SPECIFICATIONS FOR ADDITIONAL ELECTRICAL REQUIREMENTS.

4. REFER TO FIXTURE SCHEDULE ON THIS SHEET.

SHEET NOTES

1. REFER TO ADDITIONAL LIGHTING CONTROL INFORMATION ON SHEET NO. EL-500.

2. POWER ALL 277V EMERGENCY/EGRESS/LIFE SAFETY BRANCH LIGHT FIXTURES INDICATED ON THIS DRAWING FROM EXISTING CIRCUIT LP-EL4 #1 UNLESS NOTED OTHERWISE.

3. RE-CIRCUIT EXISTING LIGHT FIXTURES AS SHOWN. RE-CIRCUIT LIGHT FIXTURE ON CIRCUIT LP-EL4 #18 TO LP-L4#14.

4. REFER TO WARNING LIGHT WIRING DIAGRAM ON SHEET NO. EL-500.

5. POWER ALL 277V EMERGENCY/CRITICAL BRANCH LIGHT FIXTURES INDICATED ON THIS DRAWING FROM CIRCUIT LP-CL4 #5 UNLESS NOTED OTHERWISE.

6. ALL ROOMS WITH DUAL BRANCH CIRCUITS OR DUAL SWITCHING SHALL HAVE DUAL BALLAST IN LIGHT FIXTURES.

GENERAL FIXTURE NOTES

1. PRIOR TO SHOP DRAWING SUBMITTALS, VERIFY WALL SWITCHING ON ELECTRICAL LIGHTING PLANS FOR PROPER TYPES OF OPTIONS REQUIRED ON ALL FIXTURES.

2. PRIOR TO SHOP DRAWING SUBMITTAL, VERIFY CEILING TYPES ON ARCHITECTURAL REFLECTED CEILING PLANS FOR PROPER INSTALLATIONS OF TRIMS AND FOR EXACT FIXTURE MOUNTING LOCATIONS ON ALL FIXTURES.

3. LAMPS SHALL BE FURNISHED FOR ALL LIGHT FIXTURES WITHIN WORK AREA AND SHALL BE REPLACED, IF BURNED OUT, AT END OF JOB.

4. PATTERN 12 VIRGIN ACRYLIC LENSES SHALL HAVE A MINIMUM THICKNESS OF .125 INCHES.

5. ALL WET LOCATION FIXTURES SHALL HAVE GASKETING BETWEEN TRIM AND CEILING, AND GASKETING BETWEEN TRIM AND LENS.

6. FLUORESCENT LAMPS SHALL HAVE A MINIMUM COLOR TEMPERATURE OF 4100K AND A MINIMUM COLOR RENDERING INDEX OF 85+.

7. COMPACT FLUORESCENT LAMPS SHALL HAVE A MINIMUM COLOR TEMPERATURE OF 4100K AND A MINIMUM COLOR RENDERING INDEX OF 85+.

8. METAL HALIDE LAMPS SHALL HAVE A MINIMUM COLOR TEMPERATURE OF 3000K AND A MINIMUM COLOR RENDERING INDEX OF 80 FOR LAMPS BELOW 100 WATTS, AND 4000K AND A MINIMUM COLOR RENDERING INDEX OF 80 FOR LAMPS 100 WATTS AND ABOVE.

9. FURNISH AND INSTALL HOLD DOWN CLIPS FOR ALL LAY-IN CEILING FIXTURES.

10. COORDINATE MOUNTING OF LIGHT FIXTURES WITH MECHANICAL CONTRACTOR TO AVOID CONFLICTS BETWEEN MECHANICAL EQUIPMENT, HVAC DUCTS, AND PIPING.

11. FURNISH AND INSTALL VOLTAGE LABEL (ie "277 VOLT BALLAST") AND PERMANENTLY AFFIX TO BALLAST COVER FOR ALL 277 VOLT RATED BALLASTS.

12. FURNISH AND INSTALL ELECTRONIC PROGRAM START (PS) BALLASTS FOR ALL INDOOR FLUORESCENT FIXTURES. MAGNETIC, ELECTROMAGNETIC, RAPID START (RS) AND TRIGGER START (TS) BALLASTS SHALL NOT BE ALLOWED UNLESS NOTED OTHERWISE.

FULLY SPRINKLERED

Office of Construction and Facilities Management

Department of Veterans Affairs

US DEPARTMENT OF VETERANS AFFAIRS

JOHN D. DINGELL

VA MEDICAL CENTER

4646 JOHN R. STREET

DETROIT, MI 48202

ARCHITECT/ENGINEERS:

Albert Kahn Associates, Inc.

Albert Kahn Building

7430 Second Avenue

Detroit, Michigan 48202-2798

Albert Kahn Associates, Inc. is a member of the Albert Kahn Family of Companies.

ALBERT KAHN JOB # 0088-00000

© 2007

Drawing Title

ENLARGED LOWER LEVEL LIGHTING PLANS

Approved Project Director

Project Title

POLICE SERVICES RELOCATION

Location

DETROIT, MICHIGAN

Date

01-20-2011

Checked

-

Drawn

-

Project Number

553-11-108

Building Number

100

Drawing Number

EL-400

Dwg. 33 of 50