

Outpatient Pharmacy Swing Space				
12/15/2105				
Please see following attachments for reference. Manufacturers are for informational purposes only.				
Qty.	Item	Size	Finish	Salient Characteristics
3	Wire Mobile Shelving	36x18x78"	Chrome	4 Shelves w/ ability to add 3 shelves
				Shelves adjust in 1" increments
				5" locking swivel casters included
				NSF Certified
9	Add'l Wire Shelves	36x18"	Chrome	Includes snap-on shelf supports
				NSF Certified
21	Wire Mobile Shelving	48x24x78"	Chrome	4 Shelves w/ ability to add 3 shelves
				Shelves adjust in 1" increments
				5" locking swivel casters included
				NSF Certified
54	Add'l Wire Shelves	48x24"	Chrome	Includes snap-on shelf supports
				NSF Certified
5	Packaging Tables	48x30"	Steel	Steel top with square edges
				1 1/2 thickness
				Adj. legs 28" - 35"
3	Packing Tables	48x60"	Steel	Steel top with square edges
				1 1/2 thickness
				Adj. legs 28" - 35"
21	Packing Tables	48x96"	Steel	Steel top with square edges
				1 1/2 thickness
				Adj. legs 28" - 35"
2	Packing Table Side and Back Ledges	96x30"	Steel	Easily screws into table top
				(1) back, (2) side ledges
29	Packing Tables	48x30"	Laminate	Laminate top
				1 5/8 thickness
				Adj. legs 28" - 35"
2	Welded Storage Cabinet	36x18x74"	Steel	Lockable
				Adj. shelves
26	Ergonomic Task Chairs			Non fabric for infection control
				Height adjustable

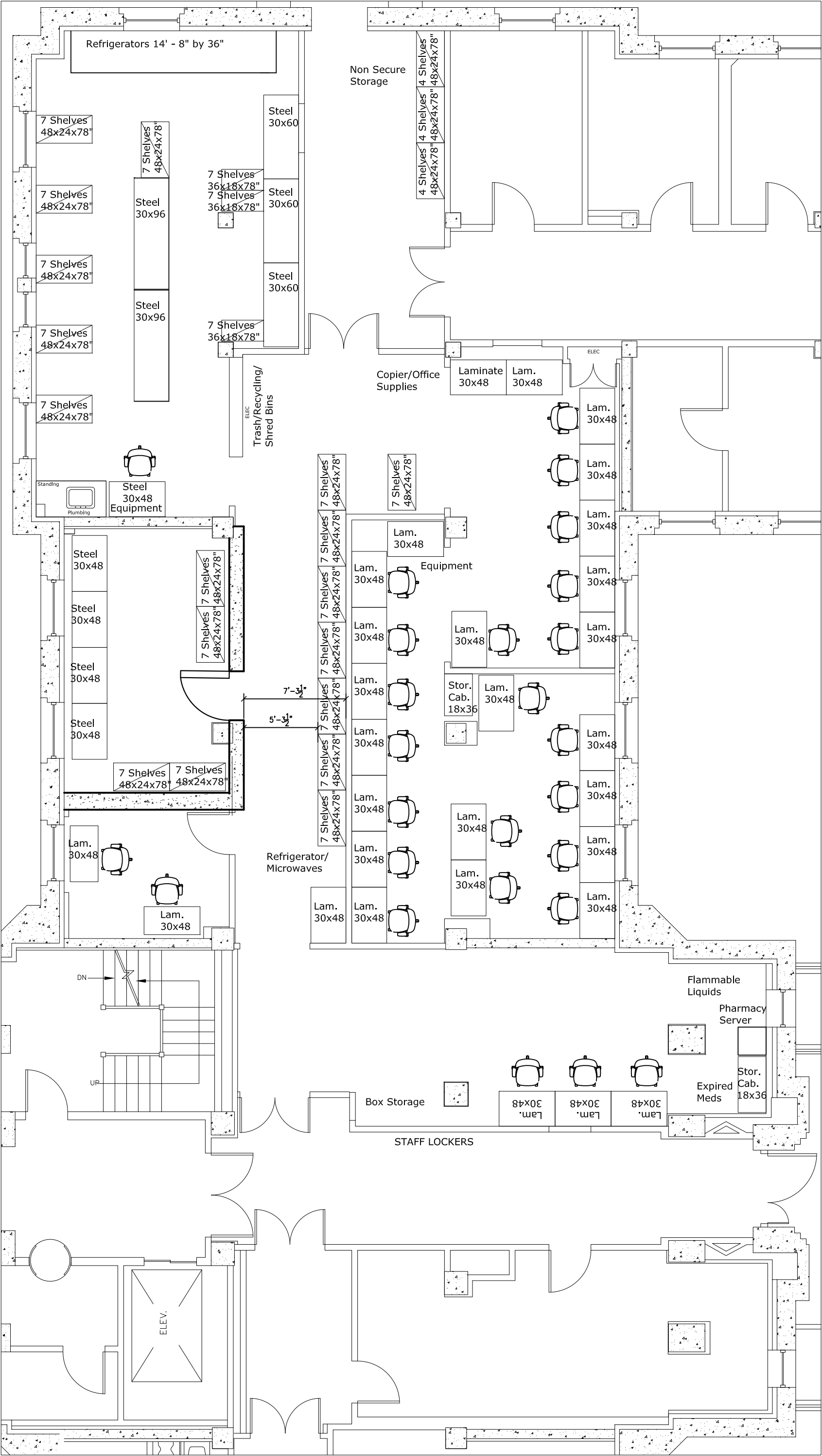

ULINE 1-800-295-5510

Search

GO

[Products](#)[Uline Products](#)[Quick Order](#)[Catalog](#)[Special Offers](#)[About Us](#)[Careers](#)[Home](#) > [All Products](#) > [Material Handling](#) > [Wire Carts](#) > [Mobile Shelving](#)

Mobile Shelving - 36 x 18 x 78"

 [Enlarge](#)

Tough, heavy duty maneuverable carts move large loads.

- **4 Shelf** – Longer posts give more space for larger items. Greater capacity for less trips.
- Easy to clean; won't collect dirt.
- Shelves adjust in 1" increments.
- 5" locking swivel casters included.
- NSF Certified.
- Optional [Wire Shelving Accessories](#) available.

MODEL NO.	DIMENSIONS W x D x H	SHELF QTY.	CAPACITY (LBS.)	WT. (LBS.)	PRICE EACH		ADD TO CART
					1	3+	
H-4254	36 x 18 x 78"	4	1,000	64	\$219	\$209	<input type="text" value="1"/> ADD

SHIPS UNASSEMBLED VIA UPS

[Additional Info](#)[Email Page](#)[Add to Favorites](#)[Request a Catalog](#)**CAPACITY:**

- 800 lbs per shelf. Cart not to exceed 1,000 lbs.

EXTRA SHELVES: H-3181C**DIMENSIONS:**

- Height listed in the chart includes casters.
- Posts: 1" Diameter (Single piece construction)
- Shelf Thickness: 1 1/4"

MATERIAL:

- Casters: Solid polyurethane
- Shelving:
 - Chrome-plated carbon steel.
 - Rust resistant, not rust proof.

TEMPERATURE: -20 to 120 F**USAGE:**

- Recommended for indoor use only.

SPECIFICATIONS:

- Casters: NSF certified (National Sanitary Foundation)

Availability: [In Stock](#)
Unit Weight: 65 lbs.

[Instructions](#)[Catalog Page 397](#)

ULINE 1-800-295-5510

Search

GO

[Products](#)[Uline Products](#)[Quick Order](#)[Catalog](#)[Special Offers](#)[About Us](#)[Careers](#)[Home](#) > [All Products](#) > [Warehouse Supplies / Equipment](#) > [Packing Tables](#) > [Industrial Packing Tables](#)

Packing Table - 96 x 36", Steel Top

 [More Images & Video](#)

Customize your work area with these heavy duty packing tables.

- Steel top with square edges. 1 1/2" thickness.
- Holds up to 500 lbs.
- 14" bottom shelf for additional storage.
- Adjustable steel legs: 28" to 35" in 1 1/2" increments.
- [Packing Table Accessories](#) and [Replacement Tops](#) available.

MODEL NO.	DIMENSIONS L x W	WT. (LBS.)	PRICE EACH		ADD TO CART
			1	2+	
H-1222-STEEL	96 x 36"	246	\$439	\$419	<input type="text" value="1"/> ADD

SHIPS UNASSEMBLED VIA MOTOR FREIGHT

[Additional Info](#) [Email Page](#) [Add to Favorites](#) [Request a Catalog](#)**TABLETOP:**

- Work surface: 12 gauge
- Reinforced end channels: 14 gauge
- Painted. Not stainless steel.

DIMENSIONS:

- Shelf Clearance: 20 1/4"
- Hole to Bolt Table to Floor: 3/8" diameter
- Adjustable Steel Legs- Actual Increments: 27 7/8" - 35 3/8"

MATERIAL:

- Legs:
 - Primary Material: 12 gauge
 - Upper Section: 13 gauge

Availability: [In Stock](#)
Unit Weight: 224 lbs.

[Instructions](#)[Catalog Page 431](#)

Country of Origin: USA

ULINE 1-800-295-5510

Search

GO

[Products](#)[Uline Products](#)[Quick Order](#)[Catalog](#)[Special Offers](#)[About Us](#)[Careers](#)[Home](#) > [All Products](#) > [Material Handling](#) > [Wire Carts](#) > [Mobile Shelving](#)

Mobile Shelving - 48 x 24 x 78"

[Enlarge](#)

Tough, heavy duty maneuverable carts move large loads.

- **4 Shelf** – Longer posts give more space for larger items. Greater capacity for less trips.
- Easy to clean; won't collect dirt.
- Shelves adjust in 1" increments.
- 5" locking swivel casters included.
- NSF Certified.
- Optional [Wire Shelving Accessories](#) available.

MODEL NO.	DIMENSIONS W x D x H	SHELF QTY.	CAPACITY (LBS.)	WT. (LBS.)	PRICE EACH		ADD TO CART
					1	3+	
H-4257	48 x 24 x 78"	4	1,000	89	\$269	\$259	<input type="text" value="1"/> <input type="button" value="ADD"/>

SHIPS UNASSEMBLED VIA UPS

[Additional Info](#)[Email Page](#)[Add to Favorites](#)[Request a Catalog](#)**CAPACITY:**

- 800 lbs per shelf. Cart not to exceed 1,000 lbs.

EXTRA SHELVES: H-3187C**DIMENSIONS:**

- Height listed in the chart includes casters.
- Posts: 1" Diameter (Single piece construction)
- Shelf Thickness: 1 1/4"

MATERIAL:

- Casters: Solid polyurethane
- Shelving:
 - Chrome-plated carbon steel.
 - Rust resistant, not rust proof.

TEMPERATURE: -20 to 120 F**USAGE:**

- Recommended for indoor use only.

SPECIFICATIONS:

- Casters: NSF certified (National Sanitary Foundation)

Availability: [In Stock](#)
Unit Weight: 90 lbs.[Instructions](#)[Catalog Page 397](#)

ULINE 1-800-295-5510[Products](#)[Uline Products](#)[Quick Order](#)[Catalog](#)[Special Offers](#)[About Us](#)[Careers](#)[Home](#) > [All Products](#) > [Shelving, Bins and Storage](#) > [Storage Cabinets](#) > [Welded Storage Cabinets](#)

Welded Storage Cabinet - 36 x 18 x 74"

[Enlarge](#)

HEAVIEST DUTY

Strength and security for storing your heaviest tools and equipment.

- 14-gauge steel with durable powder-coat finish.
- Padlockable handle with three-point locking system.
- Reinforced doors open on full-height hinges.
- Shelves adjust in 2 1/2" increments.

MODEL NO.	DIMENSIONS W x D x H	NO. SHELVES	SHELF CAP. (LBS.)	WT. (LBS.)	PRICE EACH		ADD TO CART
					1	2+	
H-4458	36 x 18 x 74"	5	1,200	320	\$695	\$660	<input type="text" value="1"/> <input type="button" value="ADD"/>

SHIPS ASSEMBLED VIA MOTOR FREIGHT

[Additional Info](#)[Email Page](#)[Add to Favorites](#)[Request a Catalog](#)**DIMENSIONS:**

- Actual- Overall (Including handle): 36 3/8 x 20 1/4 x 74 1/2"
- Shelf: 34 1/2 x 15 1/2"

WEIGHT CAPACITY:

- Total: 4,800 lbs

SHIPPING:

- Shelf clips included inside cabinet.

MISCELLANEOUS:

- Padlocks sold separately.

Ships Via Motor Freight**Availability: In Stock**
Unit Weight: 308 lbs.[Catalog Page 425](#)

Country of Origin: USA

ReGeneration by Knoll® for Healthcare

Healthcare environments require an easy to clean, easy to operate work chair that can withstand the rigors of a 24/7, multi-shift environment without sacrificing performance and comfort. ReGeneration by Knoll's Flex Back Net and structural components are flexible, light and durable. They successfully passed testing for common healthcare cleaning agents. Below is a summary of the test process.

Scope

Precision Testing Laboratories subjected ReGeneration's structural components, including the Flex Back Net, to five cleaning solutions common to healthcare environments to assess any impact on the parts.

Evaluation

Each part was evaluated in a before-and-after comparative process. Test information on untreated parts was compared to test data from the same parts after exposure to the cleaning agents. These parts were evaluated for colorfastness, surface durometer, surface cracking, tackiness, luster, and surface finish.

Protocol

Each part was evaluated for its physical aspects. Then each part was immersed in a bath of cleaning agent for 15 minutes, after which an identical set of evaluations was conducted.

Cleaning Agents

The following solutions were tested and are approved for use on structural parts, including the Flex Back Net (in all colors):

- Clorox Germicidal Liquid Bleach diluted 1:5 ratio to tap water (pH 3.7)
- Clorox Cleanup undiluted 100% solution (pH 9.7)
- Wex-Cide 128 Concentrate Phenolic Germicide by Wexford Labs diluted 1 ounce to 1 gallon tap water (pH 3.7)
- Formula 880 Quaternary Germicide by Grand Technologies diluted ½ ounce to 1 gallon tap water (pH 8.1)
- Hydroxi Pro Concentrate 128 by Core Products diluted 1:8 ratio to tap water (pH 7.2)

Parts Tested

The following parts were tested: arms, bases, casters, seat structures (not foam or upholstery) and the Flex Back Net.

Results

The laboratory found no negative result to the parts. The parts kept their original performance and appearance other than residue left by some cleaners, which can be easily removed with a wet cloth.

Additional Testing

In addition to the testing detailed above, Knoll has conducted internal testing of Virox 5 RTU cleaning solution on ReGeneration with no adverse affects.

Please note, Knoll can only attest to the results of the cleaning agents and solutions tested.

Seat and Back Upholstery

The ReGeneration by Knoll upholstered seat cushion and optional fully upholstered back were not tested. It can, however, be upholstered with the following types of high performance fabrics by KnollTextiles for use in healthcare applications. Visit KnollTextiles.com for specific patterns and colors and Knoll.com for application approvals on Knoll Office Seating.

- Crypton® – Moisture barrier plus stain, odor and bacteria resistance
- Nano-Tex® – Soil and stain resistance; Nano-Tex® with DuraBlock – Moisture barrier plus soil and stain resistance
- Polyurethane – Moisture barrier
- Solution Dyed – Fade resistance

