

PHASE 3 - CONSTRUCT
OUTPATIENT PHARMACY

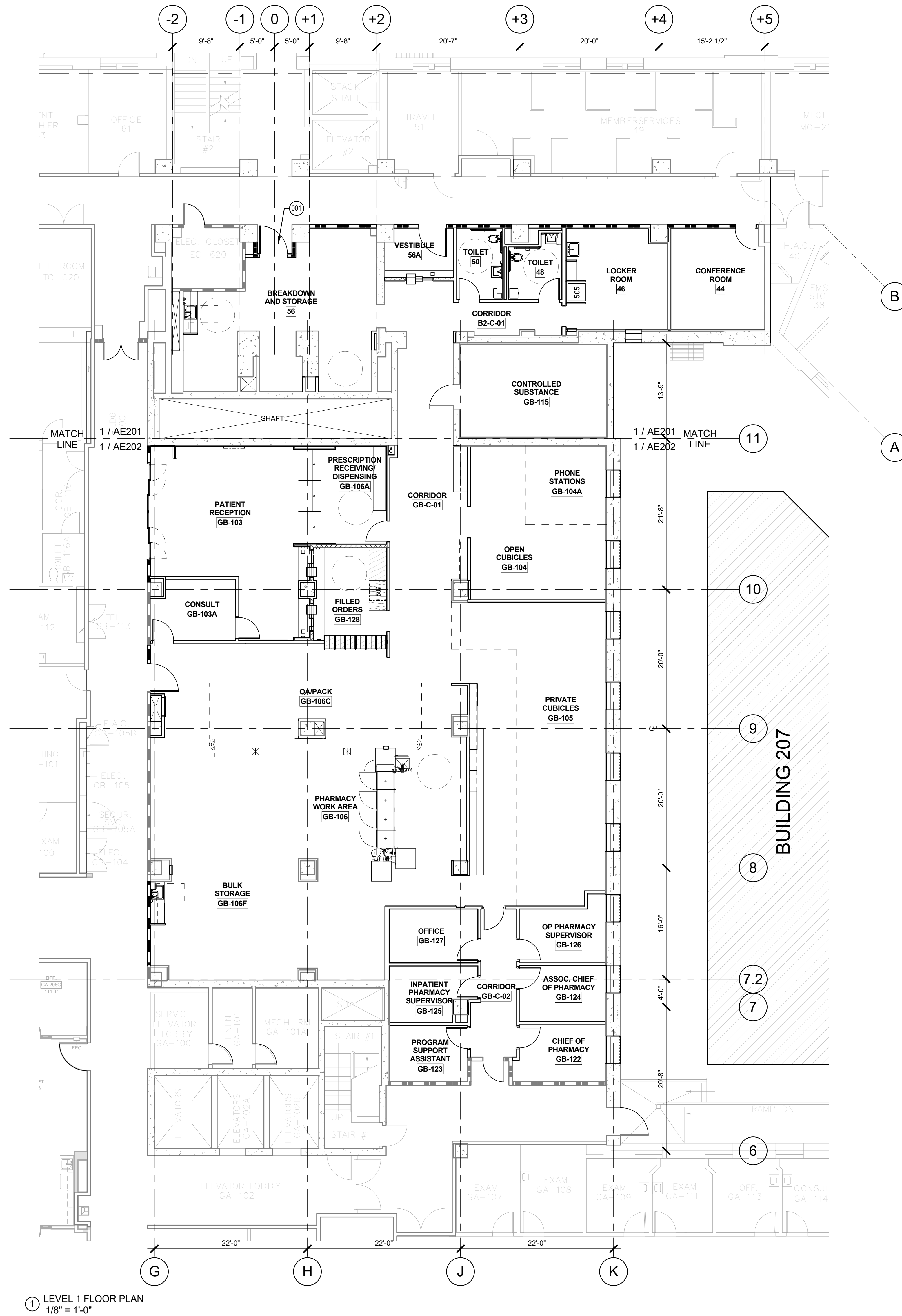

1 LEVEL 1 FLOOR PLAN
1/8" = 1'-0"

SHEET NOTES

1. ACTUAL CONDITIONS MAY DIFFER FROM THIS DOCUMENT. CONTRACTOR TO FIELD VERIFY ALL EXISTING CONDITIONS.
2. SEE AE3 SERIES REFLECTED CEILING PLANS FOR ADDITIONAL WORK.
3. SEE AE201 & AE202 ENLARGED FLOOR PLANS FOR ADDITIONAL WORK.
4. SEE AE401 FOR ENLARGED TOILET PLANS AND ELEVATIONS.
5. SEE SHEET G102 FOR TYPICAL MOUNTING HEIGHTS AND CONFIGURATION DIAGRAMS.
6. ADDITIONAL WALL & CEILING ACCESS MAY BE REQUIRED FOR UTILITY WORK. PATCH & REPAIR ALL AREAS THAT ARE NEEDED TO MATCH (E). SEE MEP DWGS FOR LOCATIONS OF UTILITY WORK.
7. FIRESTOP ALL THROUGH PENETRATIONS OF FIRE RATED ASSEMBLIES.
8. FOR NEW PARTITIONS SEE AE8 SERIES TYPICAL PARTITIONS AND FRAMING DETAILS.
9. PROVIDE (N) PAINT ON ALL (N) & (E) WALLS, PARTITIONS & CEILINGS IN PROJECT AREA U.O.N.
10. FOR DOOR & WINDOW INFORMATION SEE AE5 SERIES DOOR & WINDOW SCHEDULES & AE5 SERIES ELEVATIONS.
11. FOR FINISH INFORMATION SEE AE5 SERIES FINISH PLAN & SCHEDULE AND ELEVATIONS.
12. EXISTING COLUMN LOCATIONS ARE APPROXIMATE. VERIFY IN FIELD (VF).
13. PATCH & REPAIR (E) WALL, PARTITION, FLOOR, AND CEILING AS NEEDED PER DEMO PLANS TO MATCH ADJACENT CONDITIONS.
14. PROVIDE (N) PAINT ON ALL (N) & (E) WALLS, PARTITIONS & CEILINGS IN PROJECT AREA U.O.N.
15. VERIFY ALL DIMENSIONS IN THE FIELD.
16. REFER TO EQUIPMENT PLAN AE700 FOR EQUIPMENT LOCATIONS & KEYNOTES.
17. FURNITURE IS SHOWN FOR COORDINATION PURPOSES. PROVIDE ELECTRICAL & DATA OUTLETS FOR VA PROVIDED FURNITURE AS SHOWN IN ELECTRICAL & IT DRAWINGS.
18. REFER TO THE INTERIOR ELEVATIONS FOR ROOM & WALL INFORMATION.
19. SEE INTERIOR ELEVATIONS FOR ADDITIONAL ITEMS LOCATED IN EACH ROOM.
20. (E) SMOKE/FIRE BARRIERS SHOWN ON PLAN MAY NEED UPGRADES. DUE TO (E) PENETRATIONS. UPGRADE PER DETAILS ON SHEET AE843.
21. PROVIDE LEGIBLE LABELS ABOVE THE CEILING, ON EACH ROOM, AT SMOKE AND/OR FIRE RESISTIVE WALLS TO PREVENT FUTURE ALTERATION OF RATING.
22. PROVIDE TRAP AND HOT WATER PIPE WRAP @ ALL SINKS.

KEYNOTES

- 001 VA HAS INDICATED THAT THIS DOOR NEED NOT MEET ADA STRIKE SIDE REQUIREMENTS. AE TAKES NO RESPONSIBILITY FOR OMISSION OF STRIKE SIDE CLEARANCE.

WALL LEGEND:

- (E) GYP. WALL TO REMAIN
(E) CONC. WALL TO REMAIN
(N) NON-RATED WALL. SEE TYP. PARTITION TYPES
2-HR RATED PARTITION. SEE TYP. PARTITION TYPES
1-HR RATED PARTITION. SEE TYP. PARTITION TYPES

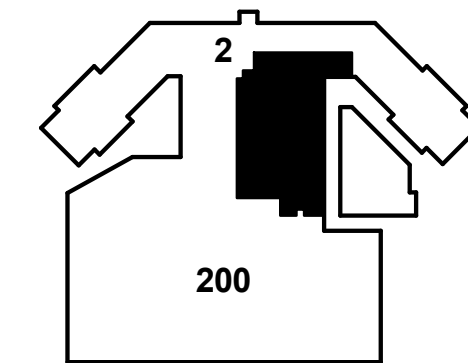

FULLY SPRINKLERED
CONSTRUCTION DOCUMENTS

CONSULTANTS:

Structural Engineer:

Estudine
1144 65th Street, Suite A
Oakland, CA 94608
T: (510) 235-3116

Mechanical, Electrical, Plumbing Engineer:

Gaynor Engineers
1153 Post Street
San Francisco, CA 94109
T: (415) 474-9500 | F: (415) 474-1363

Cost Estimator:

Hunter Pacific
363 Fifth Avenue, Suite 200
San Diego, CA 92101
T: (619) 232-2321 | F: (619) 232-0922

IT/Low Voltage/Security:

The Engineering Enterprise
1125 High Street
Auburn, CA 95603
T: (530) 886-8556

Equipment:

Criterion Systems
100 Crocker Road
Apogee, CA 95703
T: (530) 878-6689 | F: (530) 878-6585

Seals and Signatures

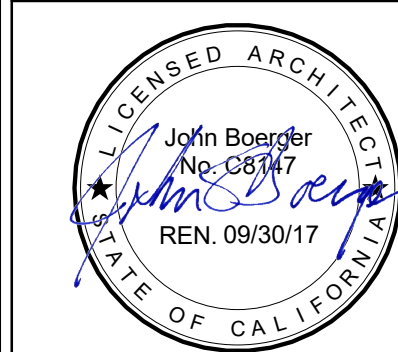

ARCHITECT/ENGINEERS:

THE DESIGN PARTNERSHIP
ARCHITECTS + PLANNERS

1629 TELEGRAPH AVENUE
SUITE 500 | OAKLAND, CA 94612
T: 415-777-3737 | F: 415-777-3476
www.dpsf.com

Drawing Title
OVERALL FLOOR PLAN

Approved: Project Director

Project Title
VA SAN FRANCISCO MEDICAL CENTER
OUTPATIENT PHARMACY DESIGN

Location
4150 Clement Street, San Francisco, CA 94121

Date
03/10/16

Checked
Checker

Drawn
JH

Project Number
662.12.112

Building Number
B200/B2

Drawing Number

AE200

Office of
Construction
and Facilities
Management

