

FARGO VA HEALTH CARE SYSTEM REPLACE CENTRAL CHILLER PLANT

Fargo, North Dakota

Project Number: 437-14-111

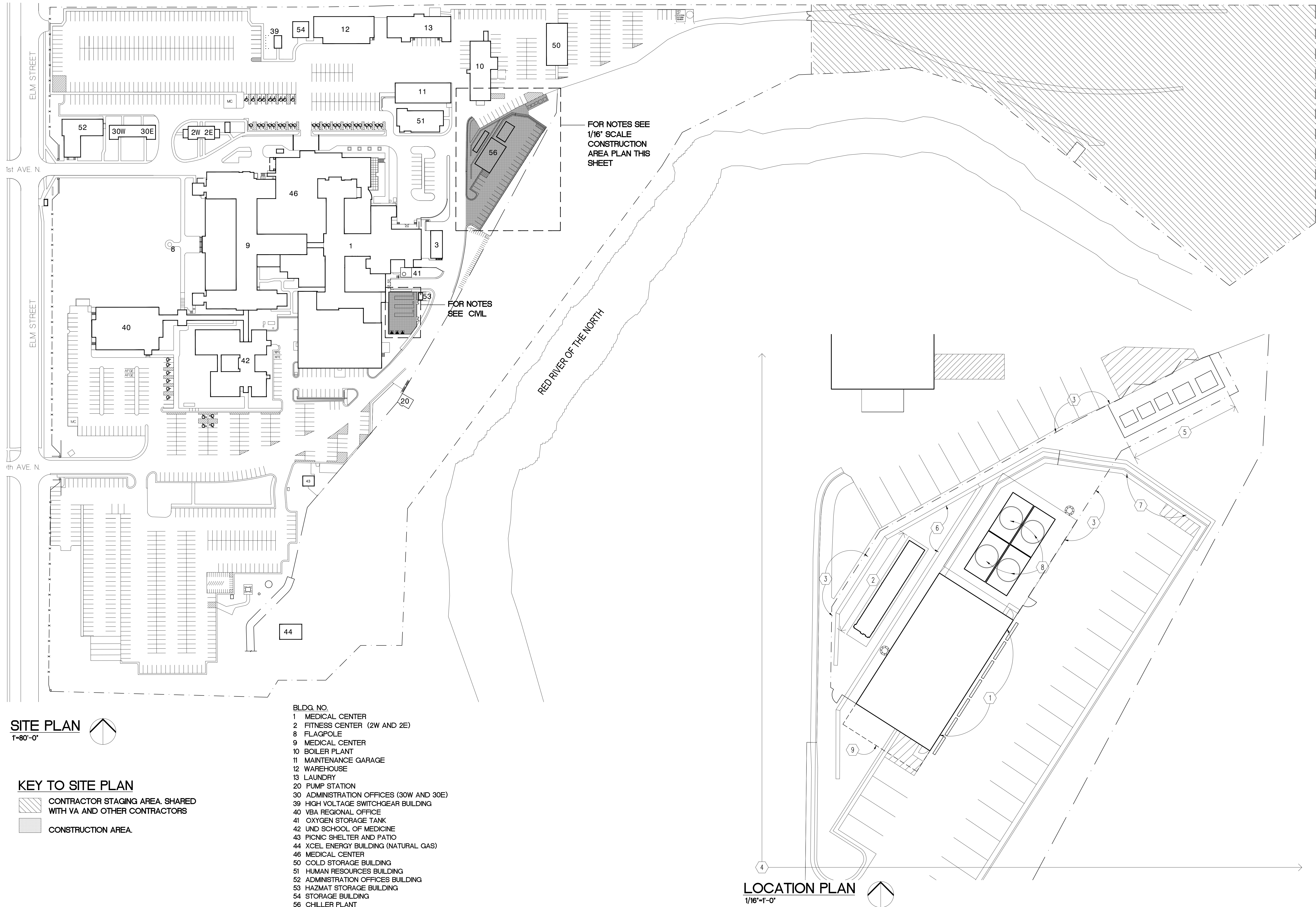

GENERAL

X1 COVER SHEET

CIVIL

- C1 DEMOLITION - PAVING PLAN
- C2 DEMOLITION - UTILITY PLAN
- C3 EROSION CONTROL/UTILITIES PLAN
- C4 GRADING PLAN
- C5 PAVING PLAN
- C6 RETAINING WALL AND FENCE ELEVATIONS
- C7 DETAILS

STRUCTURAL

S1 FOUNDATION PLAN

MECHANICAL

- P1 FOUNDATION PLUMBING PLAN - CHILLER PLANT
- P2 PLUMBING PLANS - CHILLER PLANT

- H1 HVAC PIPING DEMOLITION PLAN AND PHASING PLAN
- H2 HVAC PIPING SITE PLAN
- H3 HVAC PIPING PLAN - CHILLER PLANT
- H4 HVAC PIPING SECTIONS AND ELEVATION
- H5 HVAC PIPING PLAN - HOSPITAL
- H6 HVAC PIPING SCHEMATIC
- H7 VENTILATION PLAN - CHILLER PLANT
- H8 MECHANICAL CONTROLS
- H9 MECHANICAL SCHEDULES AND DETAILS
- H10 ENCLOSURE PLANS AND MECHANICAL DETAILS

ELECTRICAL

- E1 ELECTRICAL SYMBOLS LEGEND AND SITE DEMOLITION PLAN
- E2 SITE REMODELING PLAN
- E3 CHILLER BUILDING - LIGHTING, POWER, SYSTEMS, AND ELECTRICAL SCHEDULES
- E4 ELECTRICAL ONE-LINE DIAGRAMS AND DETAILS
- E5 ELECTRICAL DETAILS

GENERAL

- 1. SEE MECHANICAL AND ELECTRICAL DRAWINGS FOR PHASING OF WORK.
- 2. CONTRACTOR SHALL VERIFY AND COORDINATE CONCURRENT ONGOING PROJECTS UNDER CONSTRUCTION BY OTHER CONTRACTORS ON SITE.

CONSTRUCTION AREA PLAN NOTES:

- 1 NEW CHILLER PLANT BUILDING 56. SEE CIVIL, STRUCTURAL, MECHANICAL AND ELECTRICAL DRAWINGS FOR DETAILS.
- 2 RELOCATED AIR COOLED CHILLER. SEE CIVIL DRAWINGS FOR NEW CONCRETE CHILLER PAD. SEE MECHANICAL AND ELECTRICAL DRAWINGS FOR RELATED WORK.
- 3 NEW CHAIN LINK FENCE AND GATE. SEE CIVIL DRAWINGS FOR DETAILS.
- 4 REFER TO CIVIL DRAWINGS FOR SITE DEMOLITION AND REMODELING TO INCLUDE SIDEWALKS, CURB AND GUTTER, RETAINING WALLS, PAVING, LANDSCAPING AND UTILITIES.
- 5 NEW TRANSFORMERS AND PAD.
- 6 NEW RETAINING WALL. SEE CIVIL DRAWINGS.
- 7 EXISTING RETAINING WALL AND GUARD RAIL REMAINS. SEE CIVIL DRAWINGS.
- 8 NEW COOLING TOWERS. SEE STRUCTURAL DRAWINGS FOR SUPPORTS. SEE MECHANICAL AND ELECTRICAL DRAWINGS FOR RELATED WORK.
- 9 LINE OF FUTURE ADDITIONAL CHILLER MODULE FOR INCREASED CAPACITY.



Dept. of Veterans Affairs
Health Care System
2101 Elm Street North
Fargo, ND 58102



IMAGE GROUP INC.
403 CENTER AVENUE, SUITE 300
MOORHEAD, MN 56560

IMAGE GROUP INC., Architecture & Interiors
OBERMILLER NELSON ENGINEERING, Mechanical Engineers
MEN ENGINEERING, Civil & Electrical Engineers
SOLLEN & LARSON ENGINEERING, Structural Engineers

I hereby certify that this plan specification, or report was prepared by me or under my direct supervision, and that I am duly Registered Architect under the laws of the State of North Dakota.

Date 12/18/2015 Reg. No. 378

Drawing Title
COVER SHEET

VA Project No.
437-14-111

Building No.
56

Contract No.
VA263-P-1217
VA263-C-

AutoCAD File Name
Cover.dwg

Project Title
REPLACE CENTRAL CHILLER PLANT

Designed By
RM

Checked By
RM

Drawn By
MO

Location
FARGO VA HEALTH CARE SYSTEM
FARGO, ND

Date
DECEMBER 18, 2015

Scale
1"-80'-0"

Drawing No.
X1

Dwg 1 of 26

